

Note A: The LF means RoHS compliance, the housing will withstand exposure to peak temperature 260 degree C for 5 sec in the IR re-flow process.

- NOTES:
- SPECIFICATIONS**  
 Current Rating: 1A AC,DC  
 Voltage Rating: 125V AC,DC  
 Temperature Range: -40°C ~ +105°C  
 Contact Resistance: 20mΩ Max.  
 Insulation Resistance: 100MΩ Min.  
 Withstanding Voltage: 500V AC/minute
  - Material & finish:**  
 Housing: Natural Thermoplastic, UL94V-0  
 Contact and metal hold-down: Phosphor Bronze  
 Plating of contact: Matte Tin or gold on contact area, 100u"Min. Matte Tin on tail, 50u"Min. Ni overall as underplating  
 Plating of metal hold-down: 100u"Min. Matte Tin overall, 50u"Min. Nickel overall as underplating
  - Crimping application hand tool P/N: 10118656-1000
  - Ordering Information & Dimensions:

10114830- X X X XX LF

Material: LF: See note A

1: LCP Natural  
 Non Glow Wire Compatible  
 2: LCP Natural  
 Glow Wire Compatible  
 3: LCP Black  
 Glow Wire Compatible

Pin counts from 02~15

Packaging:  
 1: Tape & Reel  
 2: ESD Tape & Reel  
 3: Customized Tape & Reel(See page2)

Plating on contact:  
 0: Matte Tin 100u"  
 1: Gold Flash  
 2: Gold 15u"  
 3: Gold 30u"

PART NO.	Dimensions			
	A	B	C	D
10114830-xxx02LF	4.25	1.25±0.10	4.94	3.05
10114830-xxx03LF	5.50	2.50±0.10	6.19	4.30
10114830-xxx04LF	6.75	3.75±0.15	7.44	5.55
10114830-xxx05LF	8.00	5.00±0.10	8.69	6.80
10114830-xxx06LF	9.25	6.25±0.15	9.94	8.05
10114830-xxx07LF	10.50	7.50±0.15	11.19	9.30
10114830-xxx08LF	11.75	8.75±0.15	12.44	10.55
10114830-xxx09LF	13.00	10.00±0.15	13.69	11.80
10114830-xxx10LF	14.25	11.25±0.20	14.94	13.05
10114830-xxx11LF	15.50	12.50±0.20	16.19	14.30
10114830-xxx12LF	16.75	13.75±0.20	17.44	15.55
10114830-xxx13LF	18.00	15.00±0.20	18.69	16.80
10114830-xxx14LF	19.25	16.25±0.20	19.94	18.05
10114830-xxx15LF	20.50	17.50±0.20	21.19	19.30

mat'l. code		surface		tolerance		projection		product family	
		ISO 1302		ISO 406		ISO 1101		WTB	
ltr		ecn no		dr		date		title	
N		ELX-N-42390		Jason		9/18/21		WTB 1.25MM WAFER 90° SMT	
G		ELX-N-21788		TIM		08/27/15			
H		ELX-N-27088		TONY		05/24/17			
J		ELX-N-27325		TONY		06/26/17			
K		ELX-N-29884		TONY		04/17/17			
L		ELX-N-30309		TONY		05/28/18			
M		ELX-N-33890		JASON		06/12/19			
sheet		revision		N				dwg no	
index		sheet		1				sheet 1 of 2	
								size	
								A3	
								type	
								Product Customer Drawing	



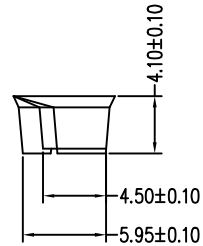
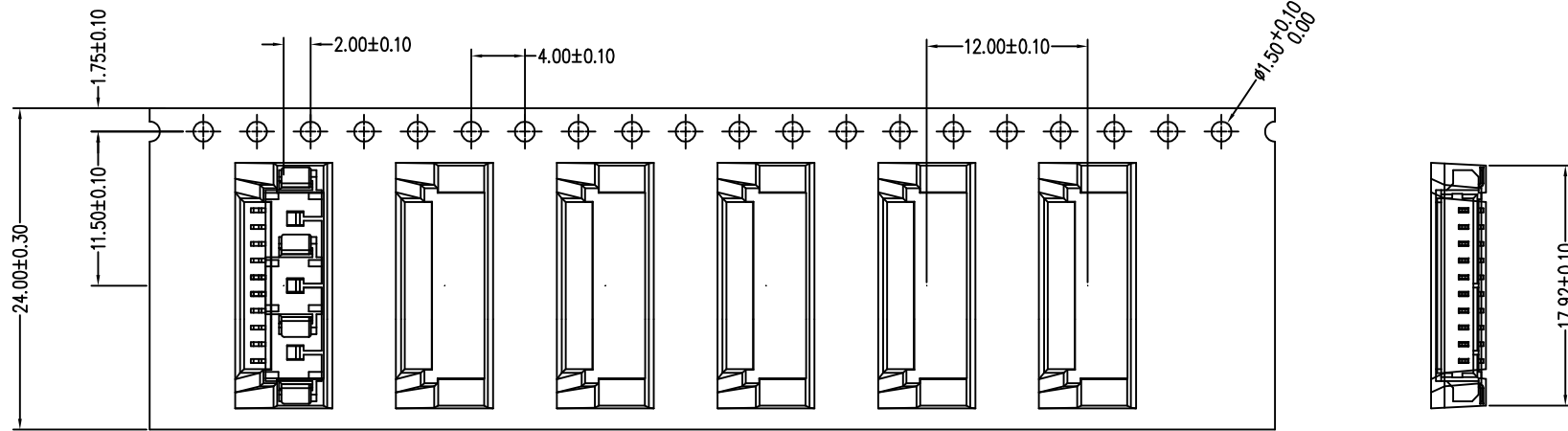
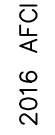

Packing only for 10114830-XX310LF

- NOTES:
1. The cumulative error of any 10 consecutive chain holes shall not exceed  $\pm 0.2\text{mm}$
  2. The non-parallel dimensions within the range of 250mm in the direction of the belt length shall not exceed 1mm.
  3. Material: PS; Color: Clear; Thickness: 0.30mm.
  4. 13°Dis; 15.3M/R; 1200pcs/R.
  5. Comply with ROHS requirements

mat'l. code		surface <input checked="" type="checkbox"/> ISO 1302		tolerance <input checked="" type="checkbox"/> ISO 406 <input type="checkbox"/> ISO 1101		projection		product family	
ltr		ecn no		dr		date		title	
N		ELX-N-42390		Jason		9/18/21		WTB	
G		ELX-N-21788		TIM		08/27/15		WTB 1.25MM WAFER 90° SMT	
H		ELX-N-27088		TONY		05/24/17		scale 1:1	
J		ELX-N-27325		TONY		06/26/17		dr JASON HSU 12/1/10	
K		ELX-N-29884		TONY		04/17/17		engr Jason Wang 2021/9/18	
L		ELX-N-30309		TONY		05/28/18		chr - -	
M		ELX-N-33890		JASON		06/12/19		appd Tim Yao 2021/9/18	
sheet		revision		N				Amphenol FCI	
index		sheet		2				type Product Customer Drawing	