

HC-D 7-SML-26/O1M20

Order No.: 1604885



<http://eshop.phoenixcontact.de/phoenix/treeViewClick.do?UID=1604885>

HEAVYCON box mounting base D7, with single locking latch, height 26 mm, with support 1x M20, with open bottom, zinc

Commercial data

GTIN (EAN)	
sales group	D011
Pack	10 pcs.
Customs tariff	85389099
Catalog page information	Page 509 (PC-2009)

Product notes

WEEE/RoHS-compliant since:
03/01/2006



<http://www.download.phoenixcontact.com>
Please note that the data given here has been taken from the online catalog. For comprehensive information and data, please refer to the user documentation. The General Terms and Conditions of Use apply to Internet downloads.

Technical data

General data

Note	For contact inserts HC-D7, D8, A3, A4, B5, HS2-D7
Design	D7
Height	25.5 mm
Width	40.5 mm
Length	38 mm

Housing type	Box mounting bases
Locking type	With single locking latch
Type of the screw connection	1x M20
Degree of protection	IP54 / IP65 with sealing screw
Ambient temperature (operation)	-40 °C ... 125 °C
Housing material	Zinc die-cast
Housing surface material	Powder-coated, gray
Seal material	NBR
Material lock	Steel, galvanized

Certificates / Approvals



Certification GOST

Accessories

Item	Designation	Description
Assembly		
1686229	HC-D 7-DS-IP65	Sealing screw, for IP65 protection

General		
1647967	HC-M-DE-M20	Pressure screw set, for housing with M20 thread, consisting of notched seal, 2 washers and pressure screw

Diagrams/Drawings

Dimensioned drawing

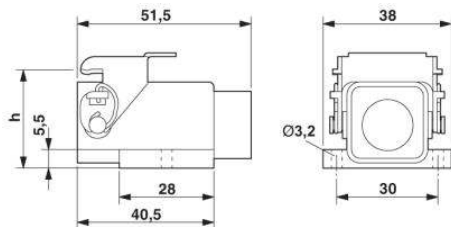

Address

PHOENIX CONTACT Inc., USA
586 Fulling Mill Road
Middletown, PA 17057, USA
Phone (800) 888-7388
Fax (717) 944-1625
<http://www.phoenixcon.com>



© 2010 Phoenix Contact
Technical modifications reserved;