

REVISIONS					
REV	DATE	DESCRIPTION	BY	CHK	APP'D
P1	22JUL2022	REVISED PER ECR-21-118222	AVN	VS	

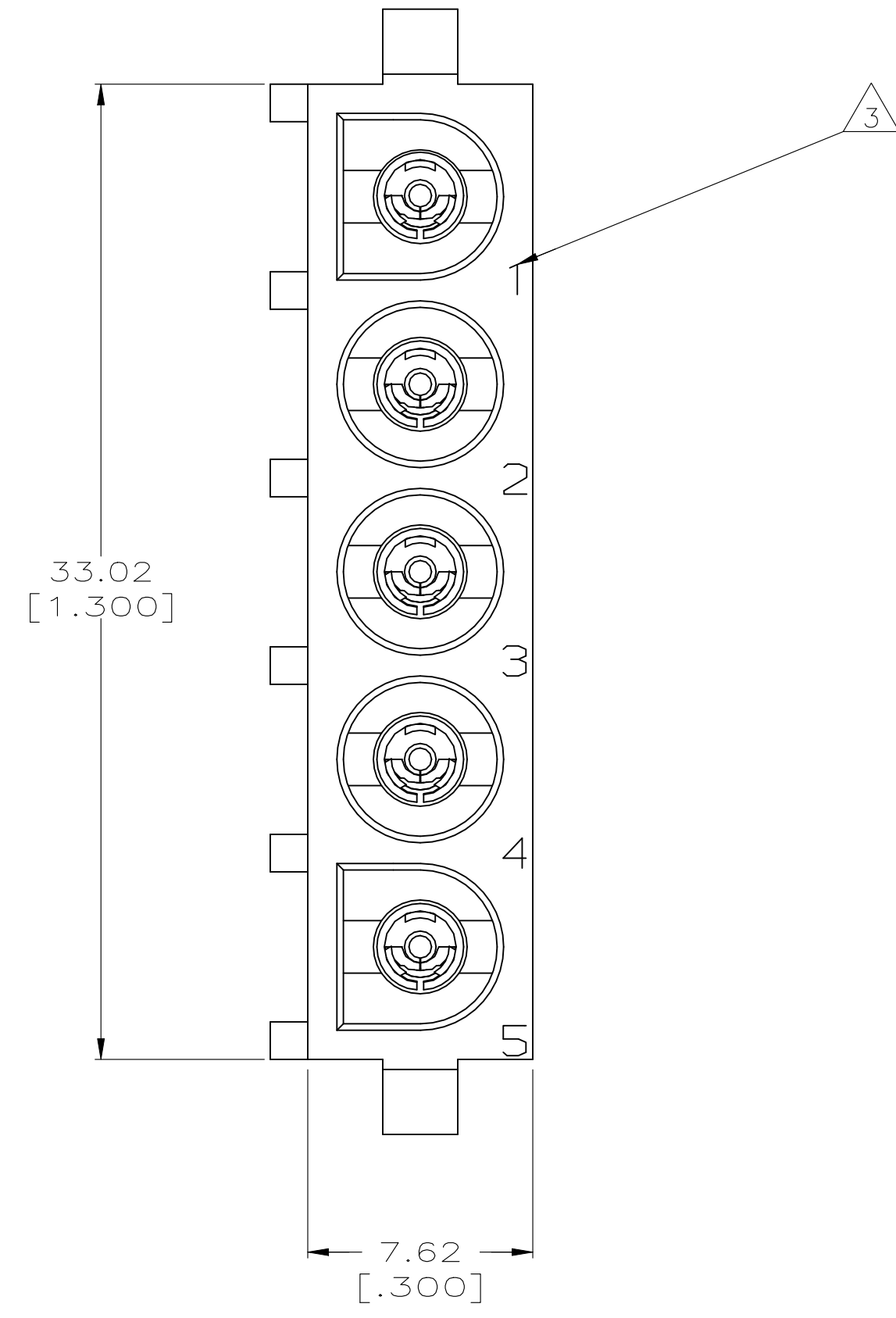

- 1 PARTS COMPLY TO AMP SOLDERABILITY SPECIFICATION 109-11-3.
- 2 CONTACT IS PLATED OVERALL WITH 0.00127 [.000050] NICKEL, THEN 0.00076 [.000030] GOLD OVER CONTACT LENGTH INDICATED AND MATTE TIN LEAD ON SOLDER TAIL END.
- 3 CIRCUIT IDENTIFICATION CHARACTERS ARE ADJACENT TO THE INDICATED CAVITIES, BUT LOCATION AND ORIENTATION MAY DIFFER FROM PRINT.
- 4 DIMENSIONS IN BRACKETS ARE IN INCHES.
- 5 CONTACT IS PLATED OVERALL WITH 0.00127 [.000050] NICKEL, THEN 0.00076 [.000030] GOLD OVER CONTACT LENGTH INDICATED AND MATTE TIN ON SOLDER TAIL END.
- 7 SUPERSEDED BY 640901-3
- 8 DIMENSIONS SHOWN REPRESENT PRODUCT IN DRY CONDITION. ADDITIONAL 2% GROWTH DUE TO END USE LOCATION MOISTURE ABSORPTION MAY OCCUR AND SHOULD BE ACCOUNTED FOR.

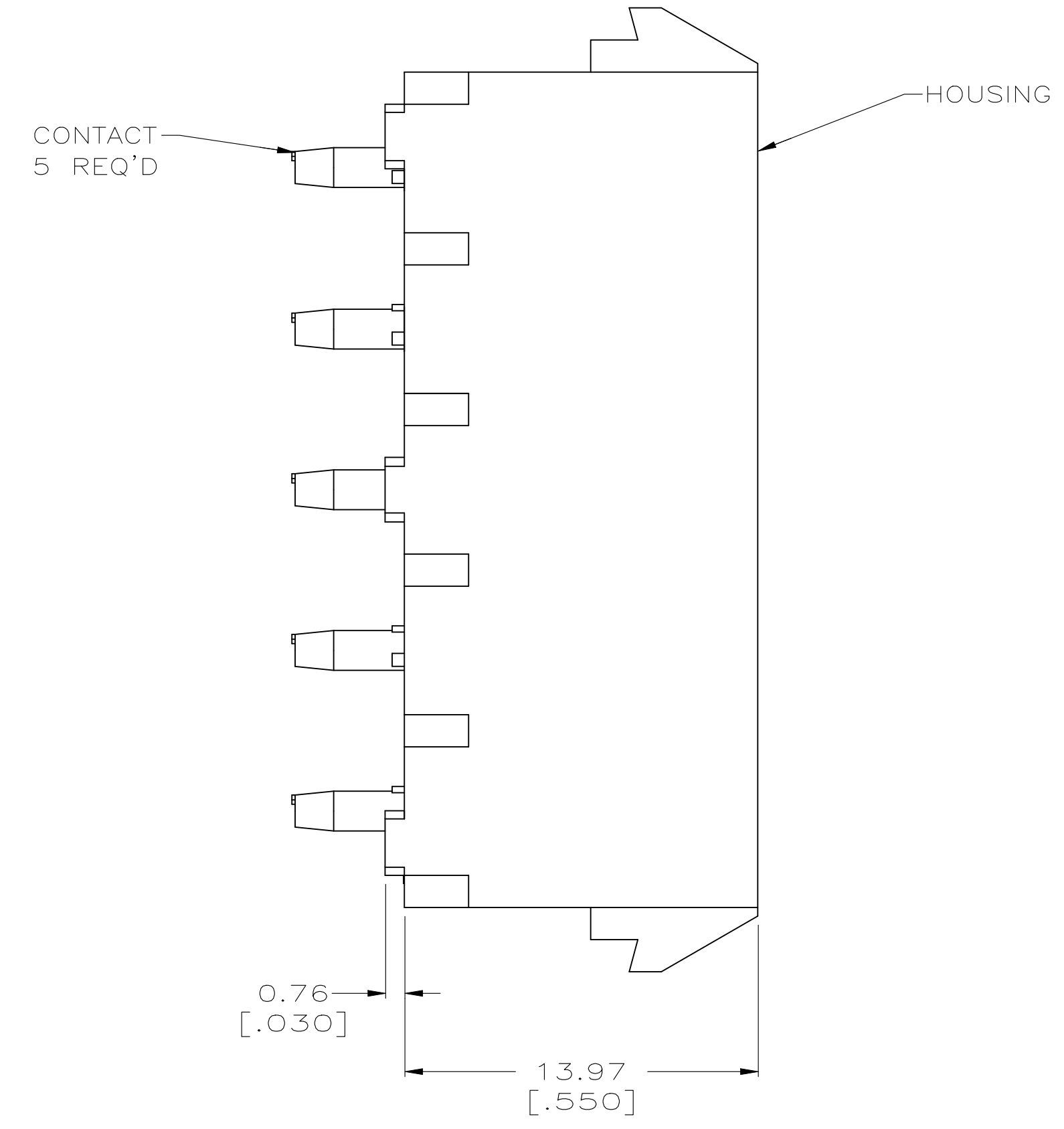
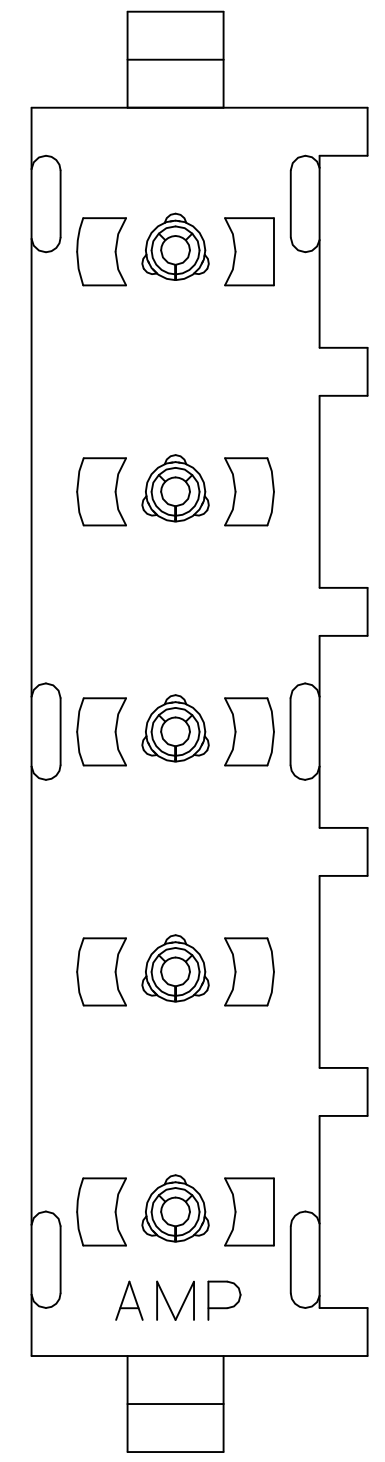
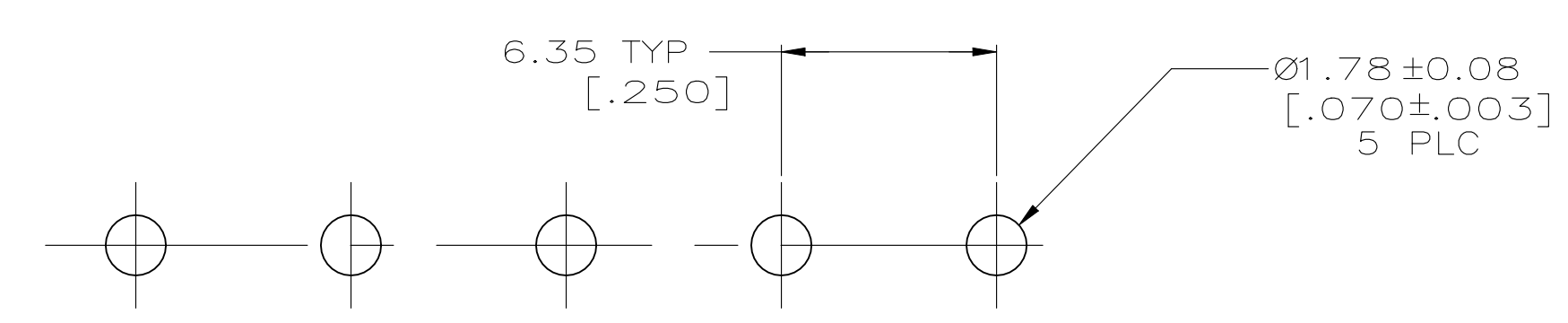
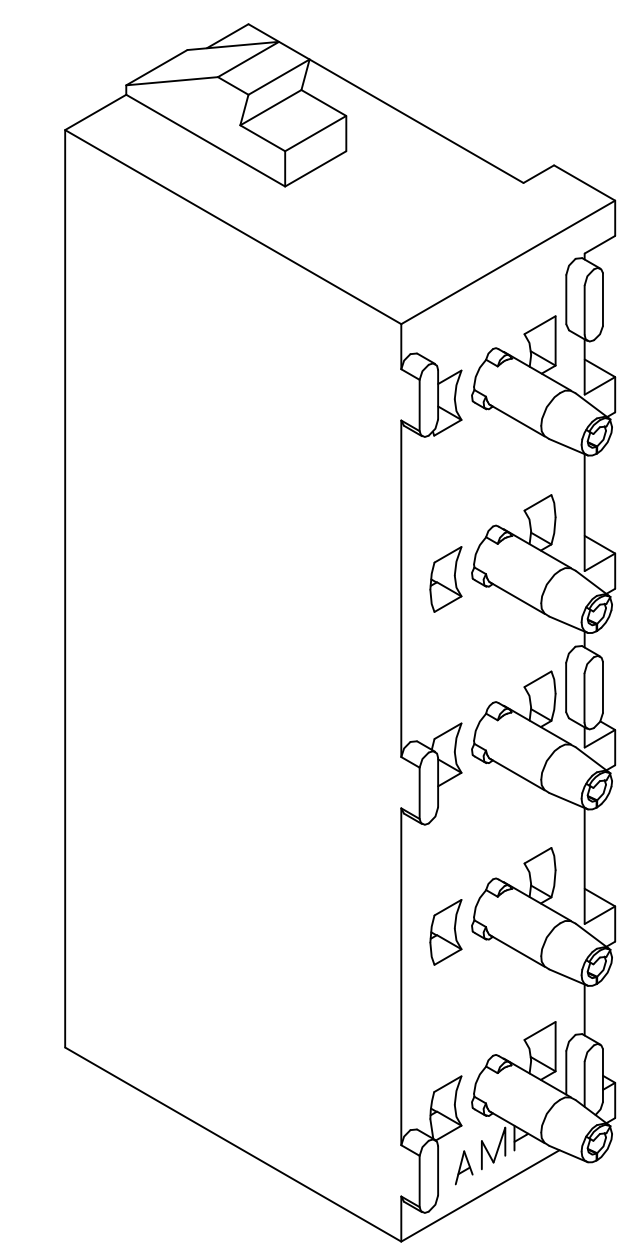
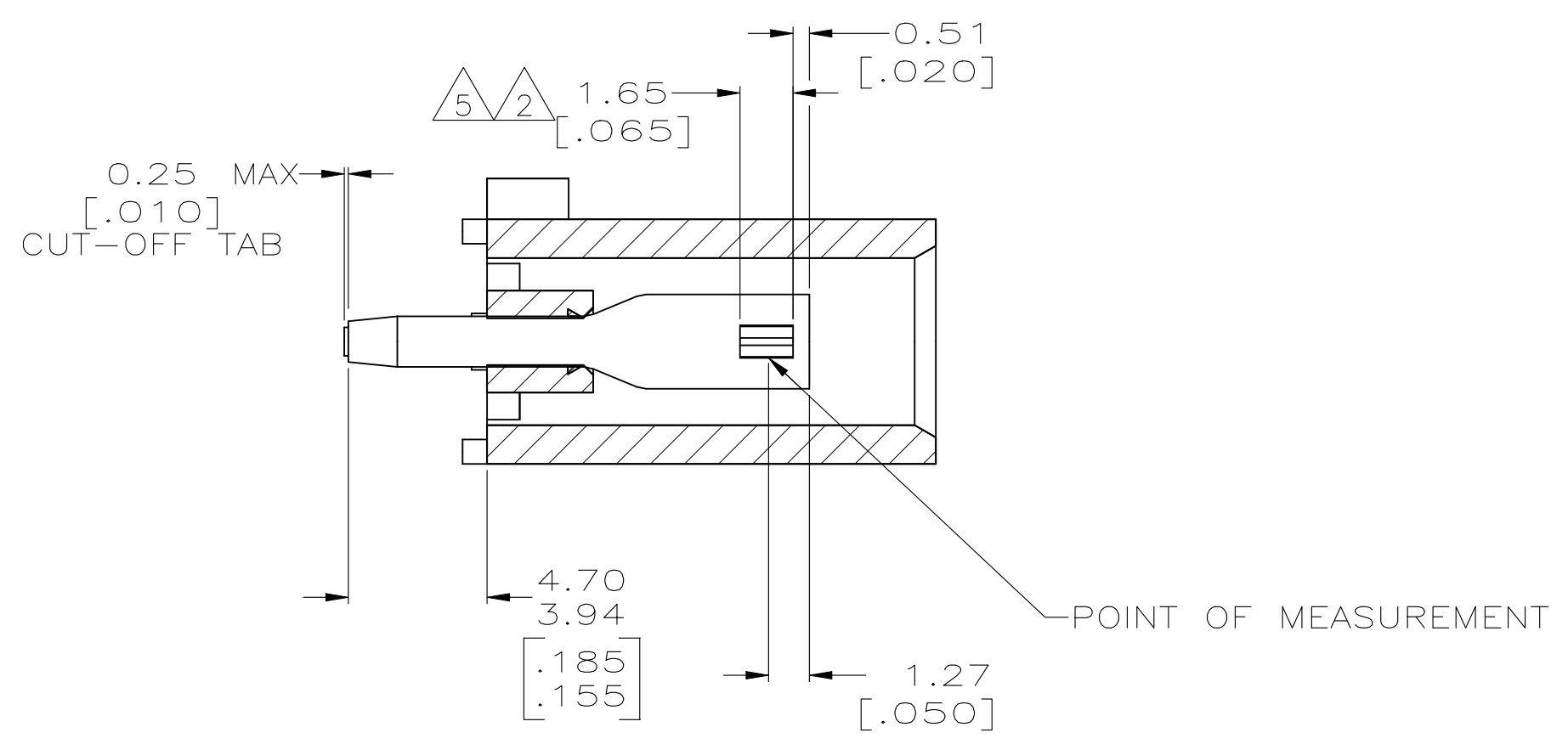

RECOMMENDED MOUNTING HOLE PATTERN FOR 1.57 [.062] THICK P.C. BOARD

CONTACT MATERIAL AND FINISH	HOUSING MATERIAL	PART NUMBER
PHOSPHOR BRONZE, PRE-TIN	NYLON,UL94V-0, BLUE	1-640901-4
PHOSPHOR BRONZE, PRE-TIN	NYLON,UL94V-0, RED	1-640901-2
PHOSPHOR BRONZE, GOLD 2	NYLON,UL94V-0, NATURAL	640901-3
PHOSPHOR BRONZE, GOLD 2	NYLON,UL94V-0, NATURAL	640901-2
PHOSPHOR BRONZE, PRE-TIN	NYLON,UL94V-0, NATURAL	640901-1

THIS DRAWING IS A CONTROLLED DOCUMENT.

DIN	10-05-98	TE LEWIS
CHK	10-05-98	R SWING
APP'D	10-05-98	M TRULL

NAME: SOCKET HEADER ASSEMBLY, 5 CIRCUIT UNIVERSAL MATE-N-LOK™

SIZE: A1 CAGE CODE: 00779C DRAWING NO: 640901

WEIGHT: 0.000000

CUSTOMER DRAWING SCALE: 5:1 SHEET: 1 OF 1 REV: P1