

- ① STAMPED AMP RG-58, 0.79[.031] HIGH CHARACTERS
- ② WITH OR WITHOUT PICKS
- 3. USE HAND TOOL NO. 220190-1 AND DIESET NO. 220195-1.
- ④ TIN-LEAD PLATE PER ASTM B-545
- ⑤ TIN PLATE PER ASTM B-545

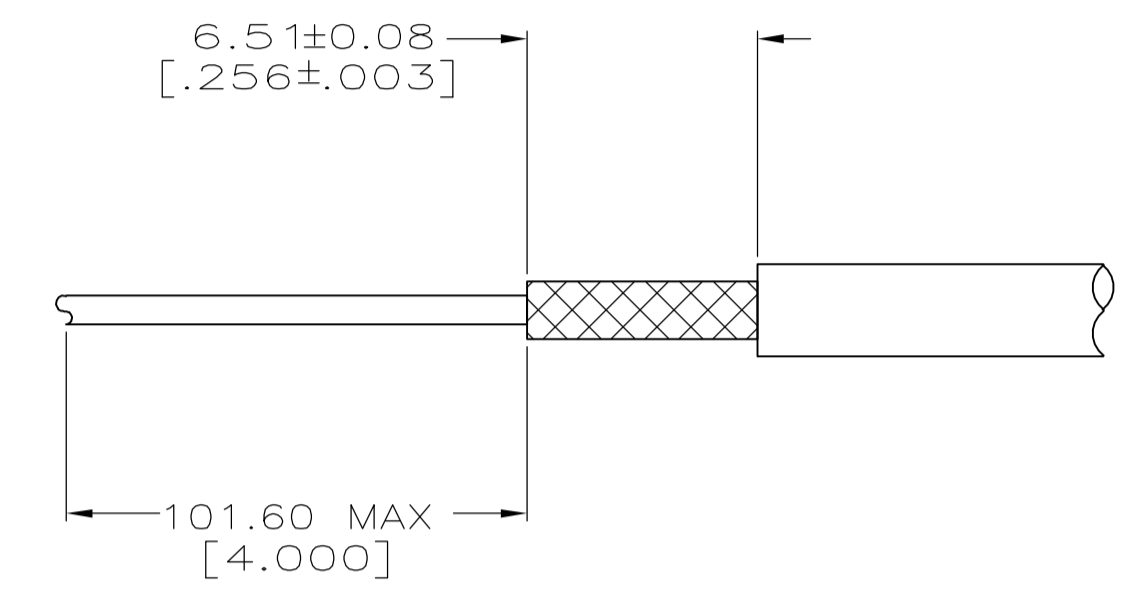

RECOMMENDED STRIP LENGTH

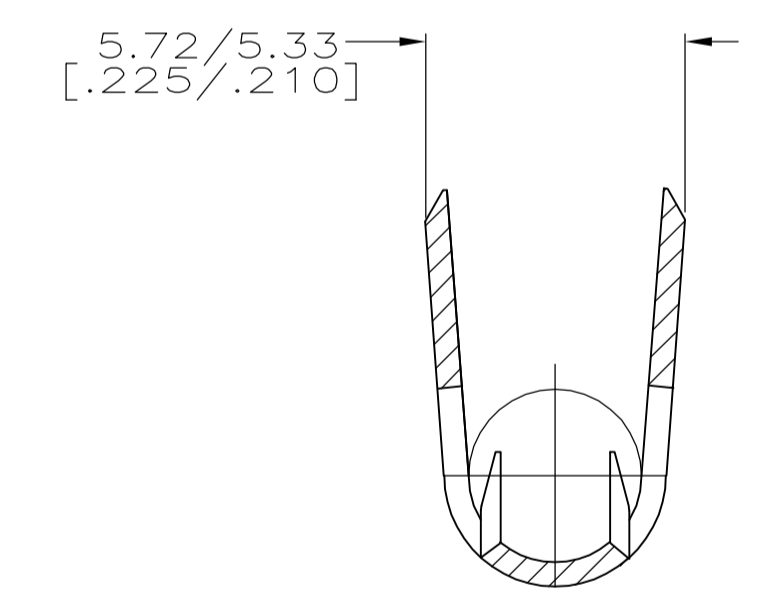

SECTION A-A
ROTATED 90° CW

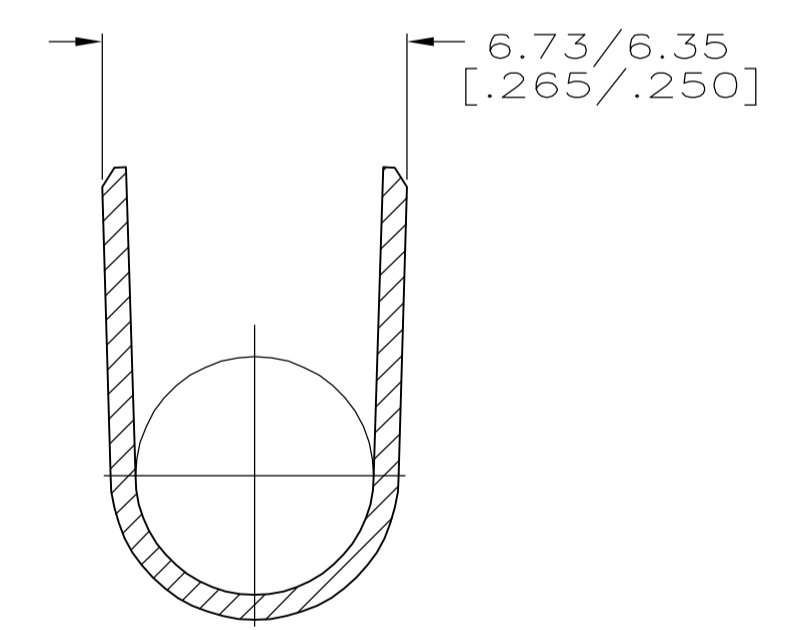

SECTION B-B
ROTATED 90° CCW

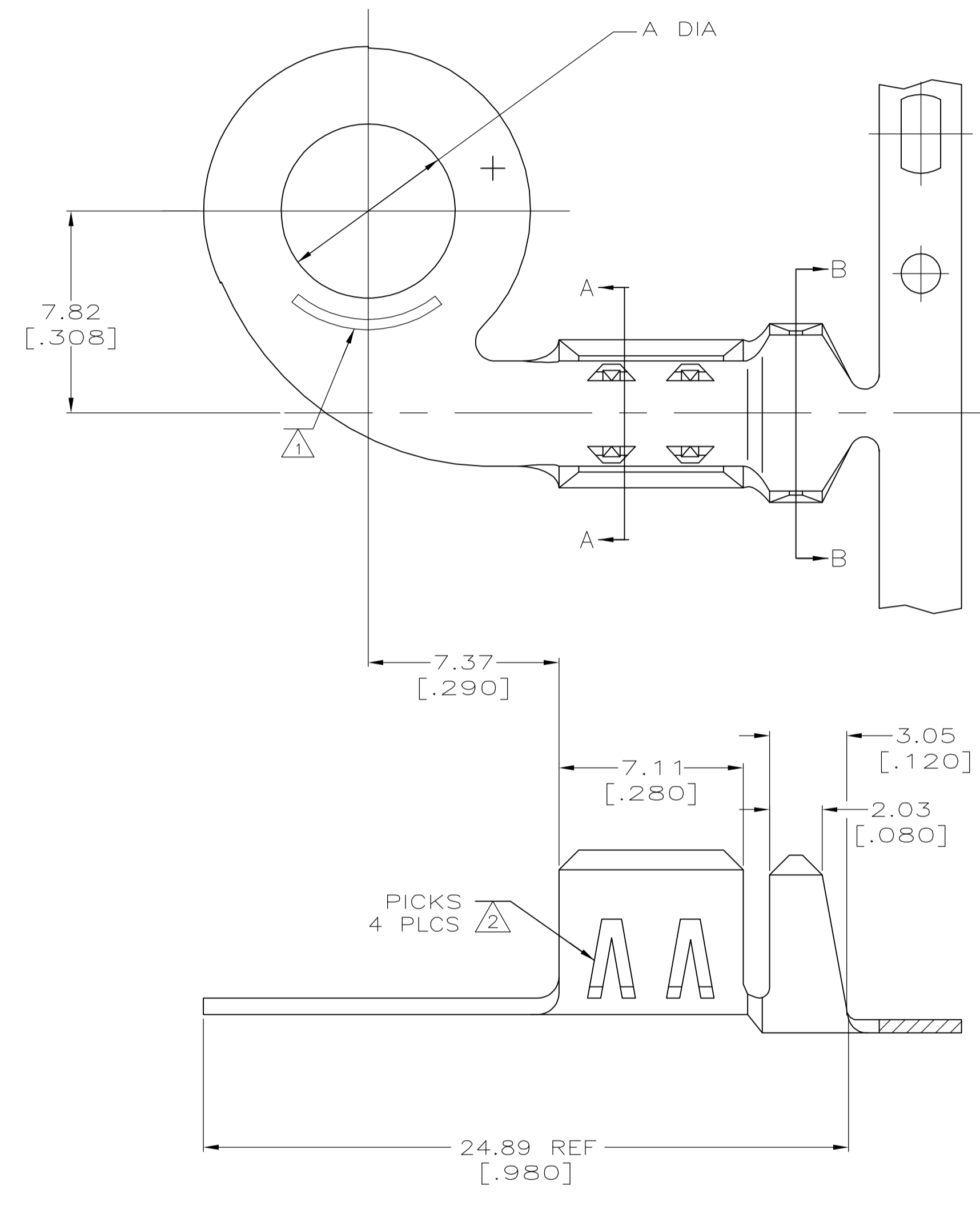

| | | | | |
|----------|--------|---------------|------------|-------------|
| | ⑤ | WITH PICKS | 4.34[.171] | 9-226619-1 |
| | ⑤ | WITH PICKS | 6.35[.250] | 9-226619-0 |
| OBSOLETE | ④ | WITHOUT PICKS | 4.34[.171] | 2-226619-1 |
| OBSOLETE | ④ | WITHOUT PICKS | 6.35[.250] | 2-226619-0 |
| OBSOLETE | ④ | WITH PICKS | 4.34[.171] | 226619-3 |
| OBSOLETE | ④ | WITH PICKS | 6.35[.250] | 226619-1 |
| | FINISH | ② | A DIM | PART NUMBER |

THIS DRAWING IS A CONTROLLED DOCUMENT.

| | | | |
|--------------------------------|--|-------------------------|---|
| DIMENSIONS: INCHES | TOLERANCES UNLESS OTHERWISE SPECIFIED: | DIN J.DAVIS 29/APR/93 | tyco Electronics Tyco Electronics Corporation Harrisburg, Pa 17105-3608 |
| 0 PLC ± - | 1 PLC ± - | CHK G.MICHAEL 29/APR/93 | NAME |
| 2 PLC ± ± 0.20[.008] | 3 PLC ± ± - | APVD | PRODUCT SPEC |
| 4 PLC ± ± - | ANGLES ± ± - | | APPLICATION SPEC |
| MATERIAL BRASS, 0.51[.020] THK | FINISH | SIZE A1 | WEIGHT |
| | | CAGE CODE 00779 | DRAWING NO. 226619 |
| | | CUSTOMER DRAWING | RESTRICTED TO |

SCALE 1:1 SHEET 1 OF 1 REV J1