

LEAD FREE  
PLATING

MATERIAL NUMBER ASSIGNMENT

74026 - 6 \* \* 0 SEE NOTE 2. & 3.

BLADE 1 MATING LENGTH	BLADE 2 MATING LENGTH
1 = 7.5 mm	1 = 7.5 mm
2 = 9.0 mm	2 = 9.0 mm
3 = 10.5 mm	3 = 10.5 mm
4 = 12.0 mm	4 = 12.0 mm
6 = 7.5 mm	6 = 7.5 mm
7 = 9.0 mm	7 = 9.0 mm
8 = 10.5 mm	8 = 10.5 mm
9 = 12.0 mm	9 = 12.0 mm

1 = 7.5 mm  
2 = 9.0 mm  
3 = 10.5 mm  
4 = 12.0 mm  
6 = 7.5 mm  
7 = 9.0 mm  
8 = 10.5 mm  
9 = 12.0 mm

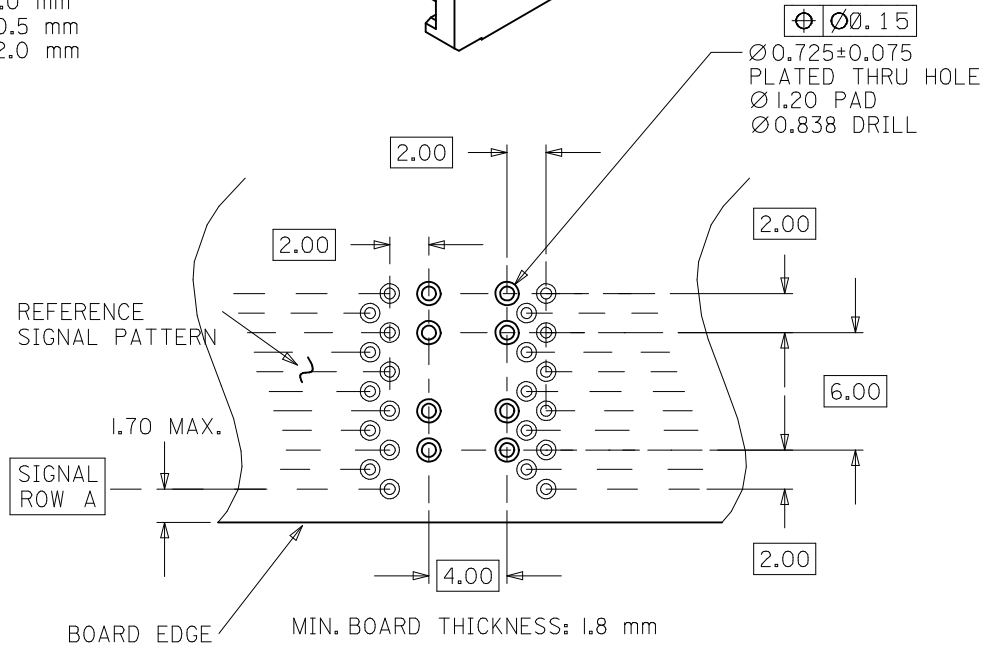
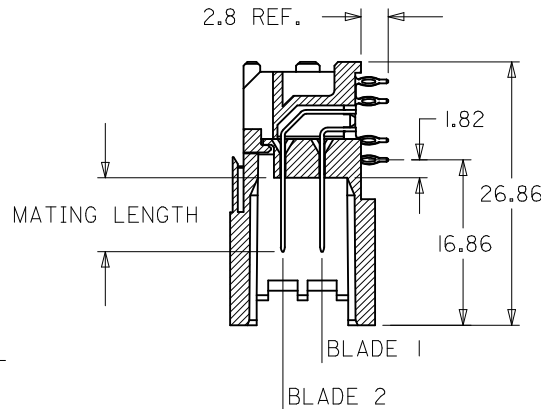
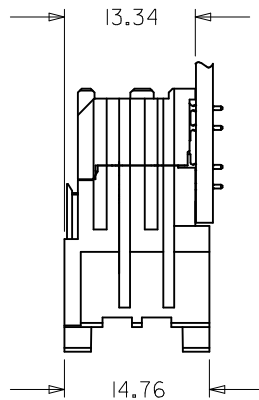
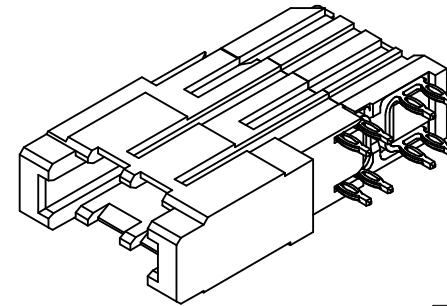
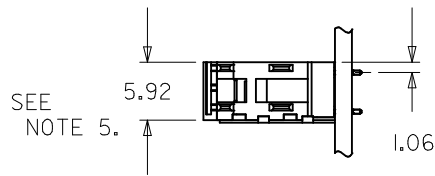

NOTES:

- MATERIALS: HOUSING : LIQUID CRYSTAL POLYMER (LCP)  
GLASS-FILLED, UL94V-0, BLACK.  
TERMINALS: COPPER ALLOY
- FINISH: SELECTIVE GOLD (Au) 0.76 MICROMETERS MINIMUM  
IN CONTACT AREA, SELECTIVE MATTE TIN (Sn) IN TAIL AREA,  
NICKEL (Ni) UNDERPLATE OVERALL.  
(WHEN \* = 1, 2, 3, OR 4.)
- FINISH: SELECTIVE GOLD (Au) 1.27 MICROMETERS MINIMUM  
IN CONTACT AREA, SELECTIVE MATTE TIN (Sn) IN TAIL AREA,  
NICKEL (Ni) UNDERPLATE OVERALL.  
(WHEN \* = 6, 7, 8, OR 9.)
- PART SHOWN IS 74026-6110.
- USE 6.00 mm NOMINAL FOR DAUGHTERCARD LAYOUT.

LEAD FREE CONVERSION  
EC NO: UCP2013-3429  
DRAWN: RWHIPPLE 2013/02/13  
CHKD: MWOLFE 2013/02/13  
APPR: SMILLER 2013/03/04

QUALITY SYMBOLS  
▽=0  
▽=0  
▽=0

GENERAL TOLERANCES (UNLESS SPECIFIED)	
mm	INCH
4 PLACES	± --- ± ---
3 PLACES	± --- ± ---
2 PLACES	± 0.13 ± ---
1 PLACE	± 0.25 ± ---
0 PLACE	± --- ± ---

ANGULAR ±1/2°  
DRAFT WHERE APPLICABLE  
MUST REMAIN WITHIN DIMENSIONS

DIMENSION STYLE MM ONLY	
DRAWN BY	DATE
RWHIPPLE	2013/02/13
CHECKED BY	DATE
BREARLEY	98/10/21
APPROVED BY	DATE
SMILLER	2013/03/04

SCALE NONE	DESIGN UNITS METRIC	THIRD ANGLE PROJECTION
<b>VHDM POWER 6 ROW DAUGHTERCARD SALES ASSEMBLY</b>		
MATERIAL NO.	DOCUMENT NO.	SHEET NO.
SEE CHART	SD-74026-001	1 OF 1