

## MATERIAL

Weldable black-oxide steel.

## HANDLE

Polyurethane, red colour.

## APPLICATIONS

ALL. accessories are designed to optimise use of toggle-joint mechanisms.

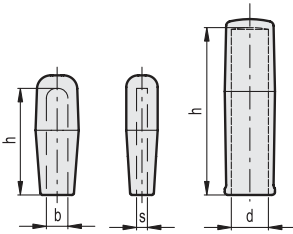

METRIC

### ALL.I

Code	Description	b	d	h	s	⚖
GG.AU151	ALL.I-55	13	-	55	5	12
GG.AU154	ALL.I-77	20	-	77	8	34
GG.AU156	ALL.I-112	-	22	112	-	50
GG.AU157	ALL.I-112/25	-	25	112	-	110

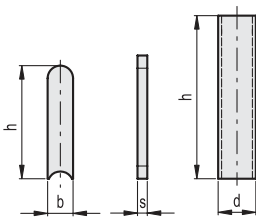

METRIC

### ALL.LC

Code	Description	b	d	h	s	⚖
GG.AU250	ALL.LC01	13	-	63	5	31
GG.AU255	ALL.LC02	20	-	90	8	108
GG.AU260	ALL.LC03	-	22	122	-	122
GG.AU265	ALL.LC04	-	25	138	-	175

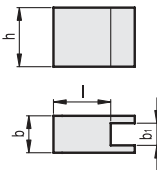

METRIC

### ALL.LS

Code	Description	b	b1	h	l	⚖
GG.AU230	ALL.LS01	10	6	16	15.5	23
GG.AU235	ALL.LS02	15	10	24	15	75.5
GG.AU240	ALL.LS03	20	12	30	22.1	130
GG.AU245	ALL.LS04	25	16.2	35	23.5	160

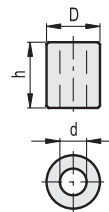

METRIC

### ALL.LM

Code	Description	D	d	h	⚖
GG.AU280	ALL.LM01	13	6.5	16	13
GG.AU285	ALL.LM02	20	10.5	24	42
GG.AU290	ALL.LM03	24	12.5	30	76
GG.AU295	ALL.LM04	32	16.5	35	120

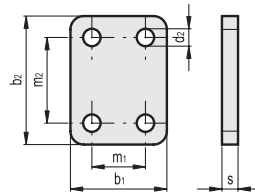

METRIC

### ALL.PB

Code	Description	b1	b2	d2	m1	m2	s	⚖
GG.AU300	ALL.PB01	36	48	6.5	20	32	6	74
GG.AU305	ALL.PB02	54	65	8.5	30	45	8	205
GG.AU310	ALL.PB03	75	75	10.5	55	55	10	400
GG.AU315	ALL.PB04	90	100	12.5	65	65	10	400



Toggle clamps