

REV. PA1	SHEET 1 OF 3	DOCUMENT NO. 10-504639-011
M REVISIONS		
LTR	DESCRIPTION	DATE
PA1	INITIAL RELEASE	4/5/18

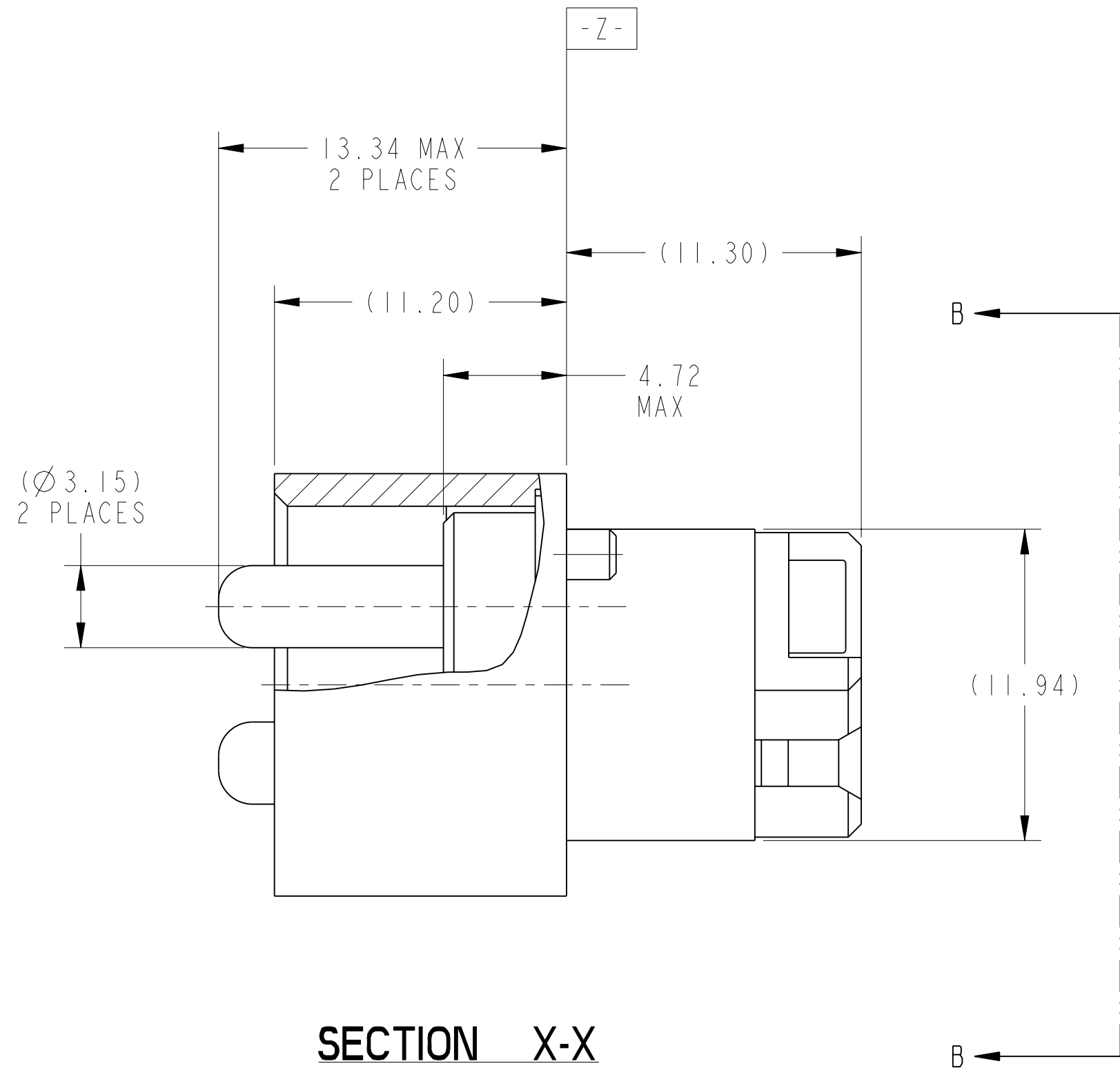
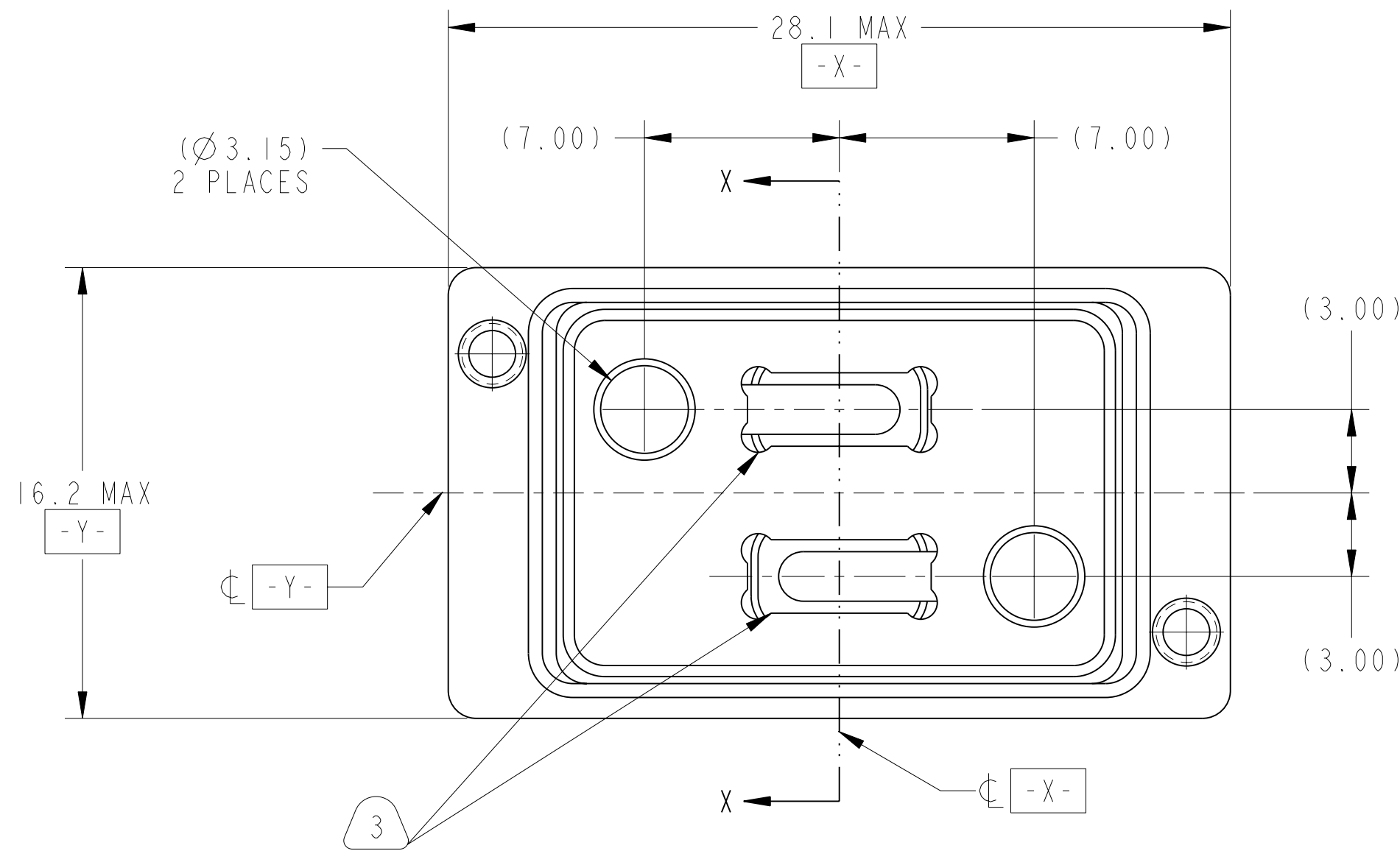
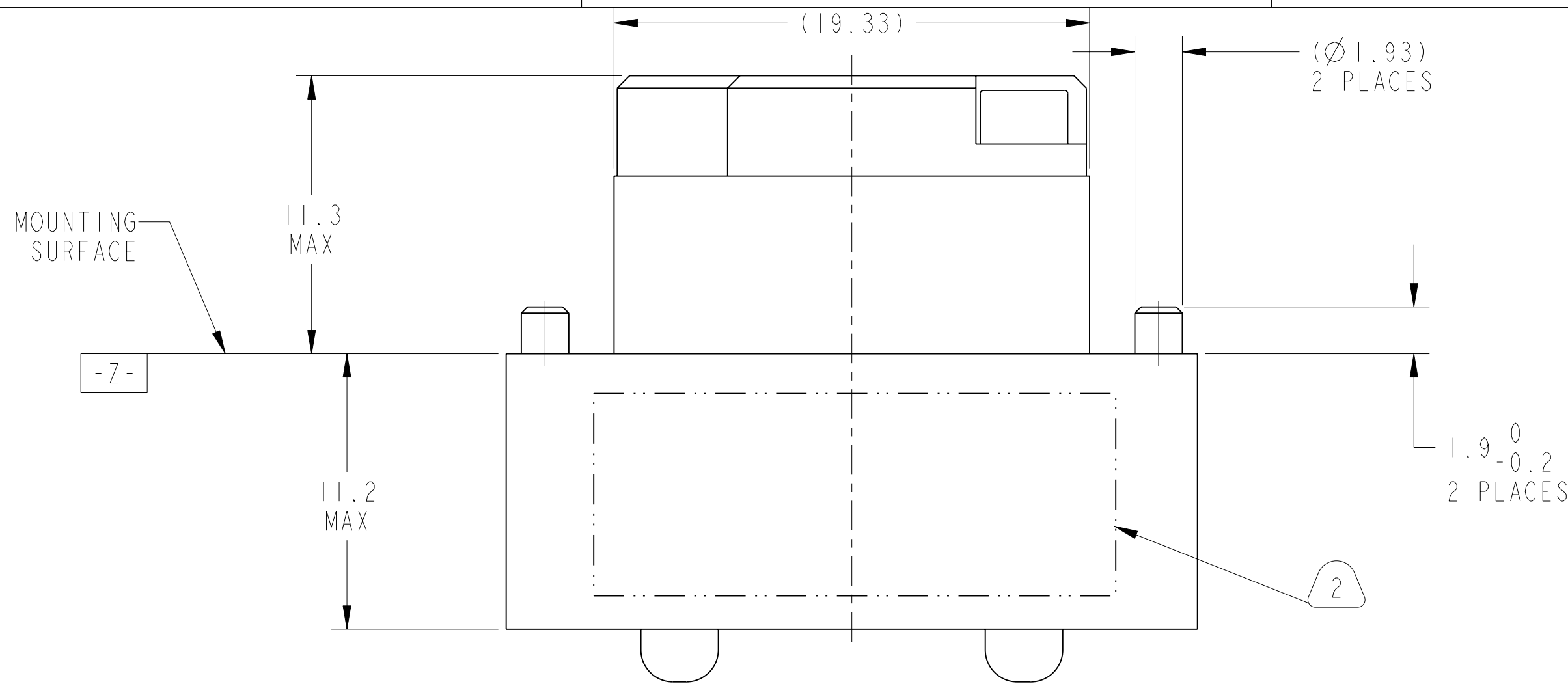

**SECTION X-X**

**METRIC DRAWING**

SEE SHEET 2

**NOTES:**

THE USE OF THIS DOCUMENT IS UNLIMITED. HOWEVER, DOCUMENTS REFERENCED HEREON MAY CONTAIN LIMITED RIGHTS DATA.

SCALE 5.000

UNLESS OTHERWISE SPECIFIED		SPECIFICATIONS		POS	QTY	PART NUMBER	DESCRIPTION	NOTE	
LINEAR DIMENSIONS ARE IN MILLIMETERS TOLERANCES: .XXXX = ±NA ANGLES= ±2° .XXX = ±NA .XX = ±.13 .X = ±.25		MATERIAL SPEC. NONE		APPROVALS		DATE	PARTS LIST		
DIM. & TOL. PER ASME Y14.5M; DRM PER MIL-DTL-31000; OTHER Amphenol Sds. PER 9-3800		PROCESS SPEC. 9-3856-5 9-3895		PREPARED BY R. CHAPMAN		05-Apr-18	<b>AMPHENOL CORPORATION</b> 40-60 DELAWARE AVENUE SIDNEY, N.Y. 13838		
LEGENDS: = FLAG NOTE CALL OUT REFERENCE ONLY		THIRD ANGLE PROJECTION		ENGINEER IN CHARGE E. HICKEY			<b>CONNECTOR, FIBER OPTIC, BACKPLANE, 2 MT SPECIAL, SPRING LOADED (VITA 66.1 ENVELOPE)</b>		
				DESIGN MANAGER R. SELFRIDGE			SIZE <b>C</b>	CAGE CODE <b>77820</b>	DOCUMENT NO. <b>10-504639-011</b>
NEXT ASSEMBLY		PRO/ENGINEER INFORMATION Pro/e Model Used: 10-504639-011.DWG.ASSEM Drawing Name: 10-504639-011		DESIGN ACTIVITY GROUP BLP		SCALE: 2.0 REF: 10-504639-002		SHEET 1 OF 3	

DOCUMENT NO. 10-504639-011

SHEET 1 OF 3

REV. PA1

C

B

A

D

C

REV. PA1

SHEET 1 OF 3

DOCUMENT NO. 10-504639-011

A

U

DOCUMENT NO. 10-504639-011

SHEET 1 OF 3

REV. PA1

4

3

2

1

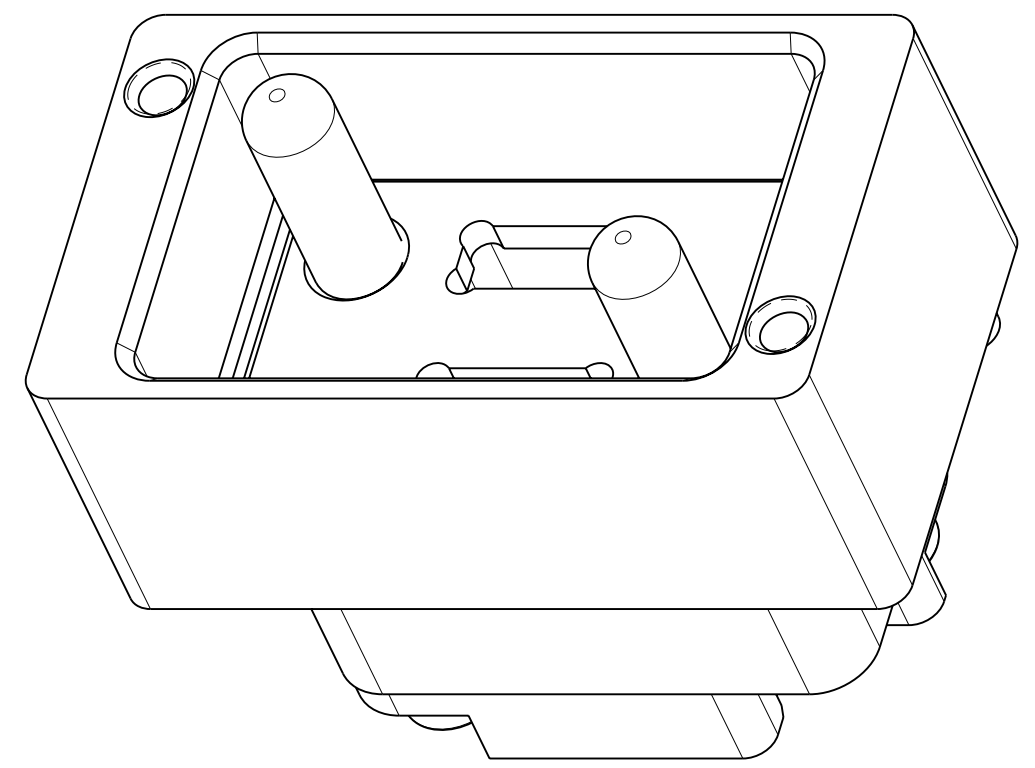
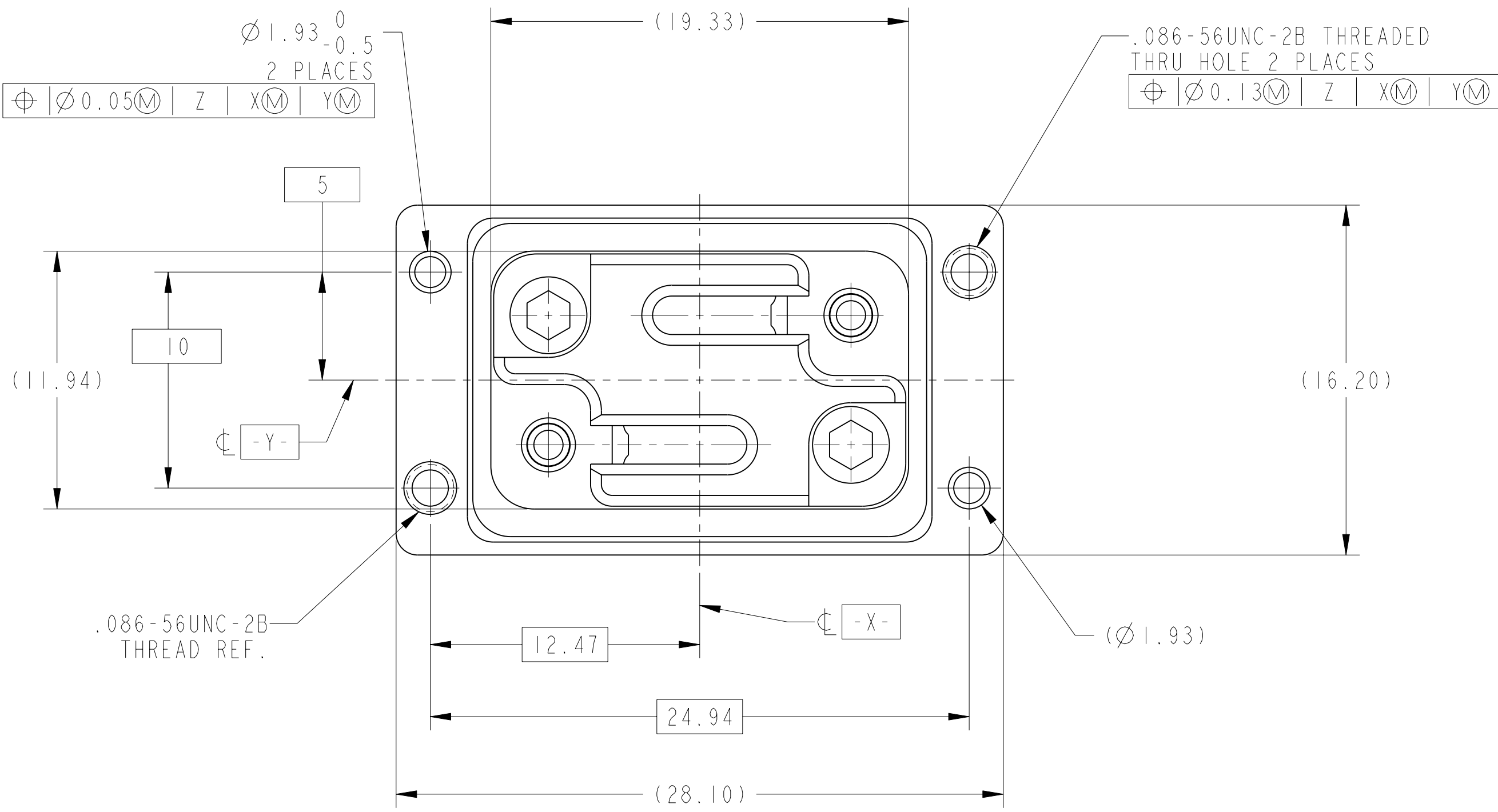

TOP ISO VIEW  
SCALE 4.000

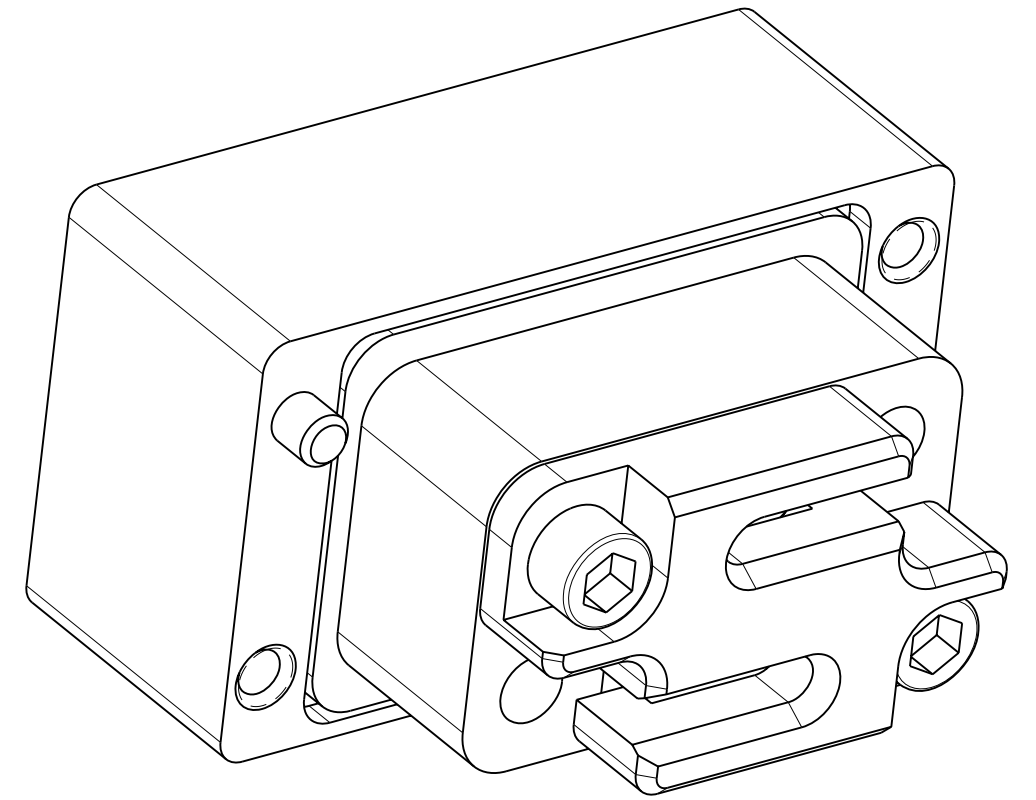

BOTTOM ISO VIEW  
SCALE 4.000

- VIEW AT B**
7. FOR CONNECTOR INSTALLATION ILLUSTRATION SEE SHEET 3.
  6. FOR MATING MODULE CONNECTOR ASSEMBLY, SEE DRAWING 10-504637-013.
  5. TIGHTEN CAPTIVE SCREWS TO 10-14 IN-OZ AFTER INSTALLING MT FERRULE (NOT INCLUDED).
  4. FIBER OPTIC INSERT IS DESIGNED FOR MT TYPE FERRULES TERMINATED TO NON-STRENGTH MEMBERED RIBBON CABLE. MT FERRULES, PIN CLAMP ASSEMBLIES AND ASSOCIATED RIBBON CABLE ARE NOT PART OF THIS ASSEMBLY.
  3. INDICATED CAVITIES WILL ACCOMODATE A STANDARD 12 CHANNEL MT FERRULE PER IEC 61754-5 (SEE NOTE 4).
  2. BLACK INK STAMP "AMPH", 77820, PART NUMBER AND DATE CODE ON INDICATED SURFACE PER 9-3856-5. DATE CODE PER 9-3895. CHARACTERS TO BE 1.6±.51 (.062±.020) HIGH. ADDITIONAL INFORMATION MAY BE REQUESTED BY PURCHASE ORDER.
  1. PARTS ARE SHIPPED UNASSEMBLED.

**MATERIALS AND FINISHES**

COMPONENT	MATERIAL/ FINISH
BACKPLANE SHELL	BODY - MATERIAL - ALUM. ALLOY PER AMS 4150 FINISH - CHROMATE TREATMENT PER MIL-C-5541, CL 3 HELICAL INSERTS - STAINLESS STEEL 304 SERIES PASSIVATED
INSERT ASSEMBLY	FRONT INSERT/RETAINER - MATERIAL - ALUM ALLOY PER AMS 4150 FINISH - CHROMATE TREATMENT PER MIL-C-5541, CL3 SCREW - STAINLESS STEEL 300 SERIES, PASSIVATED HELICAL INSERTS - STAINLESS STEEL 304 SERIES, PASSIVATED

THE USE OF THIS DOCUMENT IS UNLIMITED. HOWEVER, DOCUMENTS REFERENCED HEREON MAY CONTAIN LIMITED RIGHTS DATA.

SIZE <b>C</b>	CAGE CODE <b>77820</b>	DOCUMENT NO. <b>10-504639-011</b>	REV. <b>PA1</b>
SCALE: 2.0	REF. 10-504639-002	SHEET 2 OF 3	

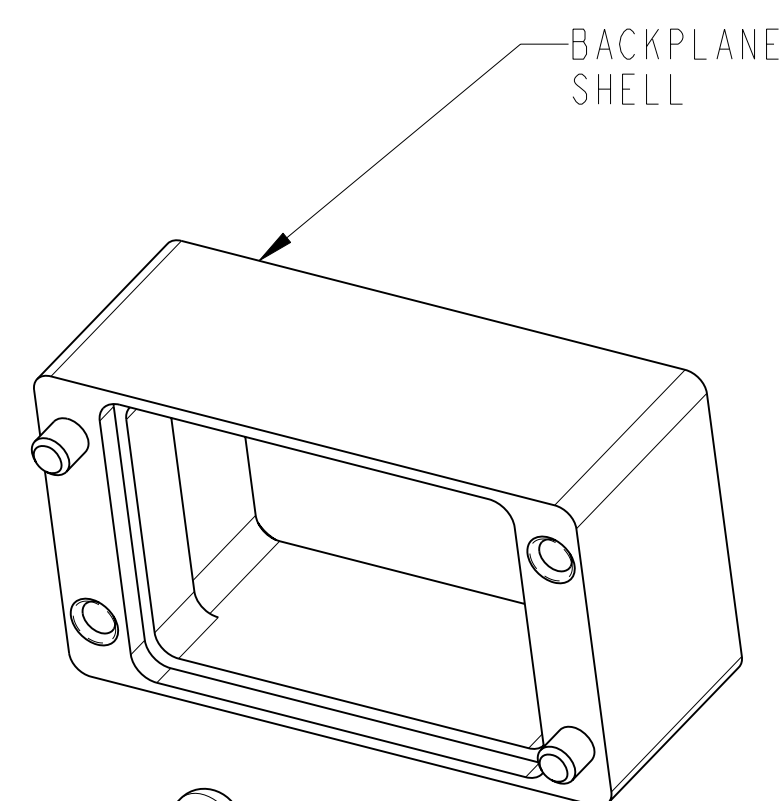
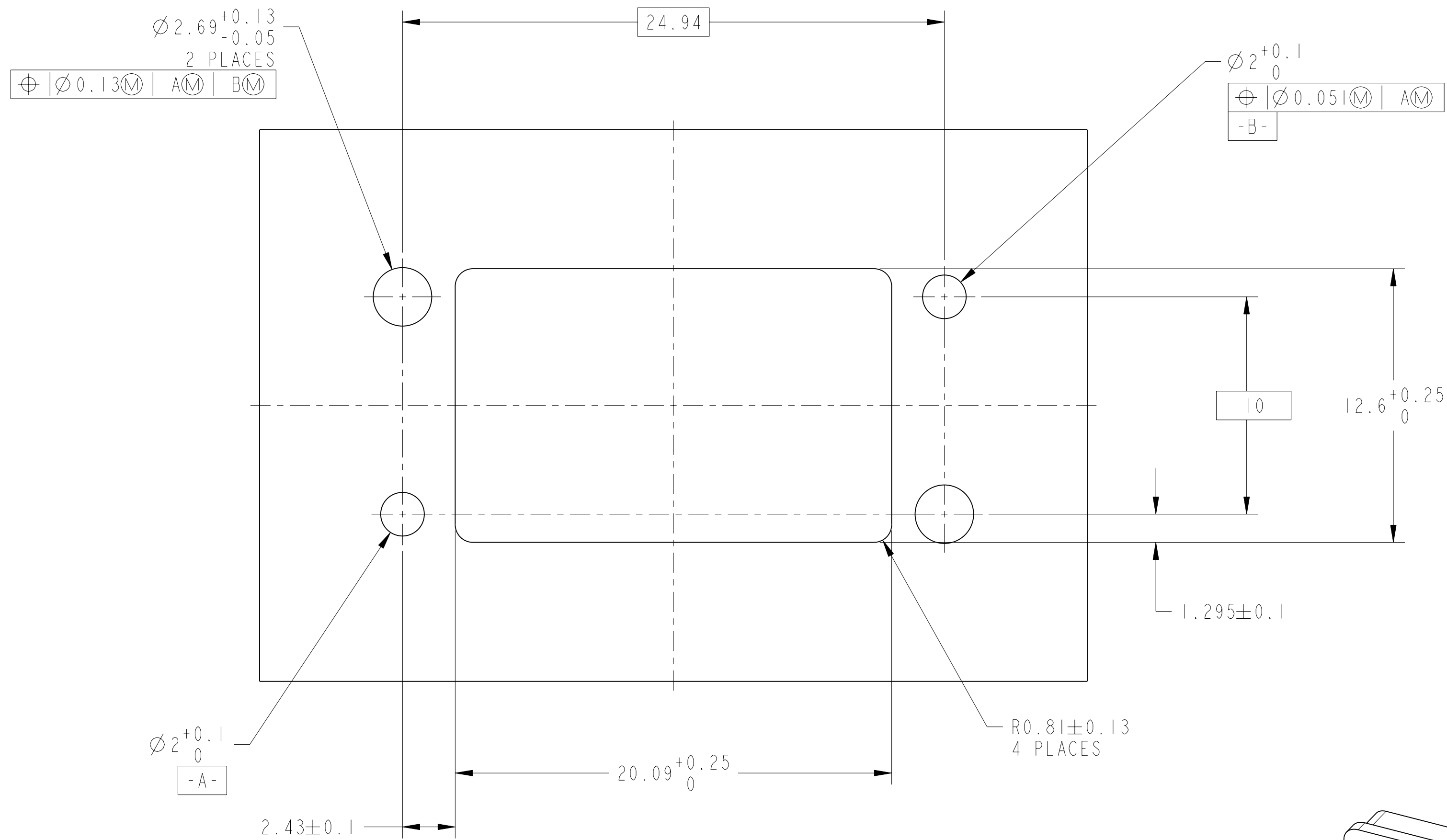

**SUGGESTED BACKPLANE BOARD CUTOUT**

(CONNECTOR SIDE SHOWN)

SCALE 6.000

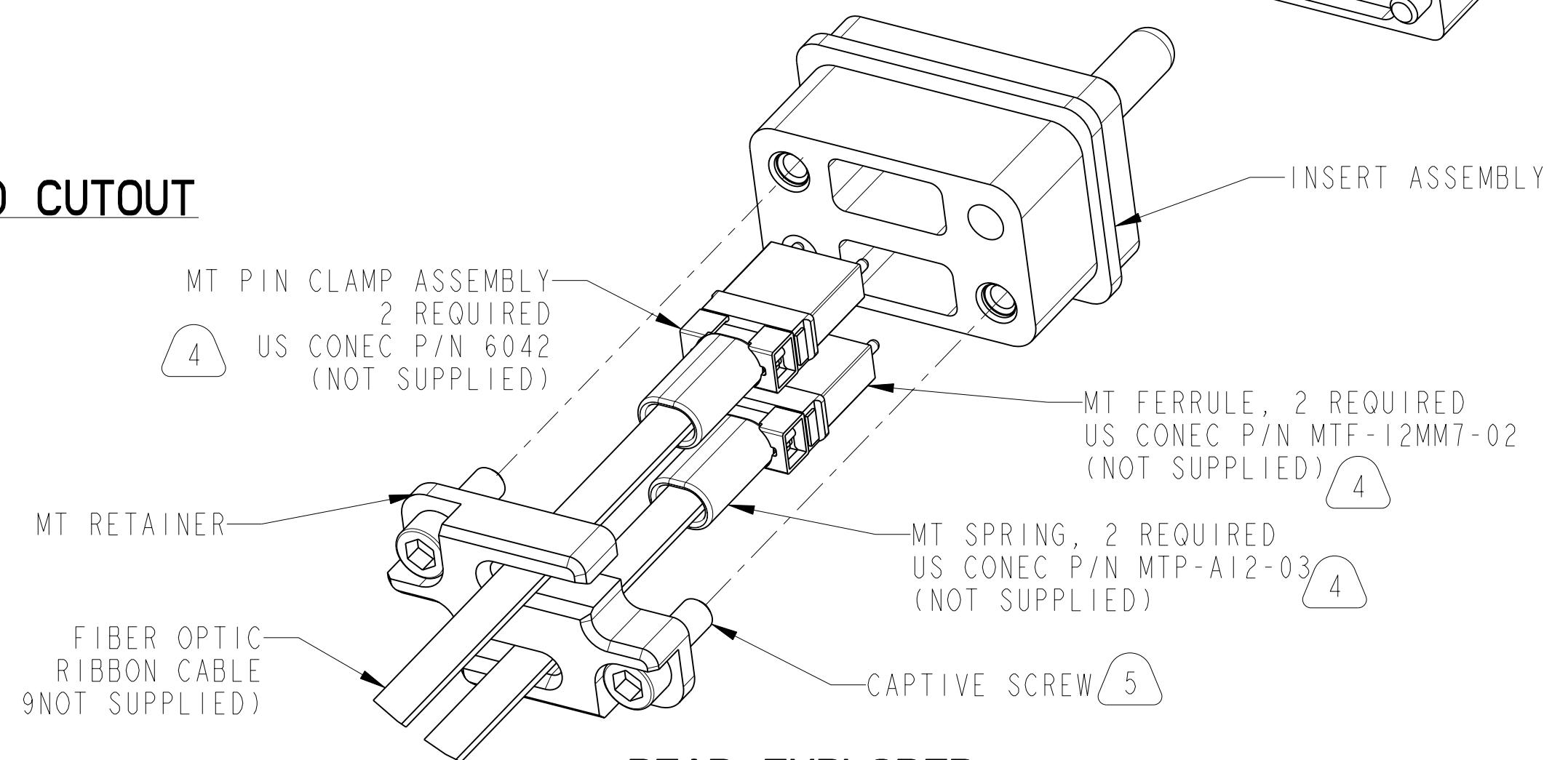

**REAR EXPLODED ASSEMBLY VIEW**

SCALE 3.000

THE USE OF THIS DOCUMENT IS UNLIMITED. HOWEVER, DOCUMENTS REFERENCED HEREON MAY CONTAIN LIMITED RIGHTS DATA.

SIZE <b>C</b>	CAGE CODE <b>77820</b>	DOCUMENT NO. <b>10-504639-011</b>	REV. <b>PA1</b>
SCALE: 2.0	REF. 10-504639-002	SHEET 3 OF 3	