

Ansicht mit Kappe.
 Hebel in Endraststellung.
 Die Kappe ist ein separates
 Verkaufsteil.

VIEW WITH COVER, LEVER
 IN END LOCK POSITION.
 THE COVER IS A SEPARATE
 SALES PART.

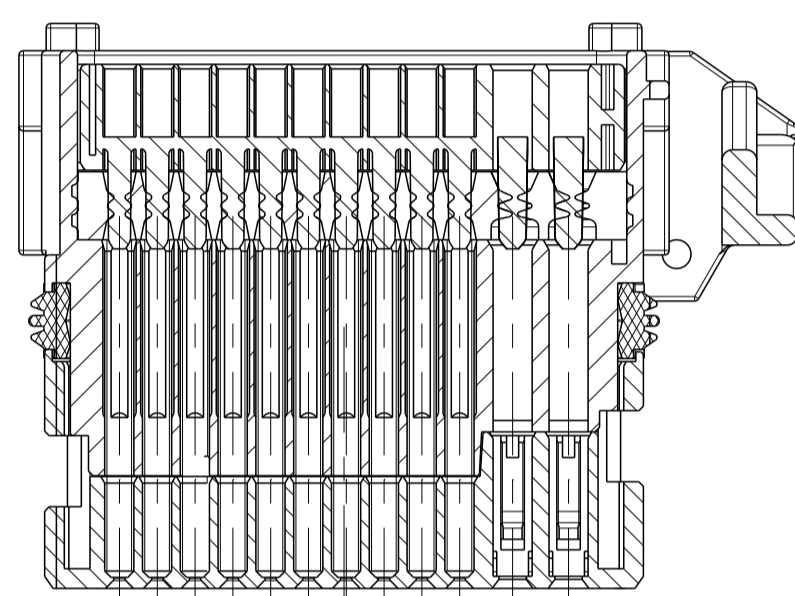

A-A

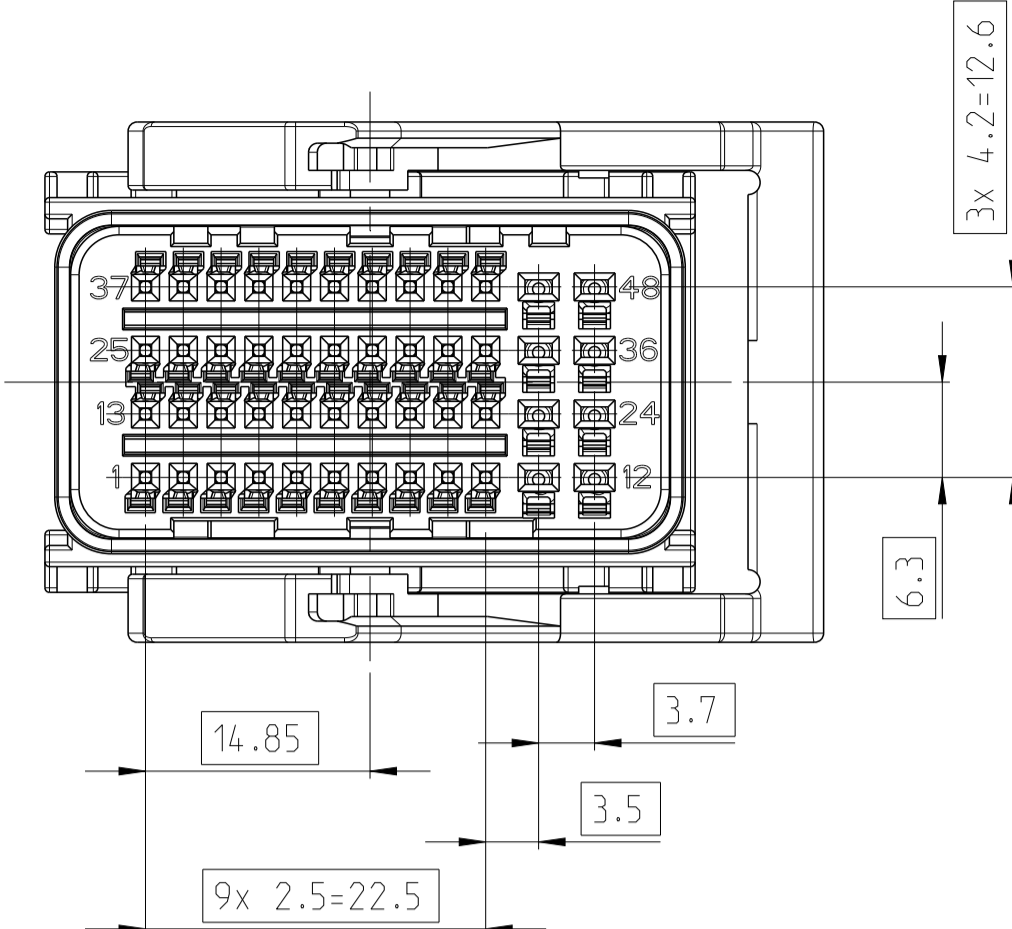
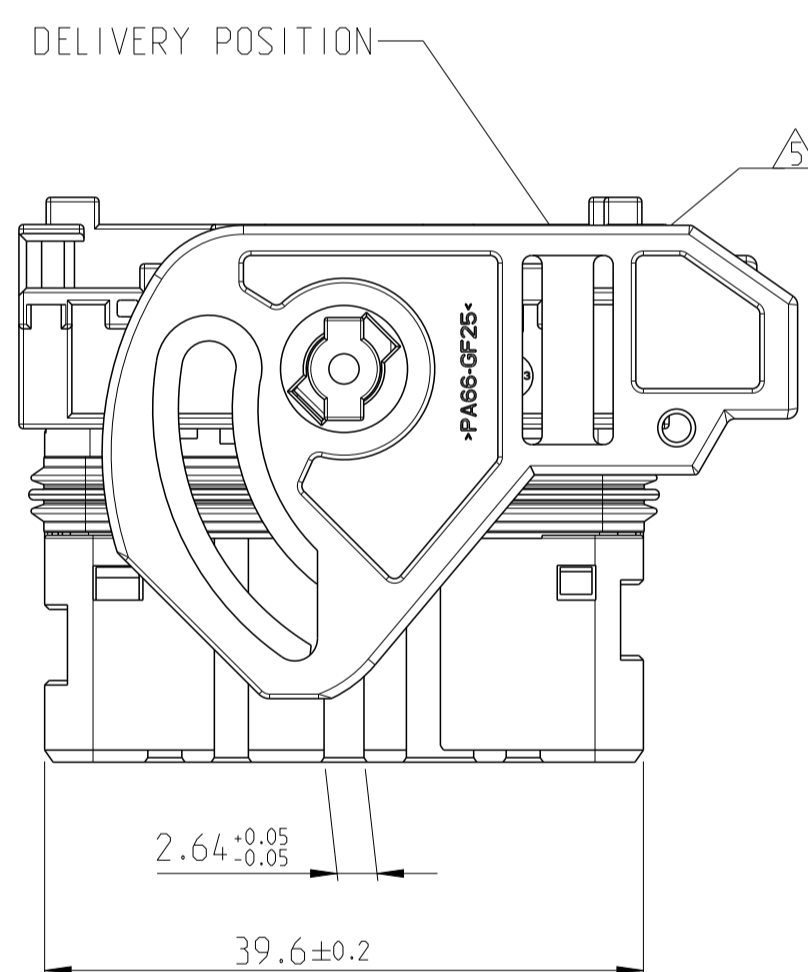

DELIVERY POSITION

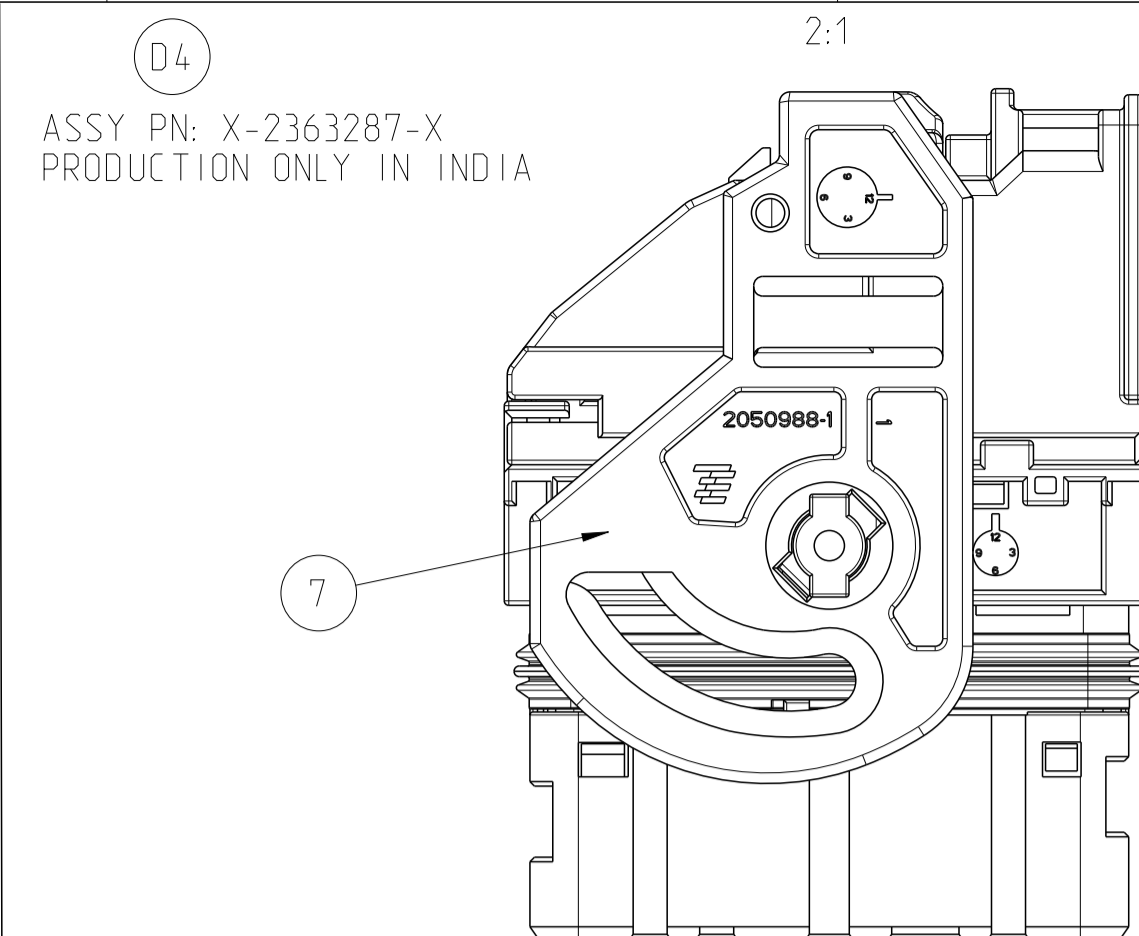

PARTS MUST CONFORM TO USCAR 2, REV. 4
 Teile entsprechen USCAR 2, Rev. 4

CONNECTOR MATING / UNMATING FORCES MAX. 75N
 Steckkraft / Oeffnungskraft max. 75N

SEALING FUNCTION REQUIRES ONLY FOLLOWING
 WIRE SIZE DIAMETERS FOR THE TERMINALS:
 Zur Sicherstellung der Dichtigkeit duerfen folgende
 Drahtquerschnitte bei den Kontakten verwendet werden:

SIGNAL TERMINAL: 0.35mm² - 0.75mm² WITH CABLE OD ϕ 1.2 - 1.9mm
 POWER TERMINAL: 0.5mm² - 1.5mm² WITH CABLE OD ϕ 1.4 - 2.4mm

4 MATED WITH:
 Passend zu:

COVER 0-1719671-1, 0-2112228-1
 2-NDRY LOCK 0-1719661-1
 2-NDRY LOCK 0-1719668-1

Kappe 0-1719671-1, 0-2112228-1
 2te Kontaktsicherung 0-1719661-1
 2te Kontaktsicherung 0-1719668-1

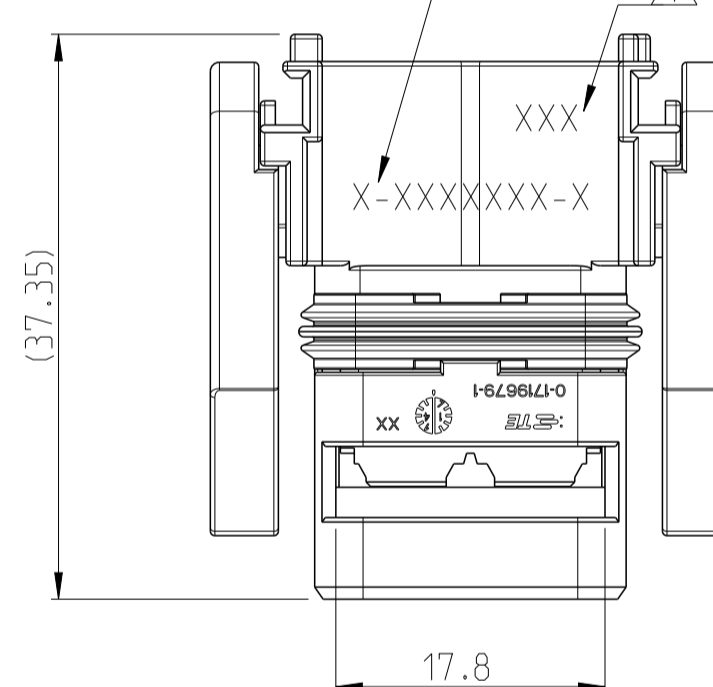

LEVER IN PRE-LOCK POSITION
 Hebel in Vorraststellung

MARKING WITH TE PN. SEE
 PINOUTCONFIGURATION ON DRAWING 1670068
 Markierung fuer TE PN. siehe
 Pinoutkonfigurations-tabelle auf Zeichnung 1670068

A THREE DIGIT MARKING ACCORDING
 TABLE ON DRAWING 1670068 LOCATED
 ON SIDE OF THE FEMALE HOUSING
 Eine dreistellige Markierung gemass
 Tabelle wie auf Zeichnung 1670068
 auf der Seite des Kontaktgehueses

8 INTERFACE SPECIFICATION: 114-18762
 Schnittstellen Spezifikation: 114-18762

**PIN-OUT CONFIGURATION
 SEE DRAWING 1670068**

TERMINALS						
	PRE-TIN	WIRE SIZE (mm ²)	WIRE SIZE DIAMETER (mm)	WIRE SIZE DIAMETER (mm)	FINISH	NOTES
TERMINALS TE PN	TE Kontakt PN	WIRE SIZE (mm ²)	Drahtquerschnitt (mm ²)	Kabeldurchmesser	Oberflaeche	Bemerkungen
968220-1	968221-1	0.35 - 0.5	ϕ 1.20 - 1.60	BLINDPLUG: PN 1394871-1 Blindstopfen: PN 1394871-1		
638652-2	638652-1	0.5 - 1.00	ϕ 1.40 - 2.10	BLINDPLUG: PN 1670108-1 Blindstopfen: PN 1670108-1		
		1.0 - 1.5	ϕ 1.90 - 2.40			

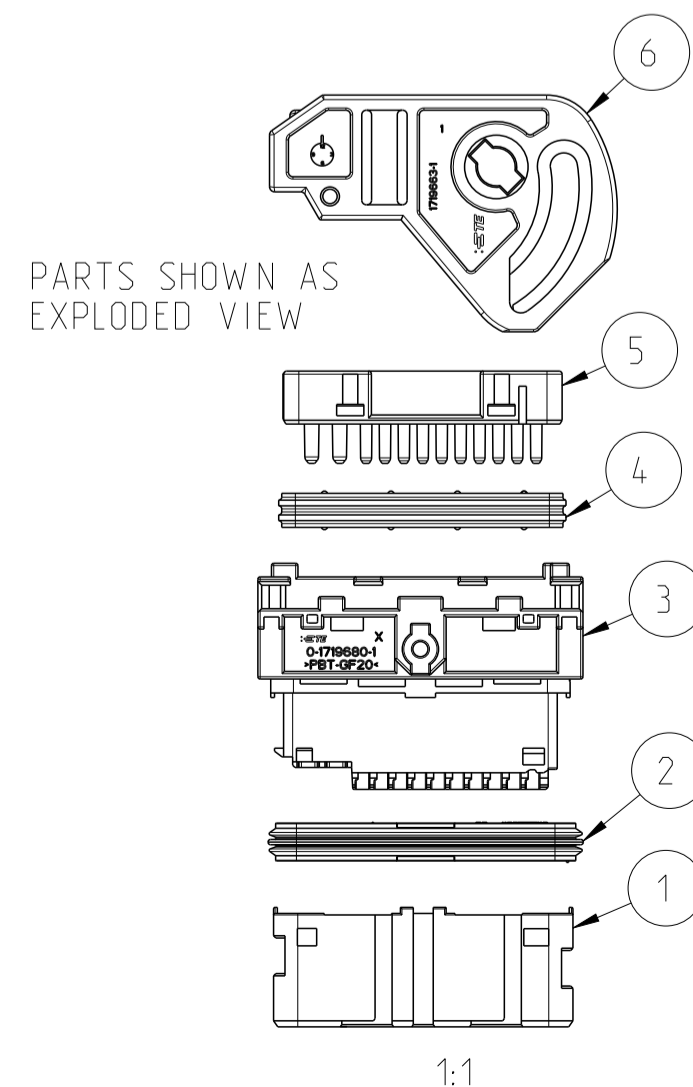

PARTS SHOWN AS
 EXPLODED VIEW

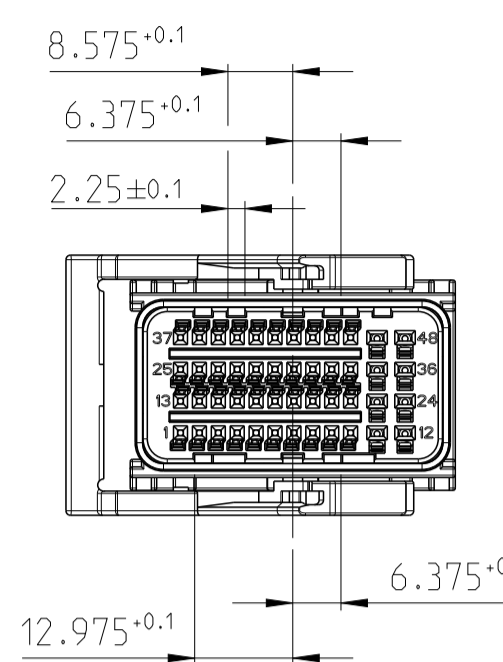
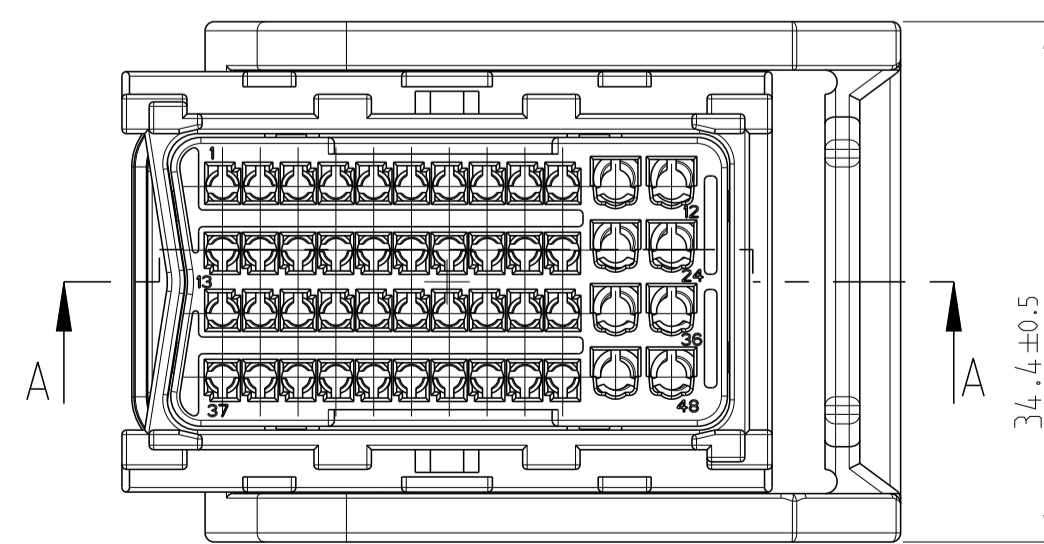

**CODING 1
 BLACK
 LEVER LEFT
 CABLE EXIT RIGHT
 PN 1719678 / 2177513 /
 2288260**

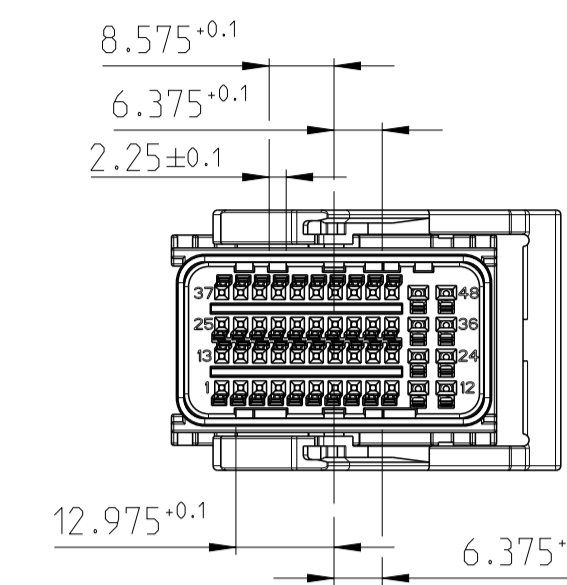

**CODING 1
 BLACK
 LEVER RIGHT
 CABLE EXIT LEFT
 PN 1670068 / 2177656 /
 2288259**

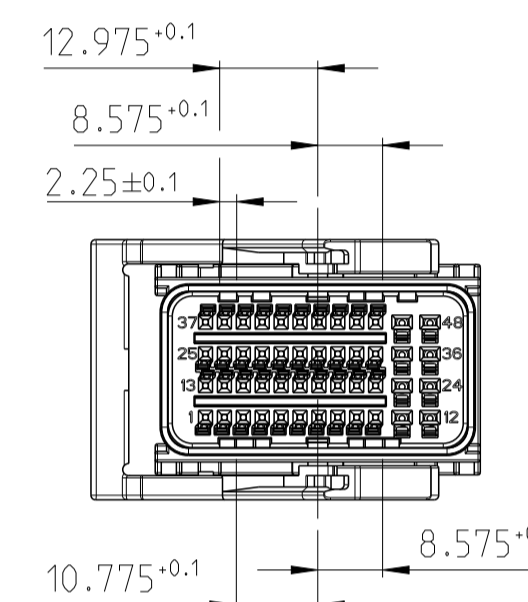

**CODING 2
 GREY
 LEVER LEFT
 CABLE EXIT RIGHT
 PN 1719683 / 2177527 /
 2288258**

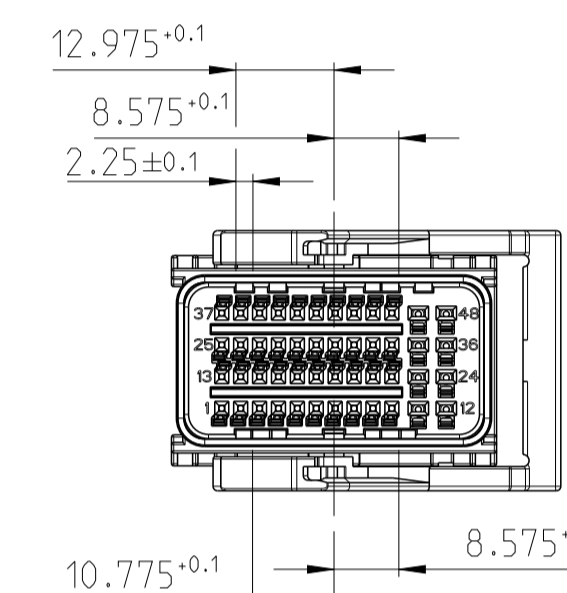

**CODING 2
 GREY
 LEVER RIGHT
 CABLE EXIT LEFT
 PN 1670069 / 2177514 /
 2288257**

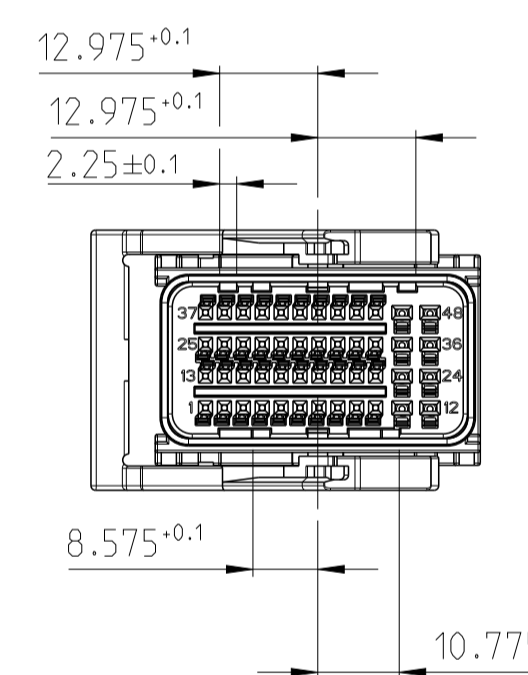

**CODING 3
 BROWN
 LEVER LEFT
 CABLE EXIT RIGHT
 PN 1418416 / 2177531 /
 2288256 / 2363287**

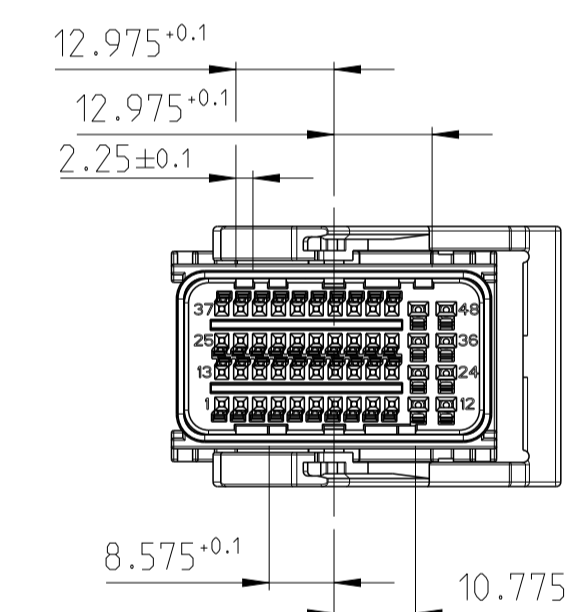

**CODING 3
 BROWN
 LEVER RIGHT
 CABLE EXIT LEFT
 PN 1670067 / 2177543 /
 2288254**

1	1	1	1	1	1	1	1	1	1	1	1	1
PA66-GF30	PA66-GF25	PA66-GF25	PBT-GF20	MVQ	PBT-GF20	PA66-GF35	PA66-GF35	PA66-GF35				
LEVER LEFT SIDE	LEVER LEFT SIDE	LEVER RIGHT SIDE	COVER FOR FAMILY SEAL	FAMILY SEAL	48 pos. (UPPER PART)	48 pos. (LOWER PART)	48 pos. (LOWER PART)	48 pos. (LOWER PART)				
NATURAL	NATURAL	NATURAL	BLACK	LIGHT BLUE	BLACK	NATURAL	GREY	BLACK				

1670068 AS SHOWN
 1670068 wie gezeichnet

THIS DRAWING IS A CONTROLLED DOCUMENT. 10MAY2006
 DWN: M. Kressmann, CHK: K. Roth, APVD: S. Mumber, 23JUL2007

DIMENSIONS: mm, TOLERANCES UNLESS OTHERWISE SPECIFIED:
 0 PLC ±0.3, 1 PLC ±0.3, 2 PLC ±0.3, 3 PLC ±0.3, 4 PLC ±0.3

MATERIAL: -, FINISH: -

WEIGHT: -, CUSTOMER DRAWING: -

TE Connectivity
 NAME: 48POS. MIXED RECEPTACLE HOUSING 40xMQS AND 8x1.5
 SIZE: 114-18761-1, CAGE CODE: 00779, DRAWING NO: C=1719678, SHEET 1 OF 1, REV 04