

THIS DRAWING IS UNPUBLISHED. RELEASED FOR PUBLICATION
 © COPYRIGHT - TE Connectivity ALL RIGHTS RESERVED.

REVISIONS					
P	LTR	DESCRIPTION	DATE	DWN	APVD
L		REVISED PER ECO-18-012589	13AUG2018	TZ	DZ

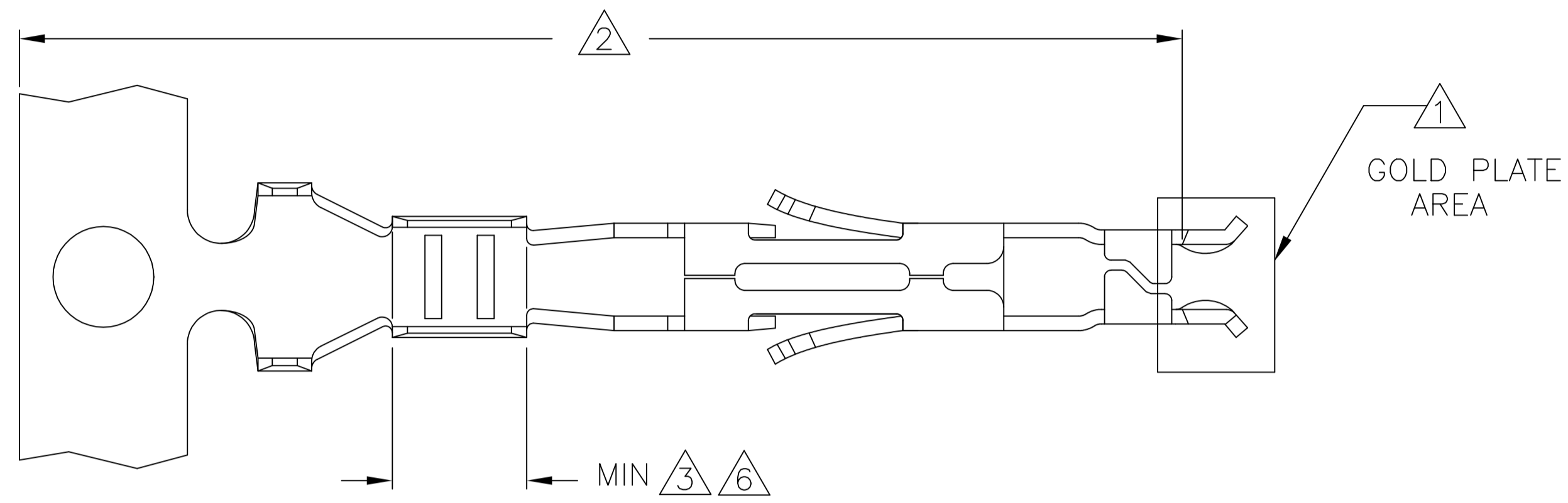

- ① FINISH: 0.76μm MIN GOLD OVER 1.27μm MIN NICKEL REQUIRED ON INNER SURFACE, PERMITTED ON OUTER SURFACE.
- ② FINISH: NICKEL BASE PLATE ON ALL SURFACES IN THIS AREA.
- ③ FINISH: 2.54μm MIN TIN-LEAD ON ALL SURFACES IN THIS AREA.
- 4. WIRE RANGE: 0.12-0.35mm² (26-22 AWG).
- 5. INSULATION RANGE; ø1.20-1.75 [ø.047-.069]
- ⑥ FINISH: 2.54μm MINIMUM TIN ON ALL SURFACES IN THIS AREA.

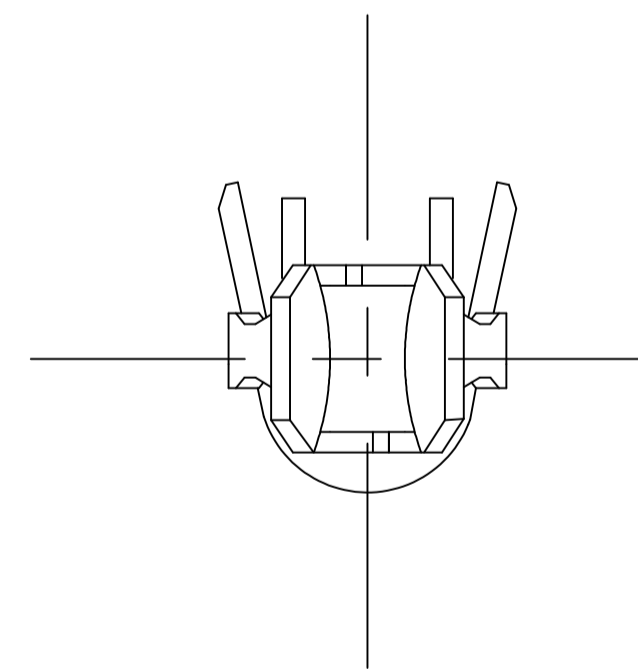
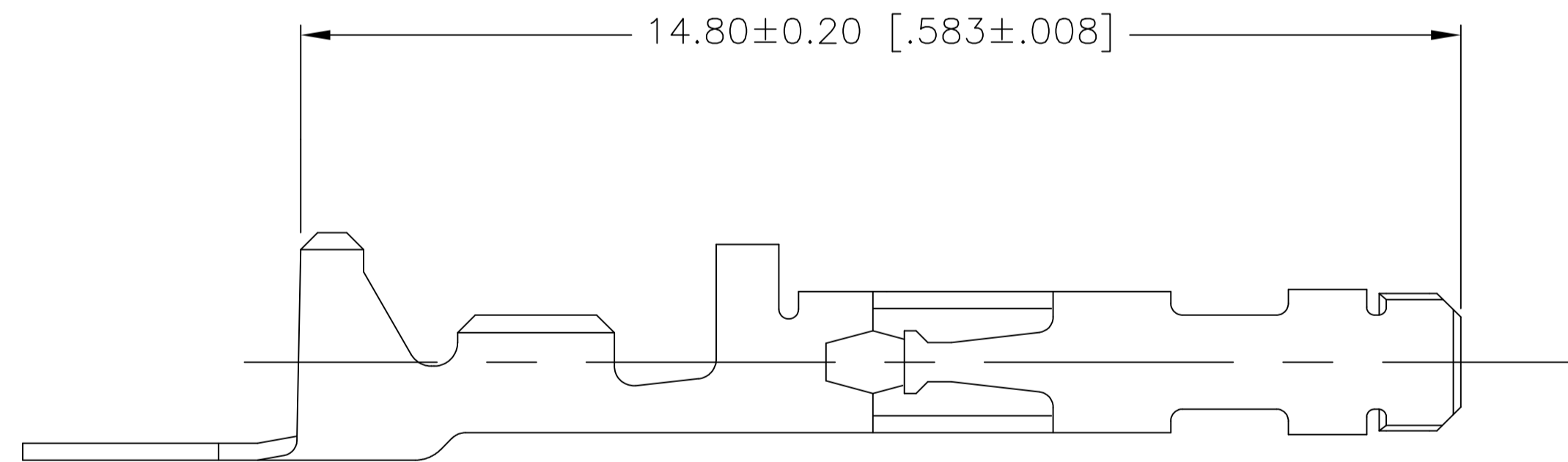

1-794142-3	①②⑥	0.22 [.009] PH BRZ	1-794139-3
794142-3	①②③	0.22 [.009] PH BRZ	794139-3
REFERENCE LOOSE PIECE	FINISH	MATERIAL	PART NUMBER

THIS DRAWING IS A CONTROLLED DOCUMENT.		DWN S. HOOVER 26-SEP-2002		
DIMENSIONS: mm		CHK D. COLEY 26-SEP-2002		
TOLERANCES UNLESS OTHERWISE SPECIFIED:		APVD D. COLEY 26-SEP-2002	NAME CONTACT, SOCKET, AMP-DUAC™ POWER CONNECTOR	
0 PLC ±		PRODUCT SPEC 108-1646	APPLICATION SPEC 114-6067	
1 PLC ±		SIZE A2		
2 PLC ± 0.10 [.004]		CAGE CODE 00779		
3 PLC ±		DRAWING NO C=794139		
4 PLC ±		RESTRICTED TO -		
ANGLES ± 0° 30'		WEIGHT 0.000000		
FINISH		SCALE 10:1		
MATERIAL		SHEET 1 of 1		
		REV L		