

Connecting the Pipe to a Ceiling Adapter

Connect this 1.5" NPT threaded pipe end to the ceiling plate

IMPORTANT! Do not loosen screws all the way when making adjustments, this may disconnect the parts and may cause injury or property damage.

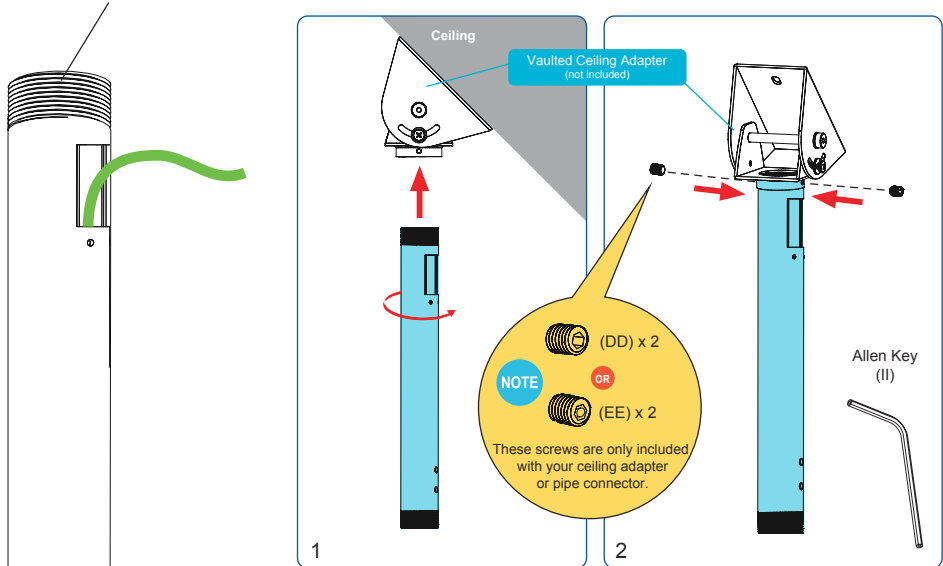

To connect the pipe to a ceiling adapter, twist the male threaded end into the female thread of the adapter.

Using allen key (II), tighten screws onto the pipe and secure the position.

Connect this 1.5" NPT threaded pipe end to the mount head

Cable Management

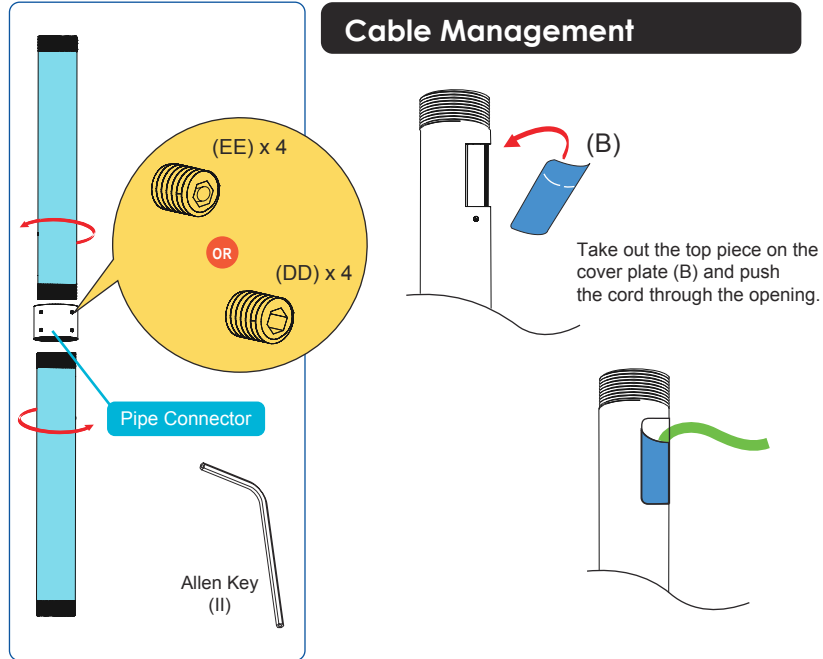

TIP

For extension longer than 3 ft connect two or more pipes together with a pipe connector (not included).



Accessories that Inspire.

INSTALLATION MANUAL

3"~3' 1.5" NPT THREADED PIPE

- QG-PRO-PM-3IN-B / W
- QG-PRO-PM-6IN-B / W
- QG-PRO-PM-1FT-B / W
- QG-PRO-PM-2FT-B / W
- QG-PRO-PM-3FT-B / W



www.qualgear.com

363kg (800lbs) RATED

CAUTION! Do not exceed the maximum rated weight specified. Otherwise, serious injury or property damage may occur.

■ 5 Year Limited Warranty

■ Version June 2016

© 2016 QualGear LLC

NOTE Please read the entire installation manual before you start installation and assembly.

WARNING

- Do not begin to install your QualGear product until you have read and understood all the instructions and warnings contained in this installation manual. If you have any questions regarding the instructions, for US customers please contact QualGear customer support via email at support@qualgear.com. For all international customers, please contact your local distributor.
- Always use an assistant or mechanical lifting equipment to safely lift and position the equipment.
- Tighten screws firmly, but do not over tighten. Over tightening can damage the items, greatly reducing their holding power.
- ALL QUALGEAR products are intended for indoor use only and any outdoor use voids the limited warranty. For warranty information, please visit:
<http://www.qualgear.com/warranty.php>
- Never exceed the maximum rated weight specified in this manual.
- All hardware must be used at the designated points in the installation instructions to prevent property damage and/or personal injury.
- This product was designed to be installed and utilized only as specified in this manual. Improper installation of this product may cause damage or serious injury. QualGear is not liable for the improper use or installation of its products.
- This product was designed to be compatible with all standard 1.5" NPT threaded pipes.
- Make sure that the supporting surface will safely support the combined load of the equipment and all attached hardware and components.



IMPORTANT: Installers must verify that the supporting surface will safely support the combined weight of the equipment and all attached hardware and components.

Maintenance

Please check that the pipe(s) are secure and safe to use at regular intervals. If you have any questions regarding any of the instructions or warnings, please contact your local distributor (OR) contact QualGear technical support via email at support@qualgear.com.

Parts & Hardware List



IMPORTANT: Before starting installation, please check that all parts shown in this checklist are included. If any parts are missing or damaged, contact your local distributor or support@qualgear.com for replacement parts and do not start assembly and installation until you receive all the parts.

MODEL (BLACK/WHITE)	LENGTH	PIPE (A)	COVER PLATE (B)
QG-PRO-PM-3IN-B/W	3"	3"	Not Included
QG-PRO-PM-6IN-B/W	6"	6"	Included
QG-PRO-PM-1FT-B/W	1'	1'	Included
QG-PRO-PM-2FT-B/W	2'	2'	Included
QG-PRO-PM-3FT-B/W	3'	3'	Included

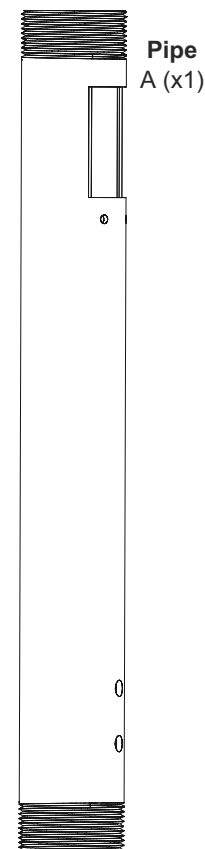

The pipe connector (sold separately) is an optional accessory that works with the pipes. Screws and allen key are hardware that are included with the pipe connector or other optional accessories such as a ceiling adapter.

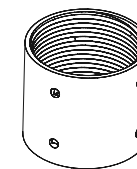

QG-PRO-PM-PC-B
QG-PRO-PM-PC-W
Pipe Connector
(Sold Separately)

OPTIONAL ACCESSORY



M2.5 Allen Key
II



M5 x 4mm
Security Screws
EE



M5 x 4mm
Screws
DD