

EJECTION LATCHES OMITTED IN THIS VIEW FOR CLARITY

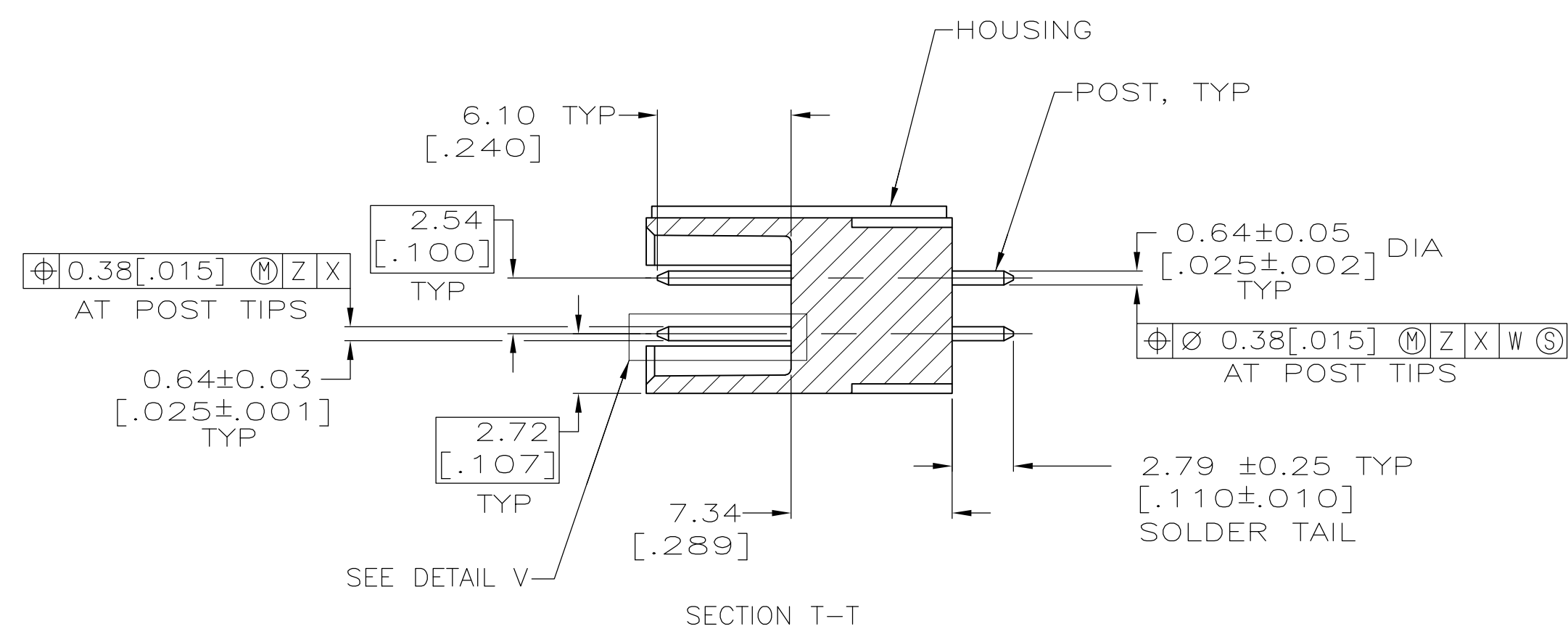

- 1 MOLDED PARTS: GLASS FILLED NYLON OR POLYESTER, 94V-0 RATED, BLACK. POSTS: PHOSPHOR BRONZE OR BRASS.
- 2 POSTS: GOLD FLASH OVER PALLADIUM-NICKEL PLATE, 0.38µm [.000015] MIN TOTAL ON THE LOCALIZED PLATE AREA, 2.54µm [.000100] MIN TIN-LEAD PLATE ON THE SOLDER-TAIL, 1.27µm [.000050] MIN NICKEL UNDERPLATE ON THE ENTIRE POST. OR 0.38µm [.000015] MIN GOLD PLATE ON THE LOCALIZED PLATE AREA, 2.54µm [.000100] MIN TIN-LEAD PLATE ON THE SOLDER-TAIL, 1.27µm [.000050] MIN NICKEL UNDERPLATE ON THE ENTIRE POST.
- 3 COORDINATE DIMENSION APPLIES FROM BASIC LOCATION.
- 4. RECOMMENDED PRINTED CIRCUIT BOARD THICKNESS IS 1.57 [.062].
- 5. DISTANCE REQUIRED BY EJECTION LATCHES IN THE OPEN POSITION.
- 6. POST 40 OMITTED.

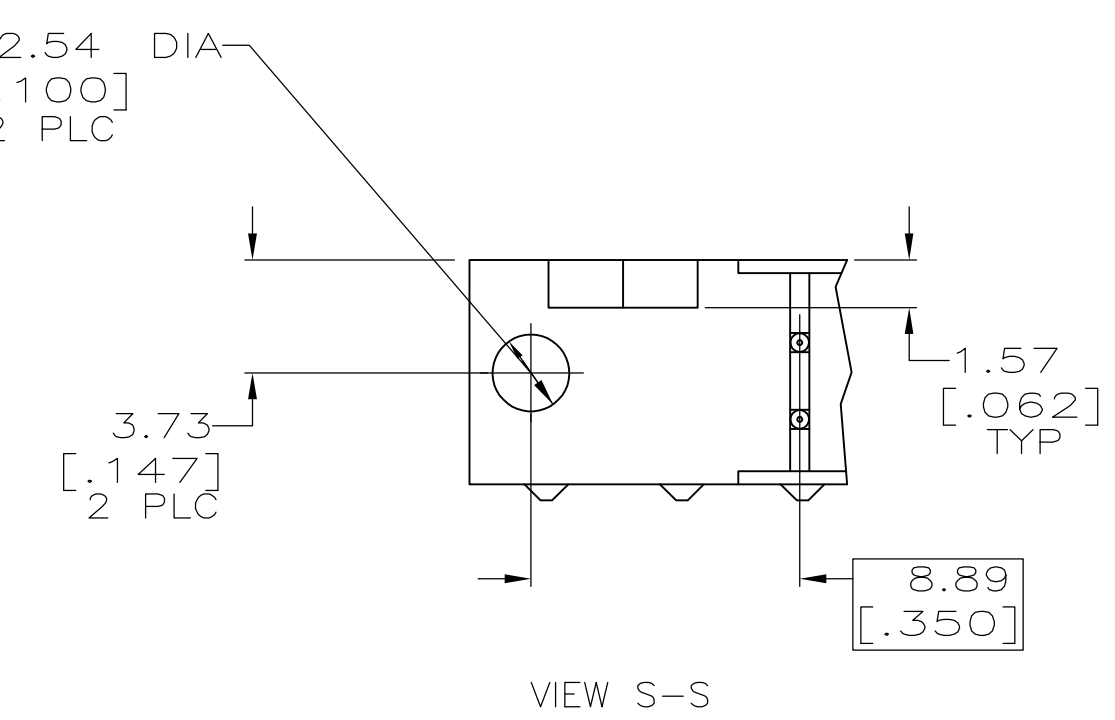
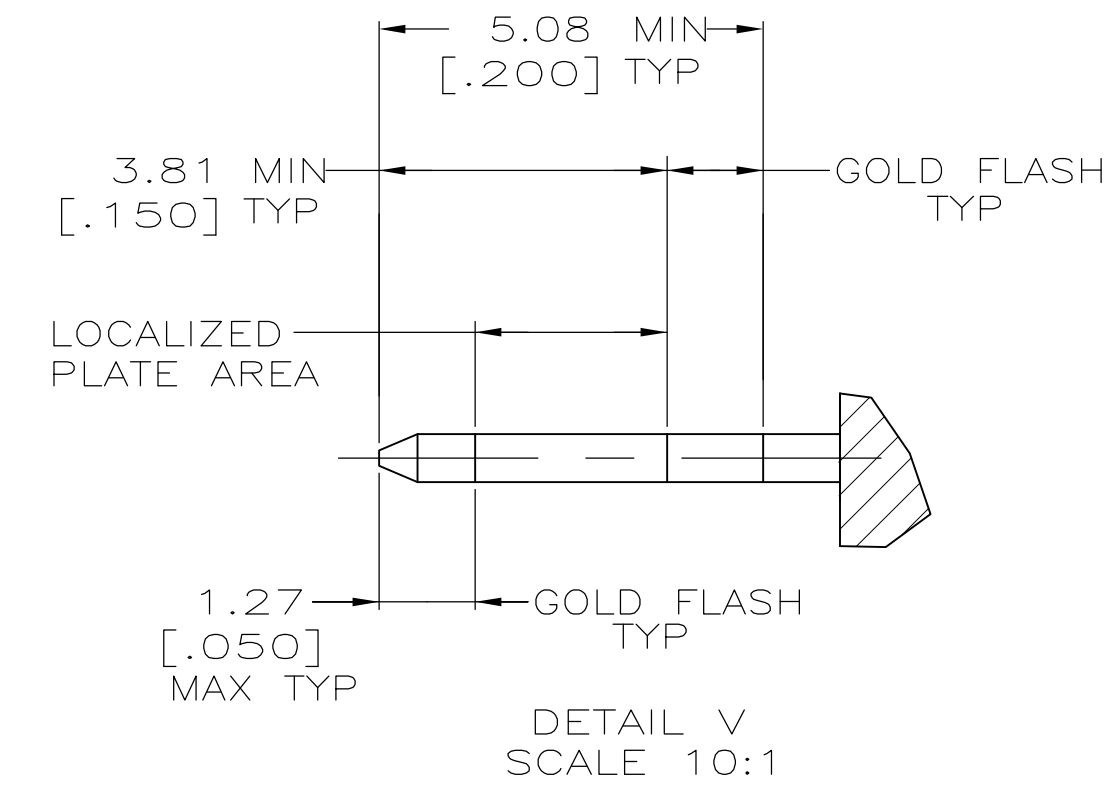
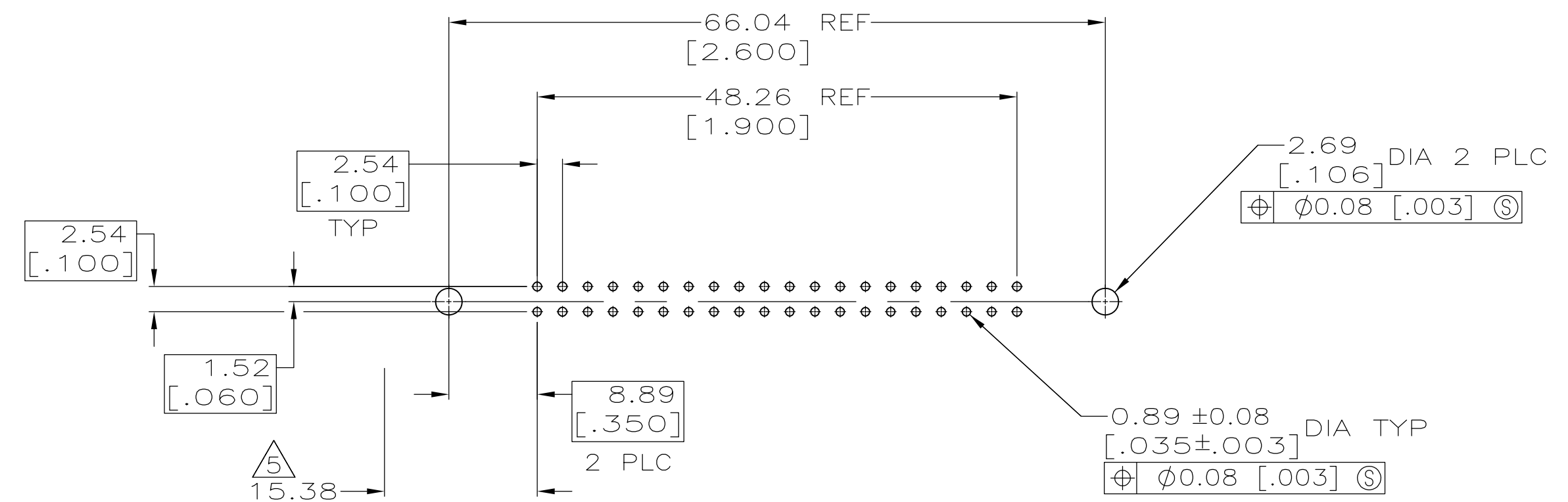
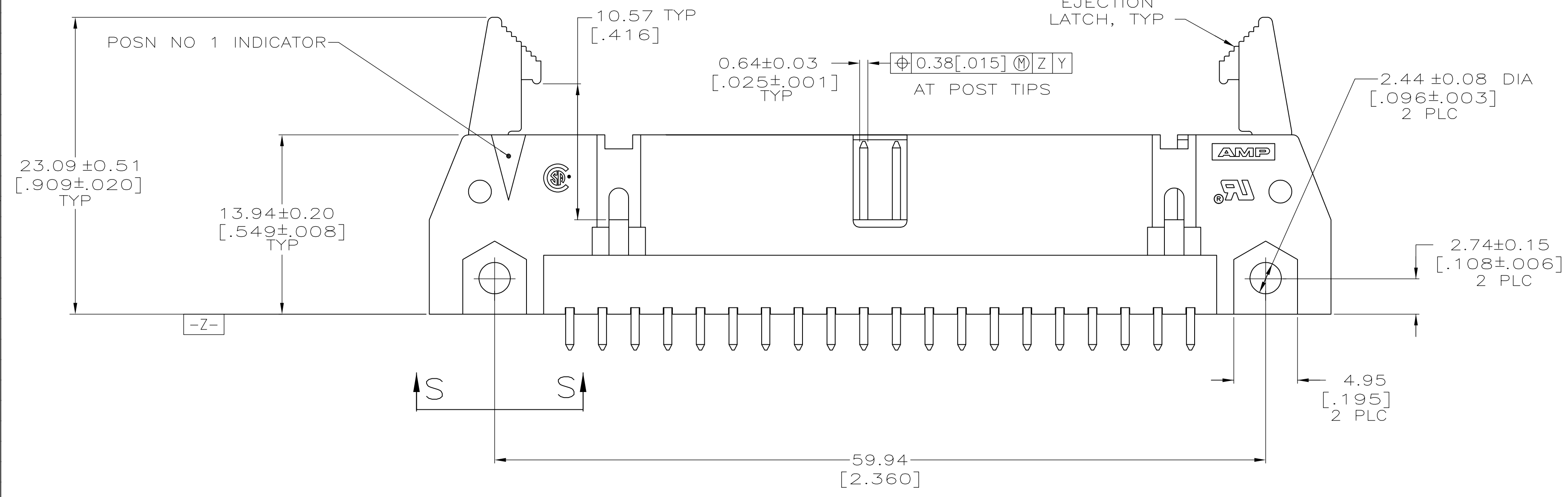

40	111187-9
NO OF POSN	PART NUMBER

THIS DRAWING IS A CONTROLLED DOCUMENT.		DIN M. MORRIS 070CT98	Tyco Electronics Corporation	
DIMENSIONS: mm [INCHES]		CHK: C. REIFSNYDER 070CT98	Harrisburg, PA 17105-3608	
TOLERANCES UNLESS OTHERWISE SPECIFIED:		APVD: -	NAME: Tyco Electronics	
0 PLC ± -	1 PLC ± -	PRODUCT SPEC 108-40018	HEADER ASSY, UNIVERSAL, AMP-LATCH	
2 PLC ± ± 0.13[.005]	3 PLC ± -	APPLICATION SPEC -	-	
4 PLC ± -	ANGLES ± -	SIZE: A1	CAGE CODE: 00779	DRAWING NO: 111187
MATERIAL 1	FINISH 2	WEIGHT: -	RESTRICTED TO: -	CUSTOMER DRAWING
		SCALE: 4:1	SHEET: 1 OF 1	REV: F