

LOOSE PIECE		SPECIFICATIONS				
MATERIAL NUMBER	ENGINEERING NUMBER	STUD SIZE	"S" ±.005 [0.13]	"W" ±.010 [0.25]	"C" MIN.	"L" MAX.
191340008	A-335-06	6	.146 [3.71]	.316 [8.02]	.303 [7.70]	.778 [19.76]
191340009	A-335-08	8	.173 [4.39]			
191340010	A-335-10	10	.198 [5.03]			

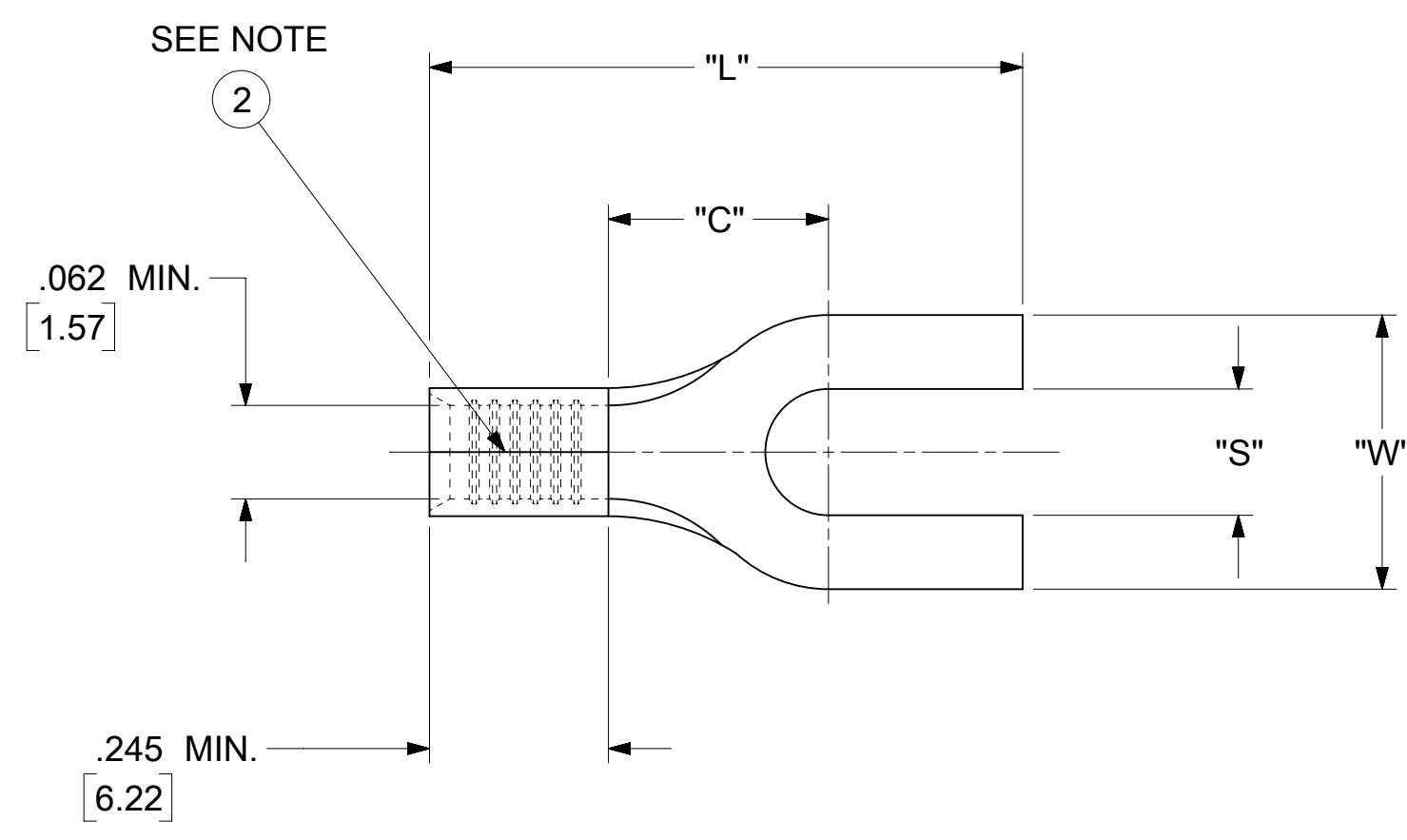

- NOTES:
- MATERIAL:
 TERMINAL: COPPER (STOCK TKN .028 ^{+0.001}/_{-0.000} [0.71])
 PLATING: ELECTRO-TIN (.0003 MIN).
 - BRAZED SEAM
 - WIRE SIZE: 22-18 AWG
 .25-1.5 MM²
 - "UL" LISTING #E32244
 "CSA" LISTING #18689
 - ALL DIMENSIONS IN INCHES/[MM].
 - PARTS ARE ROHS COMPLIANT.
 - DIMS. SHOWN ARE FOR REFERENCE ONLY.

SYMBOLS	THIS DRAWING CONTAINS INFORMATION THAT IS PROPRIETARY TO MOLEX ELECTRONIC TECHNOLOGIES, LLC AND SHOULD NOT BE USED WITHOUT WRITTEN PERMISSION									
	DIMENSION UNITS		SCALE		CURRENT REV DESC:					
∇ = 0	INCH/MM	NTS		EC NO: 625846 DRWN: ABENJAMINLW 2019/09/04 CHK'D: GROJAS01 2019/10/17 APPR: JMACNEIL 2019/10/18 INITIAL REVISION: DRWN: JJ 1984/11/28 APPR:						
∇ = 0	GENERAL TOLERANCES (UNLESS SPECIFIED)									
∇ = 0		MM	INCH							
∇ = 0	4 PLACES	±	---	±	---	PRODUCT CUSTOMER DRAWING				
∇ = 0	3 PLACES	±	---	±	.005					
∇ = 0	2 PLACES	±	0.13	±	.01	DOCUMENT NUMBER		DOC TYPE	DOC PART	REVISION
∇ = 0	1 PLACE	±	0.25	±	---	ACD30302		PSD	001	A
∇ = 0	0 PLACES	±	---	±	---	MATERIAL NUMBER		CUSTOMER		SHEET NUMBER
∇ = 0	DRAFT WHERE APPLICABLE MUST REMAIN WITHIN DIMENSIONS		THIRD ANGLE PROJECTION		DRAWING	SERIES	SEE TABLE	GENERAL MARKET		1 OF 1
∇ = 0					C-SIZE	19134				