

| PART NUMBER | REV | FIRST USED |
|-------------|-----|------------|
| 680079-1 | 0 | 854400-1 |
| 680079-2 | 0 | 565435-5 |
| 680079-3 | 0 | 354500-1 |

PRELIMINARY

PRELIMINARY

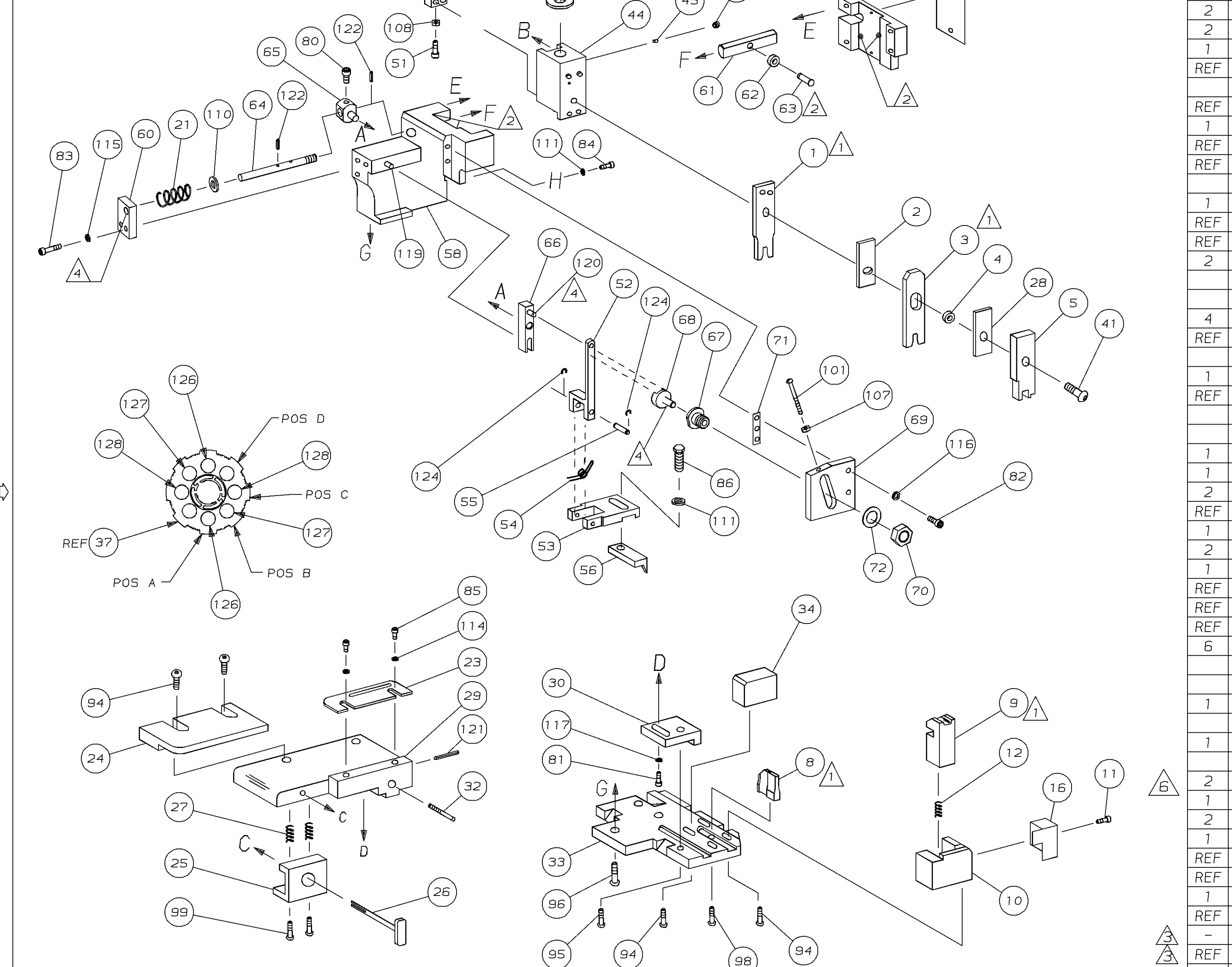
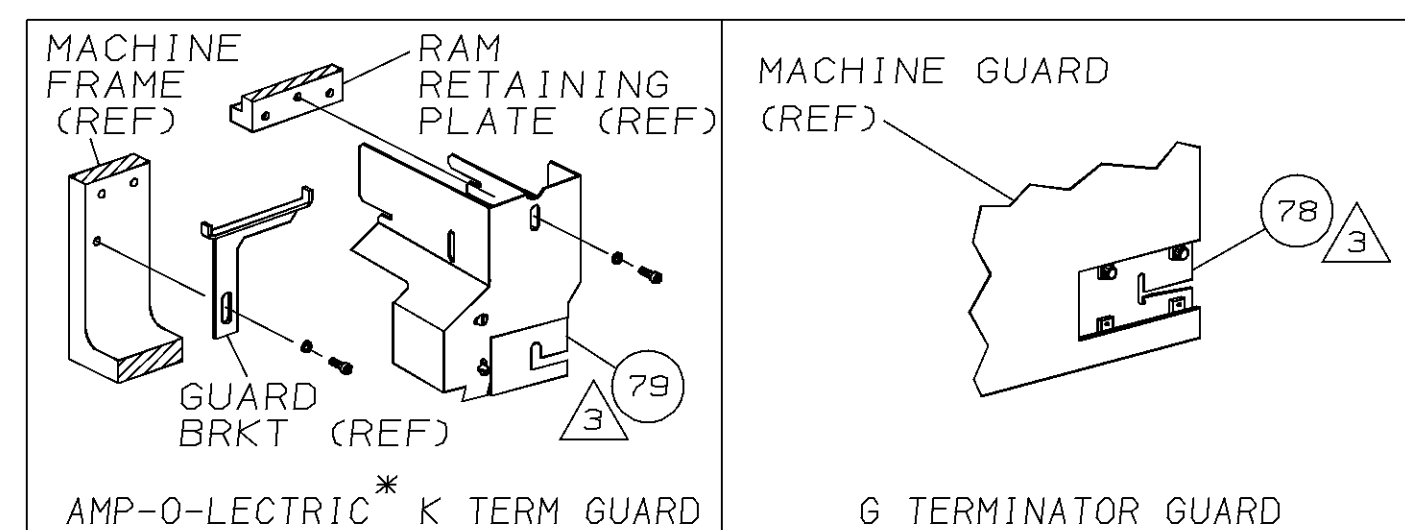
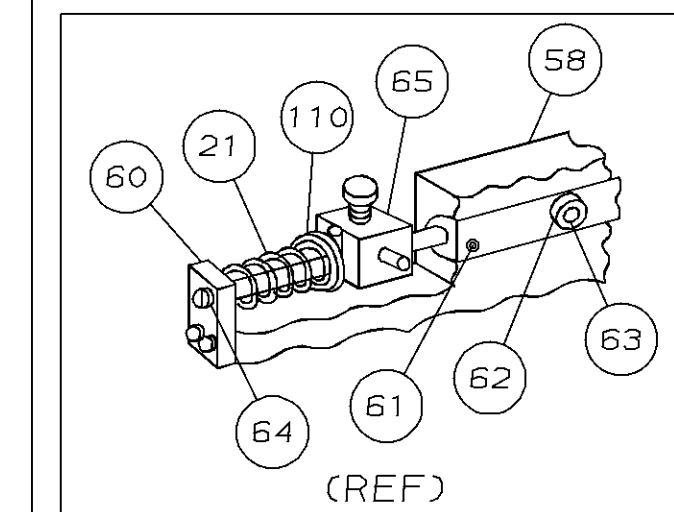

| TERMINAL NAME: | SPADE |
|----------------|----------|
| | 60998 |
| TERM APPL SPEC | 114-2084 |

| CRIMPING DATA | | | |
|---------------------|--------------|--------------------|-------------|
| PAD LTR | CRIMP HEIGHT | WIRE SIZE | |
| A | .084 ±.002 | 18 | |
| B | .090 ±.002 | 16 | |
| C | .097 ±.002 | 14 | |
| D | NOT | USED | |
| CRIMP | SIZE | TYPE | RANGE |
| WIRE | .130 | F | 18 - 14 |
| INSUL | .210 | F | .120 - .180 |
| FEED | APPL INST | SET UP GAGE LAYOUT | |
| .580 | 408-8040 | 458637-1 L1564 | |
| WIRE STRIP LENGTH - | | | |

| LEADMAKER | | MECH POST FEED | |
|-----------|---------------|----------------|----------|
| -1 | BENCH MODEL K | MECH PRE FEED | |
| -2 | BENCH MODEL G | MECH PRE FEED | |
| REF | REF | - B | 22594-8 |
| REF | REF | - B | 240628-1 |
| REF | REF | - B | 240626-1 |
| REF | REF | - B | 240633-1 |
| REF | REF | - A | 455680-1 |
| REF | REF | - B | 240629-1 |
| REF | REF | - A | 240632-2 |
| REF | REF | - B | 240659-3 |
| REF | REF | - B | 240658-1 |
| REF | REF | - B | 454398-2 |
| REF | REF | - A | 454178-1 |
| REF | REF | - C | 454220-1 |
| REF | REF | - D | 454485-1 |

| | | | | | | | |
|---|-----|-----|-----|----------|------------|-----------------------------------|---------|
| 2 | 2 | 2 | - | C | 2-354778-7 | PIN, WIRE DISC (.2630)C | 128 |
| 2 | 2 | 2 | - | C | 4-354778-1 | PIN, WIRE DISC (.2700)B | 127 |
| 2 | 2 | 2 | - | C | 5-354778-3 | PIN, WIRE DISC (.2760)A | 126 |
| 1 | 1 | 1 | - | A | 986950-1 | WASHER, FLAT PRECISION | 125 |
| REF | REF | REF | - | A | 21045-3 | RING, RET "C" (Ø.187)FD FING PIN | 124 |
| REF | REF | REF | - | A | 5-21028-1 | PIN, SLT SPR (Ø.125x.50)ADJ ROD | 122 |
| 1 | 1 | 1 | - | A | 4-21028-0 | PIN, SLT SPR (Ø.093x.75)ST GDE PL | 121 |
| REF | REF | REF | - | A | 1-21030-1 | PIN, DOWEL (Ø.187x.50)LEVER | 120 |
| REF | REF | REF | - | A | 1-21030-6 | PIN, DOWEL (Ø.187x1.25)HOUSING | 119 |
| 1 | 1 | 1 | - | A | 21024-5 | WASHER, LOCK (#10)ADJ BLOCK | 118 |
| REF | REF | REF | - | A | 21024-5 | WASHER, LOCK (#10)ADJ PLATE | 117 |
| REF | REF | REF | - | A | 21024-5 | WASHER, LOCK (#10)FEED GDE ROD | 116 |
| 2 | 2 | 2 | - | A | 21024-2 | WASHER, LOCK (#4)FRONT STP GUIDE | 114 |
| 4 | 4 | 4 | - | A | 21024-4 | WASHER, LOCK (#8)STRIPPER | 111 |
| REF | REF | REF | - | A | 21899-4 | WASHER, FLAT (Ø5/16) SCREW ADJ | 110 |
| 1 | 1 | 1 | - | A | 21018-5 | NUT, HEX (NO. 6)HOLDDOWN | 108 |
| REF | REF | REF | - | A | 21018-5 | NUT, HEX (6-32)FEED ADJ | 107 |
| 1 | 1 | 1 | - | A | 992031-1 | PIN, CLEVIS | 104 |
| 1 | 1 | 1 | - | A | 21009-2 | SCR, SKT SET (1/4-20x.25 LW)RAM | 103 |
| 2 | 2 | 2 | - | A | 21017-2 | SCR, DRIVE (#2x.19) ID PLATE | 102 |
| REF | REF | REF | - | A | 6-23715-5 | SCR, PAN HD (6-32x1.50)FEED ADJ | 101 |
| 1 | 1 | 1 | - | B | 461264-1 | PLATE, IDENTIFICATION | 100 |
| 2 | 2 | 2 | - | A | 3-21002-0 | SCR, BHC (10-32x.88)DRAG | 99 |
| 1 | 1 | 1 | - | A | 22733-8 | SCR, BHC (8-32x.38 LW)ANVIL | 98 |
| REF | REF | REF | - | A | 2-21002-9 | SCR, BHC (10-32x.75)CAP | 97 |
| REF | REF | REF | - | A | 2-22733-8 | SCR, BHC (1/4-20x.62)HOUSING | 96 |
| REF | REF | REF | - | A | 2-21002-7 | SCR, BHC (10-32x.50)SG ADJ BLOCK | 95 |
| 6 | 6 | 6 | - | A | 2-21002-2 | SCR, BHC (8-32x.50) SHEAR | 94 |
| 1 | 1 | 1 | - | A | 1-21002-7 | SCR, BHC (6-32x.38)CAM | 91 |
| 1 | 1 | 1 | - | A | 7-21000-9 | SCR, SHC (4-40x.19)STRIPPER | 89 |
| 2 | 2 | 2 | - | A | 2-21000-7 | SCR, SHC (8-32x.48)H. DOWN | 87 |
| 1 | 1 | 1 | - | A | 2-22603-0 | SCR, HEX HD (8-32x.31)FEED FINGER | 86 |
| 2 | 2 | 2 | - | A | 1-21000-3 | SCR, SHC (4-40x.25)F ST GUIDE | 85 |
| 1 | 1 | 1 | - | A | 2-21000-7 | SCR, SHC (8-32x.50)STRIPPER | 84 |
| REF | REF | REF | - | A | 3-21000-7 | SCR, SHC (10-32x.75)FEED ROD GD | 83 |
| REF | REF | REF | - | A | 3-21000-6 | SCR, SHC (10-32x.62)FD ADJ BLK | 82 |
| 1 | 1 | 1 | - | A | 3-21000-4 | SCR, SHC (10-32x.38)SG ADJ BL | 81 |
| REF | REF | REF | - | A | 3-21000-4 | SCR, SHC (10-32x.38)PIVOT BLK | 80 |
| - | REF | - | - | B | 455749-1 | GUARD, WINDOW | 79 |
| REF | - | - | - | B | 679532-1 | INSERT, GUARD | 78 |
| 1 | 1 | 1 | - | A | 690603-1 | SPRING, ASSIST | 74 |
| 1 | 1 | 1 | - | A | 23030-1 | SCR, SHC (6-32x.25 SL)INS DISC | 73 |
| REF | REF | REF | - | A | 458109-1 | WASHER, SPECIAL | 72 |
| REF | REF | REF | - | A | 690517-1 | SPACER | 71 |
| -3 | -2 | -1 | U/M | DWG SIZE | PART NO | DESCRIPTION | ITEM NO |
| QTY REQD PER ASSY | | | | | | | |
| REVISION OF EACH ASSY NO (WHEN BLANK, USE DWG REVISION) | | | | | | | |
| PARTS LIST | | | | | | | |

| | | | | | | | |
|---|-----|-----|-----|----------|------------|-----------------------------|---------|
| 1 | 1 | 1 | - | B | 690542-2 | PAWL, FEED | 56 |
| REF | REF | REF | - | B | 240624-1 | PIN, FEED FINGER | 55 |
| REF | REF | REF | - | B | 691499-1 | SPRING, FEED FINGER | 54 |
| REF | REF | REF | - | B | 690541-1 | HOLDER, FEED FINGER | 53 |
| REF | REF | REF | - | A | 455679-1 | LEVER, TERMINAL FEED ARM | 52 |
| 1 | 1 | 1 | - | A | 811242-2 | BUMPER, HOLDDOWN | 51 |
| 1 | 1 | 1 | - | A | 690753-1 | SPACER, TONKER | 50 |
| 1 | - | - | - | B | 690602-6 | CAM, PRE-FEED 1 5/8 ST | 49 |
| - | 1 | - | - | B | 690602-5 | CAM, PRE-FEED 1 1/8 ST | 48 |
| - | - | 1 | - | B | 690501-4 | CAM, POST-FEED 1 5/8 ST | 47 |
| 1 | 1 | 1 | - | B | 459456-1 | APPLICATOR, BASIC (SUBASSY) | 46 |
| 1 | 1 | 1 | - | A | 690191-1 | PLUG, NYLON | 45 |
| 1 | 1 | 1 | - | C | 455673-1 | RAM | 44 |
| 1 | 1 | 1 | - | A | 690125-1 | WASHER, LAMINATED | 43 |
| 1 | 1 | 1 | - | A | 690124-1 | WASHER, RAM | 42 |
| 1 | 1 | 1 | - | A | 7-21002-9 | BOLT, CRIMPER (5/16x1.00) | 41 |
| 1 | 1 | 1 | - | A | 23241-6 | BALL, STEEL | 40 |
| 1 | 1 | 1 | - | A | 690170-1 | SPRING, COMPRESSION | 39 |
| 1 | 1 | 1 | - | C | 690142-1 | DISC, INSULATION | 38 |
| 1 | 1 | 1 | - | D | 354777-1 | WIRE DISC, PLASTIC | 37 |
| 1 | 1 | 1 | - | A | 22480-5 | WASHER, SPRING | 36 |
| 1 | 1 | 1 | - | B | 690212-1 | POST, RAM | 35 |
| 1 | 1 | 1 | - | B | 690786-3 | SUPPORT, TERMINAL | 34 |
| REF | REF | REF | - | D | 455675-1 | PLATE, BASE | 33 |
| 1 | 1 | 1 | - | A | 690432-3 | SCREW, ADJUSTMENT | 32 |
| REF | REF | REF | - | B | 455689-1 | BLOCK, STRIP GUIDE ADJ | 30 |
| 1 | 1 | 1 | - | C | 455671-1 | PLATE, STRIP GUIDE | 29 |
| 1 | 1 | 1 | - | C | 455888-8 | SPACER, FRONT SHEAR DEP | 28 |
| 2 | 2 | 2 | - | A | 1-22284-0 | SPRING, DRAG | 27 |
| 1 | 1 | 1 | - | B | 690546-1 | LEVER, DRAG RELEASE | 26 |
| 1 | 1 | 1 | - | B | 240792-1 | DRAG, TERMINAL | 25 |
| 1 | 1 | 1 | - | D | 7-690504-6 | GUIDE, STRIP (REAR) | 24 |
| 1 | 1 | 1 | - | A | 690438-1 | GUIDE, STRIP (FRONT) | 23 |
| - | - | 1 | - | B | 690472-2 | STRIPPER | 22 |
| REF | REF | REF | - | A | 4-22284-9 | SPRING, FEED RETURN | 21 |
| 1 | 1 | - | - | A | 679218-1 | STRIPPER WIRE STOP ASSY | 20 |
| 1 | 1 | - | - | B | 458949-1 | STRIPPER | 19 |
| 1 | 1 | 1 | - | B | 691667-1 | GUARD, CHIP (FRONT) | 16 |
| 1 | 1 | 1 | - | A | 5-22280-0 | SPRING, SHEAR | 12 |
| 1 | 1 | 1 | - | B | 690461-2 | STOP, SHEAR | 11 |
| 1 | 1 | 1 | - | C | 1-690459-0 | HOLDER, SHEAR (FRONT) | 10 |
| 1 | 1 | 1 | - | C | 454276-5 | SHEAR, FLOAT (FRONT) | 9 |
| 1 | 1 | 1 | - | C | 6-683403-7 | ANVIL | 8 |
| 1 | 1 | 1 | - | C | 1-455889-7 | DEPRESSOR, SHEAR (FRONT) | 5 |
| 1 | 1 | 1 | - | B | 1-238011-0 | SPACER, BLOCK CRIMPER | 4 |
| 1 | 1 | 1 | - | C | 3-456134-1 | CRIMPER, INSULATION | 3 |
| 1 | 1 | 1 | - | C | 1-455888-0 | SPACER, CRIMPER | 2 |
| 1 | 1 | 1 | - | C | 1-456410-5 | CRIMPER, WIRE | 1 |
| -3 | -2 | -1 | U/M | DWG SIZE | PART NO | DESCRIPTION | ITEM NO |
| QTY REQD PER ASSY | | | | | | | |
| REVISION OF EACH ASSY NO (WHEN BLANK, USE DWG REVISION) | | | | | | | |
| PARTS LIST | | | | | | | |

* Trademark of AMP Incorporated

| POST FEED 1 5/8 STROKE | PRE FEED 1 1/8 STROKE | PRE FEED 1 5/8 STROKE |
|------------------------|-----------------------|-----------------------|
| | | |
| ROTATED 180° | ROTATED 180° | ROTATED 180° |
| T TERMINATING UNIT | K TERMINATING UNIT | G TERMINATING UNIT |
| | | |
| LOC A | DIST 66 | LEADMAKER |
| | | BENCH MACHINE |

- 1 RECOMMENDED SPARE PARTS.
- 2 GREASE LIGHTLY.
- 3 GUARD MUST BE IN PLACE WHEN OPERATING APPLICATOR IN A BENCH MACHINE.
- 4 LUBRICATE DAILY USING NO. 20 MACHINE OIL.
- 5. ITEMS WITH QTY OF REF SPECIFIED (EXCEPT ITEMS 78 AND 79) ARE USED ON ITEM 46.
- 6 CUT TO LENGTH AT ASSY.

THIS DRAWING IS A CONTROLLED DOCUMENT FOR AMP INCORPORATED. IT IS SUBJECT TO CHANGE AND THE CONTROLLING ENGINEERING ORGANIZATION SHOULD BE CONTACTED FOR THE LATEST REVISION.

THIS INFORMATION IS CONFIDENTIAL AND IS DISCLOSED TO YOU ON CONDITION THAT NO FURTHER DISCLOSURE IS MADE BY YOU TO OTHER THAN AMP PERSONNEL WITHOUT WRITTEN AUTHORIZATION FROM AMP INCORPORATED, HARRISBURG, PA.