

THIS IS A CONTROLLED DOCUMENT.

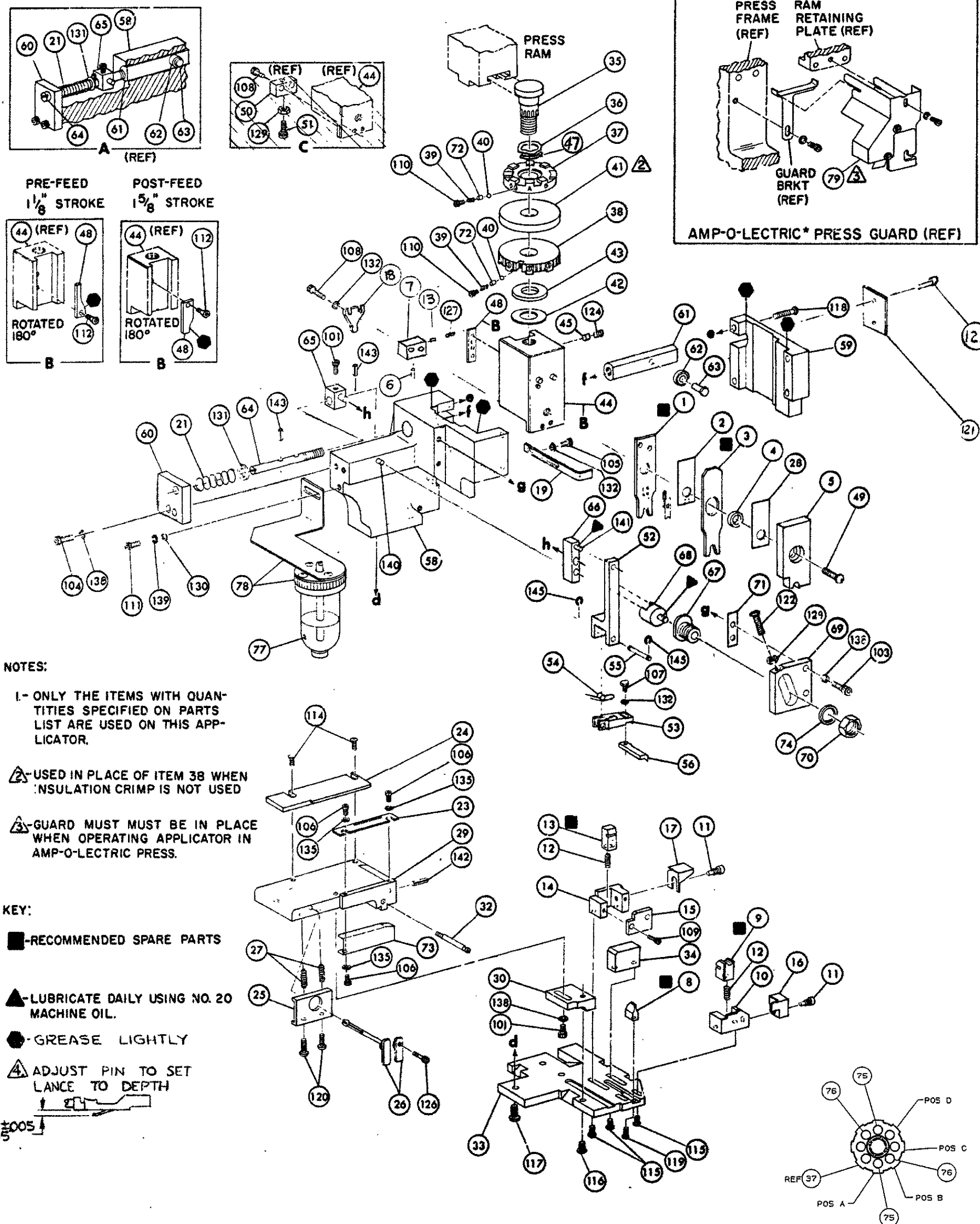

**NOTES:**

1- ONLY THE ITEMS WITH QUANTITIES SPECIFIED ON PARTS LIST ARE USED ON THIS APPLICATOR.

△ USED IN PLACE OF ITEM 38 WHEN INSULATION CRIMP IS NOT USED

△ GUARD MUST BE IN PLACE WHEN OPERATING APPLICATOR IN AMP-O-LECTRIC PRESS.

**KEY:**

- -RECOMMENDED SPARE PARTS
- ▲ -LUBRICATE DAILY USING NO. 20 MACHINE OIL.
- -GREASE LIGHTLY
- △ ADJUST PIN TO SET LANCE TO DEPTH

QTY	PART NO	DESCRIPTION	ITEM	QTY	PART NO	DESCRIPTION	ITEM
2	21045-3	RING, RETAINING 'C' (.187 DIA) FEED FINGER PIN	145	1	454220-1	CAP, HOUSING	59
2	5-21028-1	PIN, SLOT SPR (.125 DIA X .50) ADJ ROD	143	1	454485-2	HOUSING	58
1	4-21028-0	PIN, SLOT SPR (.093 DIA X .75) STR G PLATE	142	1	458537-2	PAWL, FEED	57
1	1-21030-1	PIN, DOWEL (.187 DIA X .50) LEVER	141	1	240624-1	PIN, FEED FINGER	56
1	1-21030-6	PIN, DOWEL (.187 DIA X 1.25) HOUSING	140	1	691499-1	SPRING, FEED FINGER	55
5	21024-5	WASHER, LOCK (NO 10) LUB ASSY	139	1	690541-1	FINGER, FEED	54
2	21024-5	WASHER, LOCK (NO 10) STRIP GUIDE ADJ BLOCK	138	1	455679-2	LEVER, TERMINAL FEED ARM	53
2	21024-5	WASHER, LOCK (NO 10) ADJ PLATE	137	1		BUMPER, HOLDDOWN	52
2	21024-5	WASHER, LOCK (NO 10) FEED GUIDE ROD	136	1		SPACER, TONKER	51
2	21024-2	WASHER, LOCK (NO 4) FRONT STRIP GUIDE	135	1	7-21002-9	BOLT, CRIMPER	50
1	21024-4	WASHER, LOCK (NO 8) FEED FINGER	134	1	690501-4	CAM, POST FEED 1 5/8 STROKE	49
2	21024-4	WASHER, LOCK (NO 8) DEPRESSOR	133	1	986950-1	WASHER	48
4	21024-4	WASHER, LOCK (NO 8) STRIPPER	132	1	459456-1	APPLICATOR, BASIC (SUB ASSY)	47
1	21899-4	WASHER, FLAT (5/16 DIA) SCREW ADJ	131	1	690191-1	PLUG, NYLON	46
1	21899-2	WASHER, FLAT (NO 10) LUB ASSY	130	1	455673-1	RAM	45
2	21018-5	NUT, HEX MACH (6-32) HOLDDOWN	129	1	690125-1	WASHER, LAMINATED	44
1	21068-5	NUT, HEX MACH (6-32) FEED ADJ	128	1	690124-4	WASHER, RAM	43
1	2-21008-1	SCR, SOC SET (4-40 X.25) PIN, HOLDER	127	1		DISC, SPACER	42
1	22353-8	SCR, SHLD. (.187 DIA X .250 LG) DRAG LEVER	126	1	23241-6	BALL, STEEL	41
1	21009-2	SCR, SKT SET (1/4-20 X.25) (LOC-WEL) RAM	124	1	690170-1	SPRING, COMPRESSION	40
2	21017-2	SCR DRIVE (2 X.19) I.D. PLATE	123	1	690142-1	DISC, INSULATION	39
1	6-23715-5	SCR, RD HD MACH (6-32 X 1.50) FEED ADJ	122	1	354777-1	DISC, WIRE	38
1	461264-1	PLATE, IDENTIFICATION	121	1	22480-5	WASHER, SPRING	37
2	2-21002-9	SCR, BUT HD SKT CAP (10-32 X .75) DRAG	120	1	690212-1	POST, RAM	36
1	22733-8	SCR, BUT HD SKT CAP (8-32 X .38) (LOC-WEL) ANVIL	119	1	690474-5	SUPPORT, TERMINAL	35
4	2-21002-9	SCR, BUT HD SKT CAP (10-32 X .75) CAP	118	1	455675-1	GUIDE STRIP (REAR)	34
3	2-22733-8	SCR, BUT HD SKT CAP (1/4-20 X .75) HOUSING	117	1	690432-3	SCREW, ADJUSTMENT	33
1	2-21002-7	SCR, BUT HD SKT CAP (10-32 X .50) SG ADJ BLOCK	116	1	455689-1	BLOCK, STRIP GUIDE ADJ	32
4	2-21002-2	SCR, BUT HD SKT CAP (8-32 X .50) SHEAR	115	1	458144-9	PLATE, STRIP GUIDE	30
2	2-21002-3	SCR, BUT HD SKT CAP (8-32 X .62) R STRIP GUIDE	114	2	1-22284-0	SPACER, FRONT SHEAR DEPRESSOR	28
1	1-21002-7	SCR, BUT HD SKT CAP (8-32 X .38) CAM	112	1	240793-1	SPRING, DRAG	27
1	3-21000-4	SCR, SKT HD CAP (10-32 X .38) LUBRICATOR ASSY	111	1	240792-1	LEVER, DRAG RELEASE	26
1	23030-1	SCR, SKT HD CAP (8-32 X .25) (LOC-WEL) CP DISC	110	1	5-690504-8	DRAG, STOCK	25
2	2-21000-8	SCR, SKT HD CAP (8-32 X .62) DEPRESSOR	109	1	690433-1	GUIDE STRIP (FRONT)	24
1	2-22803-0	SCR, HEX HD MACH (8-32 X .31) FEED FINGER	107	1	4-22284-9	SPRING, FEED RETURN	23
3	1-21000-3	SCR, SKT HD CAP (4-40 X .25) F STRIP GUIDE	106	1	690472-6	STRIPPER	22
1	2-21000-7	SCR, SKT HD CAP (8-32 X .50) STRIPPER	105	1	46965-1	HOLDER, TERMINAL	21
2	3-21000-7	SCR, SKT HD CAP (10-32 X .75) FEED ROD GUIDE	104	1		GUARD, CHIP (REAR)	20
2	3-21000-8	SCR, SKT HD CAP (10-32 X .62) FEED ADJ BLOCK	103	1	691667-3	GUARD, CHIP (FRONT)	19
2	3-21000-4	SCR, SKT HD CAP (10-32 X .38) SG ADJ BLOCK	102	1		PLATE, SHEAR (REAR)	18
REF	455755-3	GUARD ASSY	79			HOLDER, SHEAR (REAR)	17
1	1-465184-0	LUBRICATOR ASSY	78	1	690191-5	PLUG, NYLON	16
1	690603-1	SPRING, ASSIST	72	1	5-22280-0	SPRING, SHEAR	15
1	690517-1	SPACER	71	1	690481-7	STOP, SHEAR	14
1	22594-8	NUT, HEX	70	1	1-690459-0	HOLDER, SHEAR (FRONT)	13
1	240628-1	PLATE, ADJUSTMENT	69	1	454276-7	SHEAR, FLOAT (FRONT)	12
1	240626-1	SHAFT, PIVOT	68	1	3-458834-8	ANVIL	11
1	240633-1	BUSHING	67	1	815306-1	HOLDER SETTING PIN	10
1	455680-1	LEVER, INTERMEDIATE	66	1	815307-1	PIN, LANCE SETTING	9
1	240629-1	BLOCK, PIVOT	65	1	2-455889-1	DEPRESSOR, SHEAR (FRONT)	8
1	240632-2	SCREW, ADJUSTMENT FEED ROD	64	1	238011-1	SPACER, TUBULAR, INS CRIMPER	7
1	240659-3	PIN, CAM ROLLER	63	1	6-456135-7	CRIMPER, INSULATION	6
1	240658-1	ROLLER, CAM	62	1	1-455888-0	SPACER, CRIMPER	5
1	454398-2	ROD, FEED	61	1	458141-5	CRIMPER, WIRE	4
1	454178-1	GUIDE, FEED ROD	60	1			3
1				QTY	PART NO	DESCRIPTION	ITEM

REMARKS	NO	REV
APPL USED ON MACHINE PART NO	MACH SERIAL NO	DISTRIBUTION
CUSTOMER NAME	APPL SERIAL NO	ORIGINAL
ADDRESS	PURCHASE ORDER	CUSTOMER COPY
CITY	ENG APP	FIELD ENG COPY

CRIMPING DATA				APPLICATOR WILL APPLY	
PAD LTR	CRIMP HEIGHT	WIRE SIZE	STRIPE LENGTH	530519	
A	.106	10			
B	.091	12			
C	NOT USED				
D	NOT USED				
CRIMP	SIZE	TYPE	FEED	APPL INST	
WIRE	160	F		A1 8040	
INSUL	250	0	.750		
WIRE RANGE	INSULATION RANGE	PRESS NO	REMARKS		
12-10	160-.210		AMPOMATOR POST FEED		

REVISION RECORD	APPROVE	DATE	REVISION RECORD	APPROVE	DATE	REVISION RECORD	APPROVE	DATE