

PART NUMBER	REV	FIRST USED
567909-1	A	854040-3

TERMINAL NAME:		CRIMPING DATA		
SERPENT		VISIBLE PAD LTR	CRIMP HEIGHT	WIRE SIZE
	66341	A	NOT	USED
	213543-2	B	.035 ± .002	22, 24 OR 26 ⁴
		C	NOT	USED
		D	NOT	USED
CRIMP	SIZE	TYPE	RANGE	
WIRE	.054	F	26-22	
INSUL	.110	0	.028-.054	
FEED	APPL INST	SET UP GAGE	LAYOUT	
.350	SEE CUSTOMER MANUAL	NONE	L1322-1	
TERM APPL SPEC	WIRE STRIP LENGTH			
114-9007	-			

SIM TO HDM 567313-4

REF	QTY	REV	PART NO	DESCRIPTION	ITEM NO
					70
					69
					68
					67
					66
					65
					64
					63
					62
					61
					60
					59
					58
					57
REF	-	B	694433-8	PAWL, FEED	56
					55
					54
					53
					52
1	-	A	811242-2	BUMPER, HOLDDOWN	51
1	-	A	844419-1	SPACER, TONKER	50
					49
1	-	A	690602-6	CAM, PRE-FEED 1.62 STROKE	48
					47
					46
1	-	A	690191-1	PLUG, NYLON	45
1	-	C	853076-1	RAM	44
1	-	A	690125-1	WASHER, LAMINATED	43
1	-	A	690124-1	WASHER, RAM	42
1	-	A	7-21002-9	BOLT, CRIMPER(5/16x1.00)	41
1	-	A	23241-6	BALL, STEEL	40
1	-	A	690170-1	SPRING, COMPRESSION	39
1	-	C	690142-1	DISC, INSULATION	38
1	-	D	354777-1	WIRE DISC, PLASTIC	37
1	-	A	22480-5	WASHER, SPRING	36
1	-	B	690212-1	POST, RAM	35
1	-	B	690786-1	SUPPORT, TERMINAL	34
1	-	C	462544-1	PLATE, BASE SPECIAL	33
1	-	A	690432-3	SCREW, ADJUSTMENT	32
1	-	B	462543-1	BLOCK, SCREW SPECIAL	31
1	-	B	455689-1	BLOCK, STRIP GUIDE ADJ	30
1	-	C	2-455671-6	PLATE, STRIP GUIDE	29
1	-	C	1-455888-6	SPACER, FRONT SHEAR DEP	28
2	-	A	1-22284-0	SPRING, DRAG	27
1	-	B	690546-1	LEVER, DRAG RELEASE	26
1	-	B	240792-1	DRAG, TERMINAL	25
1	-	D	9-690504-5	GUIDE, STRIP (REAR)	24
1	-	A	690438-1	GUIDE, STRIP (FRONT)	23
					22
1	-	A	463756-1	GUIDE, SCRAP	21
					20
REF	-	C	462615-1	STRIPPER	19
					18
					17
					16
					15
					14
					13
1	-	A	5-22280-0	SPRING, SHEAR	12
1	-	B	690461-2	STOP, SHEAR (FRONT)	11
1	-	B	462548-1	HOLDER, SHEAR (FRONT) SP	10
1	-	B	462547-1	SHEAR, FLOAT (FRONT) SP	9
1	-	C	5-854014-0	ANVIL	8
					7
					6
1	-	A	462838-1	DEPRESSOR, SHEAR (FRONT) SP	5
1	-	B	238011-2	SPACER, BLOCK CRIMPER	4
1	-	C	844991-6	CRIMPER, INSULATION	3
					2
1	-	C	844418-1	CRIMPER, WIRE	1

THIS DRAWING IS A CONTROLLED DOCUMENT FOR AMP INCORPORATED. IT IS SUBJECT TO CHANGE AND THE CONTROLLING ENGINEERING ORGANIZATION SHOULD BE CONTACTED FOR THE LATEST REVISION.

THIS INFORMATION IS CONFIDENTIAL AND IS DISCLOSED TO YOU ON CONDITION THAT NO FURTHER DISCLOSURE IS MADE BY YOU TO OTHER THAN AMP PERSONNEL WITHOUT WRITTEN AUTHORIZATION FROM AMP INCORPORATED, HARRISBURG, PA.

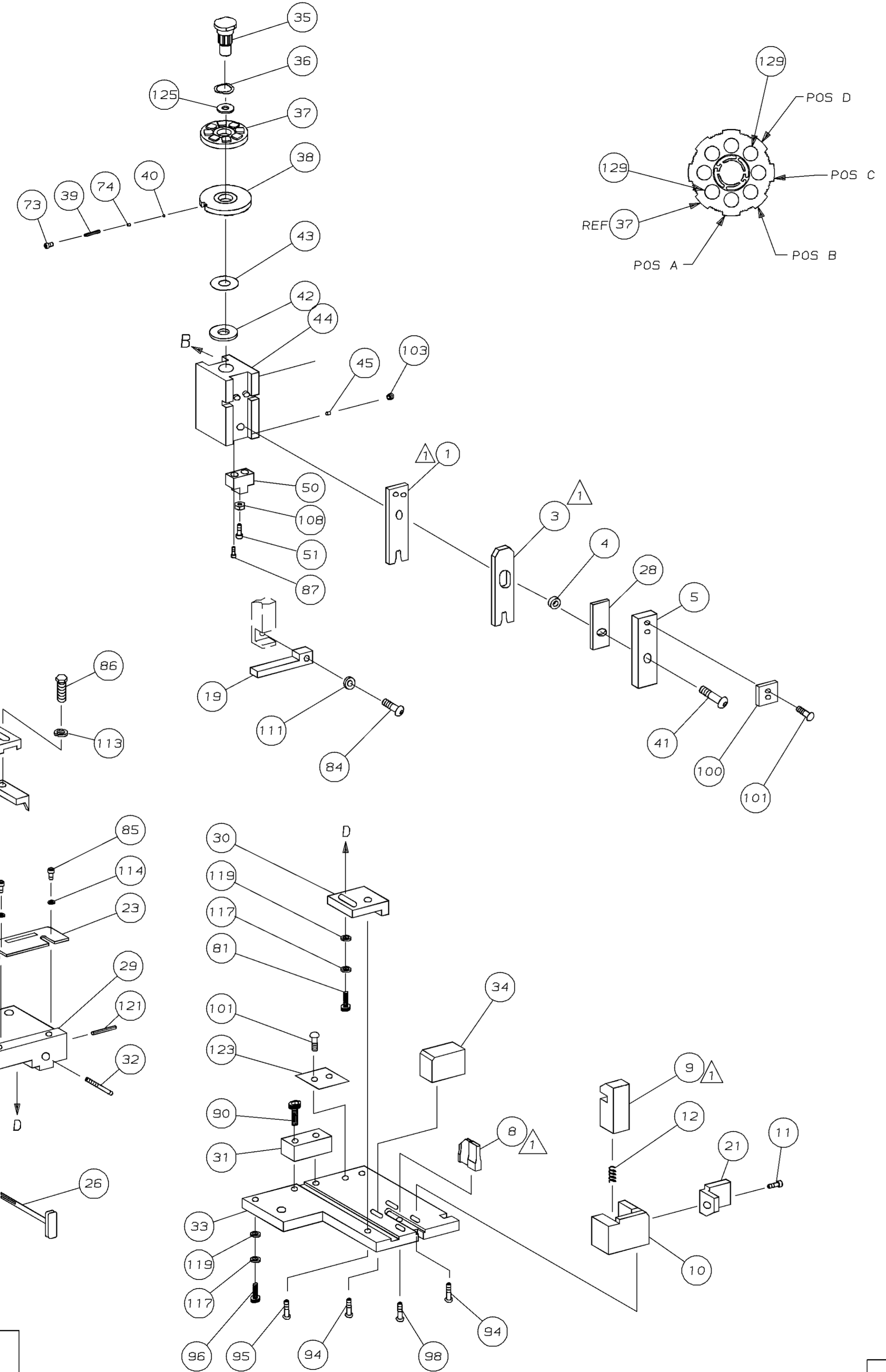

QTY	REV	PART NO	DESCRIPTION	ITEM NO	
2	-	C	6-354779-5	PIN, WIRE DISC (.3315)D	129
				128	
				127	
				126	
1	-	A	986950-1	WASHER, FLAT PRECISION	125
				124	
1	-	B	690701-2	PLATE, SERIAL NO.	123
				122	
1	-	A	4-21028-0	PIN,SLT SPR(φ.093x.75)ST GDE PL	121
				120	
2	-	A	21899-2	WASHER,FLAT(#10)S G ADJ BLK	119
				118	
2	-	A	21024-5	WASHER, LOCK(#10)ADJ BLOCK	117
				116	
				115	
2	-	A	21024-2	WASHER,LOCK(#4)FRONT STP GUIDE	114
REF	-	A	21024-4	WASHER,LOCK(#8)FEED FINGER	113
				112	
REF	-	A	21024-4	WASHER,LOCK(#8)STRIPPER	111
				110	
				109	
1	-	A	21018-5	NUT, HEX(#6)HOLD DOWN	108
				107	
				106	
				105	
				104	
1	-	A	21009-2	SCR,SKT SET(1/4-20x.25 LW)RAM	103
				102	
4	-	A	21017-2	SCR,DRIVE(#2x.19)ID PLATE	101
1	-	B	819347-1	PLATE, IDENTIFICATION	100
2	-	A	3-21002-0	SCR,BHC(10-32x.88)DRAG	99
1	-	A	22733-8	SCR,BHC(8-32x.38 LW)ANVIL	98
				97	
1	-	A	3-21000-8	SCR,SHC(10-32x.88)MOUNTING	96
1	-	A	2-22733-1	SCR,BHC(10-32x.50)SG ADJ BLK	95
4	-	A	22733-9	SCR,BHC(8-32x.50)SHEAR-TERM SUP	94
2	-	A	2-21000-6	SCR,BHC(8-32x.38)R STP GDE	93
				92	
1	-	A	1-21002-7	SCR,SHC(6-32x.50)CAM	91
2	-	A	2-21000-7	SCR,SHC(8-32x.50)SCR BLK	90
				89	
				88	
2	-	A	1-21000-6	SCR,SHC(4-40x.62)DEP-HOLD DOWN	87
REF	-	A	2-22603-0	SCR,HEX HD(8-32x.31)FEED FINGER	86
2	-	A	1-21000-3	SCR,SHC(4-40x.25)F ST GUIDE	85
REF	-	A	22733-9	SCR,BHC(8-32x.50 SL)STRIPPER	84
				83	
				82	
1	-	A	3-21000-4	SCR,SHC(10-32x.38)SG ADJ BL	81
				80	
				79	
				78	
2	-	B	463310-7	BLADE, STRIPPING (#24)	77
				76	
				75	
1	-	A	690603-1	SPRING, ASSIST	74
1	-	A	23030-1	SCR,SKT CAP(6-32x.25)CP DSC	73
				72	
				71	

QTY	REV	PART NO	DESCRIPTION	ITEM NO
-1	U/M	DWG SIZE	REVISION OF EACH ASSY NO (WHEN BLANK, USE DWG REVISION)	

QTY	REV	PART NO	DESCRIPTION	ITEM NO
-1	U/M	DWG SIZE	REVISION OF EACH ASSY NO (WHEN BLANK, USE DWG REVISION)	

- 1 RECOMMENDED SPARE PARTS.
- 2 GREASE LIGHTLY.
- 3 ITEM NOT SHOWN
- 4 CUT TO LENGTH AT ASSY.

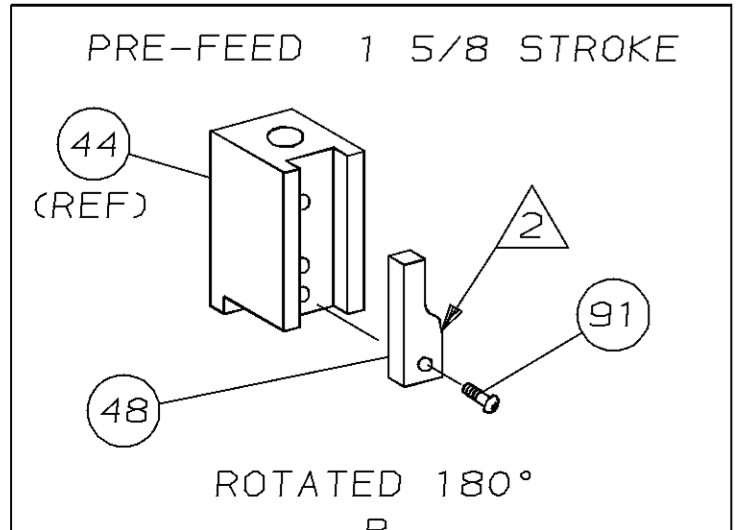

LOC A
DIST 66

DIMENSIONS IN INCHES. DO NOT SCALE PRINT. TOLERANCES UNLESS OTHERWISE SPECIFIED.

DR M. O'BRINE 11/3/94 APP 11-3-94 T. ELBIN
 2 PLC DEC +-
 3 PLC DEC +-
 4 PLC DEC +-
 ANGLES +-
 SURF TEXTURE: ✓
 REMOVE BURRS, BREAK SHARP EDGES R.015 MAX

MATL - HT TR - FIN -

DR C. ERISMAN 3/28/95 REL 3/28/95 B. MORGAN

NAME STRIPPER CRIMPER APPLICATOR MACHINE REF STRIPPER CRIMPER

SCALE - DWG NO 567909 SHEET 1 OF 1 REV A