

THIS DRAWING IS UNPUBLISHED. RELEASED FOR PUBLICATION
 © COPYRIGHT - By - ALL RIGHTS RESERVED.

LOC		DIST		REVISIONS			
P	LTR	DESCRIPTION		DATE	DWN	APVD	
G	14	A		REVISED PER ECO-14-003208	18MAR2014	NK	DR

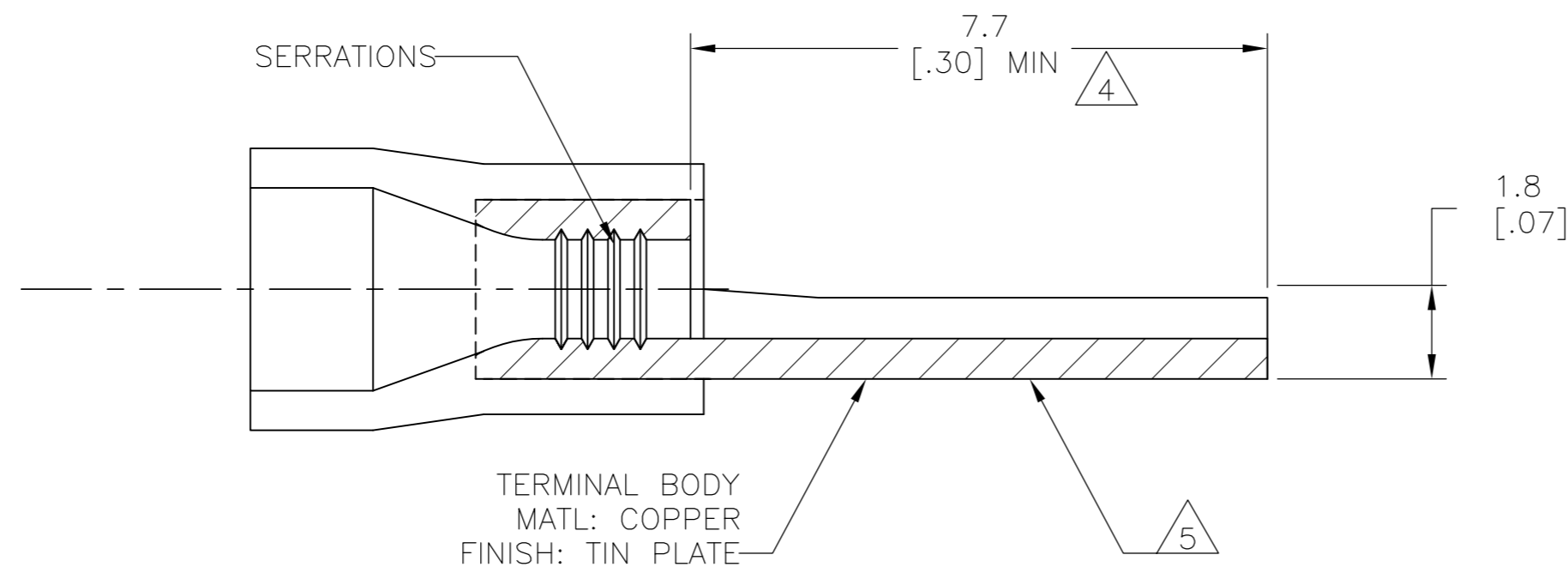
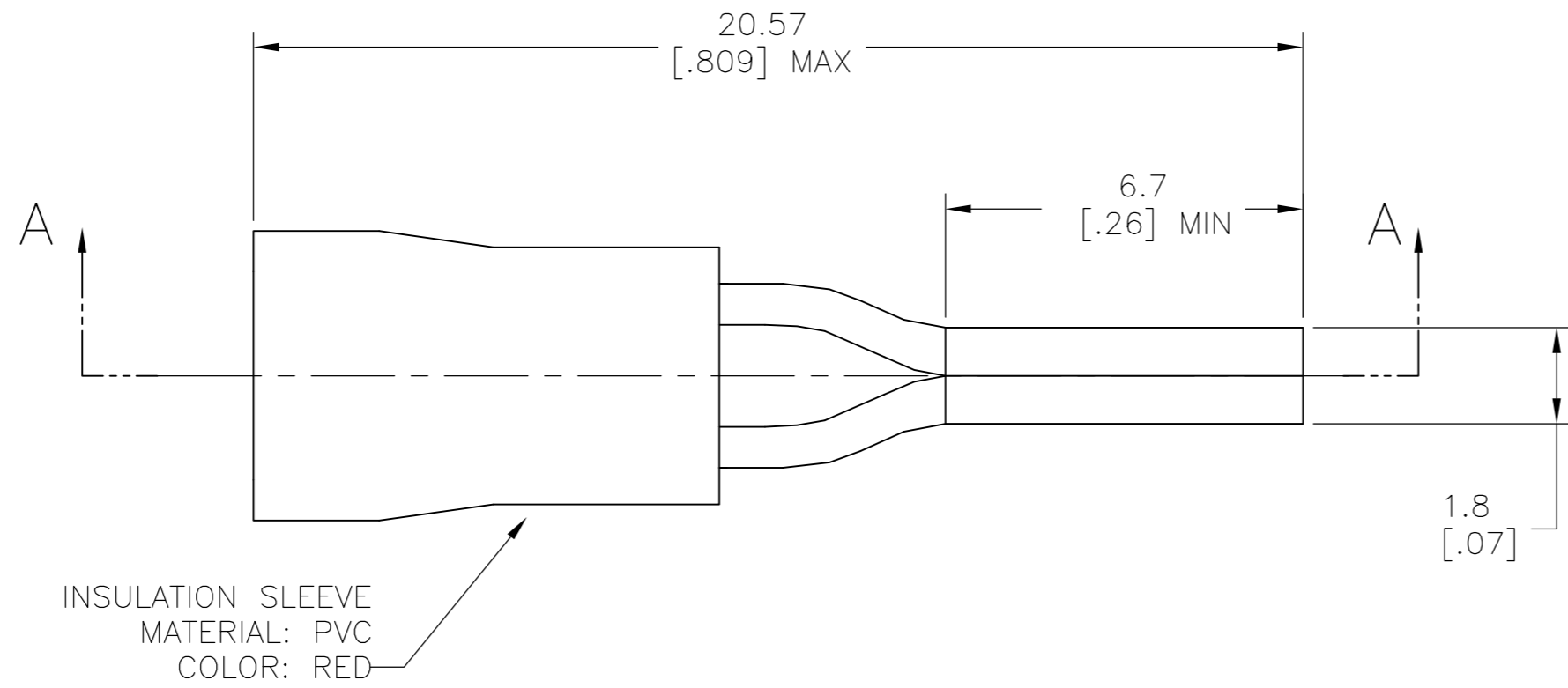

- 1 WIRE SIZE IS #22-#16 AWG
- 2 WIRE INSULATION DIA: 2.7 - 3.56[.11-.141]
- 3 MATERIAL THICKNESS IS 0.8[.03]
- 4 DIMENSION APPLIES FROM EDGE OF METAL WIRE BARREL TO END OF PIN
- 5 STAMP AMP 22-16* APPROX AS SHOWN
- 6 MAX RECOMMENDED OPERATING TEMPERATURE 105°C[221°F]

LOOSE PEICE	STANDARD	1000	181630
PACKAGING	LABELLING	QTY RED	PART NO

THIS DRAWING IS A CONTROLLED DOCUMENT.		DWN	jr ruth	02FEB06																		
DIMENSIONS: mm [INCHES]		CHK	T MICHIELUTTI	02FEB06																		
TOLERANCES UNLESS OTHERWISE SPECIFIED:		APVD	T MICHIELUTTI	02FEB06																		
<table border="1"> <tr><td>0 PLC</td><td>±</td><td>-</td></tr> <tr><td>1 PLC</td><td>±</td><td>0.50[.019]</td></tr> <tr><td>2 PLC</td><td>±</td><td>-</td></tr> <tr><td>3 PLC</td><td>±</td><td>-</td></tr> <tr><td>4 PLC</td><td>±</td><td>-</td></tr> <tr><td>ANGLES</td><td>±</td><td>1°</td></tr> </table>		0 PLC	±	-		1 PLC	±	0.50[.019]	2 PLC	±	-	3 PLC	±	-	4 PLC	±	-	ANGLES	±	1°	NAME	TERMINAL, WIRE PIN, PLASTI-GRIP,
0 PLC	±	-																				
1 PLC	±	0.50[.019]																				
2 PLC	±	-																				
3 PLC	±	-																				
4 PLC	±	-																				
ANGLES	±	1°																				
MATERIAL	FINISH	PRODUCT SPEC	-		SIZE	CAGE CODE	DRAWING NO	RESTRICTED TO														
-	-	APPLICATION SPEC	-		A2	00779	C=181630	-														
CUSTOMER DRAWING			WEIGHT	-	SCALE	8:1	SHEET	1 of 1														
			REV	A																		