

THIS DRAWING IS A CONTROLLED DOCUMENT.

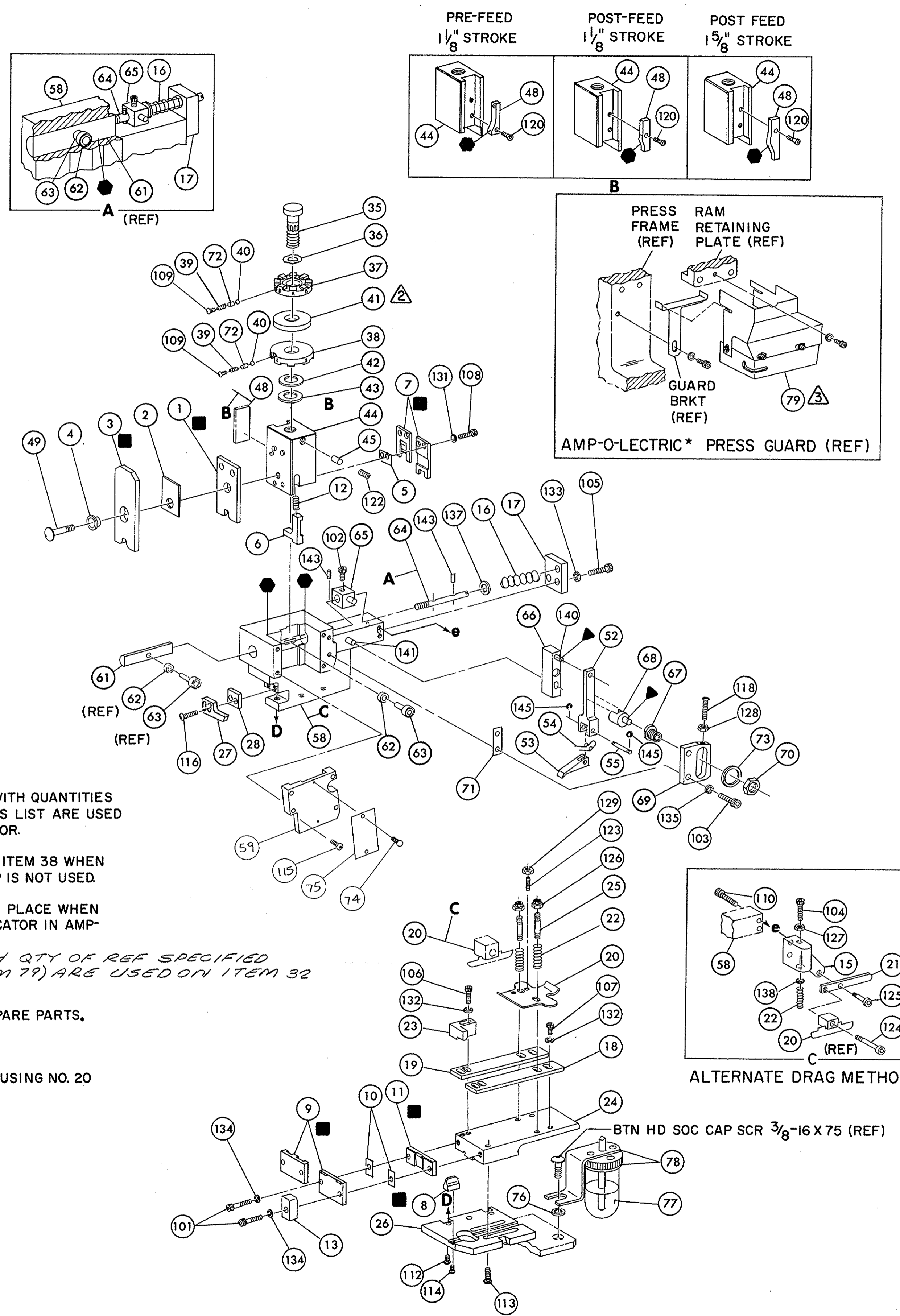

- NOTES:**
- 1. ONLY THE ITEMS WITH QUANTITIES SPECIFIED ON PARTS LIST ARE USED ON THIS APPLICATOR.
  - 2. USED IN PLACE OF ITEM 38 WHEN INSULATION CRIMP IS NOT USED.
  - 3. GUARD MUST BE IN PLACE WHEN OPERATING APPLICATOR IN AMP-O-LECTRIC PRESS.
  - 4. PARTS WITH QTY OF REF SPECIFIED (EXCEPT ITEM 79) ARE USED ON ITEM 32.
- KEY:**
- RECOMMENDED SPARE PARTS.
  - ▲ LUBRICATE DAILY USING NO. 20 MACHINE OIL.
  - GREASE LIGHTLY.

REF	QTY	PART NO	DESCRIPTION	ITEM NO
REF		21045-3	RING, RETAINING 'C' (.187 DIA) FEED PIN	145
REF		5-21028-1	PIN, SLOT SPG (.12 DIA X .50) FD ADJ ROD	143
REF		1-21030-7	PIN, DOWEL (.187 DIA X 1.50) HOUSING	141
REF		1-21030-1	PIN, DOWEL (.187 DIA X .50) LEVER	140
		22260-5	WASHER, FLAT (NO 6) DRAG SPRING	139
REF		21899-4	WASHER, FLAT (5/16 DIA) SCR ADJ	138
REF		21024-5	WASHER, LOCK (NO 10) FEED ADJ PLATE	136
2	1	7-21002-9	BOLT, CRIMPER	135
REF		21024-5	WASHER, LOCK (NO 10) SHEAR PLATES	134
REF		21024-5	WASHER, LOCK (NO 10) FEED ROD GUIDE	133
4	1	690501-3	CAM, POST FEED 1/8 STROKE	132
2	1	21024-4	WASHER, LOCK (NO 8) STRIP GUIDE	131
2	1	21024-4	WASHER, LOCK (NO 8) SHEAR BLADE	130
2	1	21018-4	NUT, HEX MACH (4-40) DRAG	129
REF		21068-5	NUT, HEX MACH (6-32) FD ADJ PLATE	128
		21018-7	NUT, HEX MACH (10-32) DRAG SPRING	127
2	2	21022-2	NUT, HEX SELF-LKG (8-32) DRAG STUD	126
		5-21004-7	SCR, SKT HD SHLD (250 DIA X .25) DRAG ARM	125
		21004-5	SCR, SKT HD SHLD (250 DIA X 1.00) DRAG	124
2	1	4-21078-8	SCR, SKT SET OVAL POINT (4-40 X .75) DRAG	123
1	1	21009-2	SCR, SKT SET (1/4-20 X 25) (LOC-WEL) RAM	122
1	1	2-21003-0	SCR, FLAT HD SKT CAP (6-32 X .50) CAM	121
REF		3-21064-2	SCR, RD HD MACH (6-32 X 1.50) FEED ADJ	120
2	2	2-21002-2	SCR, BTN HD SKT CAP (8-32 X .50) STRIPPER	119
REF		2-21002-9	SCR, BTN HD SKT CAP (10-32 X .75) HSG CAP	118
1	1	22733-8	SCR, BTN HD SKT CAP (8-32 X .38) (LOC-WEL) ANVIL	117
4	1	3-21002-3	SCR, BTN HD SKT CAP (1/4-20 X .50) STR GDE PL	116
REF		1-24073-9	SCR, BTN HD SKT CAP (1/4-20 X .75) BASE PL	115
		2-21000-4	SCR, SKT HD CAP (6-32 X 1.00) DRAG ADAPTOR	114
2	2	23030-1	SCR, SKT HD CAP (6-32 X .25) (LOC-WEL) CP DISC	113
2	2	2-21000-7	SCR, SKT HD CAP (8-32 X .50) SHEAR BLADE	112
3	2	2-21000-6	SCR, SKT HD CAP (8-32 X .38) STRIP GUIDE	111
1	2	2-21000-6	SCR, SKT HD CAP (8-32 X .38) STRIP GUIDE	110
REF		3-21000-7	SCR, SKT HD CAP (10-32 X .75) FD ROD GUIDE	109
		3-21000-9	SCR, SKT HD CAP (10-32 X 1.00) DRAG SPRING	108
REF		3-21000-6	SCR, SKT HD CAP (10-32 X .62) FD ADJ PLATE	107
REF		3-21000-4	SCR, SKT HD CAP (10-32 X .38) PIVOT BLK	106
2	1	3-21000-8	SCR, SKT HD CAP (10-32 X .88) SHEAR PLATE	105
REF		455745-1	GUARD, WINDOW	104
		465184-9	LUBRICATOR ASSY	103
		455985-1	OIL, LUBRICATING	102
		454406-1	SPACER, LUB BRACKET	101
1	1	461264-1	ID PLATE	79
2	1	21017-2	SCR, DRIVE (#2 X .19)	78
REF		458109-1	WASHER, FLAT (SPECIAL)	77
2	1	690603-1	SPRING, ASSIST	76
REF		690517-1	SPACER	75
		22594-8	NUT, HEX	74
		240628-1	PLATE, ADJ	73
		240626-1	SHAFT, PIVOT	72
		240633-1	BUSHING	71
		455680-1	LEVER, INTERMEDIATE	70
		240629-1	BLOCK, PIVOT	69
		240632-2	SCREW, ADJ	68
		240659-3	PIN, CAM ROLLER	67
		240658-1	CAM, ROLLER	66
REF		454398-1	ROD, FEED	65

CRIMPING DATA				APPLICATOR WILL APPLY	
PAD LTR	CRIMP HEIGHT	WIRE SIZE	WIRE STRIP LENGTH		
A	.081	16			61283
B	.075	18			35091606
C	.071	20			
D	.069	22			
CRIMP	SIZE	TYPE	FEED	APPL INST	
WIRE	.100	F		A18039	
INSUL	.180	F	.828		
WIRE RANGE	22-16	INSULATION RANGE	.100-.140	PRESS NO	565435-5

REMARKS	NO	REV
APPL USED ON MACHINE PART NO	MACH SERIAL NO	DISTRIBUTION
CUSTOMER NAME	APPL SERIAL NO	ORIGINAL
ADDRESS	PURCHASE ORDER	CUSTOMER COPY
CITY	ENG APP	FIELD ENG COPY

AMP INCORPORATED Harrisburg, Pa.

AMP O-LECTRIC POST FEED

MINIATURE QUICK CHANGE APPLICATOR

AMP 466124-3

END FEED RING

CUSTOMER AND ASSEMBLY DRAWING