

DRAWING MADE IN THIRD ANGLE PROJECTION

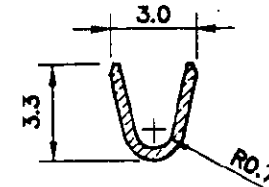

SECTION A-A

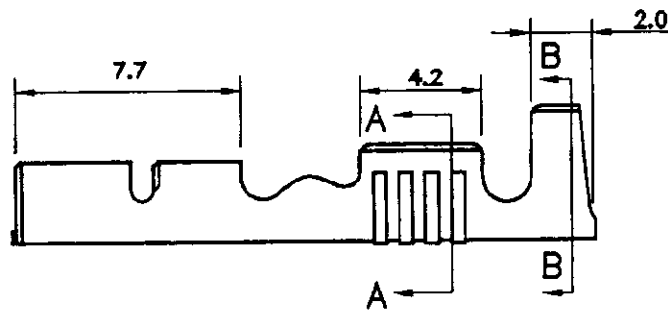
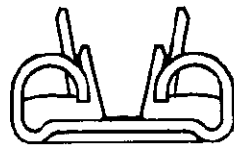
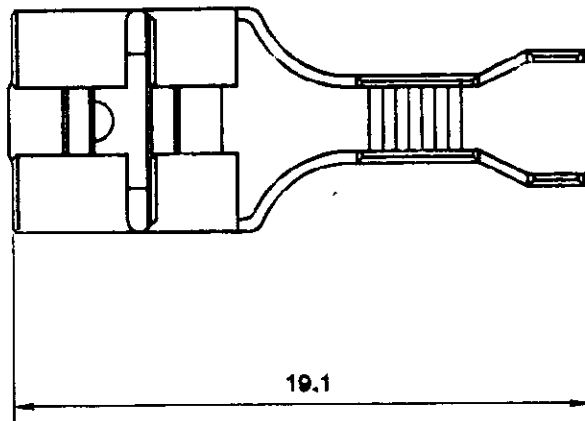
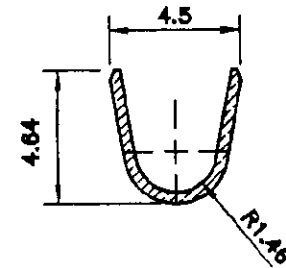

SECTION B-B

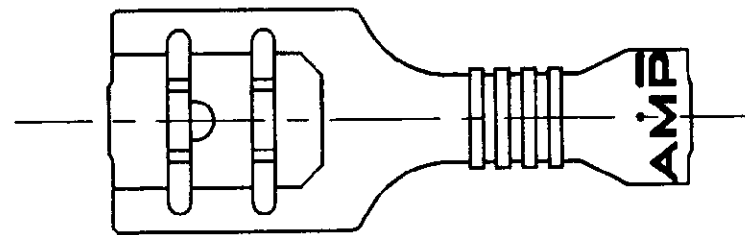

NOTE 1:
THE FIRST INSERTION SHALL
NOT BE MORE THAN 45N
2:
ALL OTHER SPECIFICATIONS
ARE IN COMPLIANCE TO AS3169.

3 OBSOLETE PARTS: OBSOLETE CIS STREAMLINING PER D.RENAUD/D.SINISI

THIS INFORMATION IS CONFIDENTIAL AND DISCLOSED TO YOU ON CONDITION THAT NO FURTHER DISCLOSURE IS MADE BY YOU TO OTHER THAN AMP PERSONNEL WITHOUT WRITTEN AUTHORIZATION FROM AUSTRALIAN AMP

CONTROLLED

3 OBSOLETE

WIRE RANGE: 0.5-1.5 sq mm

INSULATION RANGE: #2.29-3.3 mm

-	PRE TIN	BRASS	190713-7
-	TIN PLATED	BRASS	190713-4
REMARKS	FINISH	MATERIAL	PART No

SIZE 0.4±0.013X19.3±0.05			
DATE 25/01/95	CHK VK	AMP Australia AMP Pty. Limited Hobart Avenue, CHELSEA VIC 3192	
DR RP	APP BL 8.CM		
NAME			LOC CODE U
RECEPTACLE, FASTON, LOW INSERTION FORCE, 0.250			
SCALE AS SHOWN	SIZE A3	DWG No. C-190713	SHEET 1 OF 1
REV A	REV A1		

A1	REVISED PER ECO-09-022178	AEG	21SEP09
A	ECN FA 00 0003 95	BL	17/3/95
P	F	LTR	REVISION RECORD
APP	DATE		

CUSTOMER DRAWING

ORIGINAL

8 7 6 5 4 3 2 1