

4 3 2 1

used for: D-SUB HD

POS.	A ^{-0.76}	B ^{-0.25}	C	PART-NO.
15	31.19	16.46	25.00 ^{+0.12} / _{-0.13}	302A10869X
26	39.52	24.79	33.30 ^{+0.15} / _{-0.1}	302A10879X
44	53.42	38.50	47.04 ±0.13	302A10889X
62	69.70	54.96	63.50 ±0.13	302A10899X

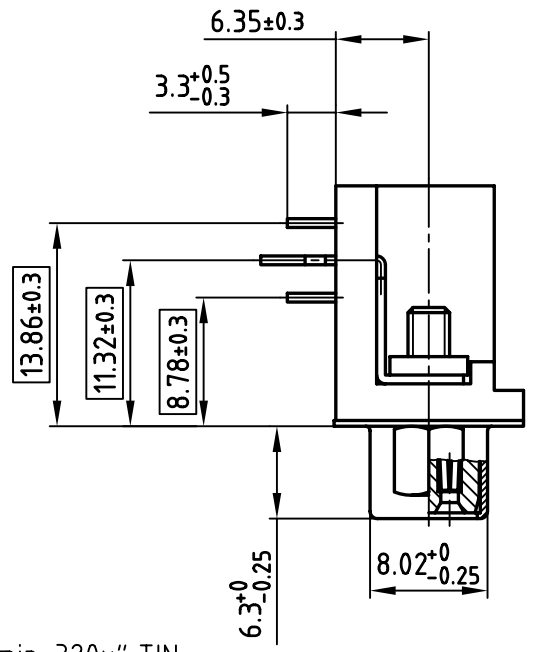
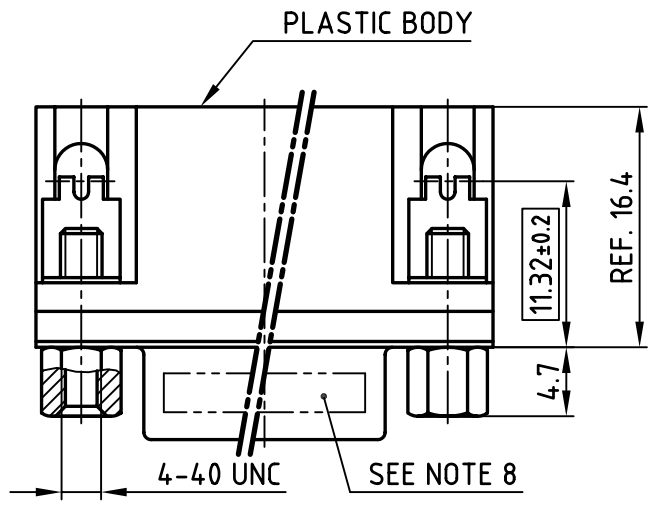
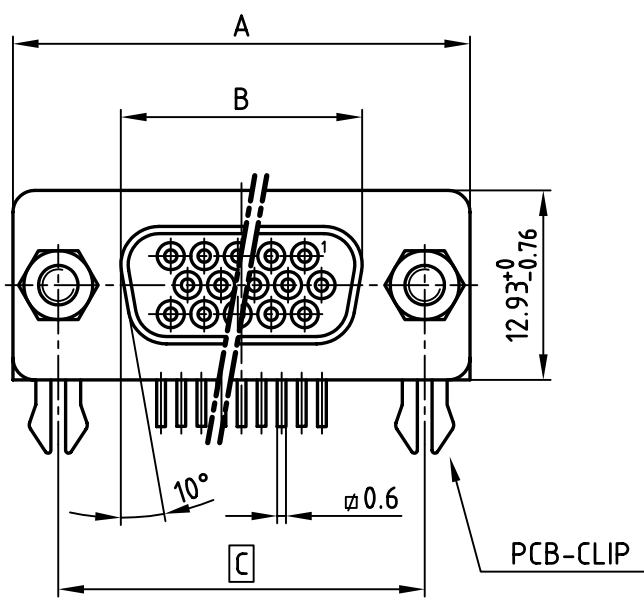

NOTES:

1. METALSHELLS: STEEL; min. 320µ" TIN
2. INSULATORS: PBT GF UL 94 V-0, BLACK
3. CONTACTS: COPPER ALLOY
4. PLATING: 8µ" HARD GOLD OVER min. 50µ" NICKEL
5. THREADED INSERT: COPPER ALLOY; min. 200µ" TIN over 80µ" NICKEL
6. PCB-SNAP: COPPER ALLOY; min. 200µ" TIN over 80µ" NICKEL
7. P.C.B. HOLE DRILLINGS SEE DRAWING 16V11H6B
8. CONNECTOR IS PART MARKED: PART NO. CONEC Y/WW
9. = CRITICAL DIMENSIONS

Directive 2002/95/EC
"RoHS"
Compliant

APPROVAL # FREIGABE # DEBLOCAGE # AUTORIZACION # APPROVAL	
CUSTOMER APPROVAL DATE:	
NAME:	TITLE:
COMPANY NAME:	
APPROVAL # FREIGABE # DEBLOCAGE # AUTORIZACION # APPROVAL	

THIS DRAWING MAY NOT BE COPIED OR REPRODUCED IN ANY WAY, AND MAY NOT BE PASSED ON TO A THIRD PARTY WITHOUT WRITTEN PERMISSION.
OWNERSHIP AND COPYRIGHT OF CONEC GmbH
DO NOT ALTER CAD DRAWING BY HAND

tolerance		dim. in mm	
2002	date	name	
drawn	08.01.	Parei	
appd.	10.01.	Schrader	
norm			
d-old			
1 x b	Ä 2086	29.09.2004	Schmidt
rev.	description	date	name



scale:	2:1	
material:	SEE NOTES	
title:		
D-SUB HD FEMALE 90° 15-62pos. with threaded lock 4-40 UNC		
dwg no:	AutoCAD 2000	DIN-A
	16K1A425A	4
part no:	SEE TABLE	
		sh: 1/1

4 3 2 1