

THIS COPY IS PROVIDED ON A RESTRICTED BASIS AND IS NOT TO BE USED IN ANY WAY DETRIMENTAL TO THE INTERESTS OF PANDUIT CORP.

PANDUIT P/N	WEIGHT
CPN	.05 LB/EACH [24g /EACH]

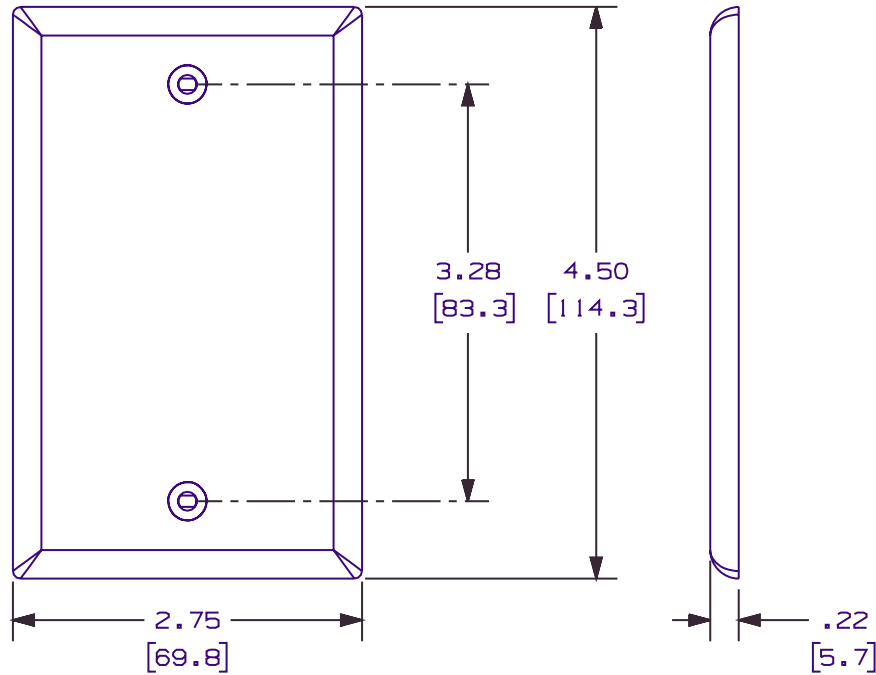

NOTES:

- SEE CURRENT CATALOG FOR ADDITIONAL PART SUFFIXES TO INDICATE COLOR AND/OR PACKAGE QUANTITY.
- TWO (2) #6-32 X 1/2" SLOTTED OVAL HEAD SCREWS ARE INCLUDED WITH FACEPLATE.
- DIMENSIONS IN PARENTHESIS ARE IN METRIC.

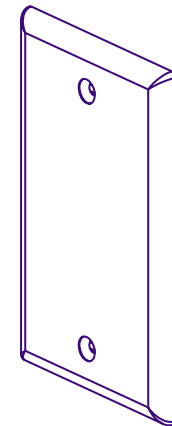

CAD FILENAME/LAYERS		D37876BB_DC_CP_N_03A.PRT	
PANDUIT		CORP. TINLEY PARK, ILLINOIS	
70mm BLANK SCREW-ON FACEPLATE (CPN) CUSTOMER DRAWING			
UNLESS OTHERWISE SPECIFIED, DIMENSIONAL TOLERANCES ARE: (.X) ± (.XXX) ± (.XX) ± .03(.8) ANGLES ±		UNLESS OTHERWISE SPECIFIED, ALL DIMENSIONS ARE GIVEN IN INCHES, THIRD ANGLE PROJECTION.	
DRAWN BY REWE	MAT'L: ABS	SCALE NONE	
DATE 5-11-01		DRAWING NO. 37876-04	DWG SIZE A
CHK'D CSH			

REV	DATE	BY	CHK	DESCRIPTION	ECN	R	CUST	SUP
R	5-11-01	REWE	CSH	RELEASED TO PRODUCTION	37876-04	HIW		