

THIS IS A CONTROLLED DOCUMENT.

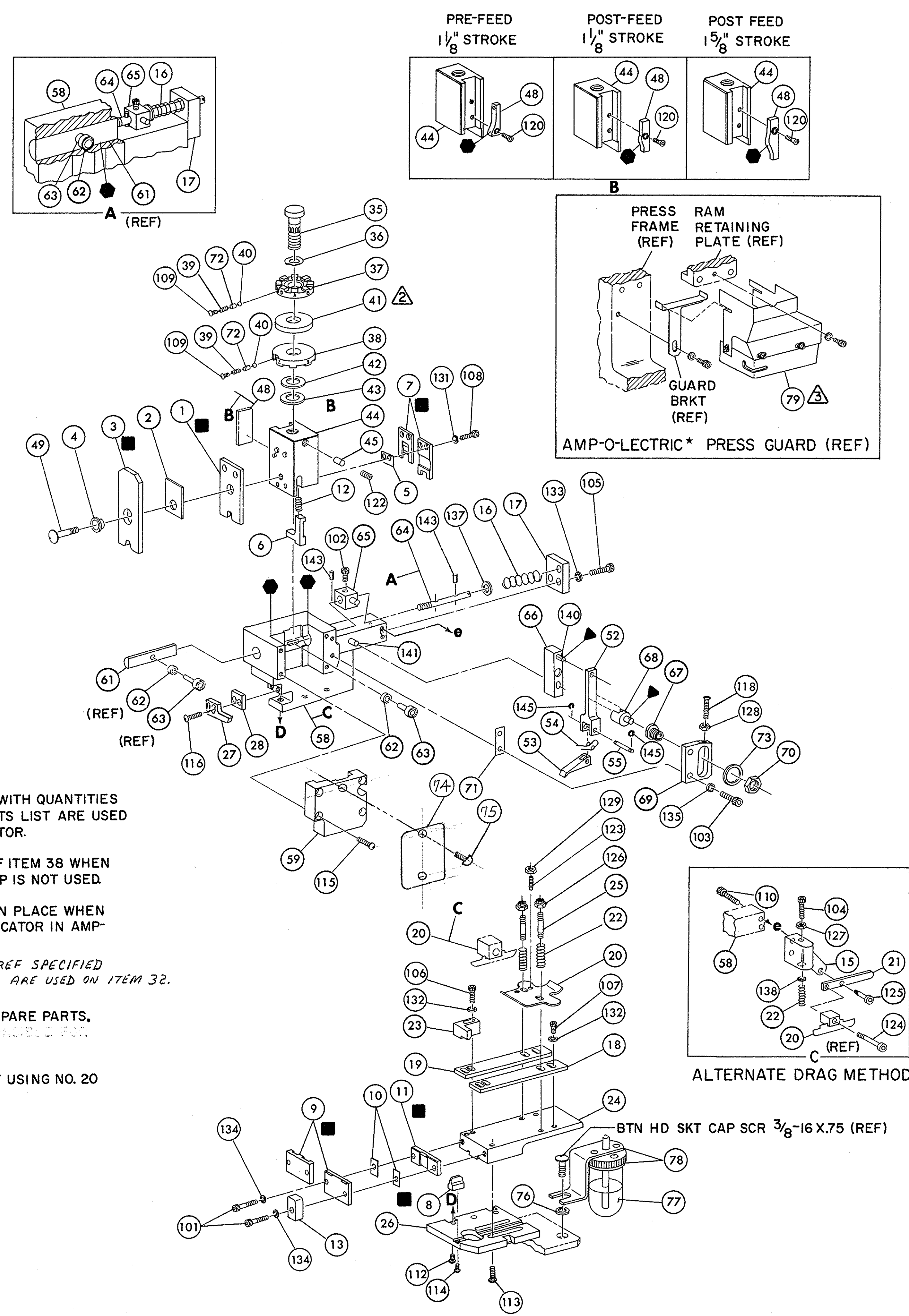

- NOTES:**
- ONLY THE ITEMS WITH QUANTITIES SPECIFIED ON PARTS LIST ARE USED ON THIS APPLICATOR.
 - USED IN PLACE OF ITEM 38 WHEN INSULATION CRIMP IS NOT USED.
 - GUARD MUST BE IN PLACE WHEN OPERATING APPLICATOR IN AMP-O-LECTRIC PRESS.
 - ITEMS WITH QTY REF SPECIFIED (EXCEPT ITEM 79) ARE USED ON ITEM 32.
- KEY:**
- RECOMMENDED SPARE PARTS.
 - LUBRICATE DAILY USING NO. 20 MACHINE OIL.
 - GREASE LIGHTLY.

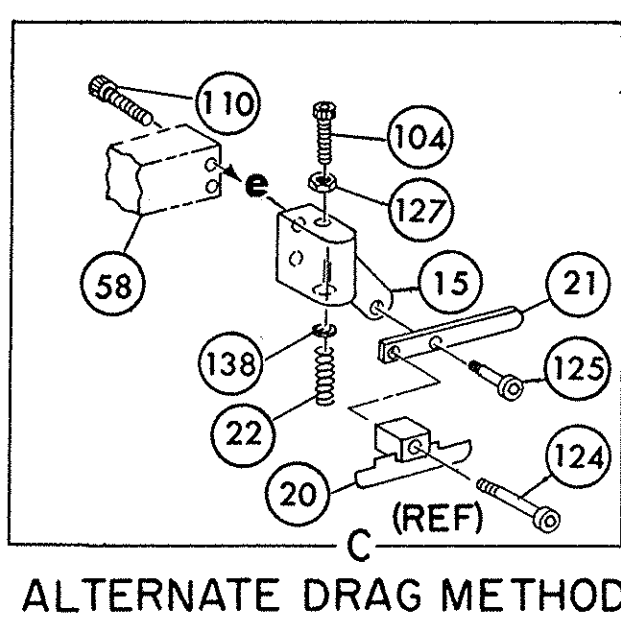

REF	QTY	PART NO	DESCRIPTION	ITEM NO
REF	145	21045-3	RING, RETAINING 'C' (.187 DIA) FEED PIN	145
REF	144	5-21028-1	PIN, SLOT SPG (.12 DIA X .50) FD ADJ ROD	144
REF	142	1-21030-7	PIN, DOWEL (.187 DIA X 1.50) HOUSING	142
REF	140	1-21030-1	PIN, DOWEL (.187 DIA X .50) LEVER	140
REF	139	21899-1	WASHER, FLAT (NO 6) DRAG SPRING	139
REF	138	21899-4	WASHER, FLAT (5/16 DIA) SCR ADJ	138
REF	136	21024-5	WASHER, LOCK (NO 10) FEED ADJ PLATE	136
REF	135	21024-5	WASHER, LOCK (NO 10) SHEAR PLATES	135
REF	134	21024-5	WASHER, LOCK (NO 10) FEED ROD GUIDE	134
REF	133	21024-4	WASHER, LOCK (NO 8) STRIP GUIDE	133
REF	132	21024-4	WASHER, LOCK (NO 8) SHEAR BLADE	132
REF	131	21018-4	NUT, HEX MACH (4-40) DRAG	131
REF	130	21018-5	NUT, HEX MACH (6-32) FD ADJ PLATE	130
REF	129	21018-7	NUT, HEX MACH (10-32) DRAG SPRING	129
REF	128	21022-2	NUT, HEX SELF-LKG (8-32) DRAG STUD	128
REF	127	5-21004-7	SCR, SKT HD SHLD (250 DIA X .50) DRAG ARM	127
REF	126	21004-5	SCR, SKT HD SHLD (250 DIA X 1.00) DRAG	126
REF	125	4-21078-8	SCR, SKT SET OVAL POINT (4-40 X .75) DRAG	125
REF	124	21009-2	SCR, SKT SET (1/4-20 X 25) (LOC-WEL) RAM	124
REF	123	1-21002-7	SCR, BTN HD SKT CAP (6-32 X .38) CAM	123
REF	122	6-23715-5	SCR, PAN HD MACH (6-32 X 1.50) FEED ADJ	122
REF	121	22733-8	SCR, BTN HD SKT CAP (8-32 X .38) STRIPPER	121
REF	120	2-21002-9	SCR, BTN HD SKT CAP (10-32 X .75) HSG CAP	120
REF	119	22733-8	SCR, BTN HD SKT CAP (8-32 X .38) (LOC-WEL) ANVIL	119
REF	118	3-21002-3	SCR, BTN HD SKT CAP (1/4-20 X .50) STR GDE PL	118
REF	117	17177-1	SCR, BTN HD SKT CAP (1/4-20 X .62) BASE PL	117
REF	116	2-21000-4	SCR, SKT HD CAP (6-32 X 1.00) DRAG ADAPTOR	116
REF	115	23030-1	SCR, SKT HD CAP (6-32 X .25) (LOC-WEL) CP DISC	115
REF	114	2-21000-8	SCR, SKT HD CAP (8-32 X .62) SHEAR BLADE	114
REF	113	2-21000-6	SCR, SKT HD CAP (8-32 X .38) STRIP GUIDE	113
REF	112	2-21000-6	SCR, SKT HD CAP (8-32 X .38) STRIP GUIDE	112
REF	111	3-21000-7	SCR, SKT HD CAP (10-32 X .75) FD ROD GUIDE	111
REF	110	3-21000-9	SCR, SKT HD CAP (10-32 X 1.00) DRAG SPRING	110
REF	109	3-21000-6	SCR, SKT HD CAP (10-32 X .62) FD ADJ PLATE	109
REF	108	3-21000-4	SCR, SKT HD CAP (10-32 X .38) PIVOT BLK	108
REF	107	4-55745-1	SCR, SKT HD CAP (10-32 X .88) SHEAR PLATE	107
REF	106	455745-1	GUARD, WINDOW	106
REF	105	465184-9	LUBRICATOR ASSY	105
REF	104	455985-1	OIL, LUBRICATING	104
REF	103	454406-1	SPACER, LUB BRACKET	103
REF	102	21017-2	SCR, DRIVE (#2 X .19)	102
REF	101	461264-1	PLATE, IDENTIFICATION	101
REF	100	458109-1	WASHER, FLAT (SPECIAL)	100
REF	99	690603-1	SPRING, ASSIST	99
REF	98	690517-1	SPACER	98
REF	97	22594-8	NUT, HEX	97
REF	96	240628-1	PLATE, ADJ	96
REF	95	240626-1	SHAFT, PIVOT	95
REF	94	240633-1	BUSHING	94
REF	93	455680-1	LEVER, INTERMEDIATE	93
REF	92	240629-1	BLOCK, PIVOT	92
REF	91	240632-2	SCREW, ADJ	91
REF	90	240659-3	PIN, CAM ROLLER	90
REF	89	240658-1	CAM, ROLLER	89
REF	88	454398-1	ROD, FEED	88
REF	87	454220-1	CAP, RAM	87
REF	86	453736-1	HOUSING	86
REF	85	240624-1	PIN, FEED FINGER	85
REF	84	691499-1	SPRING, FEED FINGER	84
REF	83	240635-1	FINGER, FEED	83
REF	82	240634-1	LEVER, TERMINAL	82
REF	81	690686-2	BOLT, CRIMPER	81
REF	80	690501-4	CAM, POST FEED 1 3/8 STROKE	80
REF	79	690191-1	PLUG, NYLON	79
REF	78	455674-1	RAM	78
REF	77	690125-1	WASHER, LAMINATED	77
REF	76	690124-4	WASHER, RAM	76
REF	75	23241-6	SPACER, DISC	75
REF	74	690170-1	BALL, STEEL	74
REF	73	690142-1	SPRING, COMPRESSION	73
REF	72	9-692155-6	DISC, INSULATION	72
REF	71	22480-5	DISC, WIRE	71
REF	70	690212-1	WASHER, SPRING	70
REF	69	458980-1	POST, RAM	69
REF	68	458980-1	APPLICATOR, BASIC (SUB ASSY)	68
REF	67	1-690451-1	SPACER, STRIPPER	67
REF	66	240639-1	STRIPPER	66
REF	65	455676-1	PLATE, BASE	65
REF	64	22354-8	DRAG, STUD	64
REF	63	455678-1	PLATE, STRIP GUIDE	63
REF	62	4-22281-1	PLATE, STRIP HOLD	62
REF	61	240636-1	SPRING, DRAG	61
REF	60	454177-1	LEVER, DRAG	60
REF	59	2-458030-8	DRAG, STOCK	59
REF	58	2-458031-8	GUIDE, STRIP (REAR)	58
REF	57	454178-1	GUIDE, STRIP (FRONT)	57
REF	56	4-22284-9	GUIDE, FEED ROD	56
REF	55	455745-1	SPRING, FEED RETURN	55
REF	54	455745-1	ADAPTER, DRAG	54
REF	53	465184-9	SPACER, HOLD DOWN	53
REF	52	455985-1	SPRING, HOLD DOWN	52
REF	51	454406-1	PLATE, REAR SHEAR	51
REF	50	21017-2	SPACER, SHEAR PLATE	50
REF	49	461264-1	PLATE, FRONT SHEAR	49
REF	48	458109-1	ANVIL	48
REF	47	690603-1	BLADE, SLUG	47
REF	46	690517-1	HOLD DOWN, TERMINAL	46
REF	45	22594-8	SPACER, SHEAR BLADE	45
REF	44	240628-1	SPACER, TUBULAR	44
REF	43	240626-1	CRIMPER, INSULATION	43
REF	42	240633-1	SPACER, INSULATION	42
REF	41	455680-1	CRIMPER, WIRE	41

QTY	PART NO	DESCRIPTION	ITEM NO
62	240658-1	CAM, ROLLER	62
61	454398-1	ROD, FEED	61
60			60
59			59

CRIMPING DATA				APPLICATOR WILL APPLY	
PAD LTR	CRIMP HEIGHT	WIRE SIZE	WIRE STRIP LENGTH		
A	.121	12			40604
B	.112	14			40605
C	.107	16			40606
D	NOT USED				40609
					40960
					40973
WIRE	.190	F			60401
INSUL	.250	F	1.085	A1 8039	640059
WIRE RANGE	14-12	INSULATION RANGE	.130-.180	PRESS NO	63581

REMARKS	NO	REV
APPL USED ON MACHINE PART NO	TO APPLY TERMINAL SPEC 114-2084	
CUSTOMER NAME	APPL SERIAL NO	DISTRIBUTION
ADDRESS	PURCHASE ORDER	ORIGINAL
CITY	ENG APP	CUSTOMER COPY
		FIELD ENG COPY

AMP-O-MATOR
POST-FEED

REF ID PLATE: 461264-1