

P	LTR	DESCRIPTION	DATE	DWN	APVD
	A1	REVISED PER ECR-20-012513	04SEP2020	BDA	KR

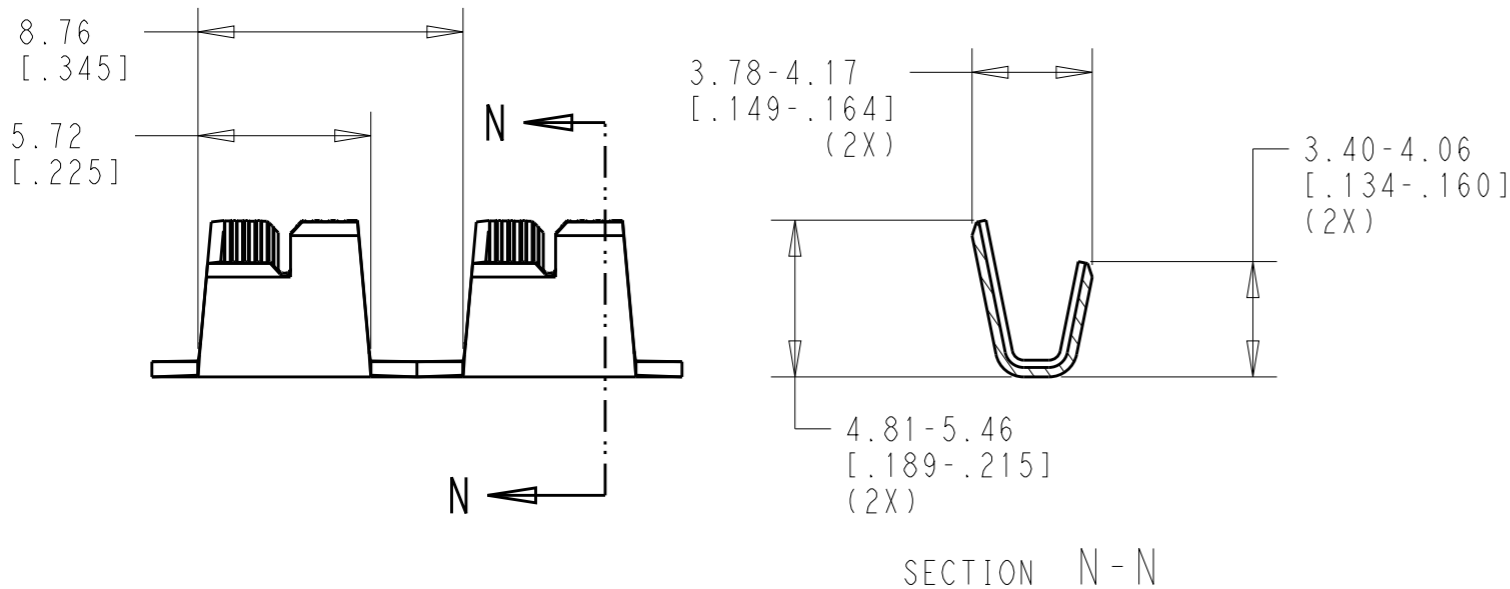
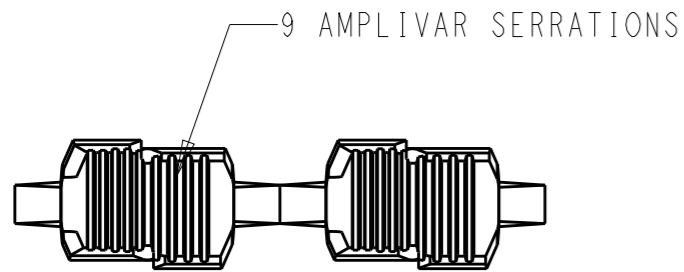

1. PRODUCT PROVIDED IN STRIP FORM ON REELS; BREAKS MAY BE PRESENT.
2. DIMENSIONS IN BRACKETS ARE IN INCHES.
3. CRIMP WIDTH ( $\pm 0.13\text{mm}$  [ $\pm 0.005$  IN]):  $3.30\text{mm}$  [.130 IN] (2D CRIMP FORM)  
CRIMP HEIGHT ( $\pm 0.05\text{mm}$  [ $\pm 0.002$  IN]): (TOTAL CMA + 10,350) / 210,000  
  
GENERAL APPLICATION GUIDELINES MUST BE FOLLOWED AS SPECIFIED IN CATALOG #TBD. FOR APPLICATOR INFORMATION CALL: 1-800-722-1111  
FOR PRODUCT INFORMATION CALL: 1-800-522-6752
4. WIRE RANGE: 600 - 7000 CMA PERTAINS TO WIRE COMBINATIONS IN CUSTOMER'S DEVICE. IF CUSTOMER'S WIRE COMBINATION TOTALS 600 - 1699 CMA, THIS WILL REQUIRE THE INCLUSION OF A SHORT PIECE OF 18 AWG STRANDED WIRE INTO THE WIRE BBL VIA USE OF A TE AUTOMATIC WIRE STUFFER DEVICE. THIS BUILDS THE TOTAL CMA BEYOND A MINIMUM OF 1700 CMA REQUIRED FOR ACCURATE CQM (CRIMP QUALITY MONITORING) TO ASSURE PRESENCE OF ALL WIRES IN THE TERMINATIONS. APPLICATIONS WHERE TOTAL CMA FALLS BETWEEN 1700 - 7000 CMA WILL NOT REQUIRE INCLUSION OF THE 18 AWG STUFFER WIRE

2238236-1

PART NUMBER

THIS DRAWING IS A CONTROLLED DOCUMENT.		DWN B. WEAVER 27AUG2019			NAME SPLICE, PIGTAIL, AMPLIVAR, 9 SERRATIONS, 2D 600-7000 CMA		
DIMENSIONS: mm [IN]		CHK K. RANDOLPH 27AUG2019					
TOLERANCES UNLESS OTHERWISE SPECIFIED:		APVD S. KUMAR 27AUG2019					
0 PLC $\pm$ - 1 PLC $\pm$ - 2 PLC $\pm 0.38$ [.015] 3 PLC $\pm$ - 4 PLC $\pm$ - ANGLES $\pm 1^\circ$		PRODUCT SPEC 108-143147					
MATERIAL 0.51 $\pm$ 0.03 [.020 $\pm$ .001]BRASS		FINISH TIN PLATE	APPLICATION SPEC 114-143147	SIZE A3	CAGE CODE 00779	DRAWING NO C-2238236	RESTRICTED TO -
CUSTOMER DRAWING			WEIGHT -	SCALE 4:1	SHEET 1 OF 1	REV A1	