

6 5 4 3 2 1

APPROVED: \_\_\_\_\_  
DATE: \_\_\_\_\_ TITLE: \_\_\_\_\_

Rev	AWO #	Description	Date	Appr
-		RELEASED	11/1/19	

BACK VIEW

BACK VIEW

SECTION A-A

SPECIFICATIONS:

Material:  
Insulator: Hi-temp thermoplastic, rated UL 94V-0  
Insulator color: Black  
Contacts: Copper Alloy  
Shielding: Stainless Steel, Nickel plated  
Shell: Stainless Steel, Nickel plated  
EMI Shell: Stainless Steel  
Plating:  
Gold flash over Nickel underplate overall  
Electrical:  
Current rating: 6A (Vbus & GND Contacts)  
Contact resistance: 40 mohms max  
Insulation resistance: 100 Mohms min  
Dielectric withstanding voltage: 100 VAC for 1 minute  
Environmental:  
Lead free, RoHS compliant.

UNLESS OTHERWISE SPECIFIED  
ALL DIMENSIONS ARE INCHES [MM]  
TOLERANCES: EXCEPT AS NOTED

INCHES		HOLES	
.X	± .10	Ø.X	± .10
.XX	± .020	Ø.XX	± .015
.XXX	± .015	Ø.XXX	± .010

APPROVALS		DATE
DRAWN	AY	11/1/19
CHECKED	KL	11/1/19
APPROVED		

**ADAM TECH INTERCONNECTS**  
909 Rahway Avenue,  
Union, NJ 07083  
Phone: 908-687-5000  
Fax: 908-687-5710

TITLE: **USB TYPE C, FEMALE, WATER PROOF, EDGE HANG TYPE, WITH FLANG**

SIZE X	PART NO. USB-C31-S-RA-EH-WP-WF-BK-CS5	REV. -
REF: S00288T	SCALE: NTS	SHEET 1 OF 2

6 5 4 3 2 1

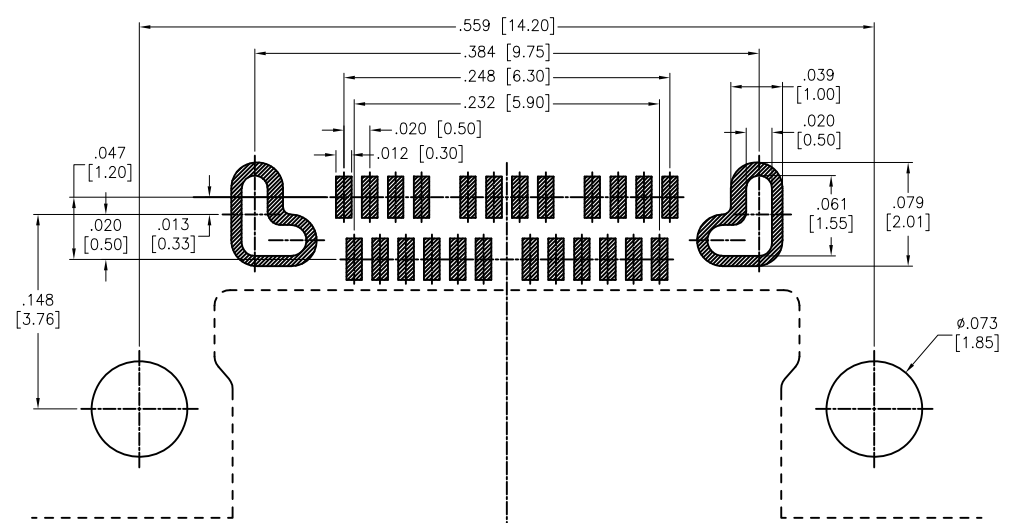

RECOMMENDED PCB LAYOUT

Pin	Signal Name	Description	Mating Sequence	Pin	Signal Name	Description	Mating Sequence
A1	GND	Ground return	First	B12	GND	Ground return	First
A2	SSTXp1	Positive half of first SuperSpeed TX differential pair	Second	B11	SSRXp1	Positive half of first SuperSpeed RX differential pair	Second
A3	SSTXn1	Negative half of first SuperSpeed TX differential pair	Second	B10	SSRXn1	Negative half of first SuperSpeed RX differential pair	Second
A4	VBUS	Bus Power	First	B9	VBUS	Bus Power	First
A5	CC1	Configuration Channel	Second	B8	SBU2	Sideband Use	Second
A6	Dp1	Positive half of the USB2.0 differential pair-Position 1	Second	B7	Dn2	Negative half of the USB2.0 differential pair-Position 2	Second
A7	Dn1	Negative half of the USB2.0 differential pair-Position 1	Second	B6	Dp2	Positive half of the USB2.0 differential pair-Position 2	Second
A8	SBU1	Sideband Use	Second	B5	CC2	Configuration Channel	Second
A9	VBUS	Bus Power	First	B4	VBUS	Bus Power	First
A10	SSRXn2	Negative half of second SuperSpeed RX differential pair	Second	B3	SSTXn2	Negative half of second SuperSpeed TX differential pair	Second
A11	SSRXp2	Positive half of second SuperSpeed RX differential pair	Second	B2	SSTXp2	Positive half of second SuperSpeed TX differential pair	Second
A12	GND	Ground return	First	B1	GND	Ground return	First

UNLESS OTHERWISE SPECIFIED ALL DIMENSIONS ARE INCHES [MM] TOLERANCES: EXCEPT AS NOTED INCHES HOLES		
.X ± .10	Ø.X ± .10	
.XX ± .020	Ø.XX ± .015	
.XXX ± .015	Ø.XXX ± .010	
APPROVALS		DATE
DRAWN	AY	11/1/19
CHECKED	KL	11/1/19
APPROVED		

		909 Rahway Avenue, Union, NJ 07083 Phone: 908-687-5000 Fax: 908-687-5710
<b>TITLE</b> USB TYPE C, FEMALE, WATER PROOF, EDGE HANG TYPE, WITH FLANG		
SIZE <b>X</b>	PART NO. <b>USB-C31-S-RA-EH-WP-WF-BK-CS5</b>	REV. -
REF: S00288T	SCALE: NTS	SHEET 2 OF 2