

0805 Multilayer Chip Inductors, High Frequency Applications

Special Features

- Monolithic construction provides high reliability
- High Q characteristic
- Ceramic material construction provides very stable electrical characteristics
- Operating temperature -25 to +105°C
- Current to cause 20°C temperature rise
- Tape & reel packaged
2000/ reel (1.25 thickness)
4000/ reel (0.85 thickness)

Typical Applications

- Small cellular phones
- PDAs
- Pagers
- Handheld organizers
- High-frequency wireless communication devices
- Notebook computers
- Printers
- Network cards
- Industrial electronics
- Entertainment electronic devices

PM0805H Series								
Part Number	L (nH) ± 0.3nH	Q Typ.	Test	Q Typ.	SRF	DCR	Thickness	
			Freq. (MHz)	@ 300 MHz	(MHz)	(Ω)	I, DC (mA)	Dim. A (mm)
PM0805H-1N5	1.5	10	100	50	6000	0.10	300	0.85
PM0805H-1N8	1.8	10	100	52	6000	0.10	300	0.85
PM0805H-2N2	2.2	11	100	53	6000	0.10	300	0.85
PM0805H-2N7	2.7	12	100	56	6000	0.10	300	0.85
PM0805H-3N3	3.3	13	100	56	6000	0.13	300	0.85
PM0805H-3N9	3.9	13	100	58	5400	0.15	300	0.85
PM0805H-4N7	4.7	14	100	58	4500	0.20	300	0.85
PM0805H-5N6	5.6	14	100	60	4000	0.23	300	0.85
± 5%								
PM0805H-6N8J	6.8	15	100	60	3650	0.25	300	0.85
PM0805H-8N2J	8.2	15	100	64	3000	0.28	300	0.85
PM0805H-10NJ	10	15	100	60	2500	0.30	300	0.85
PM0805H-12NJ	12	16	100	60	2450	0.35	300	0.85
PM0805H-15NJ	15	16	100	63	2200	0.40	300	0.85
PM0805H-18NJ	18	17	100	63	1750	0.45	300	0.85
PM0805H-22NJ	22	18	100	60	1700	0.50	300	0.85
PM0805H-27NJ	27	17	100	58	1550	0.55	300	0.85
PM0805H-33NJ	33	18	100	55	1350	0.60	300	0.85
PM0805H-39NJ	39	18	100	47	1300	0.65	300	0.85
PM0805H-47NJ	47	18	100	43	1200	0.70	300	0.85
PM0805H-56NJ	56	19	100	39	1150	0.75	300	0.85
PM0805H-68NJ	68	19	100	30	1000	0.80	300	0.85
PM0805H-82NJ	82	19	100	10	850	0.90	300	0.85
PM0805H-100NJ	100	23	100	-	700	0.90	300	1.25
PM0805H-120NJ	120	16	50	-	650	0.95	300	1.25
PM0805H-150NJ	150	16	50	-	550	1.00	300	1.25
PM0805H-180NJ	180	16	50	-	500	1.10	300	1.25
PM0805H-220NJ	220	16	50	-	430	1.20	300	1.25
PM0805H-270NJ	270	18	50	-	650	0.95	300	1.25
PM0805H-330NJ	330	18	50	-	550	1.00	300	1.25
PM0805H-390NJ	390	18	50	-	500	1.10	300	1.25
PM0805H-470NJ	470	16	50	-	430	1.20	300	1.25

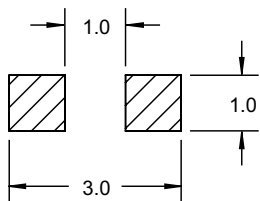
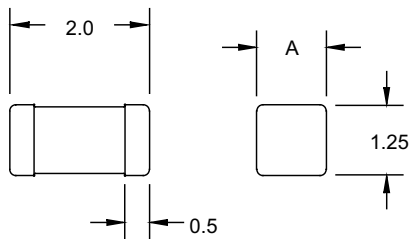

Pad Layout

Tol: ± 0.2
Dim: mm

J.W. Miller
M A G N E T I C S

306 E. Alondra Blvd., Gardena, CA 90247-1059 • (310) 515-1720 • FAX (310) 515-1962

www.jwmiller.com