

| P | LTR | DESCRIPTION | DATE | DWN | APVD |
|---|-----|-------------------------|----------|-----|------|
| | A | RELEASED FOR PRODUCTION | 06UG2019 | RK | PS |
| | | | | | |
| | | | | | |

1:1

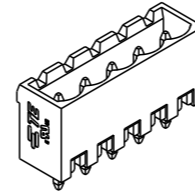

NOTES:

- MATERIAL AND FINISH:
HOUSING : POLYAMIDE 66, UL94V-0, COLOR GREEN.
TERMINAL : COPPER ALLOY, TIN PLATED.
 - MECHANICAL
MIN. PC BOARD HOLES DIAMETER : 1.5 mm
 - ELECTRICAL
RATED VOLTAGE : 300 V
RATED CURRENT : 16 A
INSULATION RESISTANCE : >2000 M Ohm (500V DC)
 - OPERATING TEMPERATURE RANGE: -40°C TO +105°C
- △ NOT CUMULATIVE TOLERANCE.

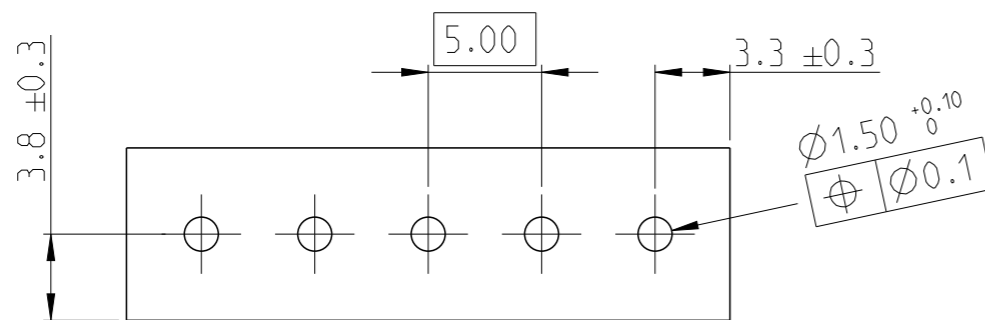
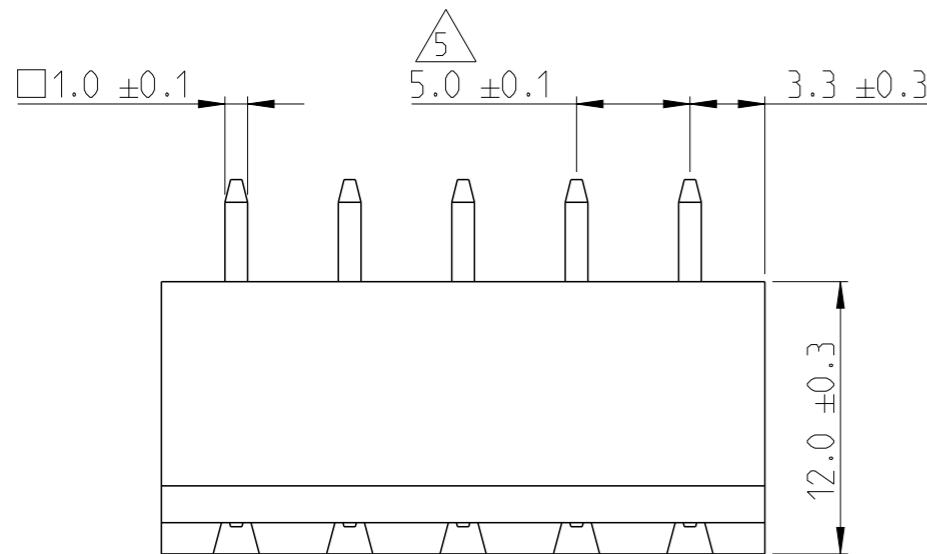
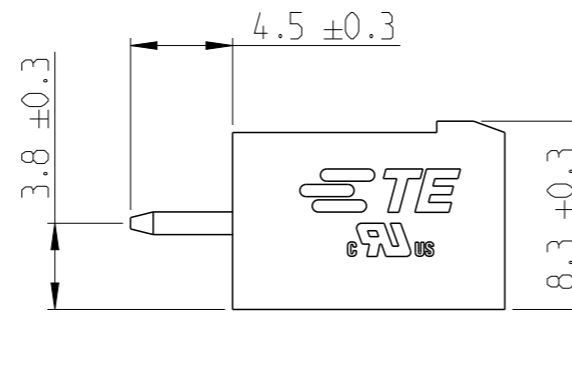
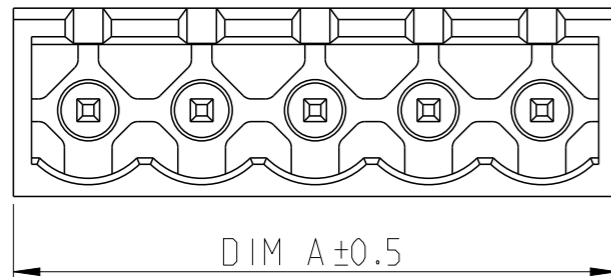

RECOMMENDED PC BOARD LAYOUT

| 81.6 | 16 | 1-2351885-6 |
|-------|------------|-------------|
| 76.6 | 15 | 1-2351885-5 |
| 71.6 | 14 | 1-2351885-4 |
| 66.6 | 13 | 1-2351885-3 |
| 61.6 | 12 | 1-2351885-2 |
| 56.6 | 11 | 1-2351885-1 |
| 51.6 | 10 | 1-2351885-0 |
| 46.6 | 9 | 2351885-9 |
| 41.6 | 8 | 2351885-8 |
| 36.6 | 7 | 2351885-7 |
| 31.6 | 6 | 2351885-6 |
| 26.6 | 5 | 2351885-5 |
| 21.6 | 4 | 2351885-4 |
| 16.6 | 3 | 2351885-3 |
| 11.6 | 2 | 2351885-2 |
| DIM A | NO. OF POS | PART NUMBER |

| | | | | |
|---|--|--------------------------------|--|--------------------|
| THIS DRAWING IS A CONTROLLED DOCUMENT. | | DWN 12APR2019 RAGHAVENDRA.K | TE Connectivity | |
| DIMENSIONS: mm | | CHK 01JUL2019 KARTHIK.JK | | |
| TOLERANCES UNLESS OTHERWISE SPECIFIED: | | APVD 02JUL2019 PRASHANTH.S | NAME HEADER 180 DEG. 5.0mm PITCH TAIL LENGTH 4.5mm | |
| 0 PLC ± 1 PLC ± 2 PLC ± 3 PLC ± 4 PLC ± ANGLES ± | | PRODUCT SPEC - | APPLICATION SPEC - | |
| MATERIAL SEE NOTES | | WEIGHT - | SIZE A3 | CAGE CODE 00779 |
| FINISH SEE NOTES | | DRAWING NO C-2351885 | | RESTRICTED TO - |
| CUSTOMER DRAWING | | | SCALE 3:1 | SHEET 1 OF 1 |
| | | | REV A | |