

|     |      |           |     |                           |         |     |      |
|-----|------|-----------|-----|---------------------------|---------|-----|------|
| LOC | DIST | REVISIONS |     |                           |         |     |      |
| F   | 7    | P         | LTR | DESCRIPTION               | DATE    | DWN | APVD |
|     |      | P         |     | REVISED PER ECO-11-005150 | 21MAR11 | RK  | HMR  |

- △1 SENS DE BOBINAGE STANDARD (POUR APPLICATEUR STANDARD).
- △2 SENS DE BOBINAGE INVERSE (POUR MINI-APPLICATEUR).

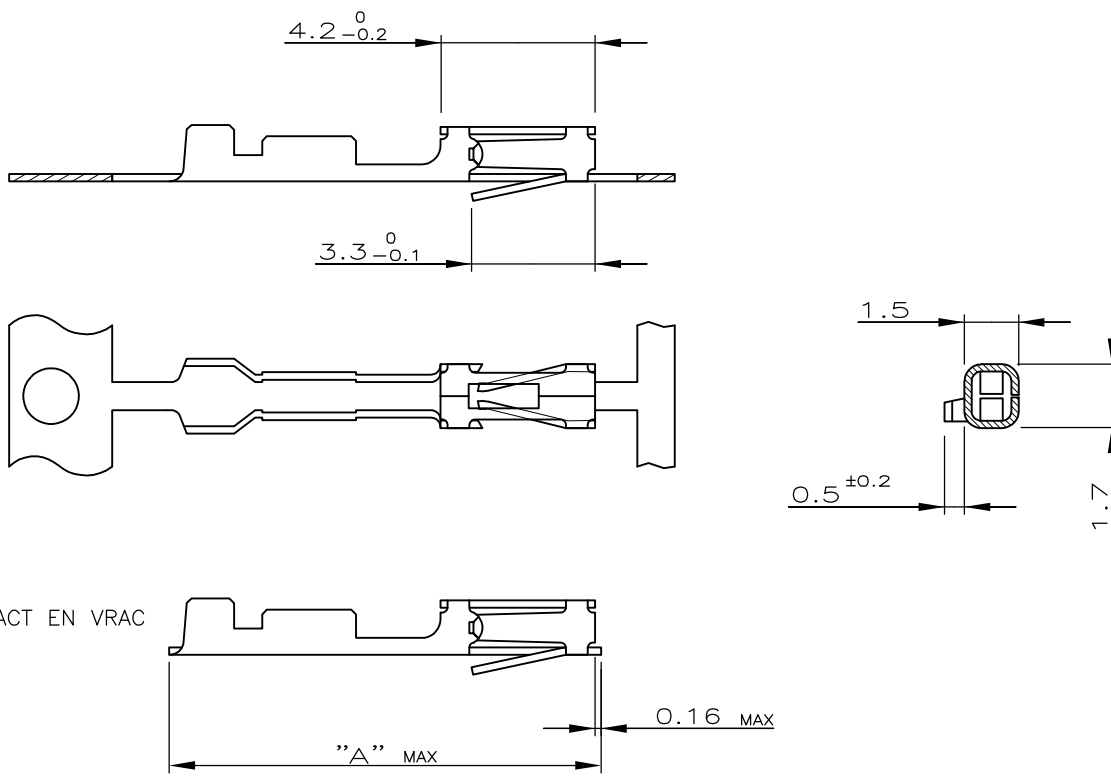

|                                   |                          |   |            | DIMENS. FIL<br>VOIR CI-DESSUS |                               | ISOLANT    |  |
|-----------------------------------|--------------------------|---|------------|-------------------------------|-------------------------------|------------|--|
| 28-32                             | 0.5-1.0                  | DORE 0.8µM DANS LA ZONE DE CONTACT<br>FLASH D'OR SUR LE RESTE<br>SOUS-COUCHE 1.27µM NI. | 11.7       | 0-167023-2                    | △2                            | 0-167020-2 |  |
| 28-32                             | 0.5-1.0                  | DORE 0.8µM DANS LA ZONE DE CONTACT<br>ETAIN SUR LE FUT<br>SOUS-COUCHE 1.27µM NI.        | 11.7       | 0-167023-1                    | △2                            | 0-167020-1 |  |
| 20-26<br>(0.5mm <sup>2</sup> MAX) | 1.40 MAX                 | DORE 0.8µM DANS LA ZONE DE CONTACT<br>ETAIN SUR LE FUT<br>SOUS-COUCHE 1.27µM NI.        | 12.3       | 0-141603-4                    | △2                            | 0-167300-8 |  |
| 20-26<br>(0.5mm <sup>2</sup> MAX) | 1.40 MAX                 | DORE 0.8µM DANS LA ZONE DE CONTACT<br>FLASH D'OR SUR LE RESTE<br>SOUS-COUCHE 1.27µM NI. | 12.3       | 0-141603-3                    | △2                            | 0-167300-6 |  |
|                                   |                          |   |            |                               | △1                            | 0-167300-7 |  |
|                                   |                          |   |            |                               | △1                            | 0-167300-5 |  |
| JAUGE AWG<br>FIL                  | DIAMETRE<br>ISOLANT (MM) | FINITION  | DIM<br>'A' | REFERENCE<br>CONTACT EN VRAC  | REFERENCE<br>CONTACT EN BANDE |            |  |

THIS DRAWING IS UNPUBLISHED.

RELEASED FOR PUBLICATION

ALL RIGHTS RESERVED.

© COPYRIGHT - By -

|   |       |                  |           |   |          |                          |               |
|---|-------|------------------|-----------|---|----------|--------------------------|---------------|
| DIMENSIONS:<br>mm                         |       | DWN<br>A.CAMEL   | 20.MAR.89 | MATERIAL<br>BRONZE PHOSPHOREUX                |          | FINISH<br>VOIR CI-DESSUS |               |
| TOLERANCES UNLESS<br>OTHERWISE SPECIFIED: |       | CHK<br>-         | -         | <br>TE Connectivity<br>CONTACT AMPMODU MOD.IV |          |                          |               |
| 0 PLC                                     | ± -   | APVD             | -         |   |          |                          |               |
| 1 PLC                                     | ± 0.3 | PRODUCT SPEC     | -         |   |          |                          |               |
| 2 PLC                                     | ± -   | APPLICATION SPEC | -         |   |          |                          |               |
| 3 PLC                                     | ± -   | WEIGHT           | -         | SIZE  | A4       | CAGE CODE                | 00779         |
| 4 PLC                                     | ± -   |                  |           | DRAWING NO                                    | C-141603 |                          | RESTRICTED TO |
| ANGLES                                    | ± 5'  |                  |           | CUSTOMER DRAWING                              |          | SCALE                    | 5:1           |
|   |       |                  |           |   |          | SHEET                    | 1 OF 1        |
|   |       |                  |           |   |          | REV                      | P             |