

THIS DRAWING IS UNPUBLISHED. RELEASED FOR PUBLICATION ,19 .  
 © COPYRIGHT 19 BY AMP INCORPORATED. ALL INTERNATIONAL RIGHTS RESERVED.

LOC		DIST		P		F		ZONE		LTR		REVISIONS		DATE	APPD	
G		86										D		REV PER 063A-0561-01	080CT02	JR/MS

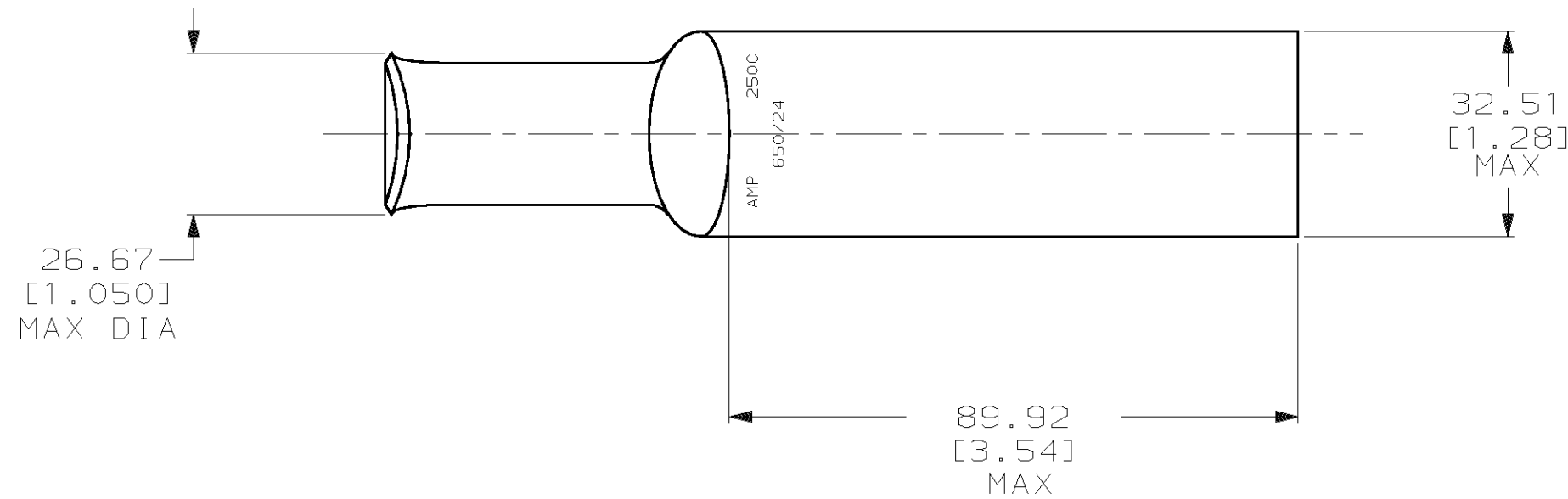

1 CIRCULAR MIL RANGE: 231-275 MCM  
 2 TIN PL 0.00381 [0.00150] MIN THK PER MIL-T-10727

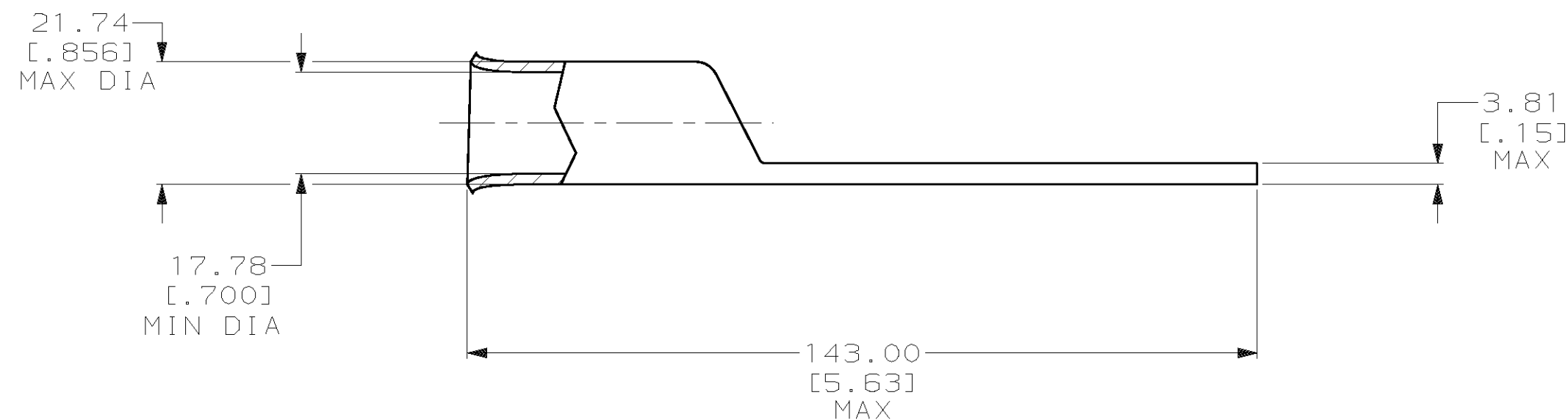

325719

B

A

325719

PART NO

DO NOT SCALE PRINT.  
 UNLESS SPECIFIED  
 DIMENSIONS IN mm [INCHES]  
 TOLERANCES ON :  
 2 PLC DEC ± 0.51 [.020]  
 3 PLC DEC ± -  
 ANGLES ± -

MATERIAL  
 ANNEALED COPPER  
 ASTM B-75

FINISH  
 2

DR 03/09/90  
 DK SCHRUM

CHK 20JAN95  
 MS FEHER

APPD 20JAN95  
 WJ VOCKROTH

APPD 20JAN95  
 TL SHUTTER

PRODUCT SPEC  
 108-30200

APPLICATION SPEC  
 -

WEIGHT .289 LB

AMP INCORPORATED Harrisburg, Pa. 17105		
NAME		
TERMINAL, AMPPOWER™ WIRE SIZE: 250 MCM		
SIZE	CAGE CODE	DRAWING NO
C	00779	325719
SCALE	1:1	SHEET
		1 OF 1

