

15A, 45V - 200V Schottky Barrier Surface Mount Rectifier

FEATURES

- Low power loss, high efficiency
- Ideal for automated placement
- Guard ring for overvoltage protection
- High surge current capability
- Moisture sensitivity level: level 1, per J-STD-020
- RoHS Compliant
- Halogen-free according to IEC 61249-2-21

APPLICATIONS

- Switching mode power supply (SMPS)
- Adapters
- DC to DC converters

MECHANICAL DATA

- Case: TO-263AB (D²PAK)
- Molding compound meets UL 94V-0 flammability rating
- Terminal: Matte tin plated leads, solderable per J-STD-002
- Meet JESD 201 class 1A whisker test
- Polarity: As marked
- Weight: 1.37g (approximately)

KEY PARAMETERS		
PARAMETER	VALUE	UNIT
I_F	15	A
V_{RRM}	45 - 200	V
I_{FSM}	150	A
T_{JMAX}	150	°C
Package	TO-263AB (D ² PAK)	
Configuration	Dual dies	

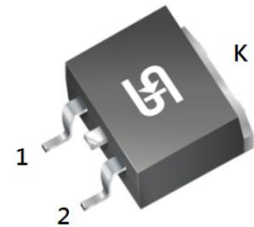

TO-263AB (D²PAK)

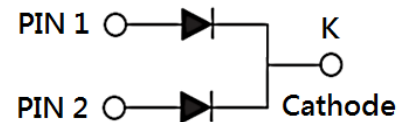

ABSOLUTE MAXIMUM RATINGS ($T_A = 25^\circ\text{C}$ unless otherwise noted)							
PARAMETER	SYMBOL	MBRS 1545 CT-Y	MBRS 1560 CT-Y	MBRS 15100 CT-Y	MBRS 15150 CT-Y	MBRS 15200 CT-Y	UNIT
Marking code on the device		MBRS 1545CT	MBRS 1560CT	MBRS 15100CT	MBRS 15150CT	MBRS 15200CT	
Repetitive peak reverse voltage	V_{RRM}	45	60	100	150	200	V
Reverse voltage, total rms value	$V_{R(RMS)}$	31	42	70	105	140	V
Forward current	I_F	15					A
Surge peak forward current, 8.3ms single half sine wave superimposed on rated load	I_{FSM}	150					A
Peak repetitive reverse surge current ⁽¹⁾	I_{RRM}	1	0.5				A
Peak repetitive forward current (Rated V_R , Square wave, 20KHz)	I_{FRM}	15					A
Critical rate of rise of off-state voltage	dv/dt	10,000					V/ μs
Junction temperature	T_J	-55 to +150					°C
Storage temperature	T_{STG}	-55 to +150					°C

Notes:

1. $t_p = 2.0\mu\text{s}$, 1.0KHz

THERMAL PERFORMANCE			
PARAMETER	SYMBOL	TYP	UNIT
Junction-to-ambient thermal resistance	$R_{\theta JA}$	50	°C/W
Junction-to-case thermal resistance	$R_{\theta JC}$	2	°C/W

ELECTRICAL SPECIFICATIONS ($T_A = 25^\circ\text{C}$ unless otherwise noted)						
PARAMETER		CONDITIONS	SYMBOL	TYP	MAX	UNIT
Forward voltage per diode ⁽¹⁾	MBRS1545CT-Y	$I_F = 7.5\text{A}, T_J = 25^\circ\text{C}$	V_F	-	-	V
	MBRS1560CT-Y			-	0.75	V
	MBRS15100CT-Y			-	0.92	V
	MBRS15150CT-Y MBRS15200CT-Y			-	0.95	V
	MBRS1545CT-Y	$I_F = 15.0\text{A}, T_J = 25^\circ\text{C}$		-	0.84	V
	MBRS1560CT-Y			-	-	V
	MBRS15100CT-Y			-	-	V
	MBRS15150CT-Y MBRS15200CT-Y			-	-	V
	MBRS1545CT-Y	$I_F = 7.5\text{A}, T_J = 125^\circ\text{C}$		-	0.57	V
	MBRS1560CT-Y			-	0.65	V
	MBRS15100CT-Y			-	0.82	V
	MBRS15150CT-Y MBRS15200CT-Y			-	0.92	V
	MBRS1545CT-Y	$I_F = 15.0\text{A}, T_J = 125^\circ\text{C}$		-	0.72	V
	MBRS1560CT-Y			-	-	V
	MBRS15100CT-Y			-	-	V
	MBRS15150CT-Y MBRS15200CT-Y			-	-	V
Reverse current @ rated V_R per diode ⁽²⁾	MBRS1545CT-Y MBRS1560CT-Y MBRS15100CT-Y MBRS15150CT-Y MBRS15200CT-Y	$T_J = 25^\circ\text{C}$	I_R	-	100	μA
	MBRS1545CT-Y	$T_J = 125^\circ\text{C}$		-	15	mA
	MBRS1560CT-Y			-	10	mA
	MBRS15100CT-Y MBRS15150CT-Y MBRS15200CT-Y			-	5	mA

Notes:

1. Pulse test with $PW = 0.3\text{ms}$
2. Pulse test with $PW = 30\text{ms}$

ORDERING INFORMATION		
ORDERING CODE⁽¹⁾	PACKAGE	PACKING
MBRS15xCT-Y	TO-263AB (D ² PAK)	800 / Tape & Reel

Notes:

1. "x" defines voltage from 45V(MBRS1545CT-Y) to 200V(MBRS15200CT-Y)

CHARACTERISTICS CURVES

($T_A = 25^\circ\text{C}$ unless otherwise noted)

Fig.1 Forward Current Derating Curve

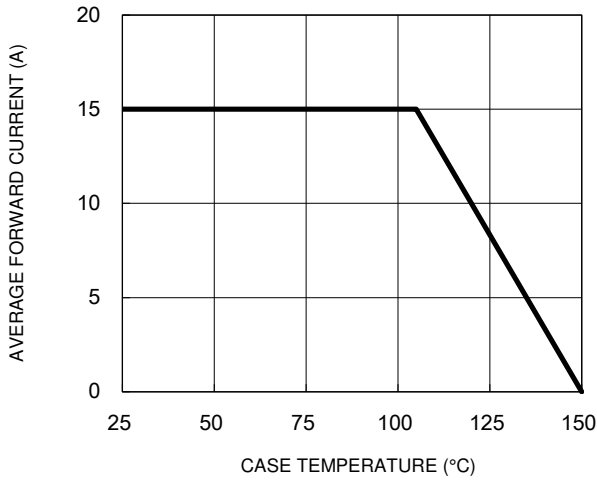

Fig.2 Typical Junction Capacitance

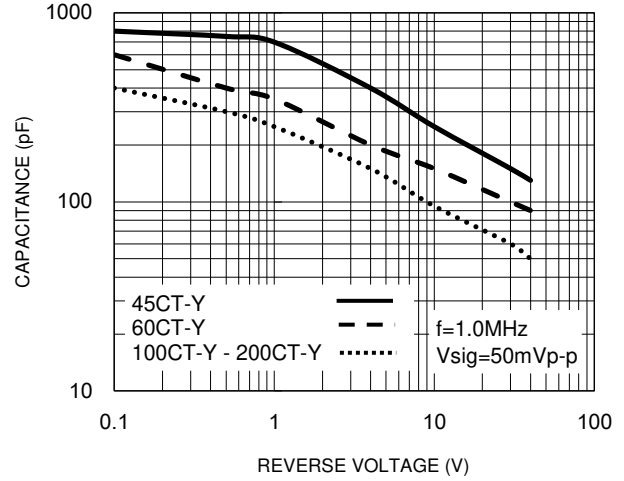

Fig.3 Typical Reverse Characteristics

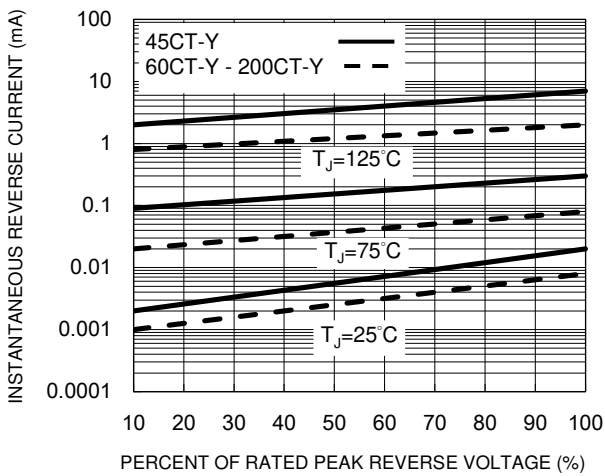

Fig.4 Typical Forward Characteristics

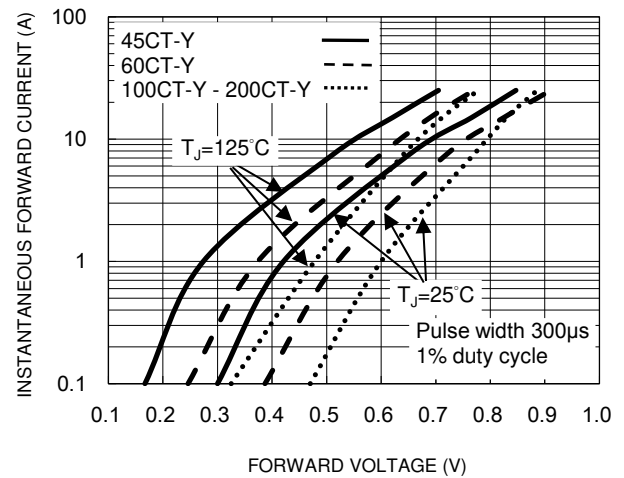
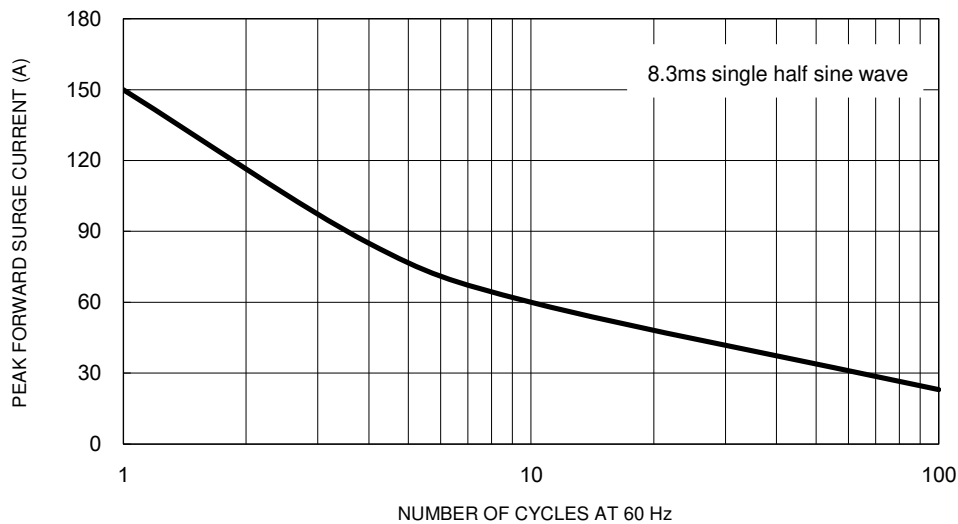

Fig.5 Maximum Non-Repetitive Forward Surge Current



CHARACTERISTICS CURVES

($T_A = 25^\circ\text{C}$ unless otherwise noted)

Fig.6 Typical Transient Thermal Impedance

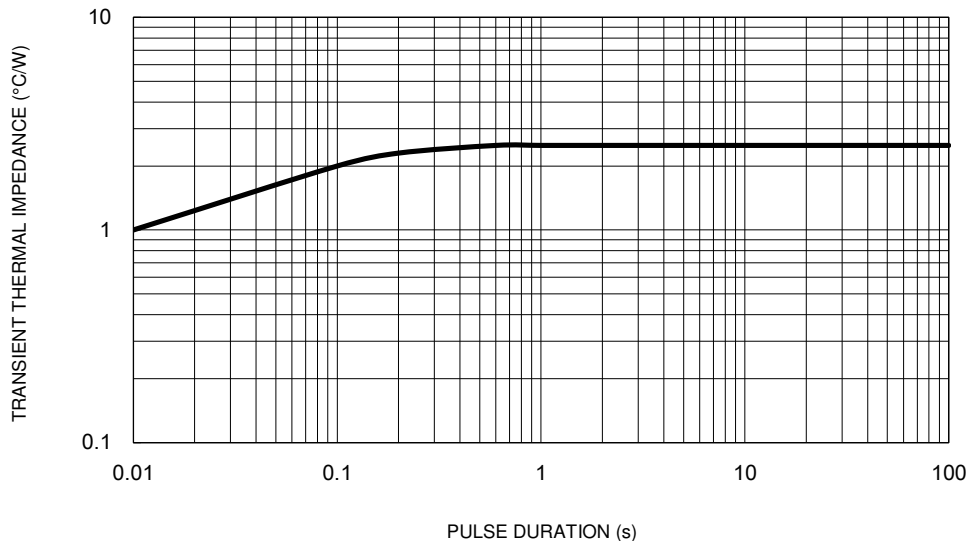

PACKAGE OUTLINE DIMENSIONS

TO-263AB (D²PAK)

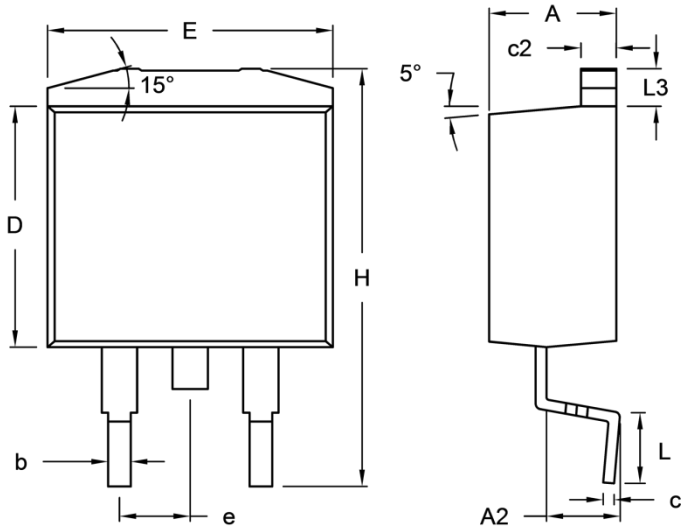

DIM.	Unit (mm)		Unit (inch)	
	Min.	Max.	Min.	Max.
A	4.44	4.70	0.175	0.185
A2	2.03	2.79	0.080	0.110
b	0.68	0.94	0.027	0.037
c	0.36	0.53	0.014	0.021
c2	1.14	1.40	0.045	0.055
D	8.25	9.25	0.325	0.364
E	-	10.50	-	0.413
e	2.41	2.67	0.095	0.105
H	14.60	15.88	0.575	0.625
L	2.29	2.79	0.090	0.110
L3	1.14	1.40	0.045	0.055

SUGGESTED PAD LAYOUT

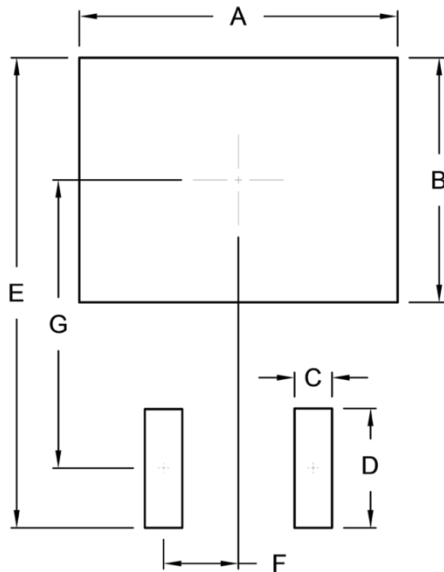

Symbol	Unit (mm)	Unit (inch)
A	10.80	0.425
B	8.30	0.327
C	1.27	0.050
D	4.05	0.159
E	15.95	0.628
F	2.54	0.100
G	9.775	0.385

MARKING DIAGRAM



- P/N = Marking Code
- G = Green Compound
- YWW = Date Code
- F = Factory Code

Notice

Specifications of the products displayed herein are subject to change without notice. TSC or anyone on its behalf assumes no responsibility or liability for any errors or inaccuracies.

Purchasers are solely responsible for the choice, selection, and use of TSC products and TSC assumes no liability for application assistance or the design of Purchasers' products.

Information contained herein is intended to provide a product description only. No license, express or implied, to any intellectual property rights is granted by this document. Except as provided in TSC's terms and conditions of sale for such products, TSC assumes no liability whatsoever, and disclaims any express or implied warranty, relating to sale and/or use of TSC products including liability or warranties relating to fitness for a particular purpose, merchantability, or infringement of any patent, copyright, or other intellectual property right.

The products shown herein are not designed for use in medical, life-saving, or life-sustaining applications. Customers using or selling these products for use in such applications do so at their own risk and agree to fully indemnify TSC for any damages resulting from such improper use or sale.