

- 1
- 2
- 3
- 4
- 5
- 6
- 7
- 8
- 9
- 10
- 11
- 12
- 13
- 14
- 15
- 16
- 17
- 18

**MATERIAL**

Polyamide based (PA) technopolymer, black colour, matte finish.

**PACKING RING**

NBR synthetic rubber.

**MAXIMUM CONTINUOUS WORKING TEMPERATURE**

100°C.

**SPECIAL EXECUTIONS ON REQUEST**

Words, marks and graphic symbols can be tampprinted on the cap.



ELESA Original design

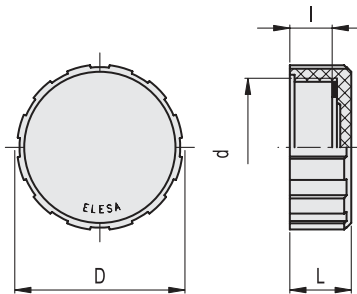

**Conversion Table**  
1 mm = 0.039 inch

mm	inch
9.5	0.37
15.5	0.60
19	0.75

Code	Description	d	l	D	L	⚖️
58211	T.470-33x2	M33x2	9.5	42	16	18
58221	T.470-48x2	M48x2	15.5	56	21	26
58231	T.470-60x2	M60x2	19	70	26	55
58251	T.470-1	G 1	9.5	42	16	17
58271	T.470-1.½	G 1 1/2	15.5	56	21	27
58281	T.470-2	G 2	19	70	26	58