

LOC		DIST		REVISIONS			
P	LTR	DESCRIPTION	DATE	DMN	APVD		
D		REVISED PER ECO-08-008919	16APR08	HMR	DB		

- MATERIAL: CONNECTOR- NYLON UL94V-2 (BLUE).
 CONTACTS- 0.30 [.012] THK COPPER ALLOY
 (BRIGHT TIN-LEAD 0.00203 [.000080] MIN THK).
 (MATTE TIN 0.00203 [.000080] MIN THK).
- CONTACTS ACCEPT #26 AWG SOLID, FUSED STRANDED OR STRANDED (7 STRANDS) WIRE WITH 2.41 [.095] MAX INSULATION DIA.
- BOW, IN ANY DIRECTION, NOT TO EXCEED 0.15 [.006] PER IN.
- HOUSING FEATURES: FEED-THRU.
- DIMENSIONS IN BRACKETS ARE IN INCHES.

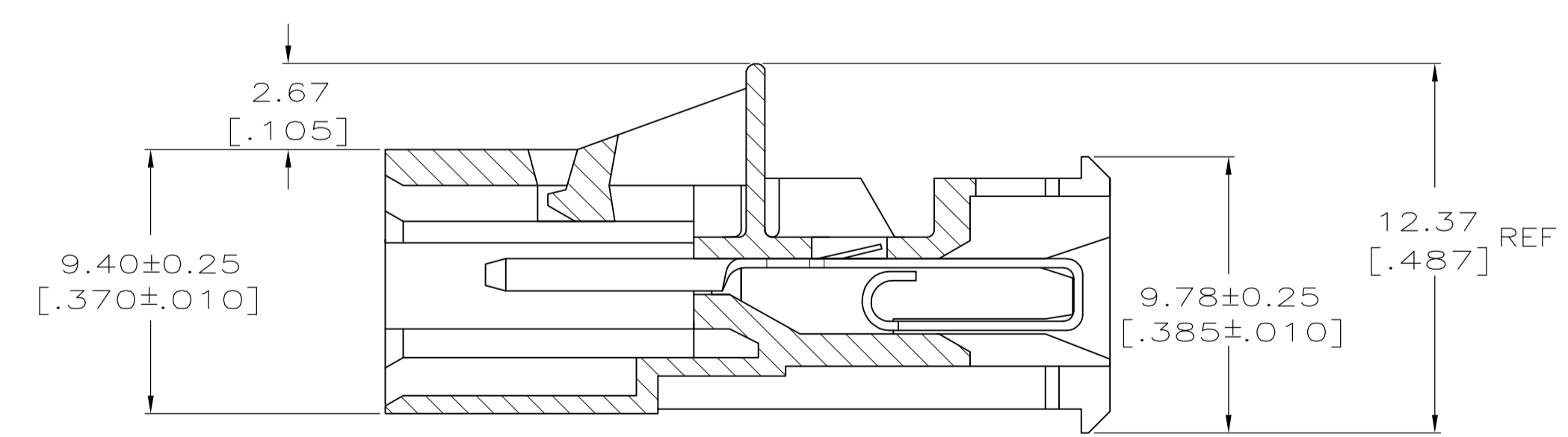
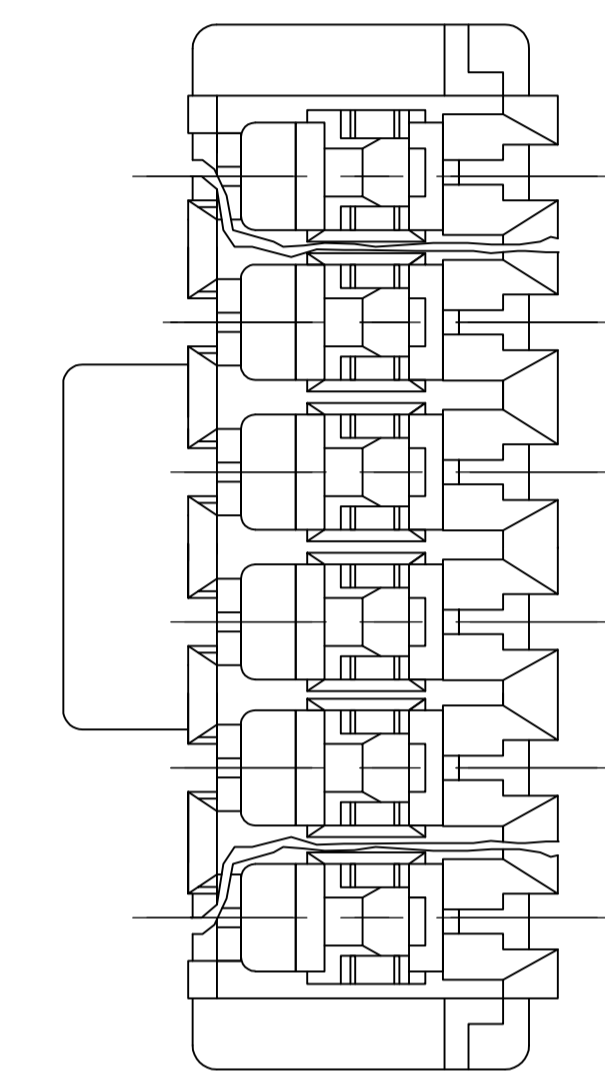
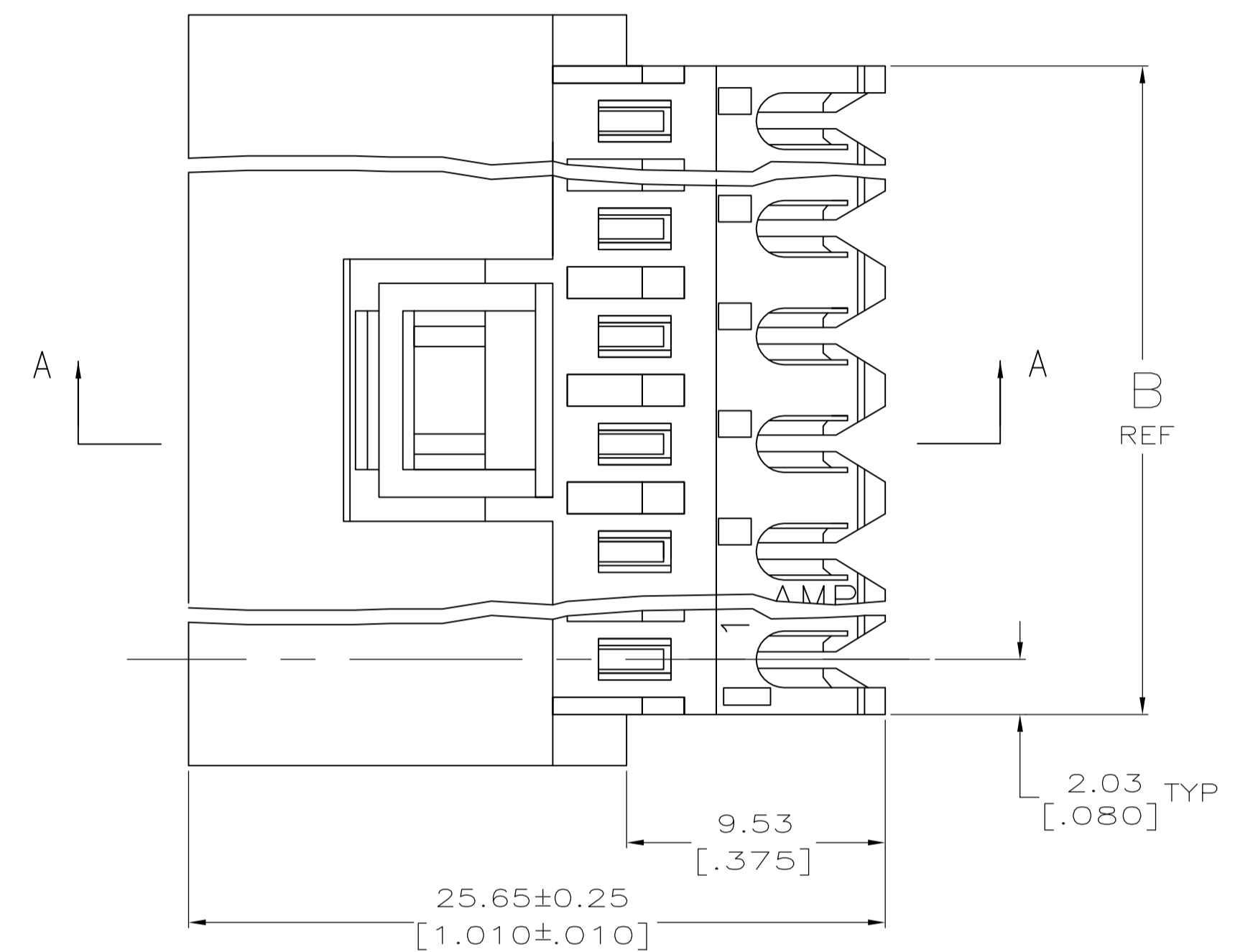
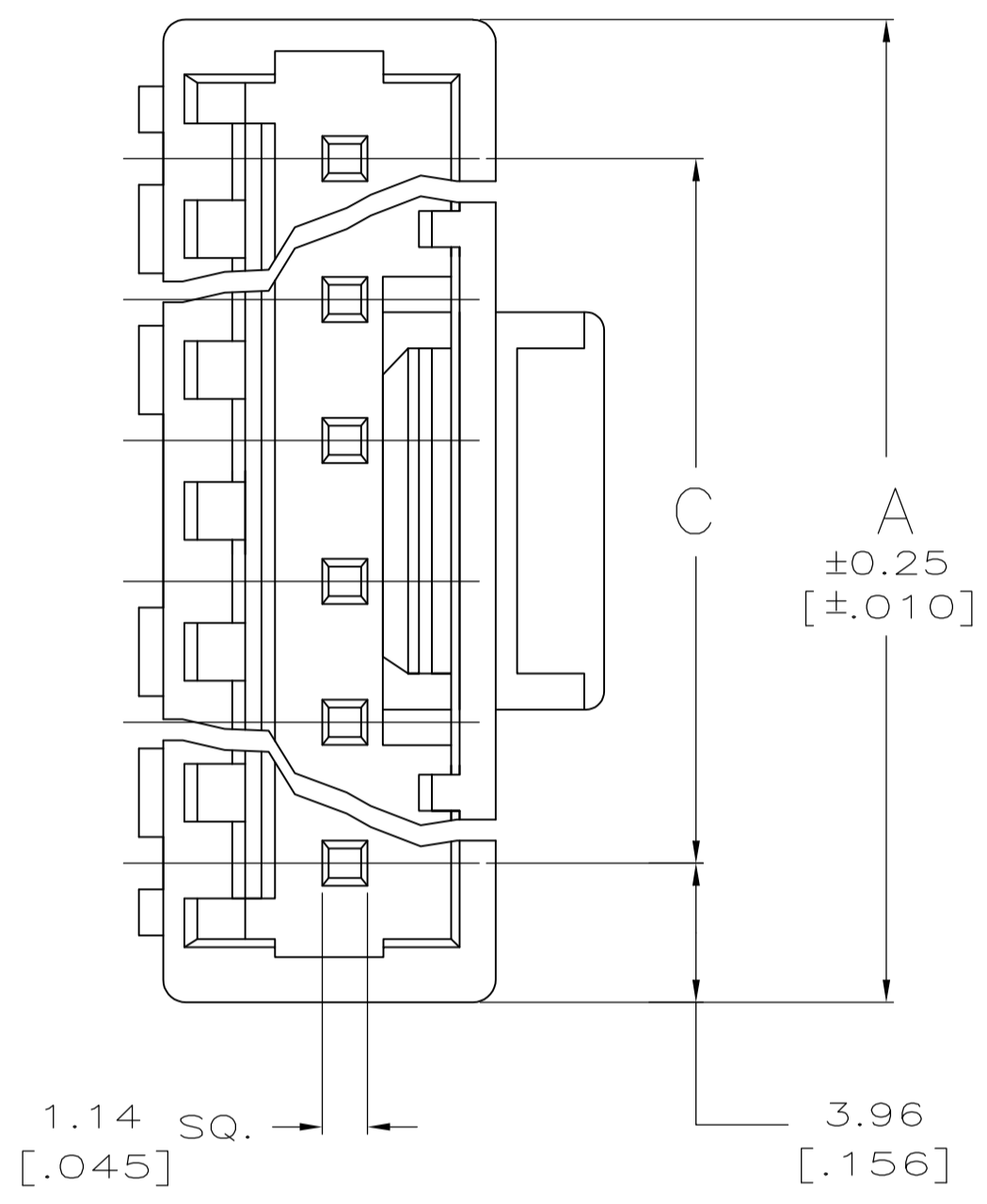

SECTION A-A

FINISH	C	B	A	NO. OF CIRCUITS	PART NUMBER	
TIN	91.14 [3.588]	95.20 [3.748]	99.06 [3.900]	24	5-641526-4	
	55.47 [2.184]	59.54 [2.344]	63.40 [2.496]	15	4-641526-5	
	43.59 [1.716]	47.65 [1.876]	51.51 [2.028]	12	4-641526-2	
	31.70 [1.248]	35.76 [1.408]	39.62 [1.560]	9	3-641526-9	
	19.81 [.780]	23.88 [.940]	27.74 [1.092]	6	3-641526-6	
	11.89 [.468]	15.95 [.628]	19.81 [.780]	4	3-641526-4	
	7.92 [.312]	11.99 [.472]	15.85 [.624]	3	3-641526-3	
	3.96 [.156]	8.03 [.316]	11.89 [.468]	2	3-641526-2	
	TIN-LEAD	91.14 [3.588]	95.20 [3.748]	99.06 [3.900]	24	2-641526-4
		55.47 [2.184]	59.54 [2.344]	63.40 [2.496]	15	1-641526-5
43.59 [1.716]		47.65 [1.876]	51.51 [2.028]	12	1-641526-2	
31.70 [1.248]		35.76 [1.408]	39.62 [1.560]	9	641526-9	
19.81 [.780]		23.88 [.940]	27.74 [1.092]	6	641526-6	
11.89 [.468]		15.95 [.628]	19.81 [.780]	4	641526-4	
7.92 [.312]		11.99 [.472]	15.85 [.624]	3	641526-3	
3.96 [.156]		8.03 [.316]	11.89 [.468]	2	641526-2	

THIS DRAWING IS A CONTROLLED DOCUMENT. DWN: B. LEWIS 5-31-96
 CHK: R. SWING 5-31-96
 Tyco Electronics Corporation, Harrisburg, PA 17105-3608

DIMENSIONS: mm [INCHES]	TOLERANCES UNLESS OTHERWISE SPECIFIED:	PRODUCT SPEC	NAME
0 PLC ± -	1 PLC ± -	APPLICATION SPEC	MTA-156
2 PLC ± 0.13 [.005]	3 PLC ± -		POSTED CONNECTOR ASSEMBLY,
4 PLC ± -	ANGLES ± -		26 AWG

MATERIAL: SEE NOTE 1
 FINISH: SEE NOTE 1
 WEIGHT: -
 SIZE: A1
 CAGE CODE: 00779
 DRAWING NO: 641526
 RESTRICTED TO: -
 CUSTOMER DRAWING
 SCALE: 5:1
 SHEET: 1 OF 1
 REV: D