

- 1
- 2
- 3
- 4
- 5
- 6
- 7
- 8
- 9
- 10
- 11
- 12
- 13
- 14
- 15

MATERIAL

Glass-fibre reinforced polyamide based (PA) technopolymer, black colour, matte finish.

PACKING RING

NBR synthetic rubber.

FLAT DIPSTICK

Flat section phosphatised steel.

On request and for sufficient quantities dipstick can be supplied in different lengths and/or complete with MAX-MIN level lines.

STANDARD EXECUTIONS

- TCD+a: without side hole.
- TCDF+a: with side breather hole.

MAXIMUM CONTINUOUS WORKING TEMPERATURE

100°C.

GRAPHIC SYMBOL "FILL"

According to DIN regulations.

TECHNICAL DATA

The tightening torque indicated in the table guarantees an optimal tightness, keeping the packing ring in the correct position.

ACCESSORIES ON REQUEST

TCD+a oil fill plugs are suitable for mounting aluminium plates with graphic symbols type MH. (see page 1302).



ELESA Original design

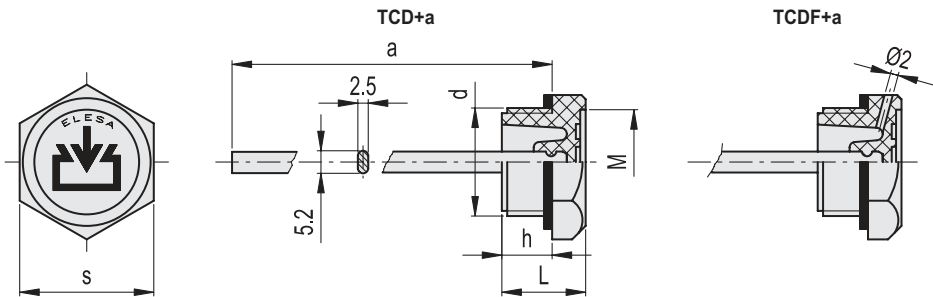

TCD+a		METRIC		METRIC		Tightening torque [Nm]		⚖️	
Code	Description	d	h	s	L	M	a		
59501	TCD.10x1.5+a	M10x1.5	9	19	16	15	120	4+5	21
59503	TCD.12x1.5+a	M12x1.5	9	19	16	15	120	6+8	21
59505	TCD.14x1.5+a	M14x1.5	9	19	16	15	120	6+8	22
59507	TCD.16x1.5+a	M16x1.5	9	22	16	17	120	8+10	22
59509	TCD.18x1.5+a	M18x1.5	11	26	18	20.5	195	8+10	36
59511	TCD.20x1.5+a	M20x1.5	11	26	18	20.5	195	8+10	37
59513	TCD.22x1.5+a	M22x1.5	12	32	20	25	195	10+12	40
59515	TCD.25x1.5+a	M25x1.5	12	32	20	25	195	10+12	40
59517	TCD.26x1.5+a	M26x1.5	12	32	20	25	195	10+12	42
59519	TCD.35x1.5+a	M35x1.5	13	38	22	31	195	15+18	44
59523	TCD.40x1.5+a	M40x1.5	14	46	24	38	195	15+18	49

TCDF+a		METRIC		METRIC		Tightening torque [Nm]		⚖️	
Code	Description	d	h	s	L	M	a		
59557	TCDF.16x1.5+a	M16x1.5	9	22	16	17	120	8+10	15
59559	TCDF.18x1.5+a	M18x1.5	11	26	18	20.5	195	8+10	30
59561	TCDF.20x1.5+a	M20x1.5	11	26	18	20.5	195	8+10	30
59563	TCDF.22x1.5+a	M22x1.5	12	32	20	25	195	10+12	35
59565	TCDF.25x1.5+a	M25x1.5	12	32	20	25	195	10+12	35
59567	TCDF.26x1.5+a	M26x1.5	12	32	20	25	195	10+12	35
59569	TCDF.35x1.5+a	M35x1.5	13	38	22	31	195	15+18	40
59573	TCDF.40x1.5+a	M40x1.5	14	46	24	38	195	15+18	49

		BSP		METRIC		Tightening torque [Nm]		⚖️	
Code	Description	d	h	s	L	M	a		
59531	TCD.1/8+a	G 1/8	9	19	16	15	120	4+6	22
59533	TCD.1/4+a	G 1/4	9	19	16	15	120	4+6	22
59535	TCD.3/8+a	G 3/8	9	22	16	17	120	8+10	22
59537	TCD.1/2+a	G 1/2	11	26	18	20.5	195	8+10	37
59539	TCD.3/4+a	G 3/4	12	32	20	25	195	10+12	40
59541	TCD.1+a	G 1	13	38	22	31	195	12+15	44
59543	TCD.1¼+a	G1 1/4	14	46	24	38	195	15+18	49
59545	TCD.1½+a	G1 1/2	15	55	26	46	195	15+18	53

		BSP		METRIC		Tightening torque [Nm]		⚖️	
Code	Description	d	h	s	L	M	a		
59585	TCDF.3/8+a	G 3/8	9	22	16	17	120	8+10	20
59587	TCDF.1/2+a	G 1/2	11	26	18	20.5	195	8+10	30
59589	TCDF.3/4+a	G 3/4	12	32	20	25	195	10+12	35
59591	TCDF.1+a	G 1	13	38	22	31	195	12+15	45
59595	TCDF.1¼+a	G1 1/4	14	46	24	38	195	15+18	49
59597	TCDF.1½+a	G1 1/2	15	55	26	46	195	15+18	53

Accessories for hydraulic systems