

# SACC-DSI-M12FSL-4FE-M16XL/1,5X - Device connector, rear mounting



1238580

<https://www.phoenixcontact.com/us/products/1238580>

Please be informed that the data shown in this PDF document is generated from our online catalog. Please find the complete data in the user documentation. Our general terms of use for downloads are valid.



Device connector, rear mounting, Power, 5-position, Socket, straight, M12, coding: L , on free cable end, Rear mounting, M16 x 1.5, Individual wires, cable length: 1.5 m, 2.50 mm<sup>2</sup>, PEX litz wire, Item is lead-free in accordance with RoHS II without Exemption 6c (Pb <0.1%)

## Your advantages

- For compact devices: transmit high power in a confined space
- Easy-to-install, optimized XL housing contour with wrench size 19
- Mechanical tightening limitation for long-term-stable gasket
- Preassembled with litz wires for immediate use
- Customer-specific assemblies and litz wire lengths available
- Sealed on the litz wire side for optimum leak-tightness
- For high transmission safety: shield connection to the housing with optional EMC nut

## Commercial data

Item number	1238580
Packing unit	1 pc
Minimum order quantity	25 pc
Sales key	AB27
Product key	ABQCHB
GTIN	4063151386290
Weight per piece (including packing)	235.8 g
Weight per piece (excluding packing)	235.8 g
Customs tariff number	85444290
Country of origin	DE

# SACC-DSI-M12FSL-4FE-M16XL/1,5X - Device connector, rear mounting



1238580

<https://www.phoenixcontact.com/us/products/1238580>

## Technical data

### Notes

General	The electrical and mechanical data specified assume that the connector pair is correctly locked and mounted. If the connector is unlocked and if there is a danger of contamination, the connector must be sealed using a protective cap > IP54. Influences arising from litz wires, cables or PCB assembly must also be taken into consideration.
General	FE not connected to metal parts that can be touched, no protective function
General	Lock nut is included in the scope of delivery

### Mounting

Mounting type	Rear mounting M16 x 1.5 With flat nut, tightening limitation
Assembly instructions	With flat nut, tightening limitation
Connection method	Individual wires

### Product properties

Product type	Circular connectors (device side)
Sensor type	Power
Number of positions	5
No. of cable outlets	1
Shielded	no
Coding	L
Thread type	M12

### Insulation characteristics

Overvoltage category	III
Degree of pollution	3

### Material specifications

Flammability rating according to UL 94	V0
Seal material	FKM
Contact material	CuZn
Contact surface material	Au
Contact carrier material	PA
Material for screw connection	Zinc die-cast, nickel-plated

### Electrical properties

Rated voltage in acc. with IEC 61076-2-101	63 V
Rated surge voltage	1.5 kV
	1.5 kV AC/DC
Nominal voltage $U_N$	63 V DC

# SACC-DSI-M12FSL-4FE-M16XL/1,5X - Device connector, rear mounting



1238580

<https://www.phoenixcontact.com/us/products/1238580>

Nominal current $I_N$	16 A
Test voltage	1.5 kV
Test voltage Core/Core	6 kV

## Connection data

### Conductor connection

Connection method	Individual wires
Contact connection type	Socket
Conductor cross section	2.5 mm <sup>2</sup>

## Mechanical properties

### Mechanical data

Insertion/withdrawal cycles	> 100
-----------------------------	-------

## Connector

### Connection 1

Head design	Socket
Head cable outlet	straight
Head thread type	M12
Coding	L

### Connection 2

Head design	free cable end
-------------	----------------

## Cable/line

Cable length	1.5 m
Cable type	PEX litz wire
Signal type/category	Power
Single wire, color	brown 1, white 2, blue 3, black 4, gray FE
AWG signal line	14
Test voltage Core/Core	6 kV
Ambient temperature (operation)	-40 °C ... 105 °C (cable, fixed installation) -25 °C ... 105 °C (Cable, flexible installation)

## Environmental and real-life conditions

### Ambient conditions

Degree of protection	IP67 IP65/IP67
Ambient temperature (operation)	-25 °C ... 85 °C (Plug / socket) -40 °C ... 85 °C (without mechanical actuation) -25 °C ... 105 °C (Cable, flexible installation) -40 °C ... 105 °C (cable, fixed installation)

# SACC-DSI-M12FSL-4FE-M16XL/1,5X - Device connector, rear mounting



1238580

<https://www.phoenixcontact.com/us/products/1238580>

## Standards and regulations

M12

Standard designation	M12 connector
Standards/specifications	IEC 61076-2-111
Note	In line with

# SACC-DSI-M12FSL-4FE-M16XL/1,5X - Device connector, rear mounting

1238580

<https://www.phoenixcontact.com/us/products/1238580>

## Drawings

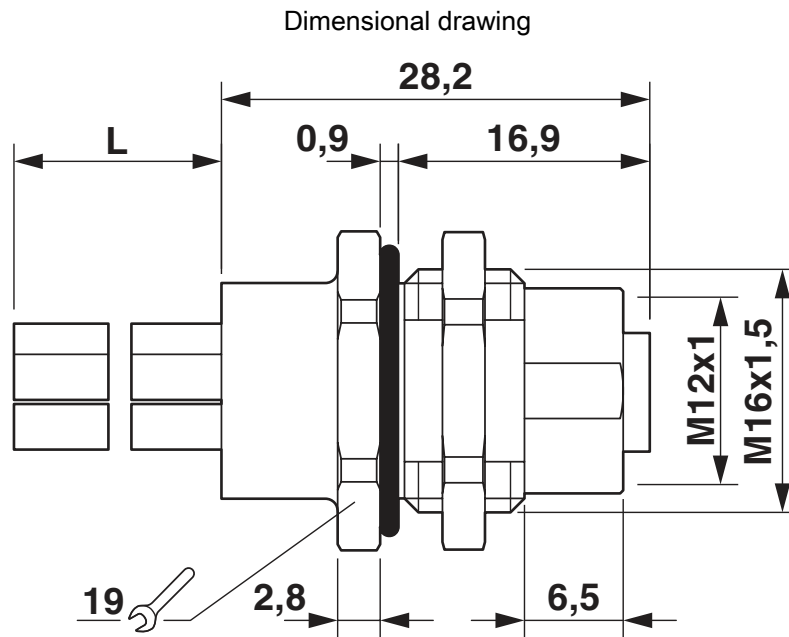

Dimensional drawing

Schematic diagram

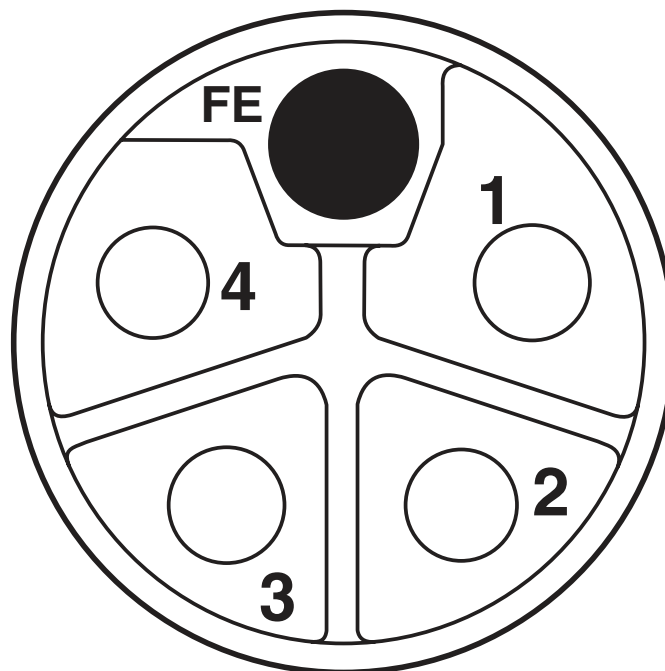

Pin assignment of M12 socket, 5-pos., L-coded, socket side view

# SACC-DSI-M12FSL-4FE-M16XL/1,5X - Device connector, rear mounting



1238580

<https://www.phoenixcontact.com/us/products/1238580>

## Approvals

To download certificates, visit the product detail page: <https://www.phoenixcontact.com/us/products/1238580>



**EAC**

Approval ID: B.01687



**cULus Recognized**

Approval ID: E468743-20180113

	Nominal voltage $U_N$	Nominal current $I_N$	Cross section AWG	Cross section $\text{mm}^2$
	63 V	16 A	- 14	-

# SACC-DSI-M12FSL-4FE-M16XL/1,5X - Device connector, rear mounting



1238580

<https://www.phoenixcontact.com/us/products/1238580>

## Classifications

### ECLASS

ECLASS-11.0	27060308
ECLASS-12.0	27060308
ECLASS-13.0	27060308

### ETIM

ETIM 8.0	EC002599
----------	----------

### UNSPSC

UNSPSC 21.0	26121600
-------------	----------

# SACC-DSI-M12FSL-4FE-M16XL/1,5X - Device connector, rear mounting



1238580

<https://www.phoenixcontact.com/us/products/1238580>

## Environmental product compliance

China RoHS	Environmentally friendly use period: unlimited = EFUP-e
	No hazardous substances above threshold values



# SACC-DSI-M12FSL-4FE-M16XL/1,5X - Device connector, rear mounting



1238580

<https://www.phoenixcontact.com/us/products/1238580>

## Accessories

### PROT M12 MS PWR - Screw plug

1092802

<https://www.phoenixcontact.com/us/products/1092802>



An M12 screw plug for the unoccupied M12 females of the M12 POWER connectors, boxes, and flush-type connectors

---

Phoenix Contact 2023 © - all rights reserved  
<https://www.phoenixcontact.com>

Phoenix Contact USA  
586 Fulling Mill Road  
Middletown, PA 17057, United States  
(+717) 944-1300  
[info@phoenixcon.com](mailto:info@phoenixcon.com)