

- $\triangle 1$  HOUSING: LIQUID CRYSTAL POLYMER, COLOR BLACK.  
CONTACTS: HIGH RELIABILITY COPPER ALLOY.  
GROUND BUSES: PHOSPHOR BRONZE ALLOY, UNS C51100.
- $\triangle 2$  CONTACTS & GROUND BUSES: NICKEL UNDERPLATE ALL OVER, MATING SURFACE PLATED TO MEET LEVEL 1 PERFORMANCE REQUIREMENTS OF TE PRODUCT SPECIFICATION 108-1422, SOLDER TAILS PLATED MATTE TIN.
- $\triangle 3$  DATE CODE MARKED IN AREA INDICATED ON SIDE OPPOSITE POSITION #1.
- $\triangle 4$  ONE GROUND BUS WITH 5 TAILS PER EACH MODULE.
- $\triangle 5$  TOLERANCE NON-ACCUMULATIVE.
- $\triangle 6$  FOR SLIP-FIT APPLICATIONS, ORIENTATION HOLE TO BE  $\phi .079 \pm .001 [2.00 \pm 0.03]$ .
- $\triangle 7$  FOR CONNECTORS OF 190 POSITIONS AND LARGER, THE CONNECTORS INTEGRAL GROUND BUS RETENTION FEATURE COMPENSATES FOR INHERENT BOW IN THE HOUSING. ONCE THE CONNECTOR IS PLACED ON THE PCB, COPLANARITY IS HELD TO 0.1 [0.04].
- $\triangle 8$  CONNECTORS PACKAGED ON 13 INCH DIA REELS PER EIA 481.
- $\triangle 9$  PRELIMINARY - NOT RELEASED FOR PRODUCTION.

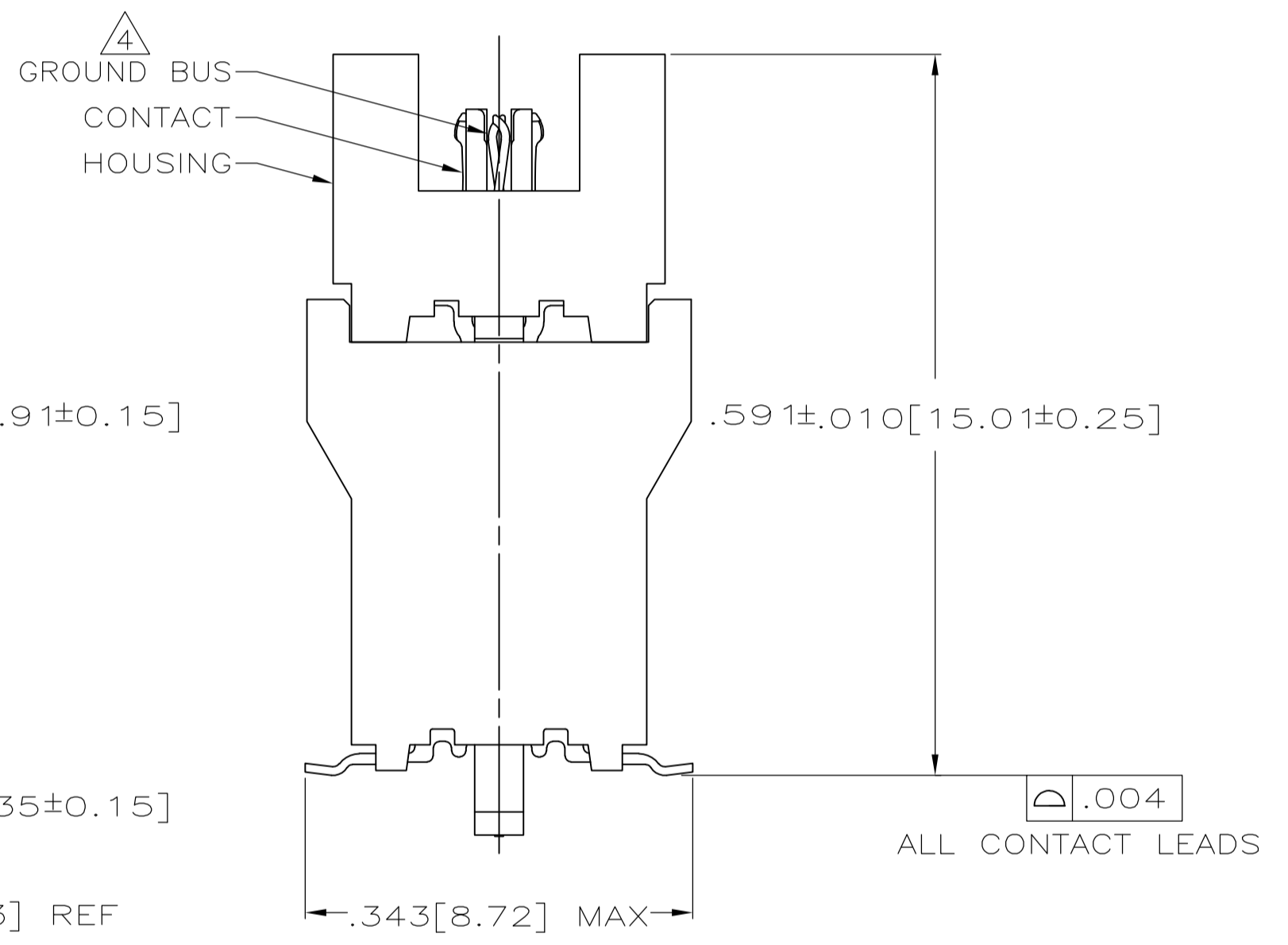
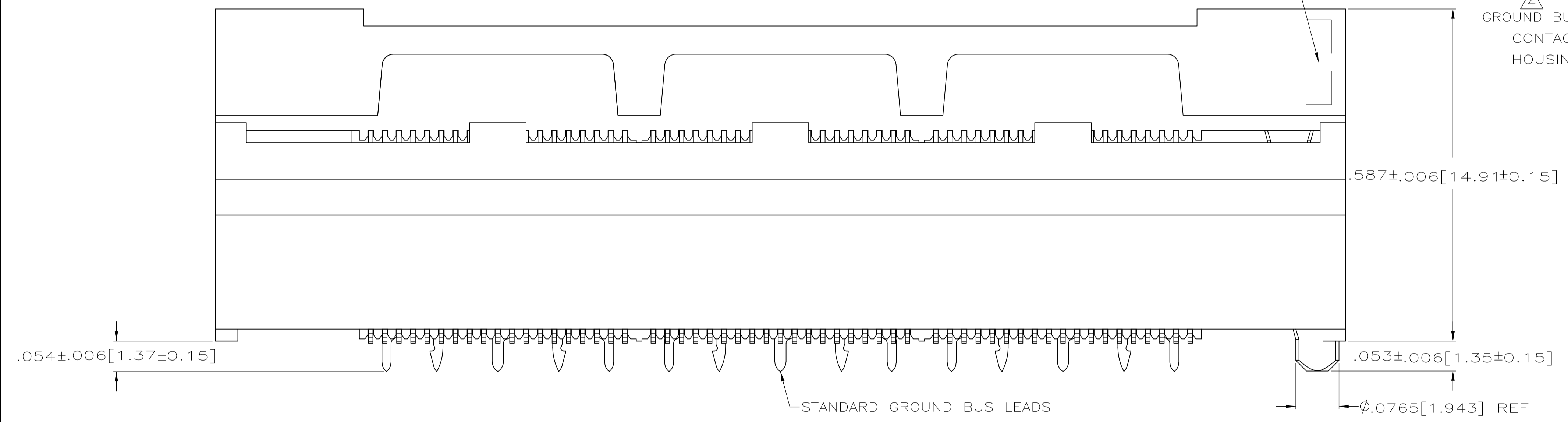

SEE SHEET 2 FOR RECOMMENDED PC BOARD LAYOUT AND PACKAGING DETAIL

|               |                       |             |              |   |               |               |               |           |             |
|---------------|-----------------------|-------------|--------------|---|---------------|---------------|---------------|-----------|-------------|
| $\triangle 9$ | NO                    | 4.724 [120] | 3.000 [76.2] | 6 | 3.450 [87.63] | 3.900 [99.06] | 4.000 [101.6] | 266       | 1-5767146-4 |
| $\triangle 9$ | NO                    | 4.724 [120] | 2.500 [63.5] | 5 | 2.950 [74.93] | 3.400 [86.36] | 3.500 [88.9]  | 228       | 1-5767146-3 |
| $\triangle 9$ | NO                    | 4.094 [104] | 2.000 [50.8] | 4 | 2.450 [62.23] | 2.900 [73.66] | 3.000 [76.2]  | 190       | 1-5767146-2 |
|               | NO                    | 3.465 [88]  | 1.500 [38.1] | 3 | 1.950 [49.53] | 2.400 [60.96] | 2.500 [63.5]  | 152       | 1-5767146-1 |
|               | NO                    | 2.835 [72]  | 1.000 [25.4] | 2 | 1.450 [36.83] | 1.900 [48.26] | 2.000 [50.8]  | 114       | 1-5767146-0 |
|               | NO                    | 2.205 [56]  | .500 [12.7]  | 1 | .950 [24.13]  | 1.400 [35.56] | 1.500 [38.1]  | 76        | 5767146-9   |
|               | NO                    | 1.732 [44]  | .000 [0]     | 0 | .450 [11.43]  | .900 [22.86]  | 1.000 [25.4]  | 38        | 5767146-8   |
|               | YES                   | 4.724 [120] | 3.000 [76.2] | 6 | 3.450 [87.63] | 3.900 [99.06] | 4.000 [101.6] | 266       | 5767146-7   |
| $\triangle 9$ | YES                   | 4.724 [120] | 2.500 [63.5] | 5 | 2.950 [74.93] | 3.400 [86.36] | 3.500 [88.9]  | 228       | 5767146-6   |
|               | YES                   | 4.724 [120] | 2.000 [50.8] | 4 | 2.450 [62.23] | 2.900 [73.66] | 3.000 [76.2]  | 190       | 5767146-5   |
|               | YES                   | 3.465 [88]  | 1.500 [38.1] | 3 | 1.950 [49.53] | 2.400 [60.96] | 2.500 [63.5]  | 152       | 5767146-4   |
|               | YES                   | 2.835 [72]  | 1.000 [25.4] | 2 | 1.450 [36.83] | 1.900 [48.26] | 2.000 [50.8]  | 114       | 5767146-3   |
|               | YES                   | 2.205 [56]  | .500 [12.7]  | 1 | .950 [24.13]  | 1.400 [35.56] | 1.500 [38.1]  | 76        | 5767146-2   |
|               | YES                   | 1.732 [44]  | .000 [0]     | 0 | .450 [11.43]  | .900 [22.86]  | 1.000 [25.4]  | 38        | 5767146-1   |
|               | VACUUM COVER INCLUDED | F           | E            | D | C             | B             | A             | NO OF POS | PART NUMBER |

THIS DRAWING IS A CONTROLLED DOCUMENT.

|                        |   |                        |                        |            |  |
|------------------------|---|------------------------|------------------------|------------|--|
| DIMENSIONS: INCHES     | TOLERANCES UNLESS OTHERWISE SPECIFIED:  | DIN L VARELA 28 OCT 04 | APVD D DIXON 28 OCT 04 | NAME       | RECEPTACLE ASSEMBLY, .355 [9.02] VERTICAL, .025 [0.64] CL, GULL WING LEADS, POCKET TAPE PACKAGED, MICTOR |
| $\triangle 1$          | 0 PLC ± -<br>1 PLC ± -<br>2 PLC ± -<br>3 PLC ± .005 (0.13)<br>4 PLC ± -<br>ANGLES ± - | CHK D DIXON 28 OCT 04  | APVD D DIXON 28 OCT 04 | SIZE       | 114-11004  |
| MATERIAL $\triangle 1$ | FINISH $\triangle 2$  | WEIGHT                 | CAGE CODE              | DRAWING NO | RESTRICTED TO  |
|                        |   |                        | A1 00779               | 5767146    |  |
| CUSTOMER DRAWING       |   | SCALE                  | 8:1                    | SHEET      | 1 OF 2   |
|                        |   | REV                    | B1                     |            |  |

Tyco Electronics Corporation  
Harrisburg, PA 17105-3608

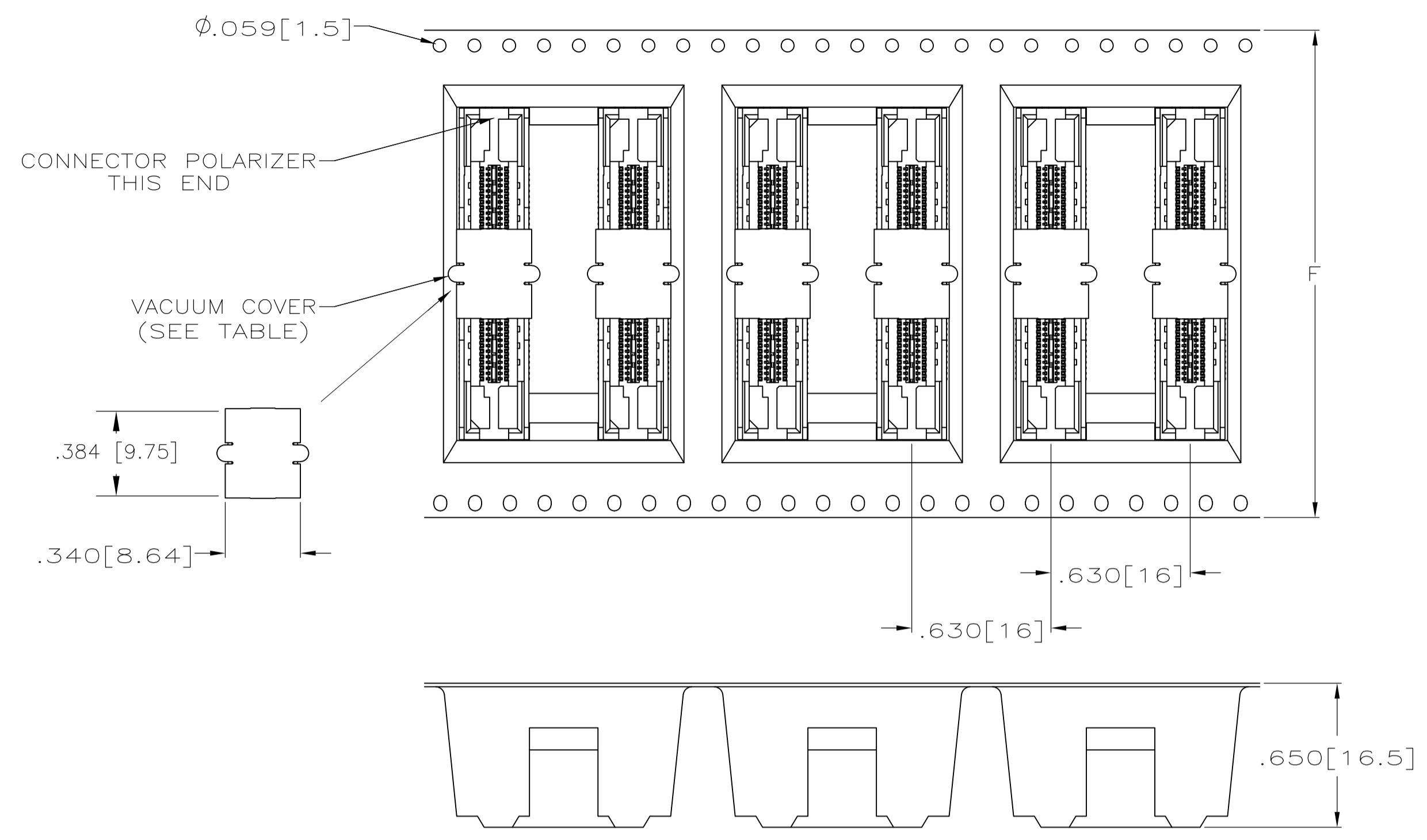

PACKAGING DETAIL  $\Delta$   
 SCALE 2:1  
 DIMENSIONS ARE FOR REFERENCE

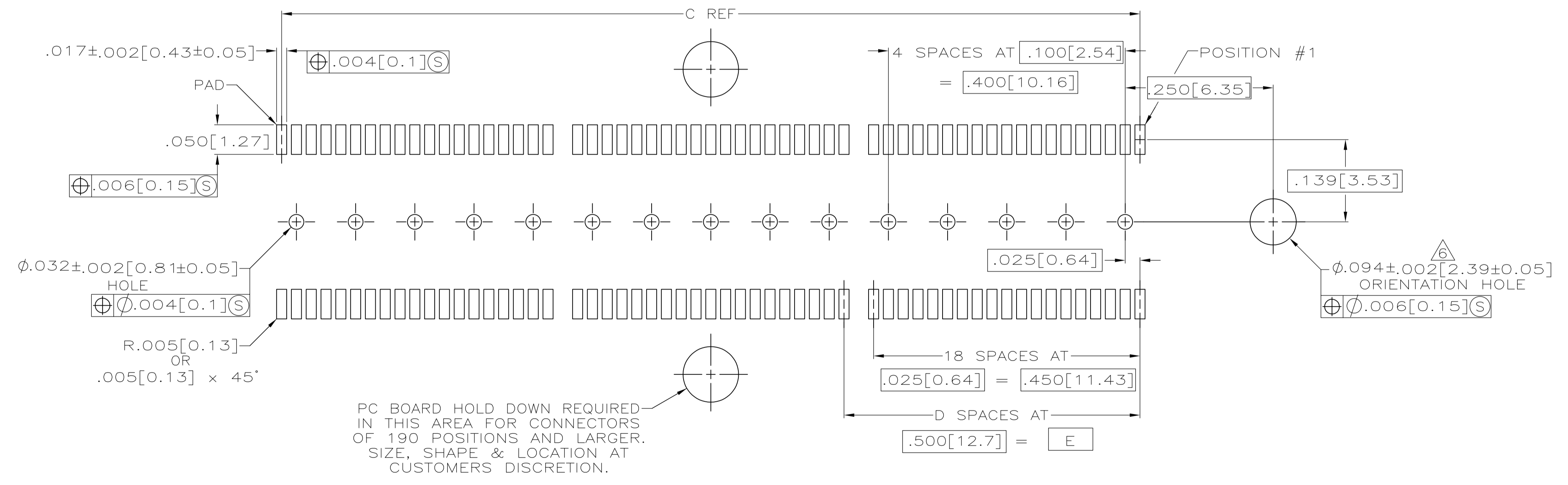

RECOMMENDED PC BOARD LAYOUT  
 (VIEWED FROM CONNECTOR SIDE)

|  |  |                  |          |           |  |
|--|--|------------------|----------|-----------|--|
| THIS DRAWING IS A CONTROLLED DOCUMENT. |  | DIN              | L VARELA | 28 OCT 04 | Tyco Electronics Corporation<br>Harrisburg, PA 17105-3608  |
|  |  | CHK              | D DIXON  | 28 OCT 04 |  |
|  |  | APP'D            | D DIXON  | 28 OCT 04 | NAME<br>RECEPTACLE ASSEMBLY, .355[9.02]<br>VERTICAL, .025[0.64] CL, GULL WING<br>LEADS, POCKET TAPE PACKAGED, MICTOR |
|  |  | PRODUCT SPEC     |          |           |  |
|  |  | APPLICATION SPEC |          |           | SIZE<br>A1   |
|  |  | WEIGHT           |          |           |  |
|  |  | CUSTOMER DRAWING |          |           | SCALE 8:1  |
|  |  |                  |          |           | SHEET 2 OF 2   |
|  |  |                  |          |           | REV B1   |