

1. MATERIAL:  
 BODY: ALUMINUM PER ASTM B317  
 INSERT: BRASS PER ASTM B36
2. FINISH:  
 BODY: .000600 MIN MATTE TIN PER ASTM B545  
 OVER .000060 MIN NICKEL PER ASTM B733.  
 INSERT: .000150 MIN MATTE NICKEL PER QQ-N-290
3. PTFE DRY LUBRICANT 360 DEGREE ON OUTER DIAMETER OF CRIMP BARREL IN ZONE SHOWN.
4. WIRE INSULATION RANGE: .425-.513.
5. SEE TE CONNECTIVITY APPLICATION SPEC. 114-32098 FOR APPLICATION REQUIREMENTS.
6. SEE TE CONNECTIVITY INSTRUCTION SHEET 408-32087 FOR TOOLING AND CRIMP INSTRUCTIONS, FIGURE 3 FOR WIRE STRIPPING DETAIL.

REVISIONS				
P.	LTN	DESCRIPTION	DATE	APVD
E		REV PER ECO 19-019314	2-27-20	CT PD

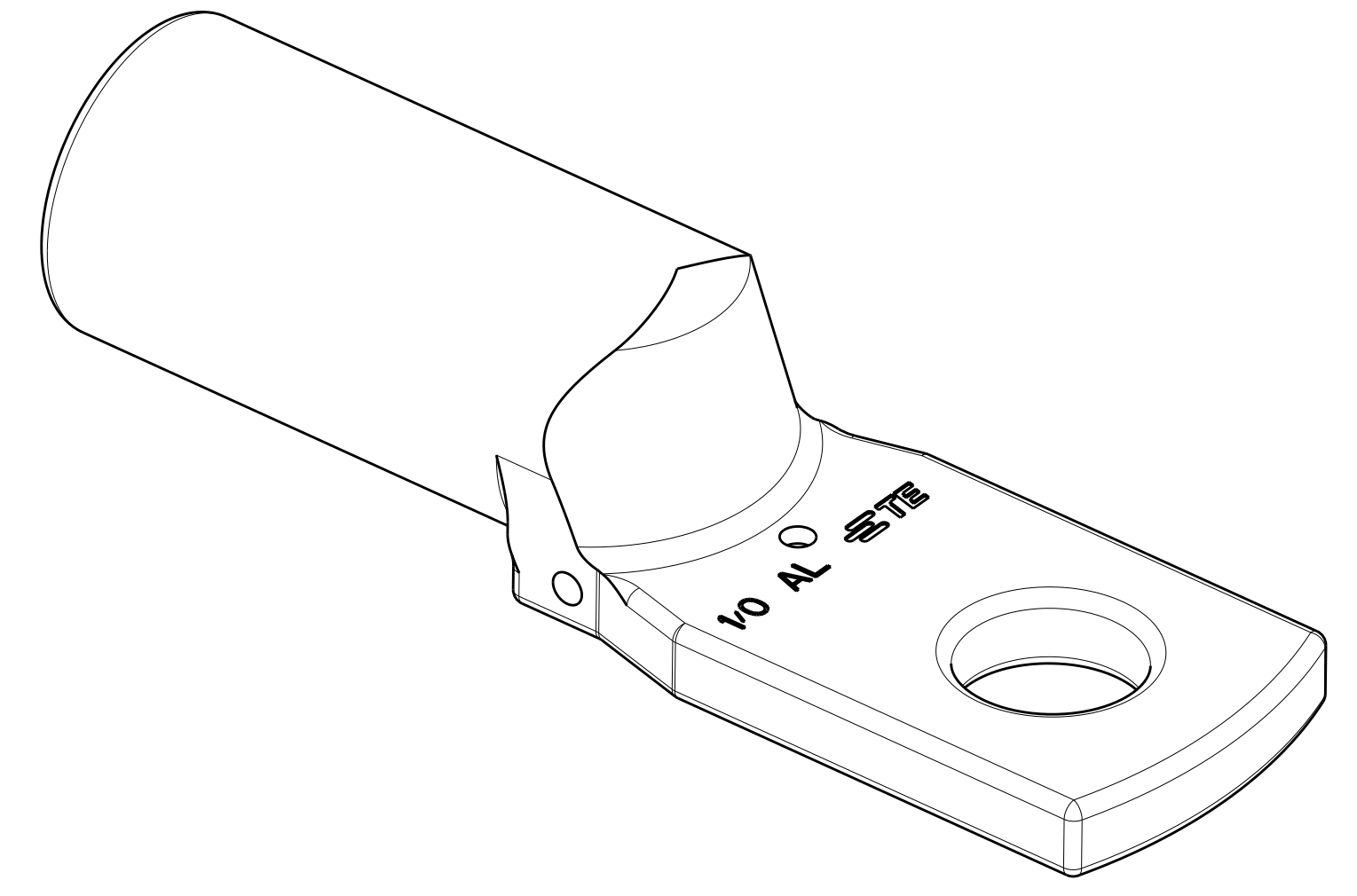

SCALE 3:1

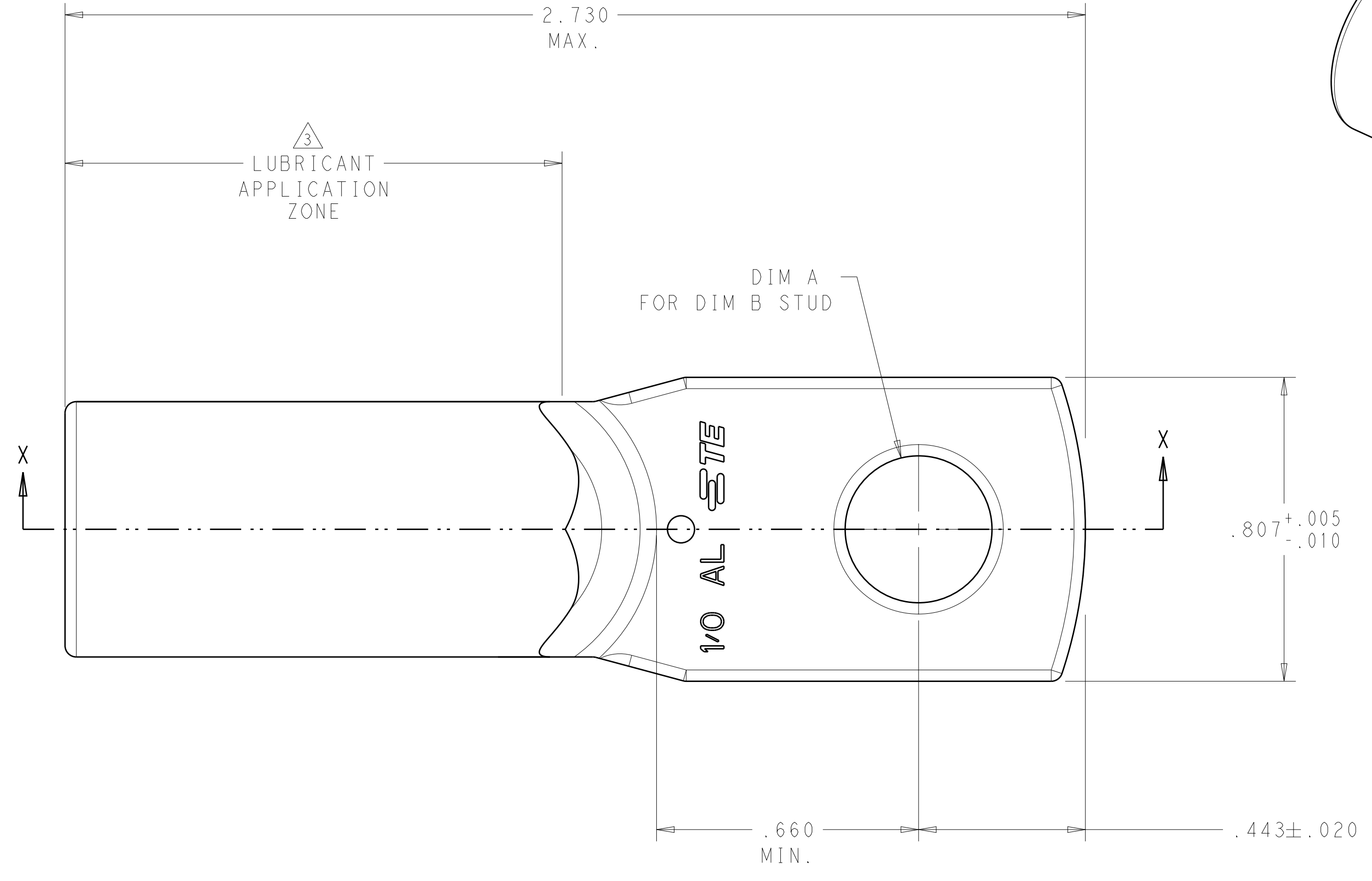
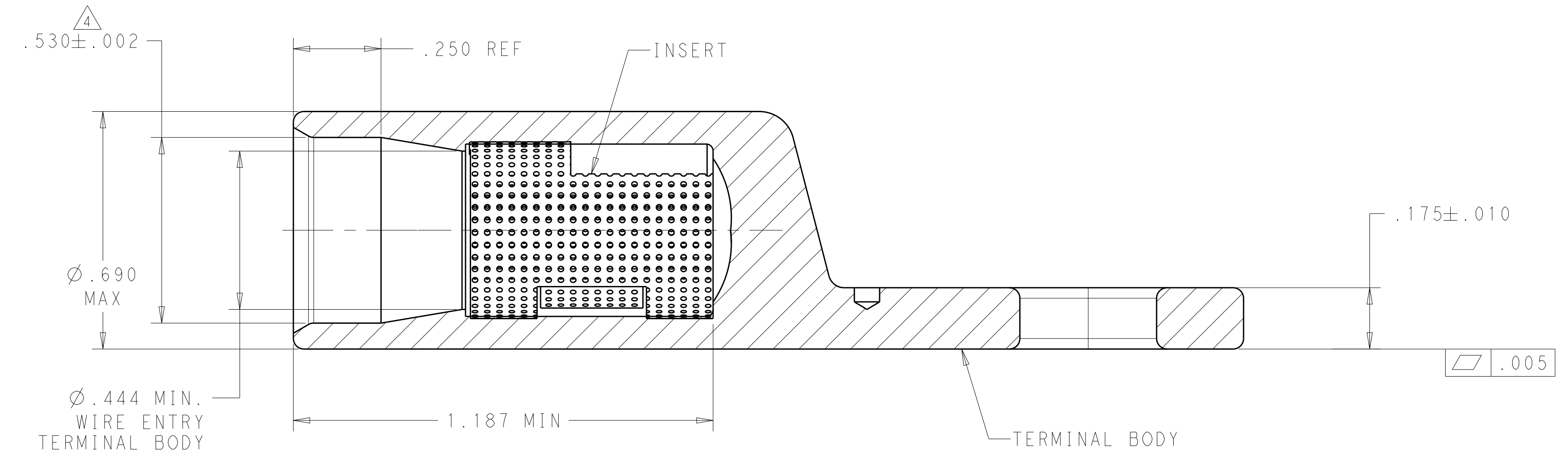

SECTION X-X

5/16	.328	2102572-3
3/8	.390	2102572-1
DIM B	DIM A	PART NO.

THIS DRAWING IS A CONTROLLED DOCUMENT.		DWN: D. FABIAN 14NOV2011	TE Connectivity
DIMENSIONS: IN		CHK: DEROCK, KIM 28NOV2012	
DIMENSIONS: IN 0 PLC ±.1 1 PLC ±.01 2 PLC ±.005 3 PLC ±.005 4 PLC ±.0005 ANGLES ±1°		TOLERANCES UNLESS OTHERWISE SPECIFIED: APVD: DEROCK, KIM 28NOV2012 PRODUCT SPEC: APPLICATION SPEC: WEIGHT: 21.22GRAMS CUSTOMER DRAWING	NAME: ASSEMBLY, ALUMINUM TERMINAL, STRAIGHT, SINGLE HOLE, 1/0 SIZE: CAGE CODE DRAWING NO: RESTRICTED TO:
MATERIAL: SEE CALL-OUT		FINISH: SEE CALL-OUT	SCALE: 4:1 SHEET 1 OF 1 REV E