

THIS DRAWING IS A CONTROLLED DOCUMENT FOR WHICH THE ORIGINAL IS KEPT IN THE COMPANY'S OFFICE. ANY REVISIONS TO THIS DRAWING SHOULD BE CONTACTED FOR THE LATEST REVISION.

THIS INFORMATION IS CONFIDENTIAL AND IS DISCLOSED TO YOU ON THE CONDITION THAT NO FURTHER DISCLOSURE FROM AMP, INCORPORATED, HARRISBURG, PA., WILL BE MADE WITHOUT THE WRITTEN AUTHORIZATION OF AMP, INCORPORATED, HARRISBURG, PA.

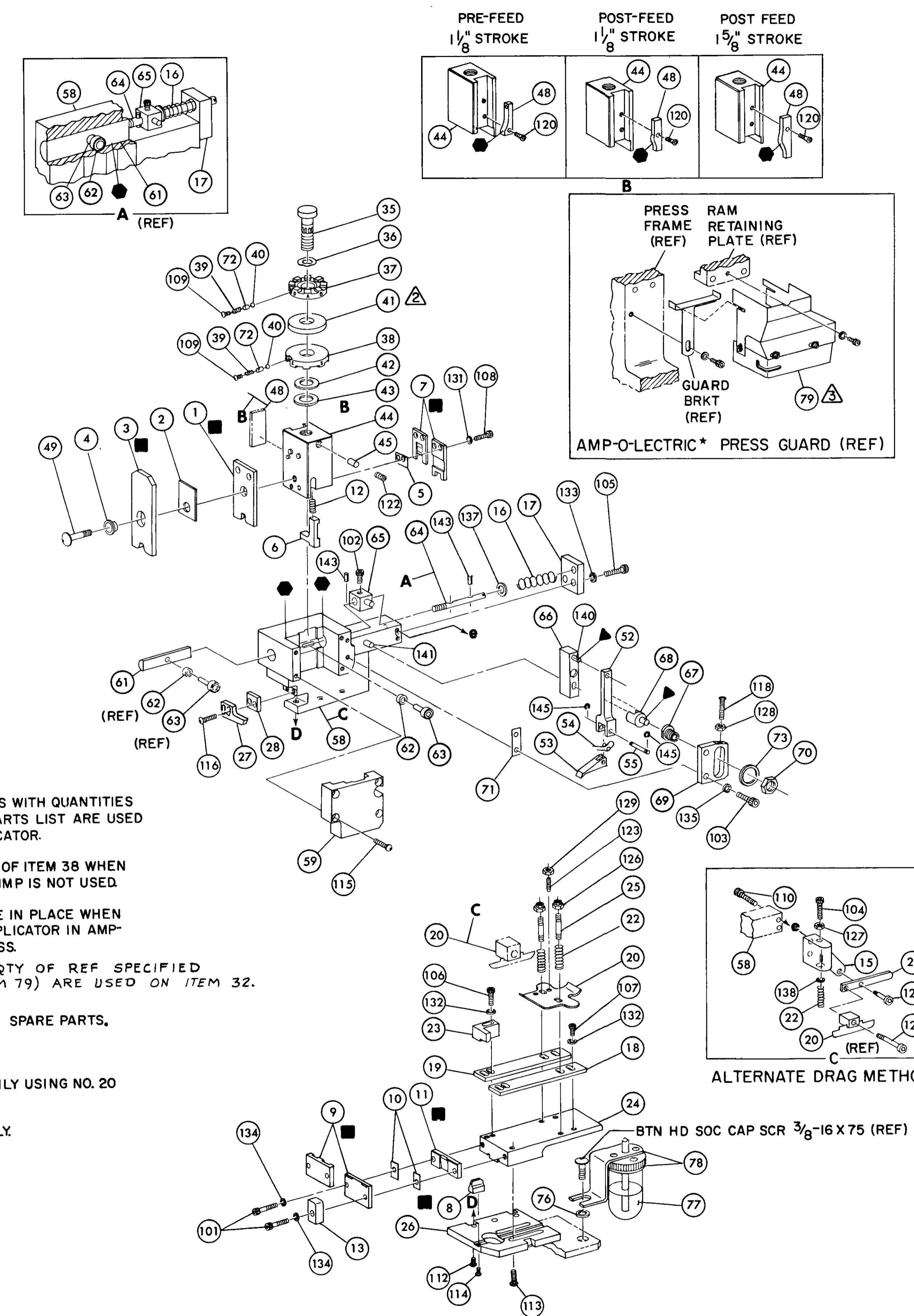

- NOTES:**
- 1 ONLY THE ITEMS WITH QUANTITIES SPECIFIED ON PARTS LIST ARE USED ON THIS APPLICATOR.
 - △ USED IN PLACE OF ITEM 38 WHEN INSULATION CRIMP IS NOT USED.
 - ▲ GUARD MUST BE IN PLACE WHEN OPERATING APPLICATOR IN AMP-O-LECTRIC PRESS.
 - 4. ITEMS WITH QTY OF REF SPECIFIED (EXCEPT ITEM 79) ARE USED ON ITEM 32.
- KEY:**
- RECOMMENDED SPARE PARTS.
 - ▲ LUBRICATE DAILY USING NO. 20 MACHINE OIL.
 - GREASE LIGHTLY.

REF	QTY	PART NO	DESCRIPTION	ITEM NO
REF		21045-3	RING, RETAINING 'C' (.187 DIA) FEED PIN	145
REF		5-21028-1	PIN, SLOT SPG (.12 DIA X .50) FD ADJ ROD	143
REF		1-21030-7	PIN, DOWEL (.187 DIA X 1.50) HOUSING	141
REF		1-21030-1	PIN, DOWEL (.187 DIA X .50) LEVER	140
REF		22260-5	WASHER, FLAT (NO 6) DRAG SPRING	138
REF		21899-4	WASHER, FLAT (5/16 DIA) SCR ADJ	137
REF		21024-5	WASHER, LOCK (NO 10) FEED ADJ PLATE	135
REF		21024-5	WASHER, LOCK (NO 10) SHEAR PLATES	134
REF		21024-5	WASHER, LOCK (NO 10) FEED ROD GUIDE	133
REF		21024-4	WASHER, LOCK (NO 8) STRIP GUIDE	132
REF		21024-4	WASHER, LOCK (NO 8) SHEAR BLADE	131
REF		21018-4	NUT, HEX MACH (4-40) DRAG	130
REF		21068-5	NUT, HEX MACH (6-32) FD ADJ PLATE	128
REF		21018-7	NUT, HEX MACH (10-32) DRAG SPRING	127
REF		21022-2	NUT, HEX SELF-LKG (8-32) DRAG STUD	126
REF		5-21004-7	SCR, SKT HD SHLD (250 DIA X .25) DRAG ARM	125
REF		21004-5	SCR, SKT HD SHLD (250 DIA X 1.00) DRAG	124
REF		4-21078-8	SCR, SKT SET OVAL POINT (4-40 X .75) DRAG	123
REF		22651-9	SCR, SKT SET (1/4-20 X 25) (LOC-WEL) RAM	122
REF		2-21003-0	SCR, FLAT HD SKT CAP (6-32 X .50) CAM	120
REF		3-21064-2	SCR, RD HD MACH (6-32 X 1.50) FEED ADJ	118
REF		2-21002-2	SCR, BTN HD SKT CAP (8-32 X .50) STRIPPER	116
REF		2-21002-9	SCR, BTN HD SKT CAP (10-32 X .75) HSG CAP	115
REF		24073-2	SCR, BTN HD SKT CAP (8-32 X .38) (LOC-WEL) ANVIL	114
REF		3-21002-3	SCR, BTN HD SKT CAP (1/4-20 X .50) STR GDE PL	113
REF		1-24073-9	SCR, BTN HD SKT CAP (1/4-20 X .75) BASE PL	112
REF		2-21000-4	SCR, SKT HD CAP (6-32 X 1.00) DRAG ADAPTOR	110
REF		3-23657-8	SCR, SKT HD CAP (6-32 X .25) (LOC-WEL) CP DISC	109
REF		2-21000-7	SCR, SKT HD CAP (8-32 X .50) SHEAR BLADE	108
REF		2-21000-6	SCR, SKT HD CAP (8-32 X .38) STRIP GUIDE	107
REF		2-21000-9	SCR, SKT HD CAP (8-32 X .75) STRIP GUIDE	106
REF		3-21000-7	SCR, SKT HD CAP (10-32 X .75) FD ROD GUIDE	105
REF		3-21000-9	SCR, SKT HD CAP (10-32 X 1.00) DRAG SPRING	104
REF		3-21000-6	SCR, SKT HD CAP (10-32 X .62) FD ADJ PLATE	103
REF		3-21000-4	SCR, SKT HD CAP (10-32 X .38) PIVOT BLK	102
REF		3-21000-8	SCR, SKT HD CAP (10-32 X .88) SHEAR PLATE	101
REF		455745-1	GUARD, WINDOW	79
REF		465184-9	LUBRICATOR ASSY	78
REF		455985-1	OIL, LUBRICATING	77
REF		454406-1	SPACER, LUB BRACKET	76
REF		458109-1	WASHER, FLAT (SPECIAL)	75
REF		690603-1	SPRING, ASSIST	74
REF		690517-1	SPACER	73
REF		22594-8	NUT, HEX	72
REF		240628-1	PLATE, ADJ	71
REF		240626-1	SHAFT, PIVOT	70
REF		240633-1	BUSHING	69
REF		455680-1	LEVER, INTERMEDIATE	68
REF		240629-1	BLOCK, PIVOT	67
REF		240632-2	SCREW, ADJ	66
REF		240659-3	PIN, CAM ROLLER	65
REF		240658-1	CAM, ROLLER	64
REF		454398-1	ROD, FEED	63
REF		454220-1	CAP, RAM	62
REF		453736-1	HOUSING	61
REF		240624-1	PIN, FEED FINGER	60
REF		691499-1	SPRING, FEED FINGER	59
REF		240635-1	FINGER, FEED	58
REF		240634-3	LEVER, TERMINAL	57
REF		7-21002-9	BOLT, CRIMPER	56
REF		690501-3	CAM, POST FEED 1/8 STROKE	55
REF		690191-1	PLUG, NYLON	54
REF		455674-1	RAM	53
REF		690125-1	WASHER, LAMINATED	52
REF		690124-1	WASHER, RAM	51
REF		23241-6	SPACER, DISC	50
REF		690170-1	BALL, STEEL	49
REF		690142-1	SPRING, COMPRESSION	48
REF		5-455829-7	DISC, INSULATION	47
REF		22480-5	DISC, WIRE	46
REF		690212-1	WASHER, SPRING	45
REF			POST, RAM	44
REF				43
REF				42
REF				41
REF				40
REF				39
REF				38
REF				37
REF				36
REF				35
REF				34
REF				33
REF				32
REF				31
REF				30
REF				29
REF				28
REF				27
REF				26
REF				25
REF				24
REF				23
REF				22
REF				21
REF				20
REF				19
REF				18
REF				17
REF				16
REF				15
REF				14
REF				13
REF				12
REF				11
REF				10
REF				9
REF				8
REF				7
REF				6
REF				5
REF				4
REF				3
REF				2
REF				1

CRIMPING DATA				APPLICATOR WILL APPLY									
PAD LTR	CRIMP HEIGHT	WIRE SIZE	WIRE STRIP LENGTH	ITEM NO									
A	.047	18		170012-1									
B	.045	20		170012-2									
C	NOT USED												
D	NOT USED												
CRIMP	SIZE	TYPE	FEED	APPL INST									
WIRE	.110	F											
INSUL	.180	F	.770	A18039									
WIRE RANGE	20-18	INSULATION RANGE	.100-.145	PRESS NO 565435-5									
REMARKS													
AMP-O-LECTRIC POST FEED													
APPL USED ON MACHINE PART NO		MACH SERIAL NO		DISTRIBUTION									
CUSTOMER NAME		APPL SERIAL NO		ORIGINAL									
ADDRESS		PURCHASE ORDER		CUSTOMER COPY									
CITY		ENG APP		FIELD ENG COPY									
<table border="1"> <tr> <td>NO</td> <td>REV</td> </tr> <tr> <td> </td> <td> </td> </tr> </table>						NO	REV						
NO	REV												
<table border="1"> <tr> <td>DATE</td> <td>BY</td> <td>APP</td> </tr> <tr> <td> </td> <td> </td> <td> </td> </tr> </table>						DATE	BY	APP					
DATE	BY	APP											
<table border="1"> <tr> <td>REV</td> <td>DATE</td> <td>BY</td> <td>APP</td> </tr> <tr> <td> </td> <td> </td> <td> </td> <td> </td> </tr> </table>						REV	DATE	BY	APP				
REV	DATE	BY	APP										

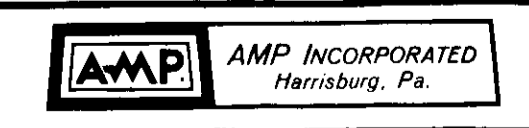

SET UP PAGE 10-1
458638-1160
DR 8-27-74 APP 8-29-74
D 0150-6564-95
REV PER EW R-5483 1/24 2/1/84
REV PER 123619 8/14 7/78

LOC A D NO 466251-2 REV 15

NAME MINIATURE QUICK CHANGE APPLICATOR
END FEED (SHUR PLUG RECPT)