

THIS DRAWING IS UNPUBLISHED. RELEASED FOR PUBLICATION
 © COPYRIGHT - BY TYCO ELECTRONICS CORPORATION. ALL RIGHTS RESERVED.

LOC	DIST	REVISIONS					
HC	00	P	LTR	DESCRIPTION	DATE	DWN	APVD
			A	REVISED, REDRAWN IN TYCO FORMAT.	05AUG1997	KYLE	RDP

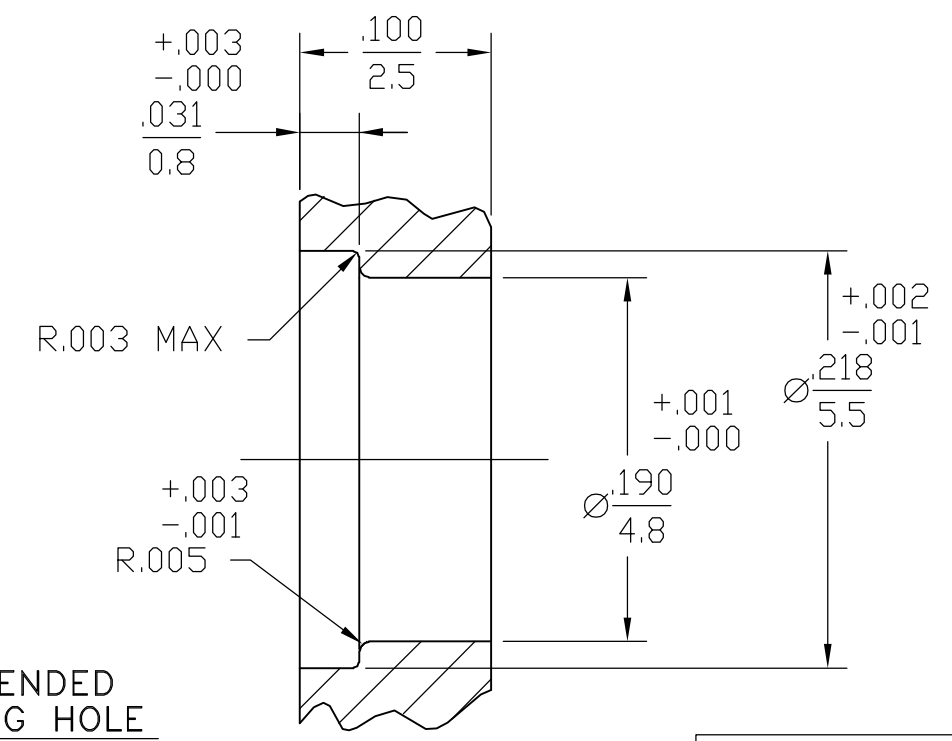
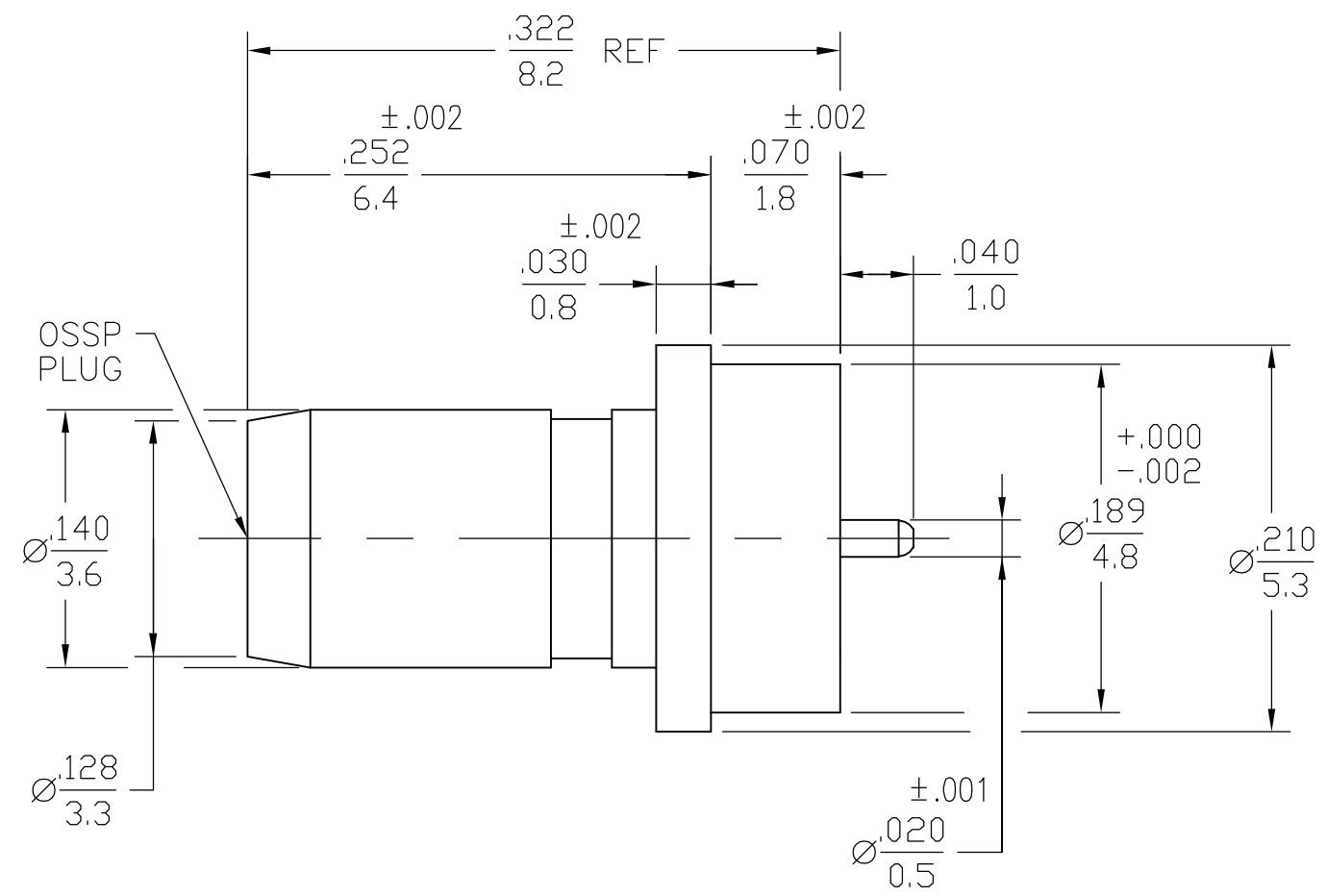

RECOMMENDED MOUNTING HOLE

1059902-1
 PART NUMBER

ELECTRICAL	MECHANICAL	ENVIRONMENTAL
Nominal Impedance (Ohms) 50	Interface Dimensions PER TYCO ELECTRONICS CATALOG	TEMPERATURE RATING -65° TO +125°C
Frequency Range (GHz) DC to 18.0	Recommended Mating Torque 12-15 IN-LBS	Vibration MIL-STD-202, Method 204, Condition D
Volt Rating (VRMS MAX) @ Sea Level 335	Force to Engage and Disengage (In-Lbs MAX) 3.0	Shock MIL-STD-202, Method 213, Condition I
VSWR 1.05 + .01f(GHz)		Thermal Shock MIL-STD-202, Method 107, Condition B, EXCEPT HIGH TEMP +125°C
Insertion Loss (dB MAX) .05 √f(GHz)		Moisture Resistance MIL-STD-202, Method 106
RF Leakage (dB MIN) -[100-f(GHz)]		Corrosion - MIL-STD-202, Method 101, Condition B, 5% salt spray
Corona, 70,000 Ft (VRMS MIN) N/A		
Dielectric Withstanding Voltage (VRMS MIN) @ Sea Level 750		
Contact Resistance (Milliohms MAX)		
Center Contact 10.0		
Outer Contact 2.0		
Cable to Housing N/A		
RF High Potential @ Sea Level (VRMS MIN @ 5 MHz) 667		
I.R.(Megohms MIN) 5,000		

COMPONENT	MATERIAL	FINISH
HOUSING	STAINLESS STEEL PER ASTM A 484 AND ASTM A582, TYPE 303	GOLD PLATE PER ASTM B 488
DIELECTRIC	PTFE FLUOROCARBON PER ASTM D 1710	N/A
CENTER CONTACT	IRON-NICKEL ALLOY PER AMS-I-23011	GOLD PLATE PER ASTM B 488
HERMETIC SEAL	GLASS BEAD	N/A

THIS DRAWING IS A CONTROLLED DOCUMENT.		DWN JB 23FEB1987	 Tyco Electronics Corporation Harrisburg, PA 17105-3608
DIMENSIONS: INCHES/mm		CHK MH/M 27FEB1987	
TOLERANCES UNLESS OTHERWISE SPECIFIED:		APVD BAR 03MAR1987	
0 PLC ± - 1 PLC ± - 2 PLC ± - 3 PLC ± .005 4 PLC ± - ANGLES ± 1° MATERIAL SEE TABLE FINISH SEE TABLE		NAME O SSP FEETHRU PLUG, HERMETIC, PANEL, STRAIGHT TERMINAL (4757-3204-00)	
MATERIAL SEE TABLE		PRODUCT SPEC -	RESTRICTED TO -
MATERIAL SEE TABLE		APPLICATION SPEC -	SIZE A3
MATERIAL SEE TABLE		WEIGHT -	CAGE CODE 00779
MATERIAL SEE TABLE		CUSTOMER DRAWING	DRAWING NO 1059902
MATERIAL SEE TABLE		SCALE 10:1	SHEET 1 of 1
MATERIAL SEE TABLE		REV A	