

LWL-Sende-LED 850nm

Technical data (TC=25°C)

cont. Forward Current : I_{Fmax} = 100mA

Forward Voltage : $U_{Vtyp.}$ = 1,8V-2,0V

Opt. Wavelength : = 830-870nm

Spectr. Bandwidth : = 35nm

Rise-/Fall Times : t_r = 6ns typ.
 t_f = 6ns typ.

Fiber Coupled Power :

($I_f=100mA$)
 in 50/125 GI : P_s = 15-25 μ W typ.
 in 200/230 S : P_s = 650 μ W max.

Storage Temp. Range : T_{str} = -55°C...+115°C

Operating Temp. Range : T_{opr} = -40°C...+100°C

Soldering (240°C) : t = 5s max.

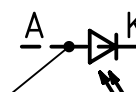
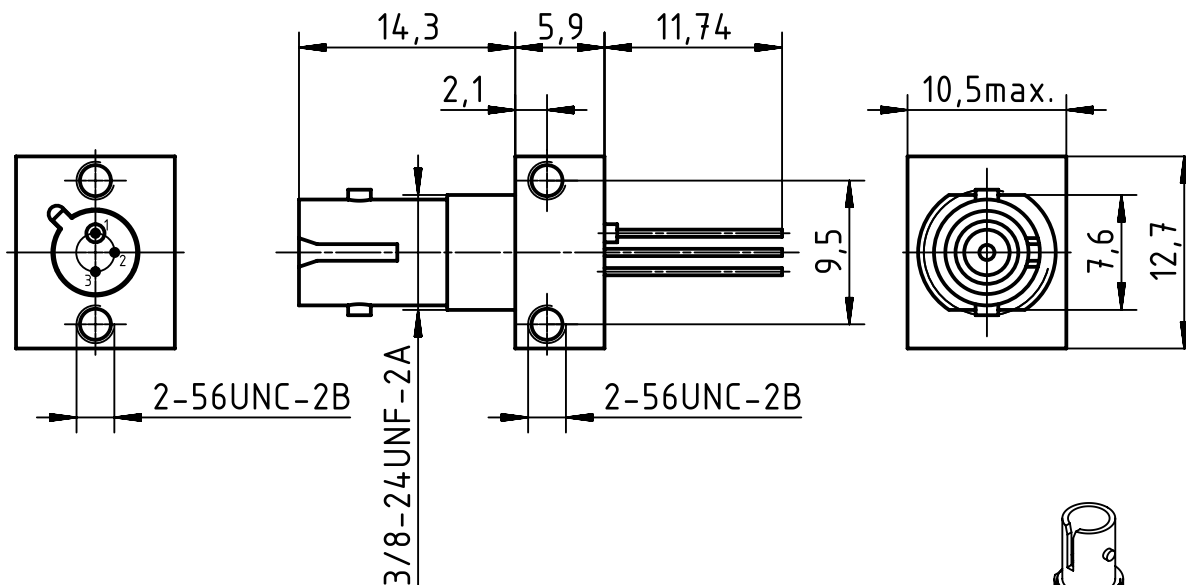

plastic colored sleeve

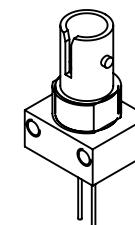

Pinout
 1. Anode
 2. Kathode
 3. Case

Anode/cathode isolated from the housing

	All rights reserved Department EL PD - DE	All Dimensions in mm Original Size DIN A4		Scale 1:1	Free size tol.	Ref. Sub.	
		Created by FINKEV	Inspected by MOOR	Standardisation TIEMANNA	Date 2013-09-18	State Final Release	
HARTING Electric GmbH & Co. KG D-32339 Espelkamp		Title FH-ST receptacle with LED 850nm				Doc-Key / ECM-Nr. 100092413/UGD/005/A 500000066458	
		Type TB	Number 20 50 000 1121			Rev. A	Page 1/1