

This document is the property of Amphenol Corporation and is delivered on the express condition that it is not to be disclosed, reproduced or used, in whole or in part, for manufacture or sale by anyone other than Amphenol Corporation without its prior consent, & that no right is granted to disclose or to use any information in this document.

CUSTOMER DRAWING

REVISIONS

SYM	ECN	DESCRIPTION	DATE	APPROVED
1	20XXXXXX	NEW RELEASE	2020/01/09	Tom.Tang
2	20XXXXXX	Updated dustproof rating to IP68	2020/01/09	Tom.Tang
3	HKXXXX	Updated BOM notes	2021/10/19	IP
4	HKXXXX	Update recommended panel sizes	2021/10/28	Michael.Qin
5	HKXXXX	Add explosion view	2021/12/09	Michael.Qin
6	HKXXXX	Update PIN quantity	2023/06/19	Michael.Qin

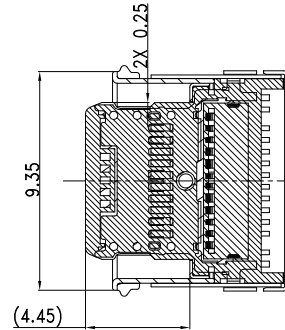
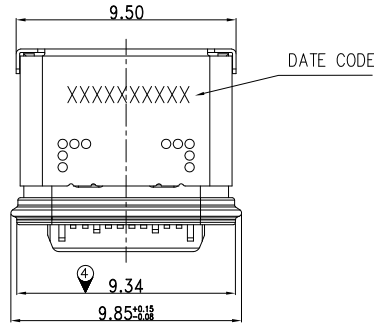

SECTION E-E (SCALE 1:1)

Pin No	Signal Name	Mating Sequence	Pin No	Signal Name	Mating Sequence
A1	GND	First	B12	GND	First
A2	TX1+	Second	B11	RX1+	Second
A3	TX1-	Second	B10	RX1-	Second
A4	Vbus	First	B9	Vbus	First
A5	CC1	Second	B8	SBU2	Second
A6	D+	Second	B7	D-	Second
A7	D-	Second	B6	D+	Second
A8	SBU1	Second	B5	CC2	Second
A9	Vbus	First	B4	Vbus	First
A10	RX2-	Second	B3	TX2-	Second
A11	RX2+	Second	B2	TX2+	Second
A12	GND	First	B1	GND	First
SHELL	GND		SHELL	GND	

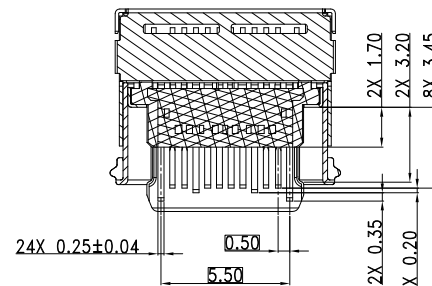
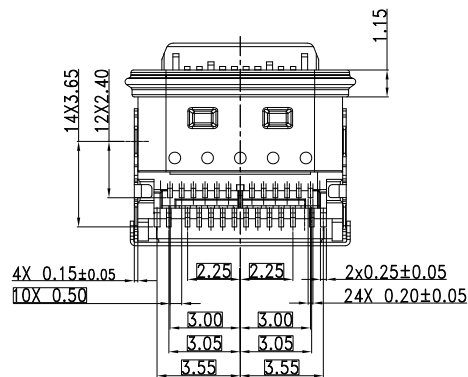
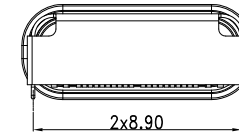
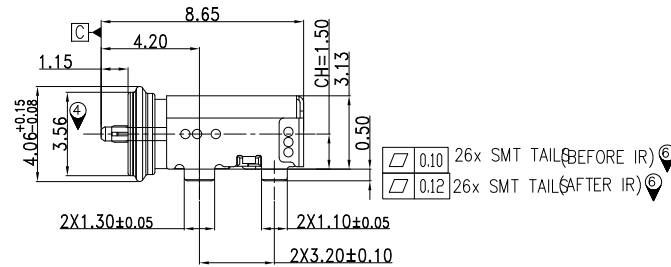
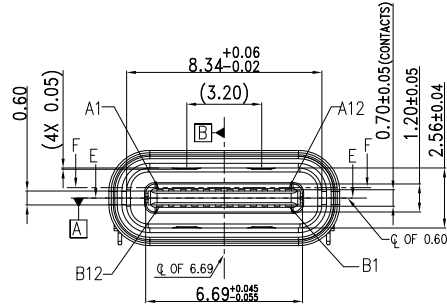

SECTION F-F (SCALE 1:1)



UNLESS OTHERWISE SPECIFIED TOLERANCES		APPROVAL		DATE		Amphenol	
U.S.		DRAWN	Alec.II	06/19/23*		Customer Drawing For	
METRIC		CHECKED	Michael.qin	06/19/23*		USB 3.1 GEN1, Type C socket connector,	
X +/- 0.50		DRAWING FILE :		R/A Top mount, Double SMT type,			
.XX +/- 0.15		ANGLE OF PROJECTION		CH=1.50mm, Waterproof IP68			
.XXX +/- 0.10		REMOVE SHARP EDGES		SIZE		DRAWING NO.	
FRACTIONS +/- 0.10		DIMENSIONS		A3		C 12401861	
ANGLES +/- 3°		U.S. INCHES		SCALE		NONE	
FOR MATERIALS AND FINISHES SEE NOTES		(METRIC)		REVISION		6	
				SHEET		1 OF 2	

This document is the property of Amphenol Corporation and is delivered on the express condition that it is not to be disclosed, reproduced or used, in whole or in part, for manufacture or sale by anyone other than Amphenol Corporation without its prior consent, & that no right is granted to disclose or to use any information in this document.

CUSTOMER DRAWING

REVISIONS

See page 1

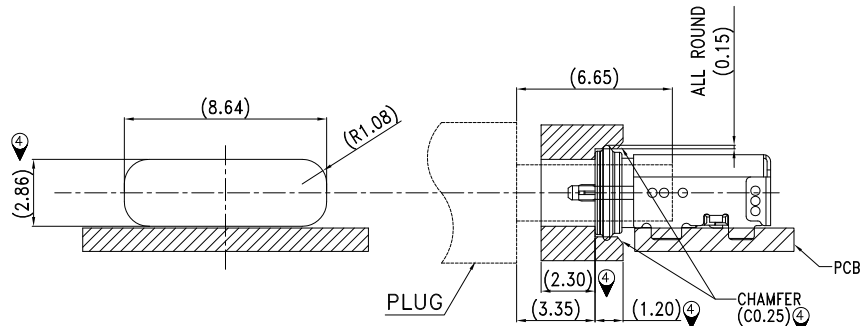

REF. PANEL DESIGN

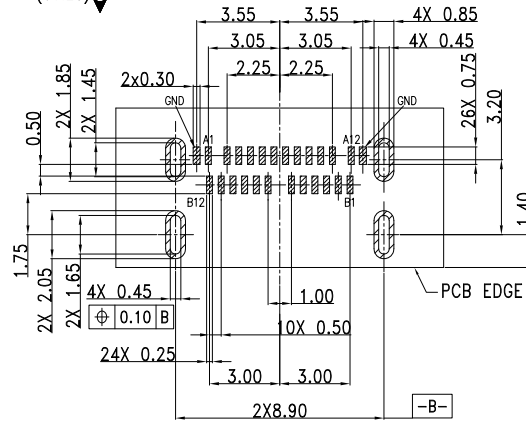

RECOMMENDED PCB LAYOUT
(Tolerance=±0.05)

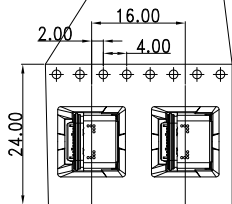
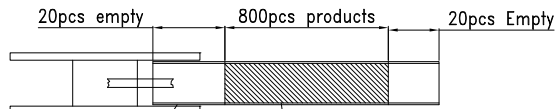

customer unwinding direction

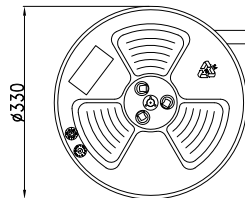

PACK DIRECTION

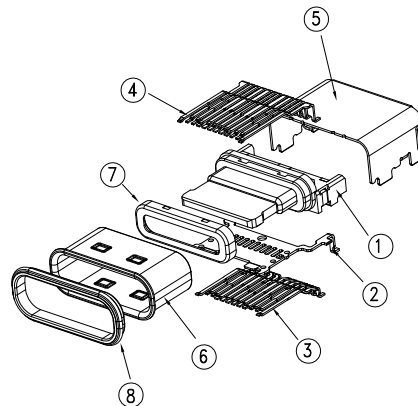

NOTES/注释:

- MATERIAL/材料: SEE TABLE/见下表
- GENERAL SPECIFICATION/通用特性:
 - COPLANARITY /共面度: 0.10 Max.
 - CURRENT RATING: 5A / 额定电流: 5安培
 - CONTACT RESISTANCE: 40mΩ MAX (INITIAL).
INSULATION RESISTANCE: 100MΩ Min
接触电阻: 40毫欧最大(初始值) / 绝缘电阻: 100MΩ Min
 - DIELECTRIC WITHSTANDING VOLTAGE: 100 VAC
耐电压: 100伏交流
 - MECHANICAL CHARACTERISTICS:
INSERTION FORCE: 5~20N EXTRACTION FORCE: 8~20N
AFTER DURABILITY EXTRACTION FORCE: 6~20N
力学特性: 初始插入力: 5~20N 拔出力: 8~20N
耐久后拔出力: 6~20N
 - DURABILITY: 10000 CYCLES / 耐久性: 10000次
 - PACKAGING TYPE: CARRIER TAPE./ 包装类型: 载带包装
- WATERPROOF CLASS IP68/防水等级 IP68
- DIMENSIONING SHALL BE INTERPRETED PER ASME Y14.5M 1994.
尺寸标注基于ASME Y14.5M 1994标准规范
- MATERIAL SHOULD BE FULFILLED AMPHENOL SPEC.# S-SN-002, FOR HALOGEN FREE PRODUCTS, ALSO NEED TO MEET S-SN-004.
产品材料环保标准为Amphenol SSN#002,如果是无卤产品需满足标准SSN#004
- ORDER P/N SYSTEM/产品料号编码系统 : 12401861XX12A

Plating Spec:

- 21: Mating Area: Au 30u" Min
- Solder Area: Gold flash
- 50u"Min Nickel Under Plating Over All

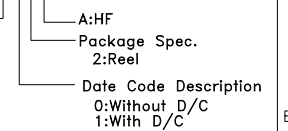

8	LIM	1	CHN-LIMS-60-A/B	BLACK
7	SMALL SHELL	1	SUS304-1/2H	CLEANING
6	MAIN SHELL	1	SUS304-1/2H	CLEANING
5	SUB-SHELL	1	SUS304-1/2H	NI PLATED
4	TOP TERMINAL	1		MATING AREA : Au30u"MIN
3	BOTTOM TERMINAL	1	NKE012-EH	SOLDER TAIL:GOLD FLASH, NICKEL OVERALL.
2	MID PLATE	1	SUS301-H	NI PLATED
1	MAIN HOUSING	1	DSM PA46 HFX31X	BLACK
ITEM DESCRIPTION	Q'TY		③ MATERIAL	FINISH

UNLESS OTHERWISE SPECIFIED TOLERANCES		APPROVAL		DATE	
U.S.		DRAWN	Alec.li	06/16/23	
.XX	+/-	CHECKED	Migheal.qin	06/16/23	
FRACTIONS	+/-	CHECKED			
ANGLES	+/-	DRAWING FILE :			
FOR MATERIALS AND FINISHES SEE NOTES		BILL OF MATERIAL			
REMOVE SHARP EDGES		ANGLE OF PROJECTION			
DIMENSIONS					
U.S.	INCHES	Amphenol Amphenol East Asia Limited TITLE Customer Drawing For USB 3.1 GEN1, Type C socket connector, R/A Top mount, Double SMT type, CH=1.50mm, Waterproof IP68			
(METRIC)	(MM)	SIZE	DRAWING NO.	REV.	
		A3	C 12401861	6	
		SCALE	NONE	SHEET 2 OF 2	