

1.00mm CENTER FLAT FLEX CABLE (FFC) (105°C, Au PLATING)

"L" DIM. →	30 ± 2 MM		51 ± 2 MM		76 ± 3 MM		102 ± 3 MM		127 ± 4 MM		152 ± 4 MM		178 ± 4 MM		203 ± 4 MM		229 ± 5 MM		254 ± 5 MM		305 ± 5 MM	
REF DIM →	(1.18 INCH)		(2 INCHES)		(3 INCHES)		(4 INCHES)		(5 INCHES)		(6 INCHES)		(7 INCHES)		(8 INCHES)		(9 INCHES)		(10 INCHES)		(12 INCHES)	
CABLE TYPE →	A	D	A	D	A	D	A	D	A	D	A	D	A	D	A	D	A	D	A	D	A	D
CIRCUITS ↓																						
4	150390701	150390700	150390703	150390702	150390705	150390704	150390707	150390706	150390709	150390708	150390711	150390710	150390713	150390712	150390715	150390714	150390717	150390716	150390719	150390718	150390721	150390720
6	150390201	150390202	150390203	150390204	150390205	150390206	150390207	150390208	150390209	150390210	150390211	150390212	150390213	150390214	150390215	150390216	150390217	150390218	150390219	150390220	150390221	150390222
8	150390223	150390224	150390225	150390226	150390227	150390228	150390229	150390230	150390231	150390232	150390233	150390234	150390235	150390236	150390237	150390238	150390239	150390240	150390241	150390242	150390243	150390244
10	150390245	150390246	150390247	150390248	150390249	150390250	150390251	150390252	150390253	150390254	150390255	150390256	150390257	150390258	150390259	150390260	150390261	150390262	150390263	150390264	150390265	150390266
12	150390267	150390268	150390269	150390270	150390271	150390272	150390273	150390274	150390275	150390276	150390277	150390278	150390279	150390280	150390281	150390282	150390283	150390284	150390285	150390286	150390287	150390288
14	150390289	150390290	150390291	150390292	150390293	150390294	150390295	150390296	150390297	150390298	150390299	150390300	150390301	150390302	150390303	150390304	150390305	150390306	150390307	150390308	150390309	150390310
16	150390311	150390312	150390313	150390314	150390315	150390316	150390317	150390318	150390319	150390320	150390321	150390322	150390323	150390324	150390325	150390326	150390327	150390328	150390329	150390330	150390331	150390332
18	150390333	150390334	150390335	150390336	150390337	150390338	150390339	150390340	150390341	150390342	150390343	150390344	150390345	150390346	150390347	150390348	150390349	150390350	150390351	150390352	150390353	150390354
20	150390355	150390356	150390357	150390358	150390359	150390360	150390361	150390362	150390363	150390364	150390365	150390366	150390367	150390368	150390369	150390370	150390371	150390372	150390373	150390374	150390375	150390376
22	150390377	150390378	150390379	150390380	150390381	150390382	150390383	150390384	150390385	150390386	150390387	150390388	150390389	150390390	150390391	150390392	150390393	150390394	150390395	150390396	150390397	150390398
24	150390399	150390400	150390401	150390402	150390403	150390404	150390405	150390406	150390407	150390408	150390409	150390410	150390411	150390412	150390413	150390414	150390415	150390416	150390417	150390418	150390419	150390420
26	150390421	150390422	150390423	150390424	150390425	150390426	150390427	150390428	150390429	150390430	150390431	150390432	150390433	150390434	150390435	150390436	150390437	150390438	150390439	150390440	150390441	150390442
28	150390443	150390444	150390445	150390446	150390447	150390448	150390449	150390450	150390451	150390452	150390453	150390454	150390455	150390456	150390457	150390458	150390459	150390460	150390461	150390462	150390463	150390464
30	150390465	150390466	150390467	150390468	150390469	150390470	150390471	150390472	150390473	150390474	150390475	150390476	150390477	150390478	150390479	150390480	150390481	150390482	150390483	150390484	150390485	150390486
32	150390487	150390488	150390489	150390490	150390491	150390492	150390493	150390494	150390495	150390496	150390497	150390498	150390499	150390500	150390501	150390502	150390503	150390504	150390505	150390506	150390507	150390508
34	150390509	150390510	150390511	150390512	150390513	150390514	150390515	150390516	150390517	150390518	150390519	150390520	150390521	150390522	150390523	150390524	150390525	150390526	150390527	150390528	150390529	150390530
36	150390531	150390532	150390533	150390534	150390535	150390536	150390537	150390538	150390539	150390540	150390541	150390542	150390543	150390544	150390545	150390546	150390547	150390548	150390549	150390550	150390551	150390552
38	150390553	150390554	150390555	150390556	150390557	150390558	150390559	150390560	150390561	150390562	150390563	150390564	150390565	150390566	150390567	150390568	150390569	150390570	150390571	150390572	150390573	150390574
40	150390575	150390576	150390577	150390578	150390579	150390580	150390581	150390582	150390583	150390584	150390585	150390586	150390587	150390588	150390589	150390590	150390591	150390592	150390593	150390594	150390595	150390596

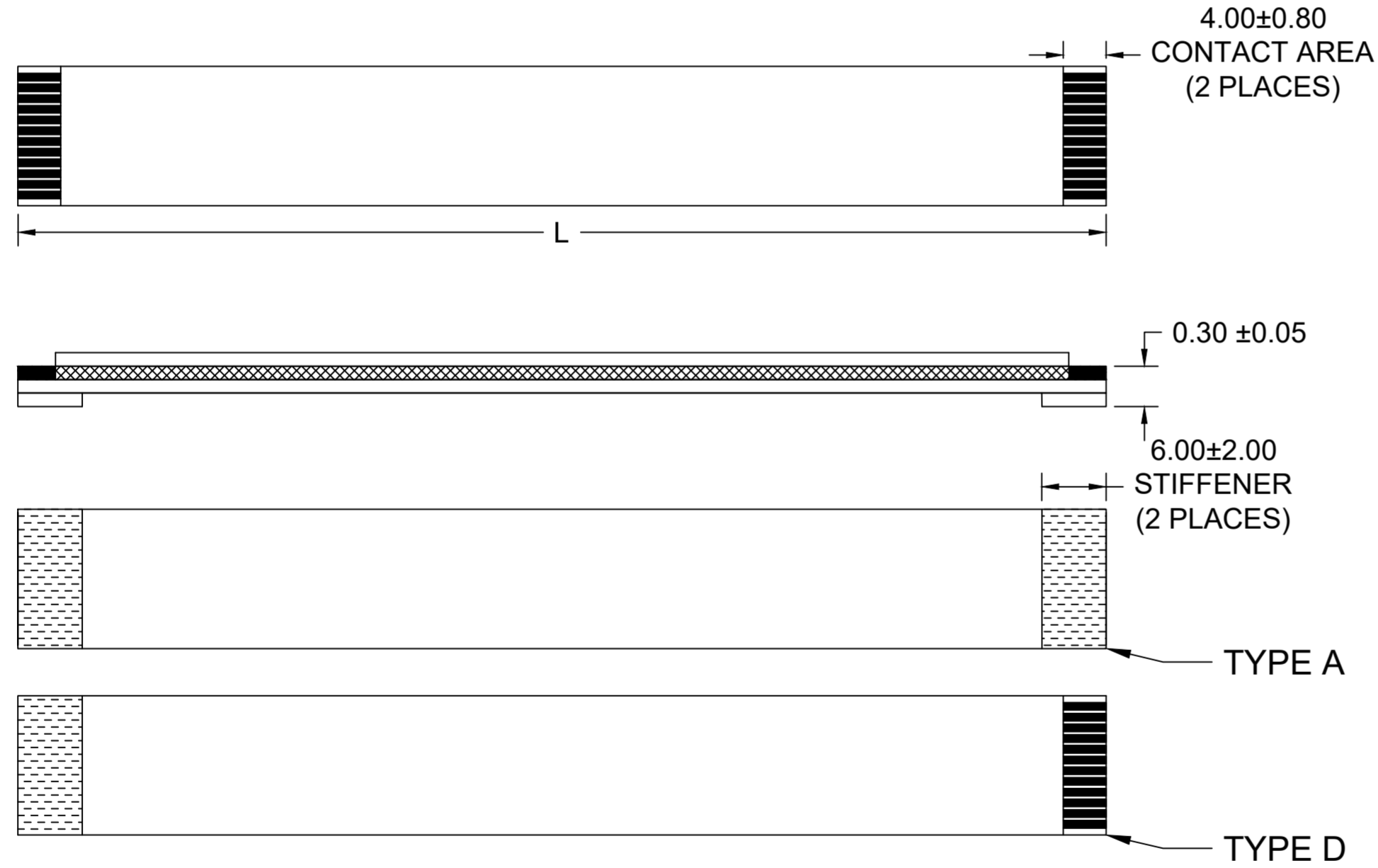

- NOTES:**
- NO PRINTING ON JUMPER CABLE UNLESS OTHERWISE SPECIFIED. IF PRINTING IS REQUIRED, THEN IT WOULD BE CONSIDERED A SPECIAL JUMPER CABLE.
 - FOR ODD CIRCUIT COUNT, CROSS-SECTION AND END-TAIL DETAIL REFER TO SHEET # 2

THIS DRAWING CONTAINS INFORMATION THAT IS PROPRIETARY TO MOLEX ELECTRONIC TECHNOLOGIES, LLC AND SHOULD NOT BE USED WITHOUT WRITTEN PERMISSION

DIMENSION UNITS	SCALE	CURRENT REV DESC: DRAWING CORRECTION			
MM	2:1				
GENERAL TOLERANCES (UNLESS SPECIFIED)					
	mm	INCH	EC NO: 728054		
4 PLACES	±----	±----	DRWN: DIEGOG7	2022/11/10	
3 PLACES	±----	±----	CHK'D: JSMITH11	2022/11/14	
2 PLACES	±----	±----	APPR: JSMITH11	2022/11/14	
1 PLACE	±----	±----	INITIAL REVISION:		
0 PLACES	±----	±----	DRWN: DIEGOG7	2022/06/01	
ANGULAR TOL	± 0.5 °		APPR: JSMITH11	2022/11/03	
DRAFT WHERE APPLICABLE MUST REMAIN WITHIN DIMENSIONS		THIRD ANGLE PROJECTION	DRAWING	SERIES	DOCUMENT NUMBER
			C-SIZE	15039	150390001
					DOC TYPE
					PSD
					DOC PART
					000
					REVISION
					B
					MATERIAL NUMBER
					SEE CHART
					CUSTOMER
					GENERAL MARKET
					SHEET NUMBER
					1 OF 2

1.00mm CENTER FLAT FLEX CABLE (FFC) (105°C, Au PLATING)

"L" DIM. →	30 ± 2 MM		51 ± 2 MM		76 ± 3 MM		102 ± 3 MM		127 ± 4 MM		152 ± 4 MM		178 ± 4 MM		203 ± 4 MM		229 ± 5 MM		254 ± 5 MM		305 ± 5 MM	
REF DIM →	(1.18 INCH)		(2 INCHES)		(3 INCHES)		(4 INCHES)		(5 INCHES)		(6 INCHES)		(7 INCHES)		(8 INCHES)		(9 INCHES)		(10 INCHES)		(12 INCHES)	
CABLE TYPE →	A	D	A	D	A	D	A	D	A	D	A	D	A	D	A	D	A	D	A	D	A	D
CIRCUITS ↓																						
5	150390723	150390722	150390725	150390724	150390727	150390726	150390729	150390728	150390731	150390730	150390733	150390732	150390735	150390734	150390737	150390736	150390739	150390738	150390741	150390740	150390743	150390742
7	150390745	150390744	150390747	150390746	150390749	150390748	150390751	150390750	150390753	150390752	150390755	150390754	150390757	150390756	150390759	150390758	150390761	150390760	150390763	150390762	150390765	150390764
9	150390767	150390766	150390769	150390768	150390771	150390770	150390773	150390772	150390775	150390774	150390777	150390776	150390779	150390778	150390781	150390780	150390783	150390782	150390785	150390784	150390787	150390786
11	150390789	150390788	150390791	150390790	150390793	150390792	150390795	150390794	150390797	150390796	150390799	150390798	150390801	150390800	150390803	150390802	150390805	150390804	150390807	150390806	150390809	150390808
13	150390811	150390810	150390813	150390812	150390815	150390814	150390817	150390816	150390819	150390818	150390821	150390820	150390823	150390822	150390825	150390824	150390827	150390826	150390829	150390828	150390831	150390830
15	150390833	150390832	150390835	150390834	150390837	150390836	150390839	150390838	150390841	150390840	150390843	150390842	150390845	150390844	150390847	150390846	150390849	150390848	150390851	150390850	150390853	150390852
17	150390855	150390854	150390857	150390856	150390859	150390858	150390861	150390860	150390863	150390862	150390865	150390864	150390867	150390866	150390869	150390868	150390871	150390870	150390873	150390872	150390875	150390874
19	150390877	150390876	150390879	150390878	150390881	150390880	150390883	150390882	150390885	150390884	150390887	150390886	150390889	150390888	150390891	150390890	150390893	150390892	150390895	150390894	150390897	150390896
21	150390899	150390898	150390901	150390900	150390903	150390902	150390905	150390904	150390907	150390906	150390909	150390908	150390911	150390910	150390913	150390912	150390915	150390914	150390917	150390916	150390919	150390918
23	150390921	150390920	150390923	150390922	150390925	150390924	150390927	150390926	150390929	150390928	150390931	150390930	150390933	150390932	150390935	150390934	150390937	150390936	150390939	150390938	150390941	150390940
25	150390943	150390942	150390945	150390944	150390947	150390946	150390949	150390948	150390951	150390950	150390953	150390952	150390955	150390954	150390957	150390956	150390959	150390958	150390961	150390960	150390963	150390962
27	150390965	150390964	150390967	150390966	150390969	150390968	150390971	150390970	150390973	150390972	150390975	150390974	150390977	150390976	150390979	150390978	150390981	150390980	150390983	150390982	150390985	150390984
29	150390987	150390986	150390989	150390988	150390991	150390990	150390993	150390992	150390995	150390994	150390997	150390996	150390999	150390998	150391001	150391000	150391003	150391002	150391005	150391004	150391007	150391006
31	150391009	150391008	150391011	150391010	150391013	150391012	150391015	150391014	150391017	150391016	150391019	150391018	150391021	150391020	150391023	150391022	150391025	150391024	150391027	150391026	150391029	150391028
33	150391031	150391030	150391033	150391032	150391035	150391034	150391037	150391036	150391039	150391038	150391041	150391040	150391043	150391042	150391045	150391044	150391047	150391046	150391049	150391048	150391051	150391050
35	150391053	150391052	150391055	150391054	150391057	150391056	150391059	150391058	150391061	150391060	150391063	150391062	150391065	150391064	150391067	150391066	150391069	150391068	150391071	150391070	150391073	150391072
37	150391075	150391074	150391077	150391076	150391079	150391078	150391081	150391080	150391083	150391082	150391085	150391084	150391087	150391086	150391089	150391088	150391091	150391090	150391093	150391092	150391095	150391094
39	150391097	150391096	150391099	150391098	150391101	150391100	150391103	150391102	150391105	150391104	150391107	150391106	150391109	150391108	150391111	150391110	150391113	150391112	150391115	150391114	150391117	150391116

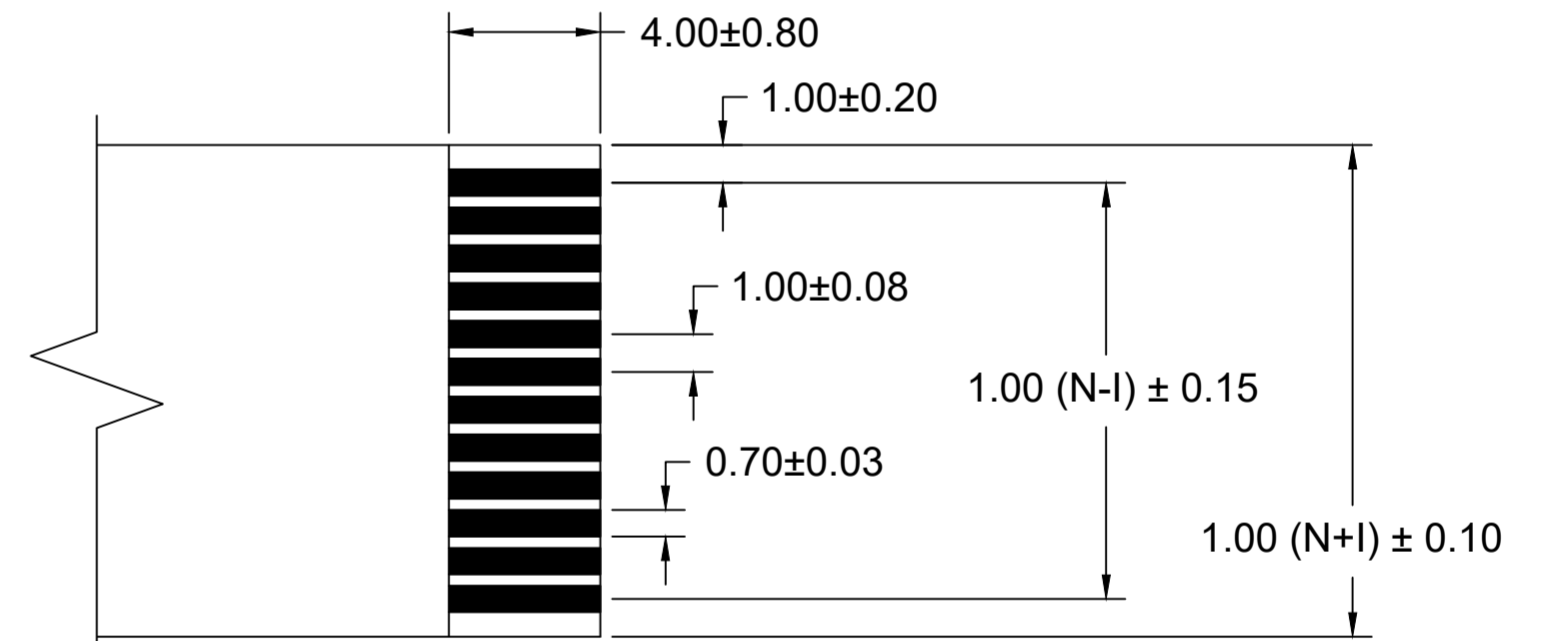

END TAIL DETAIL
SCALE 5:1

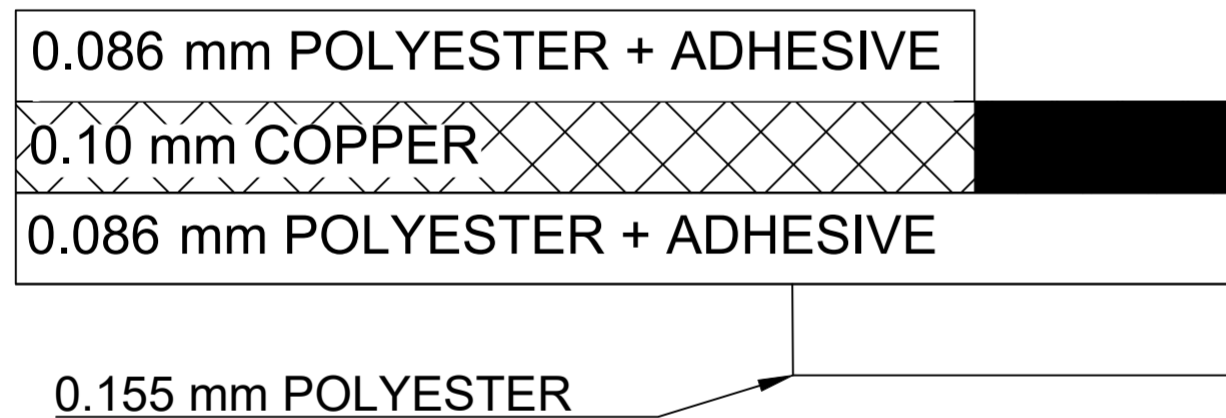

CROSS-SECTION

NOTES:

- NO PRINTING ON JUMPER CABLE UNLESS OTHERWISE SPECIFIED. IF PRINTING IS REQUIRED, THEN IT WOULD BE CONSIDERED A SPECIAL JUMPER CABLE.

THIS DRAWING CONTAINS INFORMATION THAT IS PROPRIETARY TO MOLEX ELECTRONIC TECHNOLOGIES, LLC AND SHOULD NOT BE USED WITHOUT WRITTEN PERMISSION									
DIMENSION UNITS		SCALE		CURRENT REV DESC: DRAWING CORRECTION					
MM		NA		<p style="text-align: center;">molex</p> <p style="text-align: center;">1.00MM CENTER FLAT FLEX CABLE (FFC) (105°C, AU PLATED) SALES DRAWING</p> <p style="text-align: center;">PRODUCT CUSTOMER DRAWING</p>					
GENERAL TOLERANCES (UNLESS SPECIFIED)									
	mm	INCH							
4 PLACES	±----	±----							
3 PLACES	±----	±----							
2 PLACES	±----	±----							
1 PLACE	±----	±----							
0 PLACES	±----	±----							
ANGULAR TOL ± 0.5 °				EC NO: 728054		DRWN: DIEGOG7		2022/11/10	
DRAFT WHERE APPLICABLE MUST REMAIN WITHIN DIMENSIONS				THIRD ANGLE PROJECTION		CHK'D: JSMITH11		2022/11/14	
				DRAWING		APPR: JSMITH11		2022/11/14	
				SERIES		INITIAL REVISION:		DOCUMENT NUMBER	
				C-SIZE		DRWN: DIEGOG7		150390001	
				15039		APPR: JSMITH11		DOC TYPE DOC PART REVISION	
						2022/06/01		PSD 000 B	
						2022/11/03		MATERIAL NUMBER CUSTOMER SHEET NUMBER	
						SEE CHART		GENERAL MARKET 2 OF 2	

1.00MM CENTER FFC JUMPER CABLE (HIGH TEMPERATURE) CHART

"A" DIM.	1.18 ± .079 INCHES 30 ± 2.00		2 ± .079 INCHES 51 ± 2.00 MM		3 ± .118 INCHES 76 ± 3.00 MM		4 ± .118 INCHES 102 ± 3.00 MM		5 ± .157 INCHES 127 ± 4.00 MM		6 ± .157 INCHES 152 ± 4.00 MM		7 ± .157 INCHES 178 ± 4.00 MM		8 ± .157 INCHES 203 ± 4.00 MM		9 ± .197 INCHES 229 ± 5.00 MM		10 ± .197 INCHES 254 ± 5.00 MM		12 ± .197 INCHES 305 ± 5.00 MM	
	STIFFENER	TYPE "A"	TYPE "D"	TYPE "A"	TYPE "D"	TYPE "A"	TYPE "D"	TYPE "A"	TYPE "D"	TYPE "A"	TYPE "D"	TYPE "A"	TYPE "D"	TYPE "A"	TYPE "D"	TYPE "A"	TYPE "D"	TYPE "A"	TYPE "D"	TYPE "A"	TYPE "D"	TYPE "A"
CKTS: 4	150390701	150390700	150390703	150390702	150390705	150390704	150390707	150390706	150390709	150390708	150390711	150390710	150390713	150390712	150390715	150390714	150390717	150390716	150390719	150390718	150390721	150390720
CKTS: 6	150390201	150390202	150390203	150390204	150390205	150390206	150390207	150390208	150390209	150390210	150390211	150390212	150390213	150390214	150390215	150390216	150390217	150390218	150390219	150390220	150390221	150390222
CKTS: 8	150390223	150390224	150390225	150390226	150390227	150390228	150390229	150390230	150390231	150390232	150390233	150390234	150390235	150390236	150390237	150390238	150390239	150390240	150390241	150390242	150390243	150390244
CKTS: 10	150390245	150390246	150390247	150390248	150390249	150390250	150390251	150390252	150390253	150390254	150390255	150390256	150390257	150390258	150390259	150390260	150390261	150390262	150390263	150390264	150390265	150390266
CKTS: 12	150390267	150390268	150390269	150390270	150390271	150390272	150390273	150390274	150390275	150390276	150390277	150390278	150390279	150390280	150390281	150390282	150390283	150390284	150390285	150390286	150390287	150390288
CKTS: 14	150390289	150390290	150390291	150390292	150390293	150390294	150390295	150390296	150390297	928670298	150390299	150390300	150390301	150390302	150390303	150390304	150390305	150390306	150390307	150390308	150390309	150390310
CKTS: 16	150390311	150390312	150390313	150390314	150390315	150390316	150390317	150390318	150390319	150390320	150390321	150390322	150390323	150390324	150390325	150390326	150390327	150390328	150390329	150390330	150390331	150390332
CKTS: 18	150390333	150390334	150390335	150390336	150390337	150390338	150390339	150390340	150390341	150390342	150390343	150390344	150390345	150390346	150390347	150390348	150390349	150390350	150390351	150390352	150390353	150390354
CKTS: 20	150390355	150390356	150390357	150390358	150390359	150390360	150390361	150390362	150390363	150390364	150390365	150390366	150390367	150390368	150390369	150390370	150390371	150390372	150390373	150390374	150390375	150390376
CKTS: 22	150390377	150390378	150390379	150390380	150390381	150390382	150390383	150390384	150390385	150390386	150390387	150390388	150390389	150390390	150390391	150390392	150390393	150390394	150390395	150390396	150390397	150390398
CKTS: 24	150390399	150390400	150390401	150390402	150390403	150390404	150390405	150390406	150390407	150390408	150390409	150390410	150390411	150390412	150390413	150390414	150390415	150390416	150390417	150390418	150390419	150390420
CKTS: 26	150390421	150390422	150390423	150390424	150390425	150390426	150390427	150390428	150390429	150390430	150390431	150390432	150390433	150390434	150390435	150390436	150390437	150390438	150390439	150390440	150390441	150390442
CKTS: 28	150390443	150390444	150390445	150390446	150390447	150390448	150390449	150390450	150390451	150390452	150390453	150390454	150390455	150390456	150390457	150390458	150390459	150390460	150390461	150390462	150390463	150390464
CKTS: 30	150390465	150390466	150390467	150390468	150390469	150390470	150390471	150390472	150390473	150390474	150390475	150390476	150390477	150390478	150390479	150390480	150390481	150390482	150390483	150390484	150390485	150390486
CKTS: 32	150390487	150390488	150390489	150390490	150390491	150390492	150390493	150390494	150390495	150390496	150390497	150390498	150390499	150390500	150390501	150390502	150390503	150390504	150390505	150390506	150390507	150390508
CKTS: 34	150390509	150390510	150390511	150390512	150390513	150390514	150390515	150390516	150390517	150390518	150390519	150390520	150390521	150390522	150390523	150390524	150390525	150390526	150390527	150390528	150390529	150390530
CKTS: 36	150390531	150390532	150390533	150390534	150390535	150390536	150390537	150390538	150390539	150390540	150390541	150390542	150390543	150390544	150390545	150390546	150390547	150390548	150390549	150390550	150390551	150390552
CKTS: 38	150390553	150390554	150390555	150390556	150390557	150390558	150390559	150390560	150390561	150390562	150390563	150390564	150390565	150390566	150390567	150390568	150390569	150390570	150390571	150390572	150390573	150390574
CKTS: 40	150390575	150390576	150390577	150390578	150390579	150390580	150390581	150390582	150390583	150390584	150390585	150390586	150390587	150390588	150390589	150390590	150390591	150390592	150390593	150390594	150390595	150390596

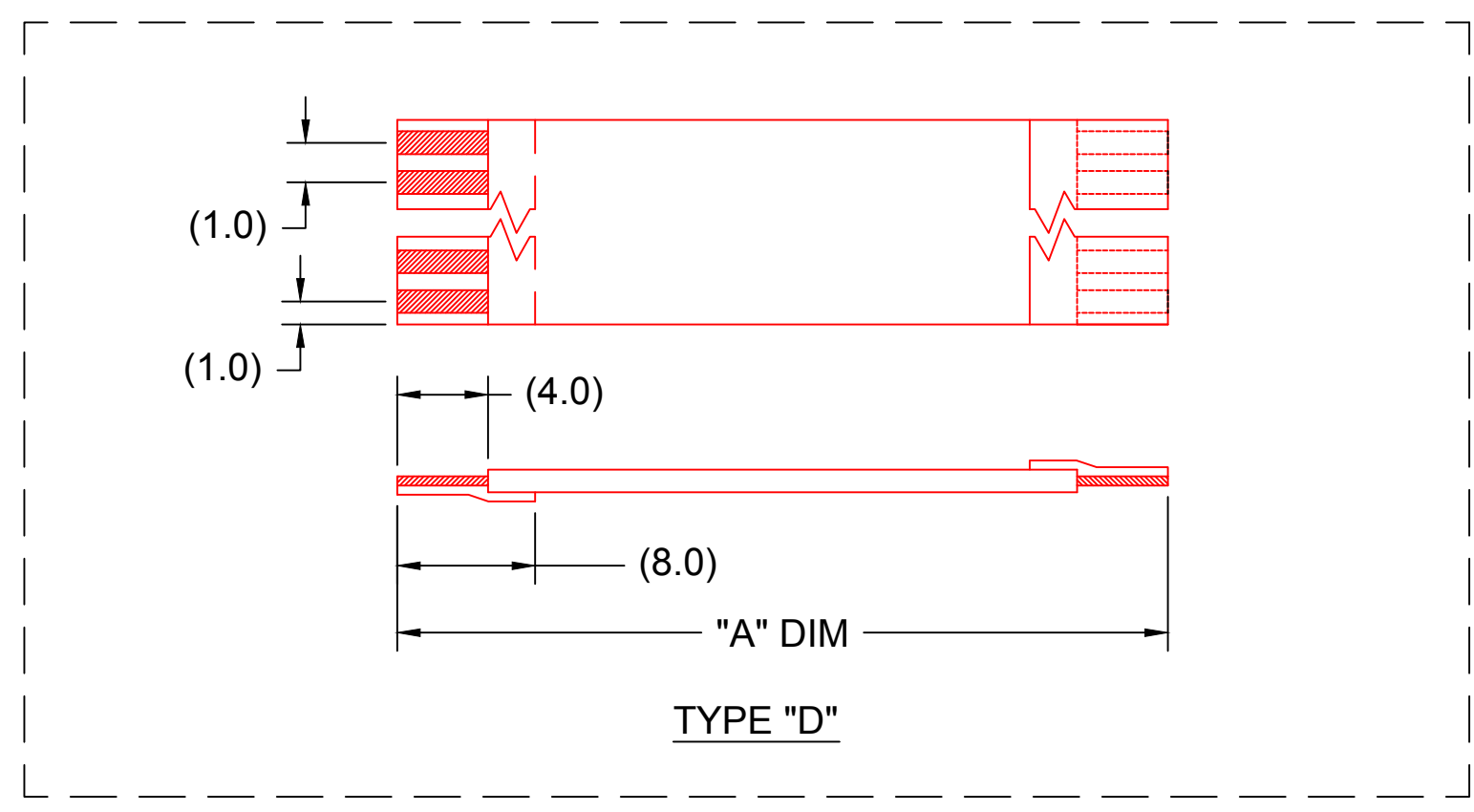
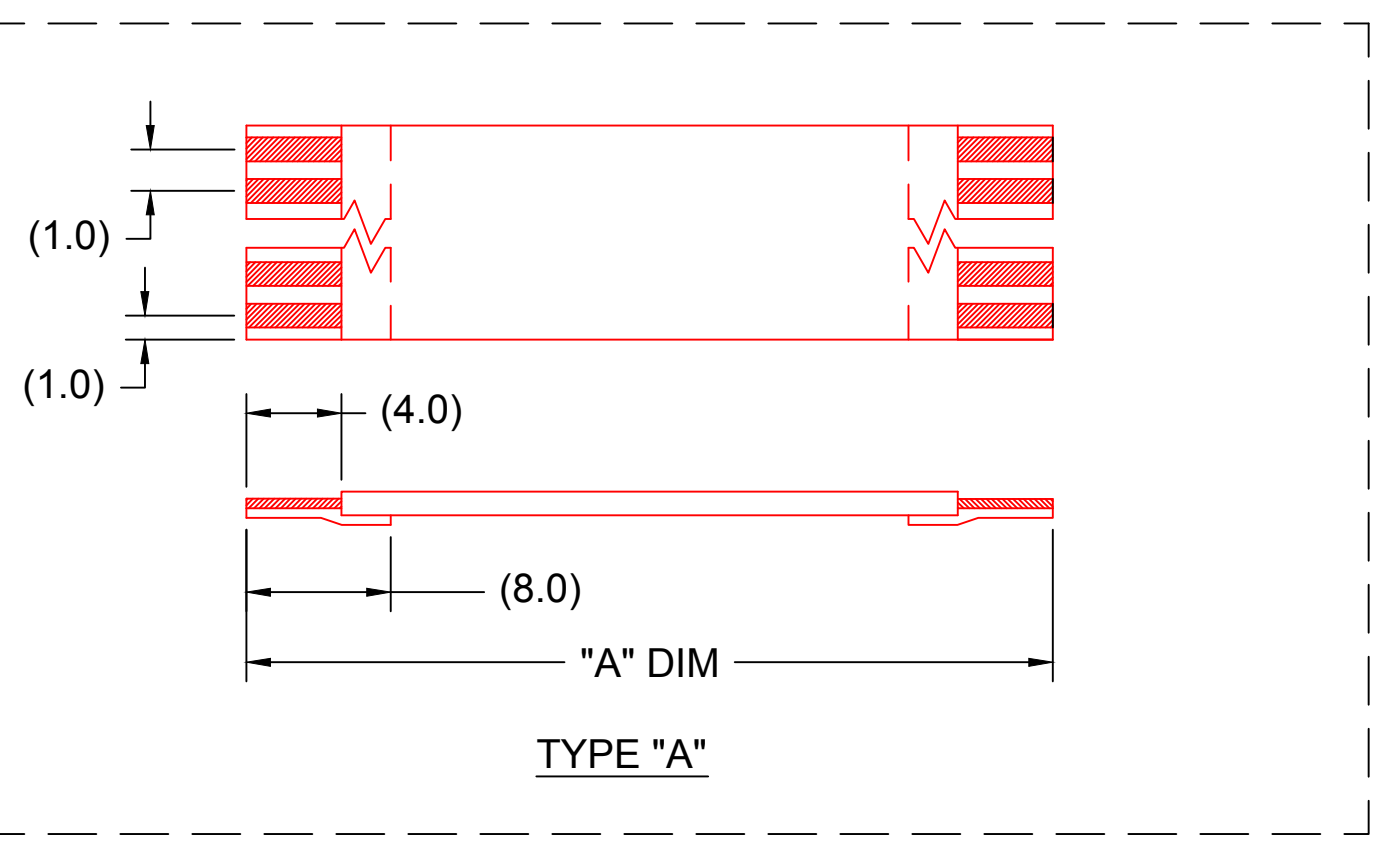

NOTES:
 1. NO PRINTING ON JUMPER CABLE UNLESS OTHERWISE SPECIFIED. IF PRINTING IS REQUIRED, THEN IT WOULD BE CONSIDERED A SPECIAL JUMPER CABLE.

RELEASED EC NO: USW2011-0065 DRWN: JLW 2010/09/30 REV	QUALITY SYMBOL ▽=0 ▽C=0	GENERAL TOLERANCES (UNLESS SPECIFIED)	DIMENSION STYLE MM	SCALE ---	DESIGN UNITS METRIC	THIRD ANGLE PROJECTION	
		4 PLACES ±--- ±--- 3 PLACES ±--- ±--- 2 PLACES ±--- ±--- 1 PLACE ±--- ±---	DRAWN BY DATE ---	TITLE 1.00MM CENTER FFC JUMPER CABLE AU PLATING			
		ANGULAR ±1/2°	CHECKED BY DATE ---	APPROVED BY DATE SFULTON 2011/03/23			
		DRAFT WHERE APPLICABLE MUST REMAIN WITHIN DIMENSIONS	MATERIAL NO. SEE CHART	DOCUMENT NO. SD-15039-001		SHEET NO. 1 OF 2	
	1		SIZE C	THIS DRAWING CONTAINS INFORMATION THAT IS PROPRIETARY TO MOLEX INCORPORATED AND SHOULD NOT BE USED WITHOUT WRITTEN PERMISSION			

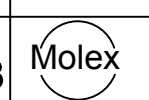

1.00MM CENTER FFC JUMPER CABLE (HIGH TEMPERATURE) CHART

"A" DIM.	1.18 ± .079 INCHES 30 ± 2.00		2 ± .079 INCHES 51 ± 2.00 MM		3 ± .118 INCHES 76 ± 3.00 MM		4 ± .118 INCHES 102 ± 3.00 MM		5 ± .157 INCHES 127 ± 4.00 MM		6 ± .157 INCHES 152 ± 4.00 MM		7 ± .157 INCHES 178 ± 4.00 MM		8 ± .157 INCHES 203 ± 4.00 MM		9 ± .197 INCHES 229 ± 5.00 MM		10 ± .197 INCHES 254 ± 5.00 MM		12 ± .197 INCHES 305 ± 5.00 MM	
	STIFFENER	TYPE "A"	TYPE "D"	TYPE "A"	TYPE "D"	TYPE "A"	TYPE "D"	TYPE "A"	TYPE "D"	TYPE "A"	TYPE "D"	TYPE "A"	TYPE "D"	TYPE "A"	TYPE "D"	TYPE "A"	TYPE "D"	TYPE "A"	TYPE "D"	TYPE "A"	TYPE "D"	TYPE "A"
CKTS: 5	150390723	150390722	150390725	150390724	150390727	150390726	150390729	150390728	150390731	150390730	150390733	150390732	150390735	150390734	150390737	150390736	150390739	150390738	150390741	150390740	150390743	150390742
CKTS: 7	150390745	150390744	150390747	150390746	150390749	150390748	150390751	150390750	150390753	150390752	150390755	150390754	150390757	150390756	150390759	150390758	150390761	150390760	150390763	150390762	150390765	150390764
CKTS: 9	150390767	150390766	150390769	150390768	150390771	150390770	150390773	150390772	150390775	150390774	150390777	150390776	150390779	150390778	150390781	150390780	150390783	150390782	150390785	150390784	150390787	150390786
CKTS: 11	150390789	150390788	150390791	150390790	150390793	150390792	150390795	150390794	150390797	150390796	150390799	150390798	150390801	150390800	150390803	150390802	150390805	150390804	150390807	150390806	150390809	150390808
CKTS: 13	150390811	150390810	150390813	150390812	150390815	150390814	150390817	150390816	150390819	150390818	150390821	150390820	150390823	150390822	150390825	150390824	150390827	150390826	150390829	150390828	150390831	150390830
CKTS: 15	150390833	150390832	150390835	150390834	150390837	150390836	150390839	150390838	150390841	150390840	150390843	150390842	150390845	150390844	150390847	150390846	150390849	150390848	150390851	150390850	150390853	150390852
CKTS: 17	150390855	150390854	150390857	150390856	150390859	150390858	150390861	150390860	150390863	150390862	150390865	150390864	150390867	150390866	150390869	150390868	150390871	150390870	150390873	150390872	150390875	150390874
CKTS: 19	150390877	150390876	150390879	150390878	150390881	150390880	150390883	150390882	150390885	150390884	150390887	150390886	150390889	150390888	150390891	150390890	150390893	150390892	150390895	150390894	150390897	150390896
CKTS: 21	150390899	150390898	150390901	150390900	150390903	150390902	150390905	150390904	150390907	150390906	150390909	150390908	150390911	150390910	150390913	150390912	150390915	150390914	150390917	150390916	150390919	150390918
CKTS: 23	150390921	150390920	150390923	150390922	150390925	150390924	150390927	150390926	150390929	150390928	150390931	150390930	150390933	150390932	150390935	150390934	150390937	150390936	150390939	150390938	150390941	150390940
CKTS: 25	150390943	150390942	150390945	150390944	150390947	150390946	150390949	150390948	150390951	150390950	150390953	150390952	150390955	150390954	150390957	150390956	150390959	150390958	150390961	150390960	150390963	150390962
CKTS: 27	150390965	150390964	150390967	150390966	150390969	150390968	150390971	150390970	150390973	150390972	150390975	150390974	150390977	150390976	150390979	150390978	150390981	150390980	150390983	150390982	150390985	150390984
CKTS: 29	150390987	150390986	150390989	150390988	150390991	150390990	150390993	150390992	150390995	150390994	150390997	150390996	150390999	150390998	150391001	150391000	150391003	150391002	150391005	150391004	150391007	150391006
CKTS: 31	150391009	150391008	150391011	150391010	150391013	150391012	150391015	150391014	150391017	150391016	150391019	150391018	150391021	150391020	150391023	150391022	150391025	150391024	150391027	150391026	150391029	150391028
CKTS: 33	150391031	150391030	150391033	150391032	150391035	150391034	150391037	150391036	150391039	150391038	150391041	150391040	150391043	150391042	150391045	150391044	150391047	150391046	150391049	150391048	150391051	150391050
CKTS: 35	150391053	150391052	150391055	150391054	150391057	150391056	150391059	150391058	150391061	150391060	150391063	150391062	150391065	150391064	150391067	150391066	150391069	150391068	150391071	150391070	150391073	150391072
CKTS: 37	150391075	150391074	150391077	150391076	150391079	150391078	150391081	150391080	150391083	150391082	150391085	150391084	150391087	150391086	150391089	150391088	150391091	150391090	150391093	150391092	150391095	150391094
CKTS: 39	150391097	150391096	150391099	150391098	150391101	150391100	150391103	150391102	150391105	150391104	150391107	150391106	150391109	150391108	150391111	150391110	150391113	150391112	150391115	150391114	150391117	150391116

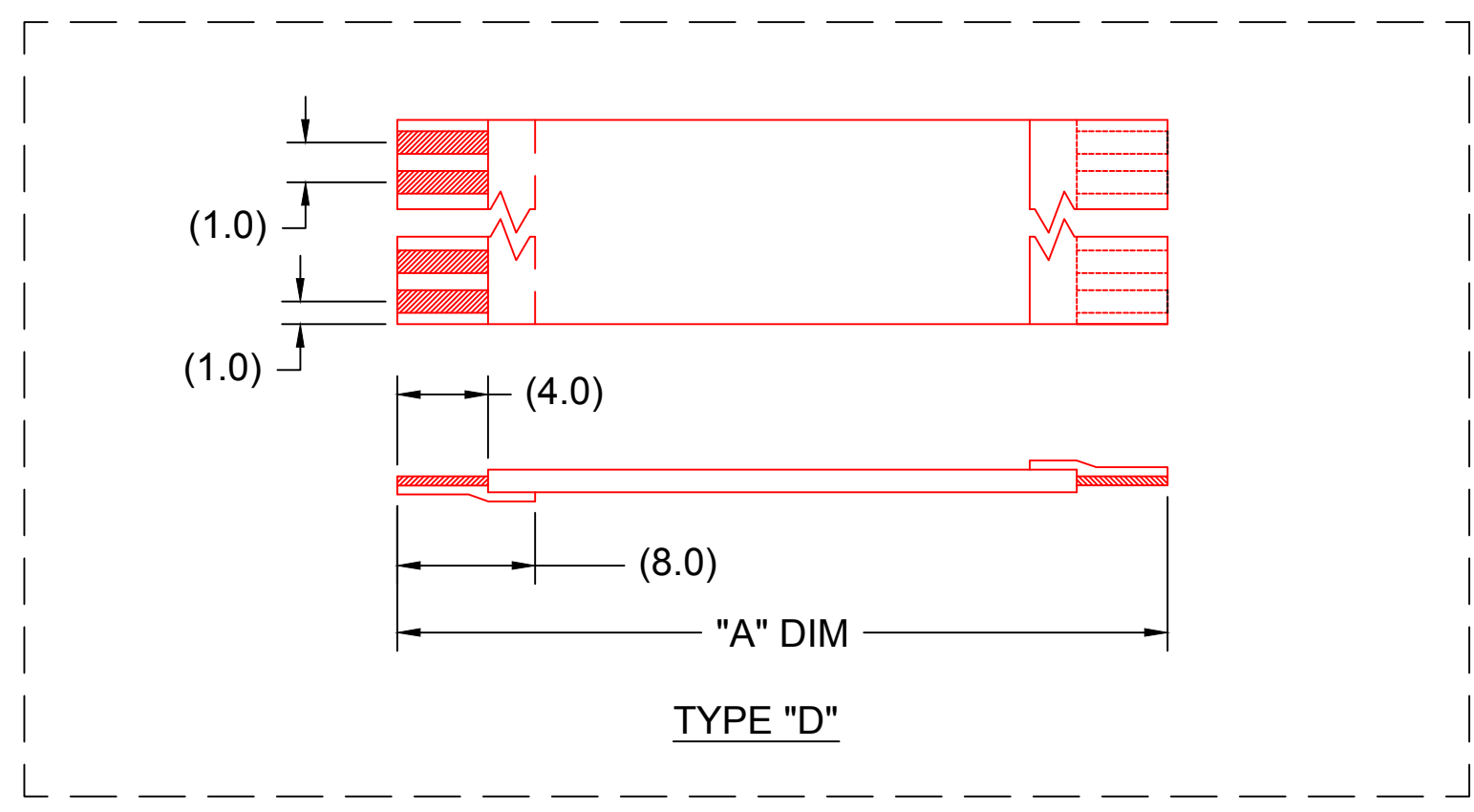
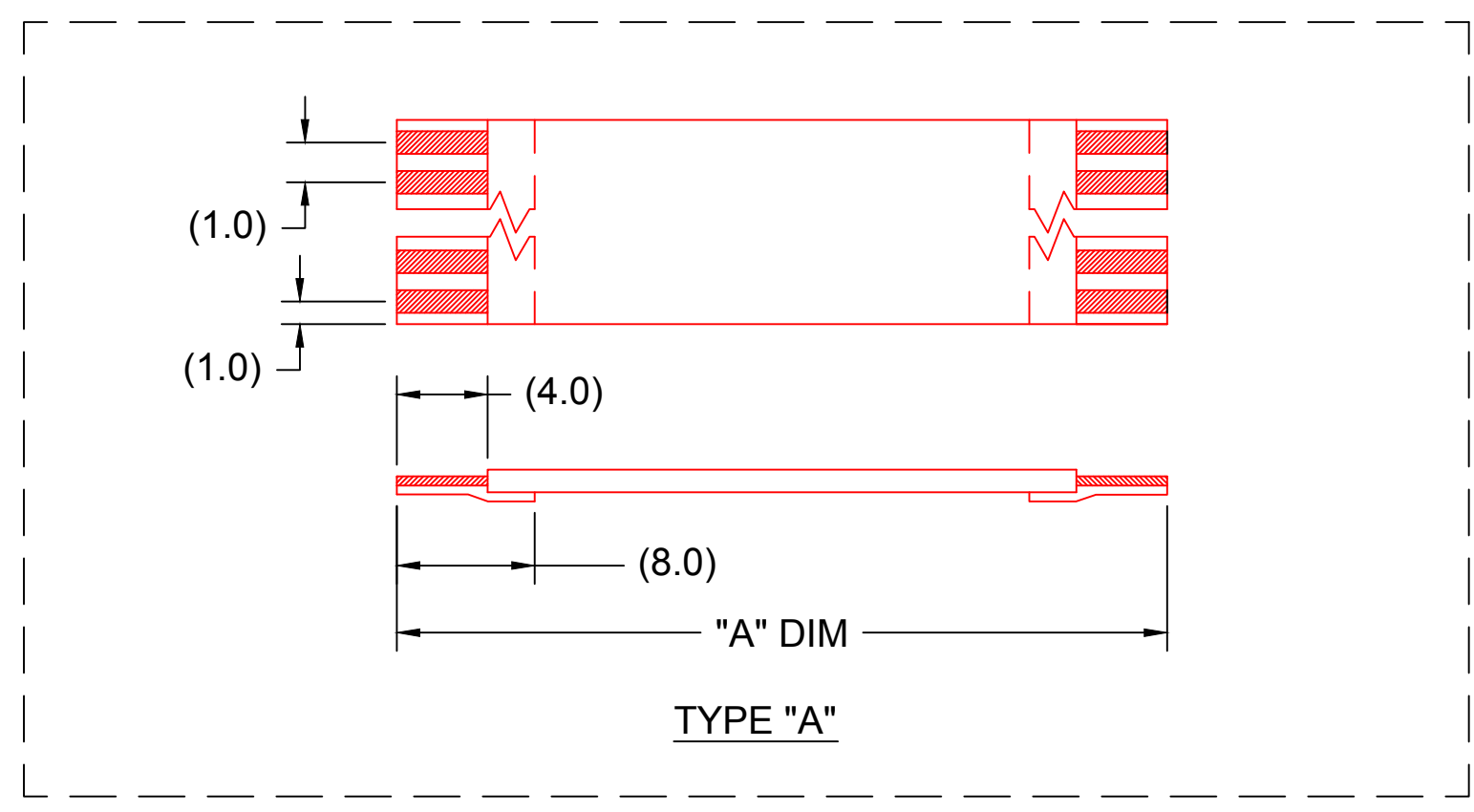

NOTES:
 1. NO PRINTING ON JUMPER CABLE UNLESS OTHERWISE SPECIFIED. IF PRINTING IS REQUIRED, THEN IT WOULD BE CONSIDERED A SPECIAL JUMPER CABLE.

SEE SHEET 1	EC NO: DRWN: REV	DESCRIPTION	QUALITY SYMBOL	GENERAL TOLERANCES (UNLESS SPECIFIED)	DIMENSION STYLE	SCALE	DESIGN UNITS	THIRD ANGLE PROJECTION
			▽=0	mm INCH	MM	---	METRIC	1.00MM CENTER FFC JUMPER CABLE AU PLATING
			▽C=0	4 PLACES ±--- ±---	DRAWN BY DATE	TITLE		
				3 PLACES ±--- ±---	CHECKED BY DATE			
				2 PLACES ±--- ±---	APPROVED BY DATE			
	1 PLACE ±--- ±---	ANGULAR ±1/2°	SFULTON 2011/03/23	MATERIAL NO.	SEE CHART	DOCUMENT NO.	SD-15039-001	SHEET NO. 2 OF 2
		DRAFT WHERE APPLICABLE MUST REMAIN WITHIN DIMENSIONS		SIZE	C	THIS DRAWING CONTAINS INFORMATION THAT IS PROPRIETARY TO MOLEX INCORPORATED AND SHOULD NOT BE USED WITHOUT WRITTEN PERMISSION		



MOLEX INCORPORATED