

This all-in-one UMRF tool is designed to mate and unmate UMRF plug with the receptacle to assure that UMRF plug would not be damaged with inappropriate usage !

• How to mate the UMRF plug with the receptacle ?

1. Insert the tool to the flanges at UMRF plug



2. Align the plug to mating axes of the receptacle, and insert vertically until "click" heard to complete mated connection (Note 1)



• How to unmate the UMRF plug from the receptacle ?

3. Insert the tool to the flanges at UMRF plug



4. Pull the plug off vertically (Note 2)

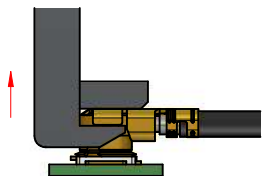

Order Code : 600636001

Material : Stainless steel

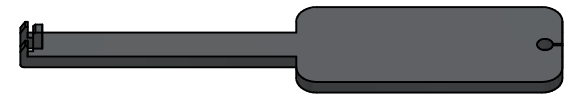

Special Notes :

Note 1 : Do not apply extreme angle when you insert the UMRF Plug to the receptacle

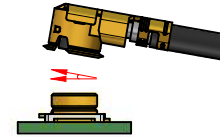

Note 2 : Never pull UMRF directly by hands since it might be damaged

Note 3 : While UMRF plug is being mated with the receptacle, please do not apply pull force higher than defined values indicated in below diagram

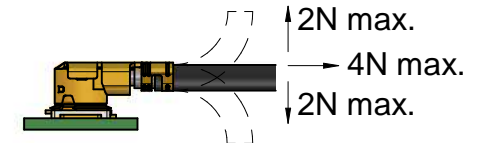

Applicable Products :

WR-UMRF 6362 series

Würth Elektronik eiSos GmbH & Co. KG  
EMC & Inductive Solutions

Max-Eyth-Str. 1  
74638 Waldenburg  
Germany  
com. +49 79 42 945 - 0

www.we-online.de  
eiSos@we-online.de



CREATED  
BMa

CHECKED  
OTs

DESCRIPTION

**UMRF Insertion & Extraction Tool Manual Instruction**

**600 636 001**

REVISION  
002.001

STATUS

DATE  
2020-10-06

BUSINESS UNIT  
eiCan