

CABLE GLANDS

Versatile Enclosure and Panel Accessories

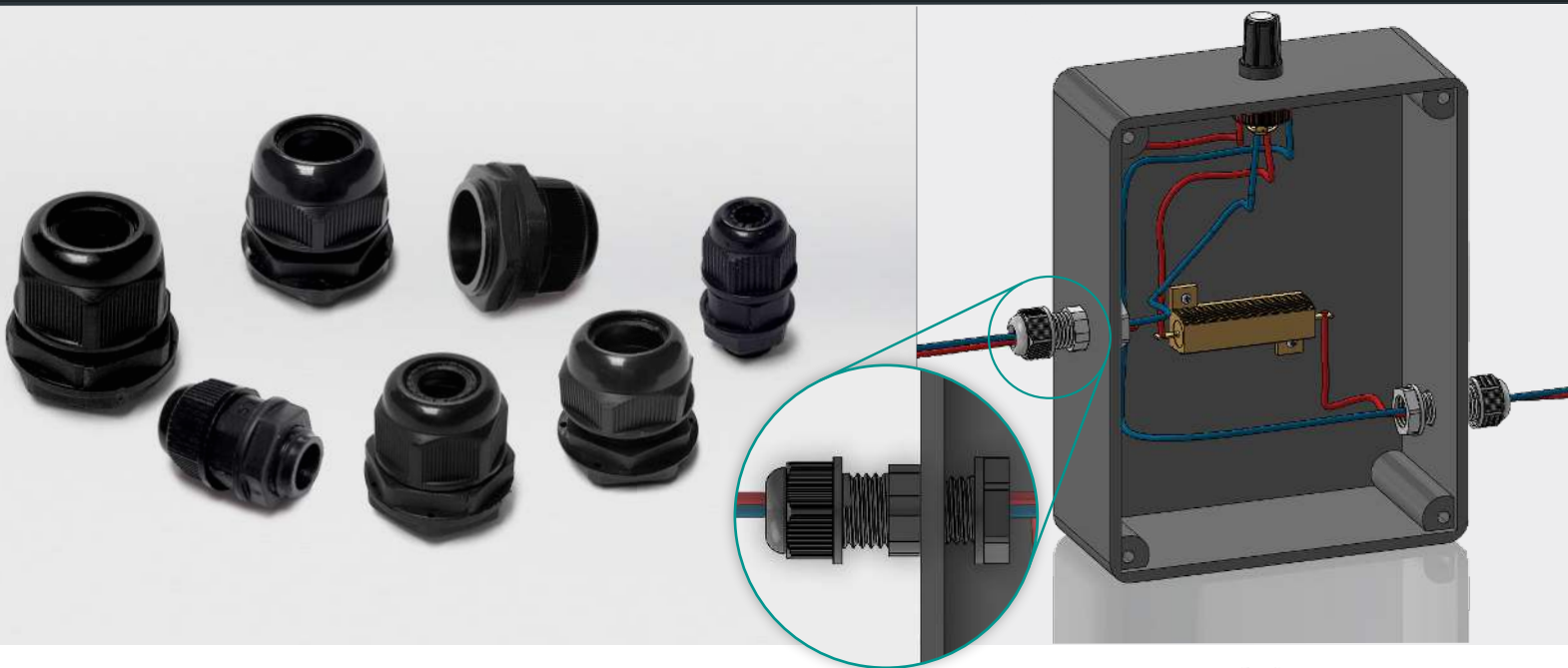

FEATURES

- ▶ Nylon body provides excellent impact resistance and durability in harsh conditions
- ▶ Prevents cabling, wiring or tubing from abrasion
- ▶ Protects enclosures against elements like water, dust and debris
- ▶ Supplied preassembled with locking nut, O-ring, body, seal and sealing nut
- ▶ Cable Gland Material: Nylon UL94 V-2
- ▶ Sealing Elements Material: TPE Rubber
- ▶ Seal Rating: IP67
- ▶ Operating temperature: -30 C to 120 C Dynamic
- ▶ RoHS and REACH compliant
- ▶ Multiple sizes available with metric threads
- ▶ Overview video available: [Click here](#)
- ▶ View full product offerings at www.daviesmolding.com

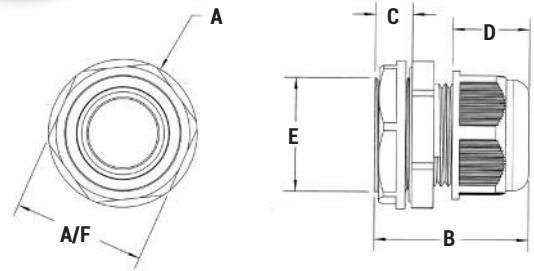

Part No	Thread Type	Cable Range	A/F	Dia. A	Min B	Max B	C	D	Dia. E	Panel Thickness	Panel Hole Dia.
GC1000-A	M12X1.5	2.5-6.5	15	16	27.5	30.5	8.5	12.5	12	.56-1.99	12.5
GC1000-B	M16X1.5	3.5-8.0	18	20	31	35.5	8.5	16.5	16	.56-1.99	16.5
GC1000-C	M20X1.5	7.0-12.0	24	26	27.5	32.5	9	17.5	20	.56-1.99	20.5
GC1000-D	M25X1.5	9.0-14.0	27	31	35	40	10	19	25	.56-1.99	25.5
GC1000-E	M32X1.5	13.0-18.0	37	40.5	38	44	10	21.5	32	.56-1.99	33
GC1000-F	M40X1.5	14.0-25.0	45	50	47.5	53.5	10	26.5	40	.56-1.99	41
GC1000-G	M50X1.5	22.0-32.0	54	60.5	55.5	64	12.5	30.5	50	.56-3.18	51
GCL1000-H	M20X1.5	7.0-12.0	24	26	36.5	41.5	13	17.5	20	.56-3.18	20.5
GCL1000-J	M25X1.5	9.0-14.0	27	31	40	44.5	15	19	25	.56-3.18	25.5

*All measurements are in mm