

THIS IS A CONTROLLED DOCUMENT.

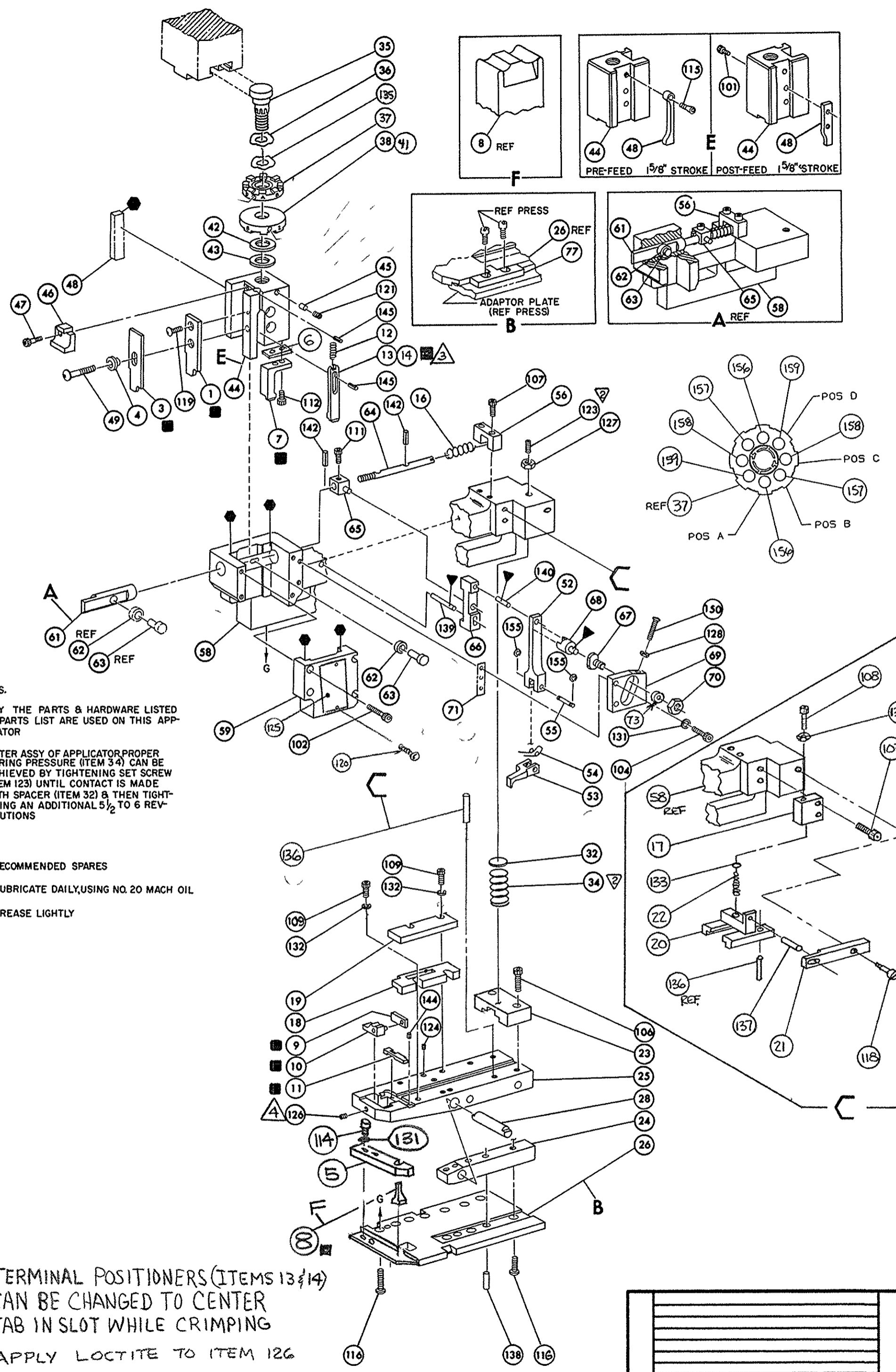

NOTES.
 1. ONLY THE PARTS & HARDWARE LISTED ON PARTS LIST ARE USED ON THIS APPLICATOR
 2. AFTER ASSY OF APPLICATOR PROPER SPRING PRESSURE (ITEM 34) CAN BE ACHIEVED BY TIGHTENING SET SCREW (ITEM 123) UNTIL CONTACT IS MADE WITH SPACER (ITEM 32) & THEN TIGHTENING AN ADDITIONAL 1/2 TO 6 REVOLUTIONS

KEY
 ■ - RECOMMENDED SPARES
 ▼ - LUBRICATE DAILY, USING NO. 20 MACH OIL
 ● - GREASE LIGHTLY

△ TERMINAL POSITIONERS (ITEMS 13 & 14) CAN BE CHANGED TO CENTER TAB IN SLOT WHILE CRIMPING
 ▽ APPLY LOCTITE TO ITEM 126

REQ	PART NO.	DESCRIPTION	NO.	REQ.	PART NO.	DESCRIPTION	NO.
			162	1	690517-1	SPACER	71
			161	1	22594-8	NUT, HEX	70
			160	1	240628-1	PLATE, ADJUSTMENT	69
			159	1	240626-1	SHAFT, PIVOT	68
			158	1	240633-1	BUSHING	67
			157	1	240630-1	LEVER, INTERMEDIATE	66
			156	1	240629-1	BLOCK, PIVOT	65
			155	1	1633226-1	SCREW, ADJUSTMENT	64
			154	1	240659-3	PIN, CAM ROLLER	63
			153	1	240658-1	ROLLER, CAM	62
			152	1	240631-1	ROD, FEED	61
			151				60
			150	1	455164-1	CAP, HOUSING	59
			149	1	458984-1	HOUSING	58
			148				57
			147	1	458361-1	GUIDE, FEED ROD	56
			146	1	240624-1	PIN, FEED FINGER	55
			145	1	691499-1	SPRING, FEED FINGER	54
			144	1	690584-5	FINGER, FEED	53
			143	1	240634-1	LEVER, TERMINAL	52
			142				51
			141				50
			140	1	3-21002-5	BOLT, CRIMPER	49
			139	1	238015-1	CAM POST FEED 15/8 STROKE	48
			138				47
			137				46
			136	1	690191-1	PLUG, NYLON	45
			135	1	691533-1	RAM	44
			134	1	690125-1	WASHER, LAMINATED	43
			133	1	690124-4	WASHER, RAM	42
			132	1	690223-1	DISC, SPACER	41
			131				40
			130				39
			129				38
			128	1	354771-1	DISC, WIRE	37
			127	1	22480-5	WASHER, SPRING	36
			126	1	690212-1	POST, RAM	35
			125	1	3-23846-5	SPRING, HINGE BAR	34
			124				33
			123	1	690573-1	SPACER, SPRING	32
			122	1			31
			121	1			30
			120	1			29
			119	1	690582-1	PIN, HINGE	28
			118				27
			117	1	463873-1	PLATE, BASE	26
			116	1	691535-2	BAR, HINGE	25
			115	1	690571-1	BLOCK, STABILIZER	24
			114	1	814222-2	BLOCK, PRESSURE	23
			113	1	7-27282-5	SPRING, DRAG	22
			112	1	458968-1	LEVER, DRAG	21
			111	1	458960-2	DRAG, STOCK	20
			110	1	691530-1	GUIDE, STRIP, REAR	19
			109	1	691529-1	GUIDE, STRIP, FRONT	18
			108	1	458978-1	BLOCK, SPRING	17
			107	1	472284-9	SPRING, FEED RETURN	16
			106				15
			105	1	692134-8	POSITIONER, TERMINAL	14
			104	1	692134-5	POSITIONER, TERMINAL	13
			103	1	5-22280-5	SPRING, TERM, POSITIONER	12
			102	1	691525-1	PLATE, REAR SHEAR	11
			101	1	691524-1	INSERT, ANVIL	10
			80	1	690569-4	PLATE, FRONT SHEAR	9
			79	1	691523-1	ANVIL	8
			78	1	691532-1	BLADE, SLUG	7
			77	1	455608-1	SPACER, SHARP BLADE	6
			76	1	463874-1	PLATE, ANVIL MOUNTING	5
			75				4
			74				3
			73				2
			72	1	691531-1	CRIMPER, WIRE	1

TERM APPL SPEC 114-2078

CRIMPING DATA				THIS APPLICATOR WILL APPLY	
PAD LETTER	CRIMP HEIGHT	WIRE SIZE	WIRE STRIP LENGTH		
A	.072	12		61177-1	
B	.062	14		61177-2	
C	.056	16			
D	.052	18			
CRIMP	SIZE	TYPE	FEED	---	
WIRE	.160	T.L.			
INSULATION	---	---	620		
INSULATION RANGE	---	WIRE RANGE	18-12	APPLICATOR INSTRUCTION # 8031	
REMARKS: AMPOMATOR DONOT EXCEED 80CPM. WITH THIS APPLICATOR					
SET UP GAGE	LAYOUT NO.	AMP INCORPORATED HARRISBURG, PENNA.			
DRAWN	5-9-73	APPROVED	REL. H. W. E. 10-73		
CHECKED	5-10-73	REL.	LOC A C NO. 686961-8		
APPLICATOR, MINIATURE QUICK CHANGE HINGE BAR, E.F. (TAB LOK (RIGHT HAND))					

REV	DATE	BY	DESCRIPTION
N	05-008307		
M	05-0150-1267-04		
L	05-0150-5217-94		
K	05-0150-4155-92		
J	05-0150-304991		
I	05-0150-1162988		
H	05-0150-1162988		
G	05-0150-1162988		
F	05-0150-1162988		
E	05-0150-1162988		
D	05-0150-1162988		
C	05-0150-1162988		
B	05-0150-1162988		
A	05-0150-1162988		
R	08-020547		
P	05-012370		

686961-8