



### Electrical Characteristics (T<sub>j</sub>=25°C unless otherwise specified)

Symbol	Test Condition	Value			Unit
		MIN.	TYP.	MAX.	
I <sub>GT</sub>	V <sub>D</sub> =12V R <sub>L</sub> =30Ω	20	-	70	mA
V <sub>GT</sub>		-	-	1.5	V
V <sub>GD</sub>	V <sub>D</sub> =V <sub>DRM</sub> T <sub>j</sub> =125°C	0.25	-	-	V
I <sub>L</sub>	I <sub>G</sub> =1.2 I <sub>GT</sub>	-	-	250	mA
I <sub>H</sub>	I <sub>T</sub> =1A	-	-	200	mA
dV/dt	V <sub>D</sub> =2/3V <sub>DRM</sub> T <sub>j</sub> =125°C Gate Open	1000	-	-	V/μs

### Static Characteristics

Symbol	Condition	Max.	Units
V <sub>TM</sub>	I <sub>TM</sub> =80A t <sub>p</sub> =380μs, T <sub>j</sub> =25°C	1.8	V
I <sub>DRM</sub>	V <sub>D</sub> =V <sub>DRM</sub> V <sub>R</sub> =V <sub>RRM</sub> , T <sub>j</sub> =25°C	10	μA
I <sub>RRM</sub>	V <sub>D</sub> =V <sub>DRM</sub> V <sub>R</sub> =V <sub>RRM</sub> , T <sub>j</sub> =125°C	8	mA

### Thermal Resistances

Symbol	Condition	Value	Units
R <sub>th(j-c)</sub>	Junction to case(AC)	TO-3P Ins	0.65
		TO-247J	0.6

### Ordering Information

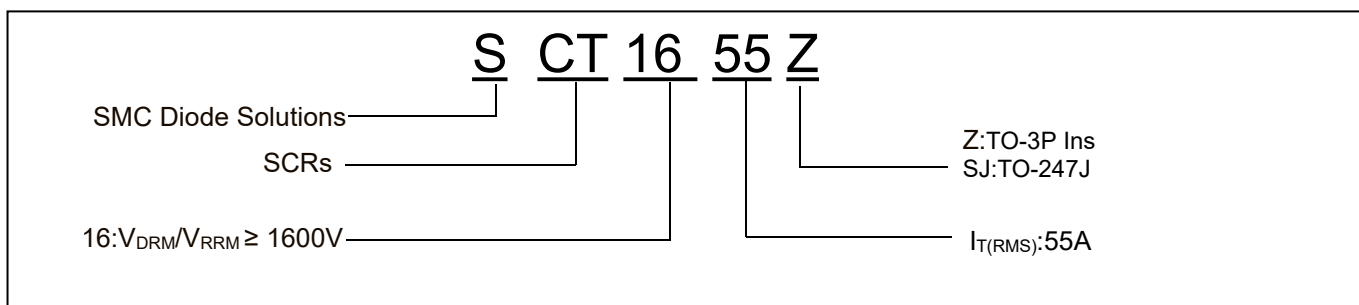

Device	Package	Shipping
SCT1655Z	TO-3P Ins	30pcs/ Tube
SCT1655SJ	TO-247J	30pcs/ Tube

## Marking Diagram

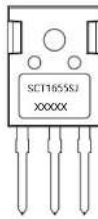
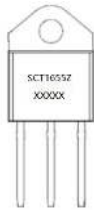

Where XXXXX is YYWWL

SCT1655Z = Part name  
SCT1655SJ = Part name  
YY = Year  
WW = Week  
L = Lot Number

## Mechanical Dimensions TO-3P(Ins)

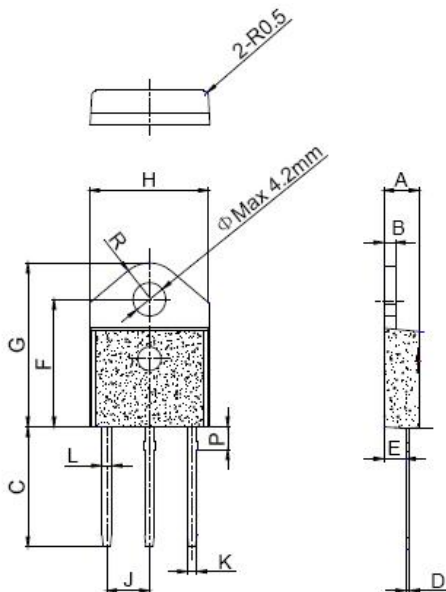

SYMBOL	Millimeters			Inches		
	Min.	Typ.	Max.	Min.	Typ.	Max.
A	4.40		4.60	0.173		0.181
B	1.45		1.55	0.057		0.061
C	14.35		15.60	0.565		0.614
D	0.50		0.70	0.020		0.028
E	2.70		2.90	0.106		0.114
F	15.80		16.50	0.622		0.650
G	20.40		21.10	0.803		0.831
H	15.10		15.50	0.594		0.610
J	5.40		5.65	0.213		0.222
K	1.10		1.40	0.043		0.055
L	1.35		1.50	0.053		0.059
P	2.80		3.00	0.110		0.118
R		4.35			0.171	

## Mechanical Dimensions TO-247J

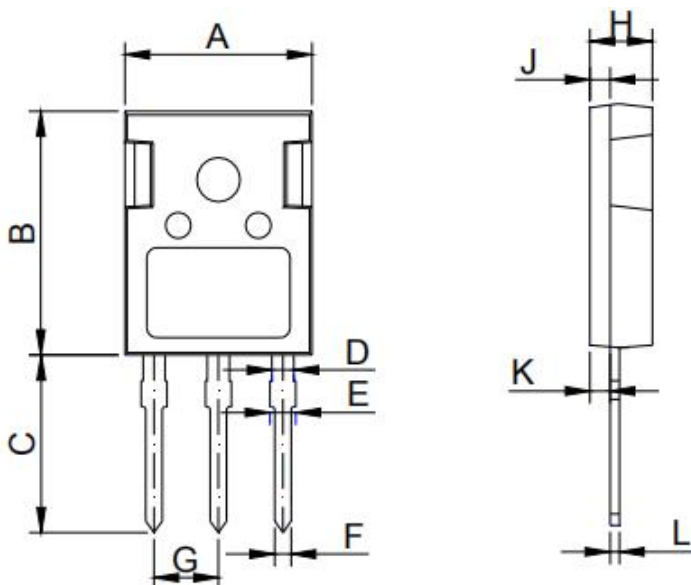

SYMBOL	Millimeters			Inches		
	Min.	Typ.	Max.	Min.	Typ.	Max.
A	15.50	15.80	16.10	0.610	0.622	0.634
B	20.80	21.00	22.20	0.819	0.828	0.874
C	19.70	20.00	20.30	0.776	0.787	0.799
D	1.80	2.00	2.20	0.071	0.079	0.087
E	1.90	2.10	2.30	0.075	0.083	0.091
F	1.00	1.20	1.40	0.039	0.047	0.055
G		5.44			0.214	
H	4.80	5.00	5.20	0.189	0.197	0.205
J	1.90	2.00	2.10	0.075	0.079	0.083
K	2.20	2.35	2.50	0.087	0.093	0.098
L	0.41	0.60	0.79	0.016	0.024	0.031

**Ratings and Characteristics Curves**

**FIG.1** Maximum power dissipation versus RMS on-state current

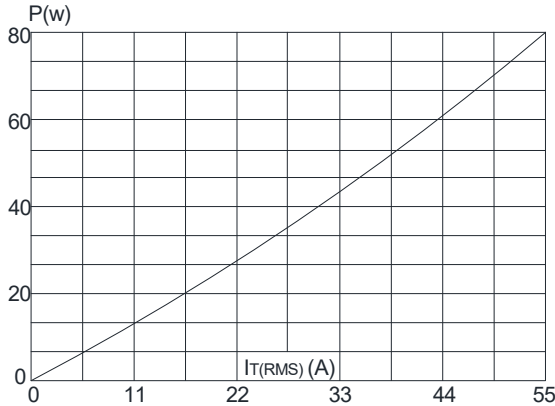

**FIG.2:** RMS on-state current versus case temperature

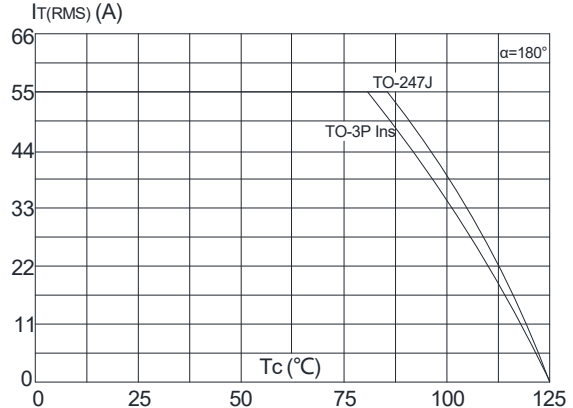

**FIG.3:** Surge peak on-state current versus number of cycles

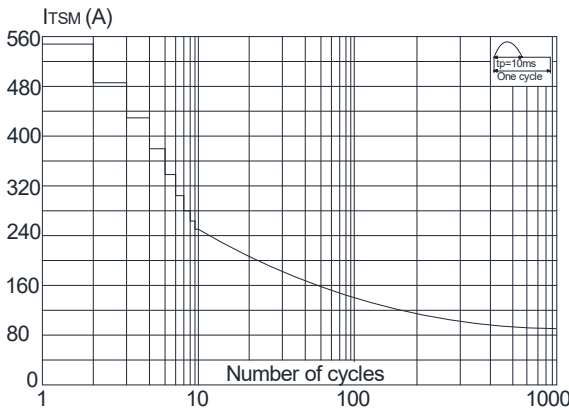

**FIG.4:** On-state characteristics (maximum values)

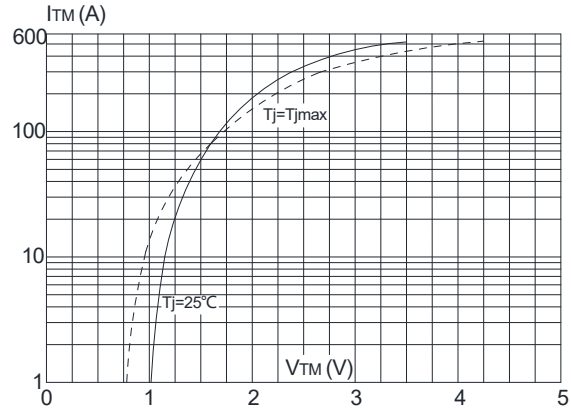

**FIG.5:** Non-repetitive surge peak on-state current for a sinusoidal pulse with width  $t_p < 10ms$ , and corresponding value of  $I^2 t$  ( $di/dt < 150A/\mu s$ )

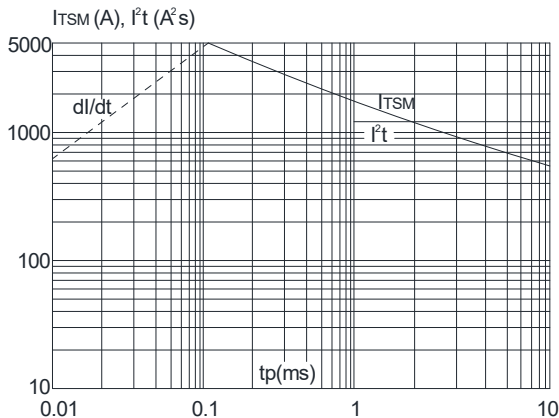

**FIG.6:** Relative variations of gate trigger current, holding current and latching current versus junction temperature

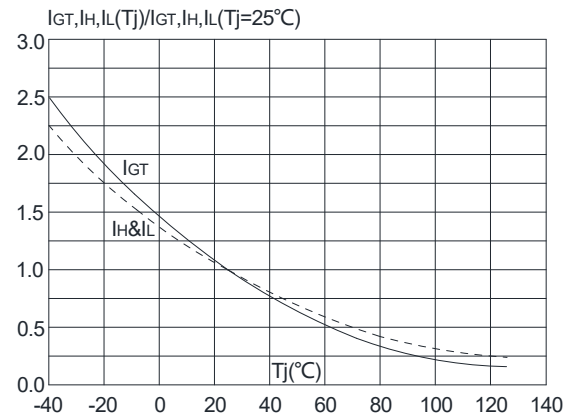



**DISCLAIMER:**

- 1- The information given herein, including the specifications and dimensions, is subject to change without prior notice to improve product characteristics. Before ordering, purchasers are advised to contact the SMC Diode Solutions sales department for the latest version of the datasheet(s).
- 2- In cases where extremely high reliability is required (such as use in nuclear power control, aerospace and aviation, traffic equipment, medical equipment, and safety equipment), safety should be ensured by using semiconductor devices that feature assured safety or by means of users' fail-safe precautions or other arrangement.
- 3- In no event shall SMC Diode Solutions be liable for any damages that may result from an accident or any other cause during operation of the user's units according to the datasheet(s). SMC Diode Solution assumes no responsibility for any intellectual property claims or any other problems that may result from applications of information, products or circuits described in the datasheets.
- 4- In no event shall SMC Diode Solutions be liable for any failure in a semiconductor device or any secondary damage resulting from use at a value exceeding the absolute maximum rating.
- 5- No license is granted by the datasheet(s) under any patents or other rights of any third party or SMC Diode Solutions.
- 6- The datasheet(s) may not be reproduced or duplicated, in any form, in whole or part, without the expressed written permission of SMC Diode Solutions.
- 7- The products (technologies) described in the datasheet(s) are not to be provided to any party whose purpose in their application will hinder maintenance of international peace and safety nor are they to be applied to that purpose by their direct purchasers or any third party. When exporting these products (technologies), the necessary procedures are to be taken in accordance with related laws and regulations..