

REVISIONS			
REV	DESCRIPTION, ECN, EAR NO.	DATE	APP'D
A	PROPOSAL	APR 08/18	L.CHAN

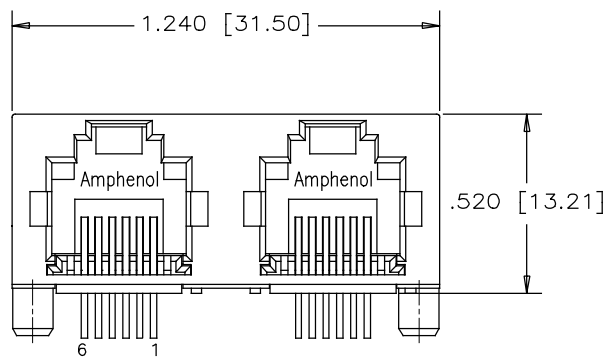

FRONT VIEW

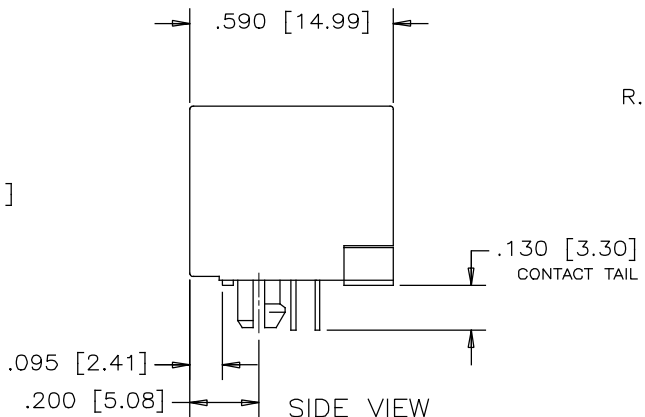

SIDE VIEW

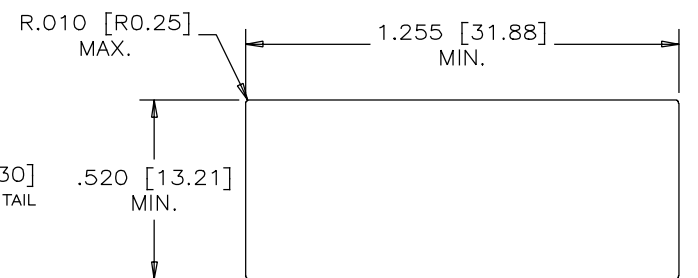

RECOMMENDED PANEL CUTOUT

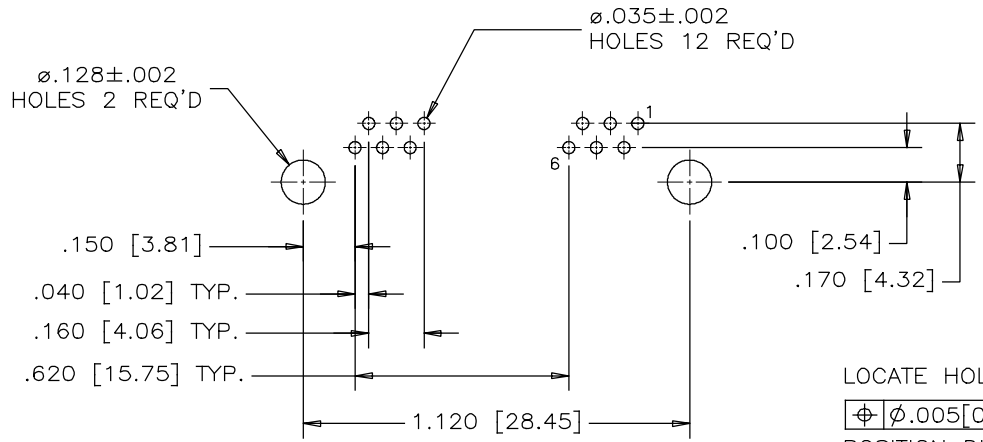

RECOMMENDED P.C.B. LAYOUT
(COMPONENT SIDE OF BOARD)

LOCATE HOLES
 $\varnothing \varnothing.005 [0.13]$
 POSITION DIMENSIONS
 ARE BASIC

MATERIALS:
 PLASTIC HOUSING: ENGINEERING THERMOPLASTIC
 FLAMMABILITY RATING UL 94V-0

CONTACTS: PHOSPHOR BRONZE
 PLATING: 50 μ" [1.27 MICRONS]
 MIN. GOLD ON MATING SURFACES.
 50 μ" [1.27 MICRONS]
 MIN. NICKEL UNDERPLATE
 100 μ" [2.54 MICRONS]
 MIN. MATTE TIN ON CONTACT TAILS.

PART NUMBER: RJHSE-7060-A2

UNLESS SPECIFIED OTHERWISE		DRAWN	W.QIU	DATE	Amphenol Canada Corp.	
PRIMARY UNITS	INCH	CHECKED	L.CHAN	APR08/18	www.amphenolcanada.com	
SECONDARY UNITS	MILLIMETER	M.E. APP'D			TITLE	
REFERENCE IN PARENTHESES		Q.A. APP'D			2 PORT, HIGH SPEED, MODULAR JACK, 6P6C, UNSHIELDED, WITHOUT LED 0.13" CONTACT TAIL - RoHS COMPLIANT	
GENERAL TOLERANCES		DWG APPR.			DWG. NO.	
1 DECIMAL PLACE	±0.025	ENG. REL. NO.			P-RJHSE-7060-A2	
2 DECIMAL PLACES	±0.020	REF.			REV	
3 DECIMAL PLACES	±0.015	THIRD ANGLE PROJECTION			A	
ANGULAR DEGREES	±1.0°	DO NOT SCALE DRAWING			CODE ID NO. 03554 DWG SIZE: C SCALE: N/A SHEET 1 OF 2	

THIS DOCUMENT CONTAINS PROPRIETARY INFORMATION AND SUCH INFORMATION MAY NOT BE DISCLOSED TO OTHERS FOR ANY PURPOSE OR USED FOR MANUFACTURING PURPOSES WITHOUT WRITTEN PERMISSION FROM AMPHENOL CANADA CORP.