

**MATERIAL**

Glass-fibre reinforced polyamide based (PA) technopolymer, RAL 5001 blue colour, matte finish.

Produced from FDA compliant raw material (FDA CFR.21 and EU 10/2011). The special technopolymer contains additives detectable by means of metal detectors.

**MOUNTING**

Threaded blind hole.

**FEATURES AND APPLICATIONS**

The RAL 5001 blue colour is easily visible in case of accidental food contamination. Furthermore the material additives are metal detectable at a cubic particle size of 5mm per side.

In order to improve the detection, the metal detector calibration must take into account the food/substance type at risk of contamination considering the moisture contained in it.

Particularly suitable for applications in the food and pharmaceutical industries.



- 1
- 2
- 3
- 4
- 5
- 6
- 7
- 8
- 9
- 10
- 11
- 12
- 13
- 14
- 15
- 16
- 17
- 18

ELESA Original design

| Conversion Table  |      |
|-------------------|------|
| 1 mm = 0.039 inch |      |
| L                 |      |
| mm                | inch |
| 80                | 3.15 |

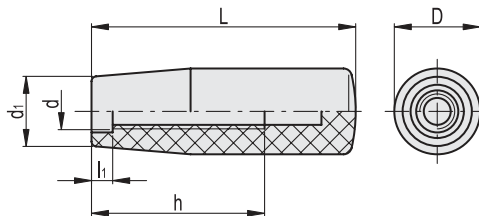

| Code   | Description     | D    | L  | d   | d1 | h  | l1 | ⚖️ |
|--------|-----------------|------|----|-----|----|----|----|----|
| 199307 | I.780/80-M10-MD | 26.5 | 80 | M10 | 21 | 55 | 7  | 45 |