

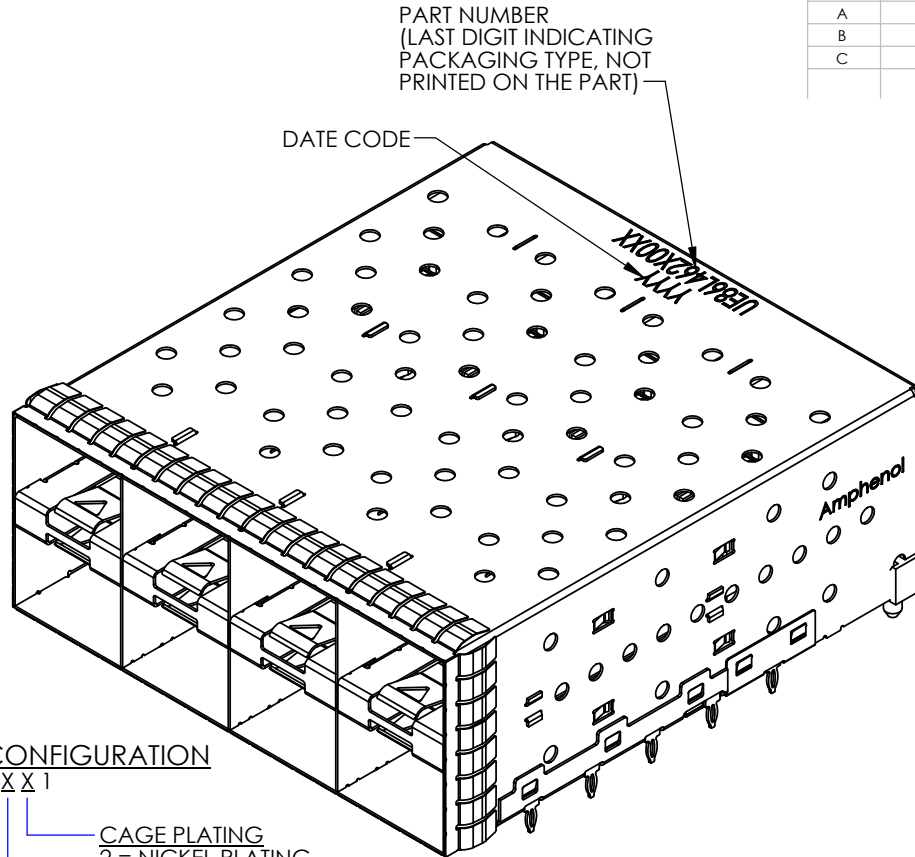

REVISIONS				
REV.	ECN	DESCRIPTION	DATE	APPROVED
A		PROPOSAL	May.15.11	J.SI
B		PROPOSAL	AUG.15.12	J.SI
C		OPTION 2 AND OPTION 5 ADDED	AUG.22.13	J.SI



AMPHENOL PART NUMBER CONFIGURATION
 UE86 - L 4 6 2 7 - 0 0 X X 1

CAGE PLATING
 2 = NICKEL PLATING
 3 = MATTE TIN

PRESS FIT CONNECTOR PLATING
 2 = 0.76 µm MIN. GOLD ON MATING AREA
 0.38-2.54 µm MATTE TIN OVER 1.27µm MIN
 NICKEL ON TERMINATION
 3 = 0.76 µm MIN. GOLD ON MATING AREA
 3.81-7.62 µm MATTE TIN ON TERMINATION
 5 = 0.38 µm MIN. GOLD ON MATING AREA
 0.38-2.54 µm MATTE TIN OVER 1.27µm MIN
 NICKEL ON TERMINATION
 6 = 0.38 µm MIN. GOLD ON MATING AREA
 3.81-7.62 µm MATTE TIN ON TERMINATION

MATERIAL: (RoHS COMPLIANT)
 CAGE - PRESS FIT:
 COPPER ALLOY
 PLATING:
 OPTION 2: NICKEL 2.54 µm MIN.
 OPTION 3: MATTE TIN 2.54 µm MIN.
 CONNECTOR - PRESS FIT:
 PLASTIC HOUSING:
 LCP, FLAMMABILITY RATING UL94-V0.
 CONTACTS:
 PHOSPHOR BRONZE
 PLATING OPTION:
 SEE AMPHENOL PART NUMBER
 CONFIGURATION FOR OPTIONS.
 PACKAGING:
 TRAY PACKAGING.
 TEMPERATURE RANGE:
 -40°C TO +85°C

DO NOT SCALE DRAWING

THIS DOCUMENT CONTAINS PROPRIETARY INFORMATION AND SUCH INFORMATION MAY NOT BE DISCLOSED TO OTHERS FOR ANY PURPOSE OR USED FOR MANUFACTURING PURPOSES WITHOUT PERMISSION FROM AMPHENOL CANADA CORP.

UNLESS OTHERWISE SPECIFIED DIMENSIONS ARE IN MILLIMETERS TOLERANCES ARE:		APPROVALS		DATE	Amphenol High Speed Interconnects A Division of Amphenol Corp. www.amphenol-highspeed.com	
DECIMALS	ANGLES	DRAWN	ChigowX	May.15.11	TITLE	
X.X ± 0.25	± 1°	DESIGNED			2X4 SFP+ EXPRESSPORT LOW PROFILE COMBO	
X.XX ± 0.15		CHECKED	J.SI	May.15.11		
MATERIAL AND FINISH		QA APPD				
REF.	X	IE APPD			SIZE	A4
CODE IDENT. NO.	03554	DWG APPD			DWG. NO.	P-UE86-L4627-00XX1
					SCALE	2:3
					PROJECT	
					SHEET	1 OF 4
					REV.	C

1 2 3 4 5 6

REVISIONS

REV.	ECN	DESCRIPTION	DATE	APPROVED
A		PROPOSAL	May.15.11	J.SI
B		PROPOSAL	AUG.15.12	J.SI
C		OPTION 2 AND OPTION 5 ADDED	AUG.22.13	J.SI

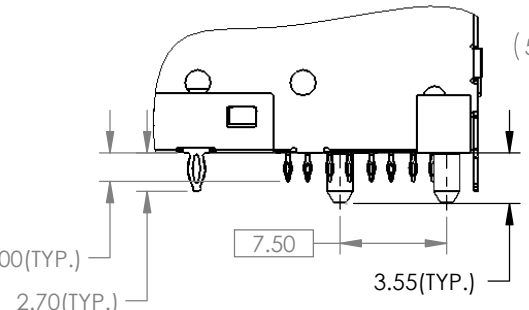
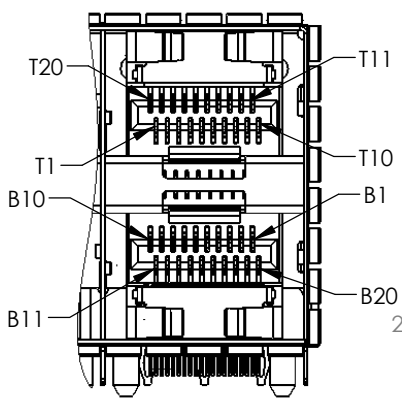
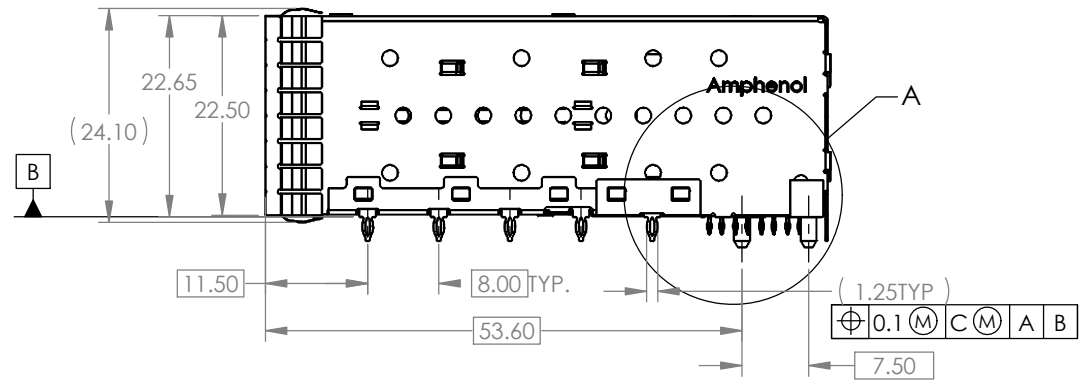
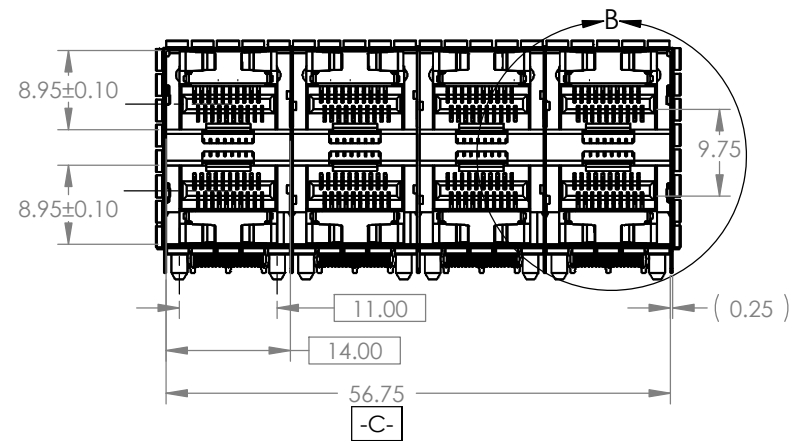

DETAIL A
SCALE 2 : 1

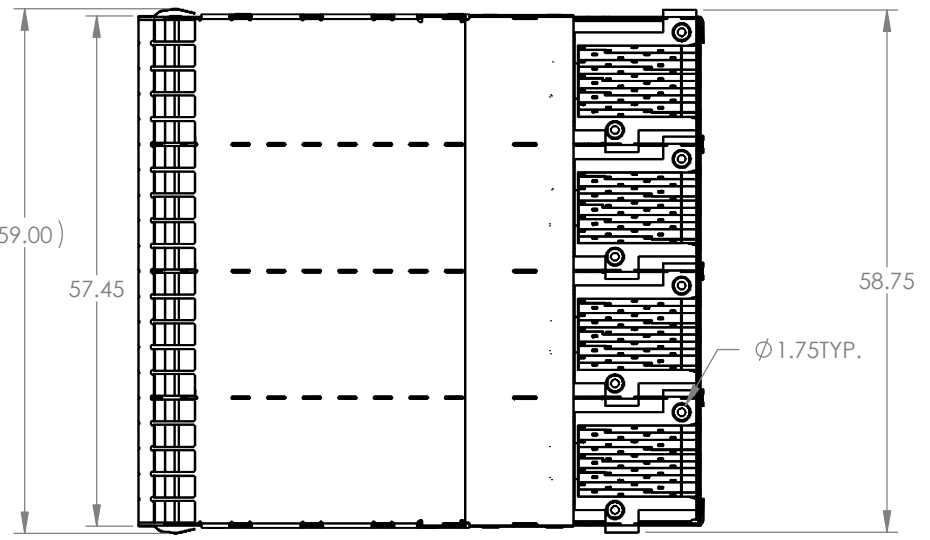

DETAIL B
SCALE 2 : 1

DO NOT SCALE DRAWING

THIS DOCUMENT CONTAINS PROPRIETARY INFORMATION AND SUCH INFORMATION MAY NOT BE DISCLOSED TO OTHERS FOR ANY PURPOSE OR USED FOR MANUFACTURING PURPOSES WITHOUT PERMISSION FROM AMPHENOL CANADA CORP.

UNLESS OTHERWISE SPECIFIED DIMENSIONS ARE IN MILLIMETERS TOLERANCES ARE:		APPROVALS		DATE	Amphenol High Speed Interconnects A Division of Amphenol Corp. www.amphenol-highspeed.com
DECIMALS	ANGLES	DRAWN	DESIGNED	May.15.11	
X.X ± 0.25	± 1°	ChigowX			TITLE
X.XX ± 0.15					2X4 SFP+ EXPRESSPORT LOW PROFILE COMBO
MATERIAL AND FINISH		CHECKED	J.SI	May.15.11	
N/A		QA APPD			
REF.	X	IE APPD			SIZE A4
CODE IDENT. NO.	03554	DWG APPD			DWG. NO. P-UE86-L4627-00XX1
					SCALE 1:1
					PROJECT
					SHEET 2 OF 4
					REV. C

1 2 3 4 5 6

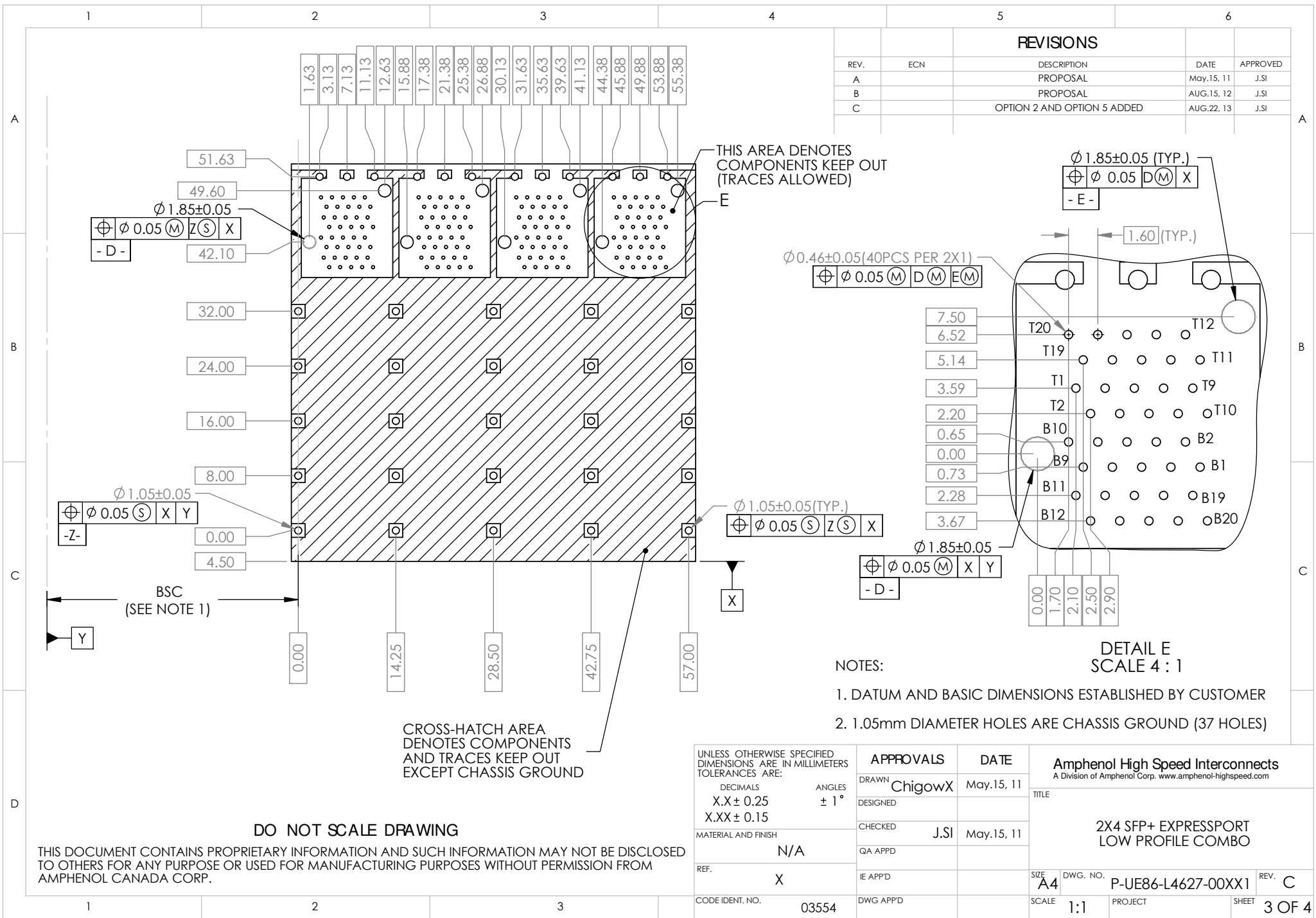

REVISIONS				
REV.	ECN	DESCRIPTION	DATE	APPROVED
A		PROPOSAL	May.15.11	J.SI
B		PROPOSAL	AUG.15.12	J.SI
C		OPTION 2 AND OPTION 5 ADDED	AUG.22.13	J.SI

THIS AREA DENOTES COMPONENTS KEEP OUT (TRACES ALLOWED)

$\phi 1.85 \pm 0.05$ (TYP.)
 $\phi 0.05$ (M) X
 - E -

$\phi 0.46 \pm 0.05$ (40PCS PER 2X1)
 $\phi 0.05$ (M) D (M) E (M)

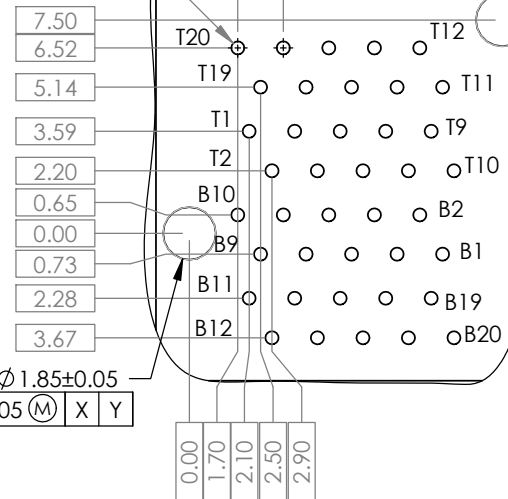

DETAIL E
SCALE 4 : 1

- NOTES:
- DATUM AND BASIC DIMENSIONS ESTABLISHED BY CUSTOMER
 - 1.05mm DIAMETER HOLES ARE CHASSIS GROUND (37 HOLES)

CROSS-HATCH AREA DENOTES COMPONENTS AND TRACES KEEP OUT EXCEPT CHASSIS GROUND

DO NOT SCALE DRAWING

THIS DOCUMENT CONTAINS PROPRIETARY INFORMATION AND SUCH INFORMATION MAY NOT BE DISCLOSED TO OTHERS FOR ANY PURPOSE OR USED FOR MANUFACTURING PURPOSES WITHOUT PERMISSION FROM AMPHENOL CANADA CORP.

UNLESS OTHERWISE SPECIFIED DIMENSIONS ARE IN MILLIMETERS TOLERANCES ARE:		APPROVALS		DATE	Amphenol High Speed Interconnects A Division of Amphenol Corp. www.amphenol-highspeed.com	
DECIMALS	ANGLES	DRAWN	DESIGNED	May.15.11	TITLE	
X.X ± 0.25	± 1°	ChigowX			2X4 SFP+ EXPRESSPORT LOW PROFILE COMBO	
X.XX ± 0.15		CHECKED	J.SI	May.15.11	SIZE	
MATERIAL AND FINISH	N/A	QA APPD			A4	
REF.	X	IE APPD			DWG. NO.	
CODE IDENT. NO.	03554	DWG APPD			P-UE86-L4627-00XX1	
					SCALE	1:1
					PROJECT	
					SHEET	3 OF 4
					REV.	C

1 2 3 4 5 6

REVISIONS				
REV.	ECN	DESCRIPTION	DATE	APPROVED
A		PROPOSAL	May.15. 11	J.SI
B		PROPOSAL	AUG.15. 12	J.SI
C		OPTION 2 AND OPTION 5 ADDED	AUG.22. 13	J.SI

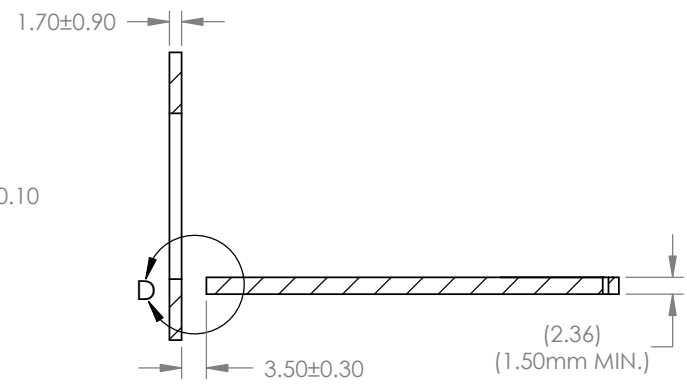
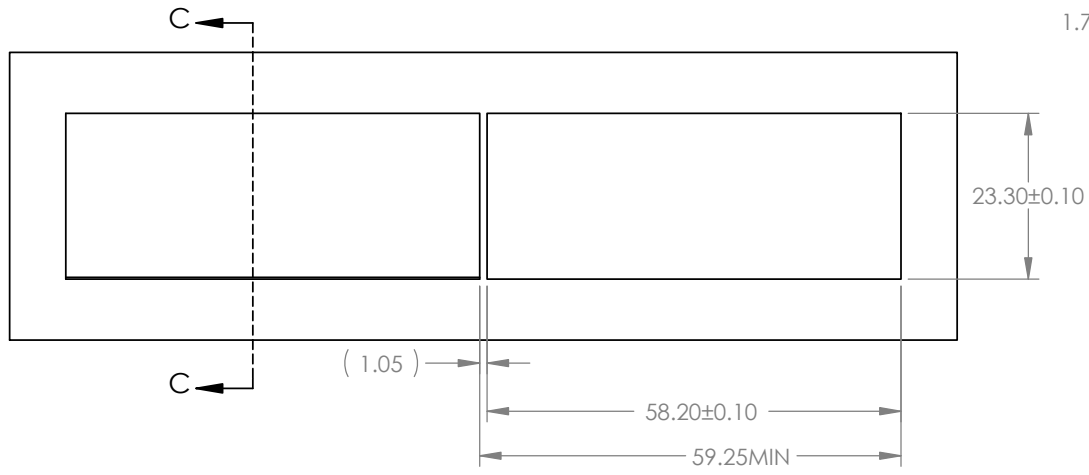

SECTION C-C

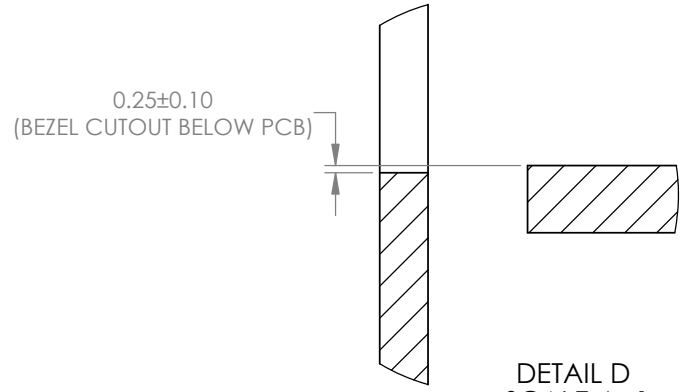

DETAIL D
SCALE 4 : 1

DO NOT SCALE DRAWING

THIS DOCUMENT CONTAINS PROPRIETARY INFORMATION AND SUCH INFORMATION MAY NOT BE DISCLOSED TO OTHERS FOR ANY PURPOSE OR USED FOR MANUFACTURING PURPOSES WITHOUT PERMISSION FROM AMPHENOL CANADA CORP.

UNLESS OTHERWISE SPECIFIED DIMENSIONS ARE IN MILLIMETERS TOLERANCES ARE:		APPROVALS		DATE	Amphenol High Speed Interconnects A Division of Amphenol Corp. www.amphenol-highspeed.com	
DECIMALS	ANGLES	DRAWN	ChigowX	May.15. 11	TITLE 2X4 SFP+ EXPRESSPORT LOW PROFILE COMBO	
X.X ± 0.25	± 1°	DESIGNED				
X.XX ± 0.15		CHECKED	J.SI	May.15. 11		
MATERIAL AND FINISH	N/A	QA APP'D				
REF.	X	IE APP'D			SIZE A4	DWG. NO. P-UE86-L4627-00XX1
CODE IDENT. NO.	03554	DWG APP'D			SCALE 1:1	PROJECT
					SHEET	4 OF 4

1 2 3 4 5 6

A
B
C
D

A
B
C