

# Banana Plug - Insulated Solderless Tapered Handle



INCHES (MILLIMETERS)  
CUSTOMER DRAWINGS AVAILABLE UPON REQUEST

## SPECIFICATIONS

**Plug Body:** Brass per QQ-B-626D

**Plug Spring:** Nickel silver per QQ-C-533

**Finish:** Nickel

**Insulated Handle:** Nylon 6/6 per ASTM D4066

## RATINGS

**Current:** 15 amps

**Breakdown Voltage:** 3500 Vrms minimum =

**Contact Resistance:** 0.010 ohms maximum

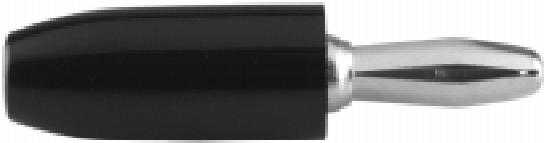
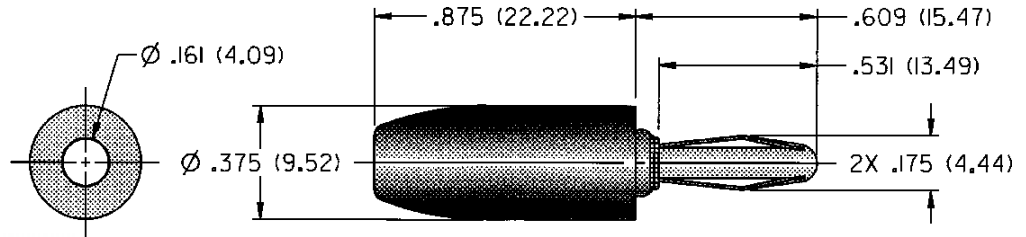

<b>NICKEL PLATING</b>
108-0301-001 White

**For Standard Banana Jack: .166 (4.23) Diameter**

## FEATURES:

- Fast solderless connection of up to 16 gauge wire
- Recessed plug body to limit shock hazard
- Nylon UL approved for self extinguishing