

# KSM Series Side Actuated Detect Switches

## Features/Benefits

- **Low profile – 1,5 mm**
- **Momentary, normally closed contact**
- **Infrared reflow soldering without cleaning**
- **Thermoformed tape & reel**
- **RoHS compliant and compatible**

## Typical Applications

- **Automotive**
- **Position sensing switch**
- **Edge card reset switch**
- **Smart card presence switch detector**
- **DSL and fiber optic networks**



## Specifications

FUNCTION: Momentary, Normally closed.  
 SWITCHING POWER MAX.: 0.2 W DC  
 SWITCHING VOLTAGE MAX.: 24 V DC  
 SWITCHING CURRENT MAX.: 50 mA DC  
 OPERATING LIFE: 50,000 operations.  
 CONTACT RESISTANCE: < 200 m Ω  
 INSULATION RESISTANCE: > 10<sup>9</sup> Ω  
 BOUNCE TIME: < 3 ms  
 OPERATING TEMPERATURE: -40°C to +85°C

TRAVEL TO BREAK: 0,3 (.01181) ± 0,1 (.00394)  
 TOTAL TRAVEL: 1,2 (.047) ± 0,15 (.006)  
 FORCE AT MAXIMUM TRAVEL: ≤1.25N  
 STORAGE TEMPERATURE: -55°C to +85°C  
 SOLDERABILITY: According to lead free soldering profiles.  
 PACKAGING: Switches delivered on continuous tape & reels of 2000 pieces, 16mm width. Dimensions according to EIA RS-481 standard.

**NOTE:** Specifications listed above are for switches with standard options. For information on specific and custom switches, consult Customer Service Center.

## Build-A-Switch

To order, simply select desired option from each category and place in the appropriate box. Available options are shown and described on page F-10. For additional options not shown in catalog, consult our Customer Service Center.

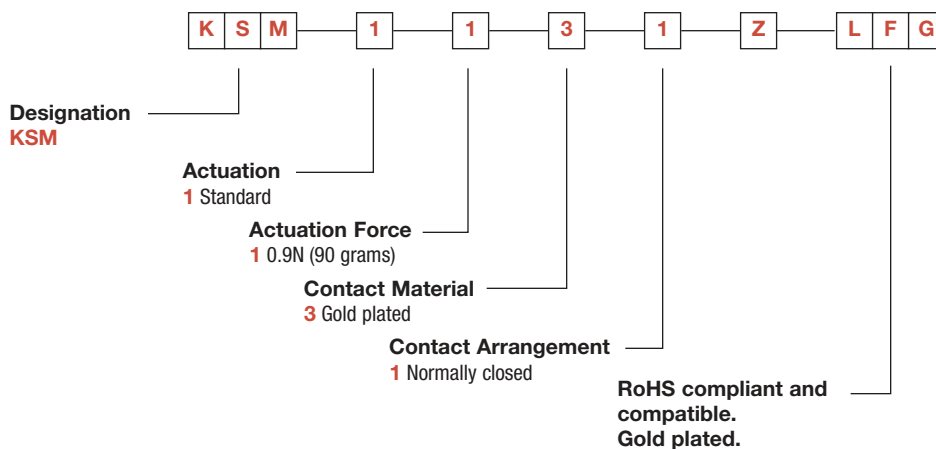

# KSM Series Side Actuated Detect Switches

## DESIGNATION

**KSM**

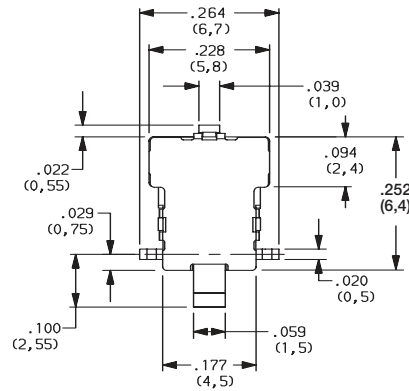

### PAD LAYOUT

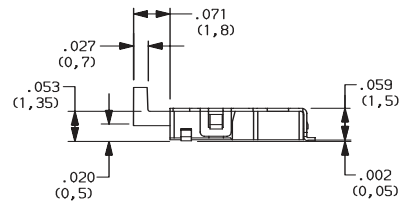
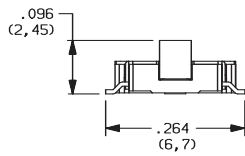
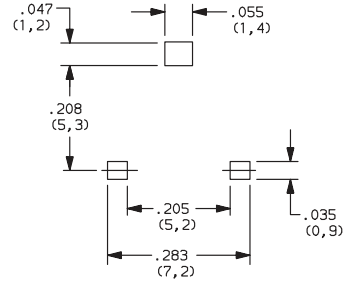

## TAPE & REEL

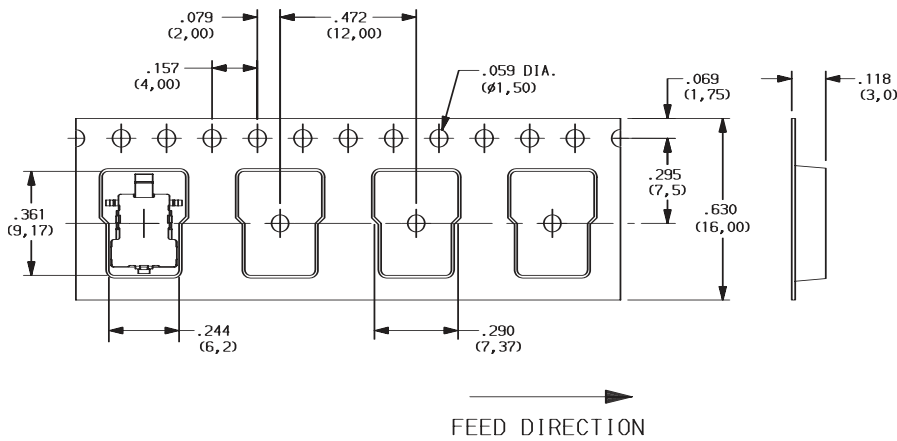

**Detect**



Third Angle Projection  
Dimensions are shown: Inches (mm)  
Specifications and dimensions subject to change