

**PROTECTIVE CAP, FEMALE WITH CHAIN**

**R143.835.000**

Series : TNC

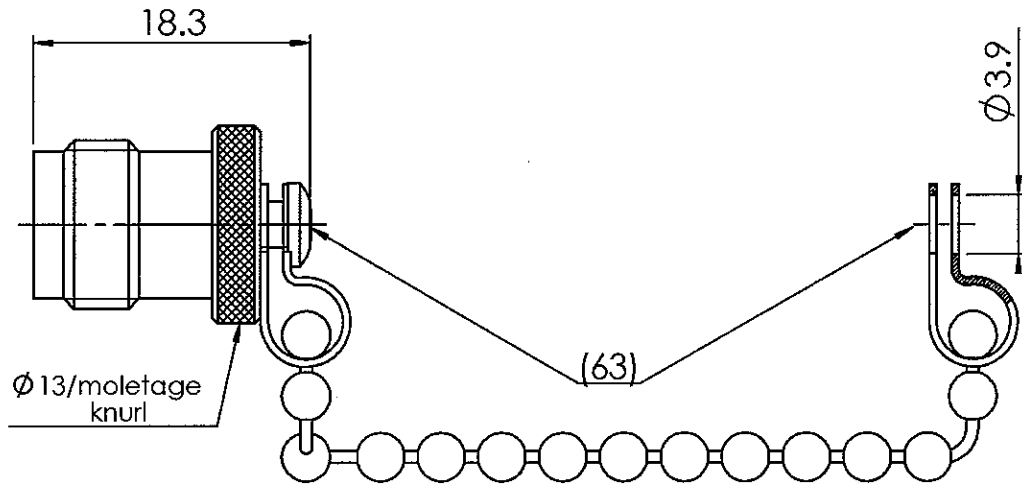

All dimensions are in mm.

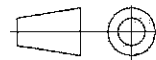

COMPONENTS	MATERIALS	PLATINGS (µm)
<b>BODY</b>	<b>BRASS</b>	Ni 2
<b>CENTER CONTACT</b>	-	-
<b>OUTER CONTACT</b>	-	-
<b>INSULATOR</b>	-	-
<b>GASKET</b>	-	-
<b>OTHERS PARTS</b>	<b>BRASS</b>	Ni 2
-	-	-
-	-	-

Issue : 0522 B

In the effort to improve our products, we reserve the right to make changes judged to be necessary.



**PROTECTIVE CAP, FEMALE WITH CHAIN**

**R143.835.000**

Series : TNC

**PACKAGING**

**SPECIFICATION**

Standard	Unit	Other
100	'W' option	Contact us

**ELECTRICAL CHARACTERISTICS**

Impedance	NA	$\Omega$
Frequency	NA	GHz
VSWR	- +	0.000 x F(GHz) Maxi
Insertion loss	NA	$\sqrt{F}$ (GHz) dB Maxi
RF leakage	- (	NA - F(GHz)) dB Maxi
Voltage rating	NA	Veff Maxi
Dielectric withstanding voltage	NA	Veff mini
Insulation resistance	NA	M $\Omega$ mini

**ENVIRONMENTAL**

Operating temperature	NA	$^{\circ}$ C
Hermetic seal	NA	Atm.cm3/s
Panel leakage	NA	

**OTHERS CHARACTERISTICS**

Assembly instruction

Others :

**MECHANICAL CHARACTERISTICS**

Center contact retention		
Axial force – Mating end	NA	N mini
Axial force – Opposite end	NA	N mini
Torque	NA	N.cm mini
Recommended torque		
Mating	NA	N.cm
Panel nut	NA	N.cm
Mating life	NA	Cycles mini
Weight	8.465	g

Issue : 0522 B

In the effort to improve our products, we reserve the right to make changes judged to be necessary.



**RADIALL®**