

|           |            |                  |         |     |      |
|-----------|------------|------------------|---------|-----|------|
| LOC<br>AI | DIST<br>00 | REVISIONS        |         |     |      |
| P         | LTR        | DESCRIPTION      | DATE    | DWN | APVD |
| C         |            | INITIAL REVISION | 07APR10 | LS  | LB   |

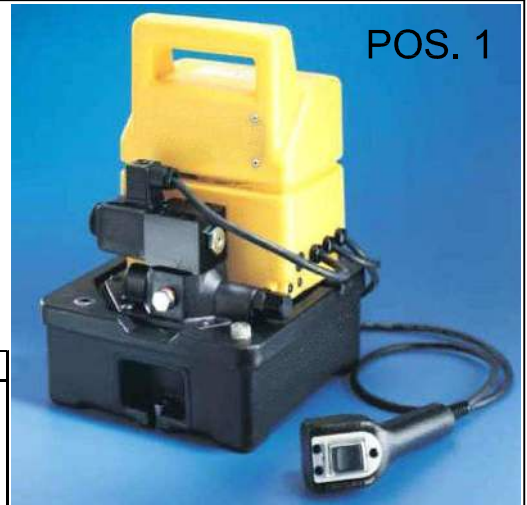

| POS | QTY | DISCRIPTION:  |
|-----|-----|---|
| 1   | 1   | <p>ELECTRICAL HYDRAULIC PUMP, DUAL-STAGE WITH CABLE REMOTE CONTROL. (by operation the motor starts and the pump drives on thrust)</p> <p>VALVE TYPE: 3/2 CONTROL HAND VALVE</p> <p>VALVE FUNCTION: DRIVE OUT- STOP - DRIVE IN</p> <p>MAX. OPERATING PRESSURE: 700 bar</p> <p>ELECTR. CONNECTING VALUE: 10A, 220V, SINGLE-PHASE, 50/60Hz</p> <p>MAX. OPERATING TEMPERATURE: 65°C</p> <p><u>FLUID VOLUME</u></p> <p>FIRST LEVEL: 3,31 l/min</p> <p>SECOND LEVEL: 0,32 l/min</p> <p>TOGGLE PRESSURE: 13 bar</p> <p>OIL CONNECTION: 3/8"-18 NPT</p> <p>PASSABLE OIL VOLUME: 1,9 dm³</p> <p><b>COMPLETE READY TO CONNECTION, INCLUDING OIL FILLING</b></p> |
| 2   | 1   | <p>COUPLER PLUG WITH PLASTIC CAP</p> <p>OIL CONNECTION: 3/8"-18 NPT FEMALE THREAD - F= SW32</p>   |
| 3   | 1   | <p>DOUBLE NIPPLE, 3/8-NPT (ON BOTH SIDES) EXTERNAL THREAD - B= SW19</p> <p><b>NEEDED FOR MOUNTING THE POSITION 2 ON THE PUMP</b></p>  |

POS. 2

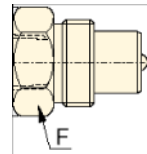

| POS | STK | BEZEICHNUNG  |
|-----|-----|--|
| 1   | 1   | <p>ELEKTOHYDRAULISCHES PUMPENAGGREGAT, zweistufig mit Kabelfernbedienung. (bei Betätigung läuft der Motor an und die Pumpe fährt auf Druck)</p> <p>Ventiltyp: 3/2-Wege Handventil</p> <p>Ventilfunktion: Ausfahren-Halt-Einfahren</p> <p>max. Betriebsdruck: 700 bar</p> <p>Elektrische Anschlußwerte: 10A, 220V, einphasig, 50/60Hz</p> <p>Max. Betriebstemperatur: 65°C</p> <p><u>Fördervolumen</u></p> <p>1. Stufe: 3,31 l/min</p> <p>2. Stufe: 0,32 l/min</p> <p>Umschaltdruck: 13 bar</p> <p>Ölanschluss: 3/8"-18 NPT</p> <p>nutzbares Ölvolumen: 1,9 dm³</p> <p><b>Komplett anschluss bereit, einschließlich Ölfüllung</b></p> |
| 2   | 1   | <p>Hochflußkupplungsstecker mit Kunststoffstaubkappe</p> <p>Ölanschluss: 3/8"-18 NPT Innengewinde - F= SW32</p>  |
| 3   | 1   | <p>Doppelnippel, beidseitig 3/8" NPT Außengewinde - B= SW19</p> <p><b>Wird für die Montage der Position 2 an der Pumpe benötigt</b></p>  |

POS. 3

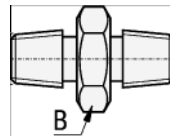

RELEASED FOR PUBLICATION

ALL INTERNATIONAL RIGHTS RESERVED.

BY TYCO ELECTRONICS CORPORATION.

THIS DRAWING IS UNPUBLISHED.

|  |                  |          |   |           |            |               |
|--|------------------|----------|---|-----------|------------|---------------|
| DIMENSIONS:<br>mm                      | DWN              | 07APR10  | MATERIAL  | FINISH    |            |               |
|  | L. Sandhu        |          |   |           |            |               |
| TOLERANCES UNLESS OTHERWISE SPECIFIED: | CHK              | 08APR10  | Tyco Electronics<br>Tyco Electronics AMP GmbH<br>64625 Bensheim (Germany) |           |            |               |
|  | L. Bauer         |          |   |           |            |               |
| 0 PLC ± -                              | APVD             | 08APR10  | NAME<br><b>ELECTRICAL HYDRAULIC PUMP</b><br>Elektrohydraulische Pumpe     |           |            |               |
| 1 PLC ± -                              | L. Bauer         |          |   |           |            |               |
| 2 PLC ± -                              | PRODUCT SPEC     |          | SIZE  | CAGE CODE | DRAWING NO | RESTRICTED TO |
| 3 PLC ± -                              | APPLICATION SPEC |          | A4  | 00779     | ©=523199-1 | -             |
| 4 PLC ± -                              | WEIGHT           | 12.000kg |   |           |            |               |
| ANGLES ± -                             | CUSTOMER DRAWING |          | SCALE   | SHEET     | 1 OF 1     | REV C         |

